

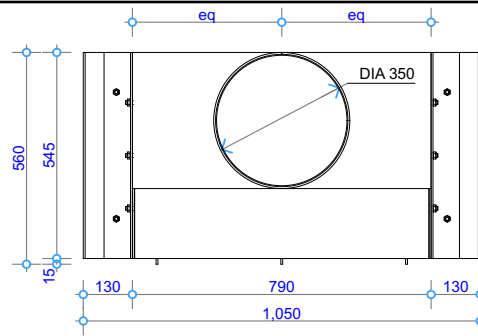

# **WD1 – 800 Open Front & Right**

## **Specifications**

Information in this specification may be subject to change without notice. Please ensure you have the current version before beginning installation.



Plan View

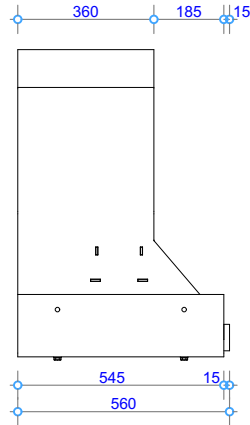

Side View

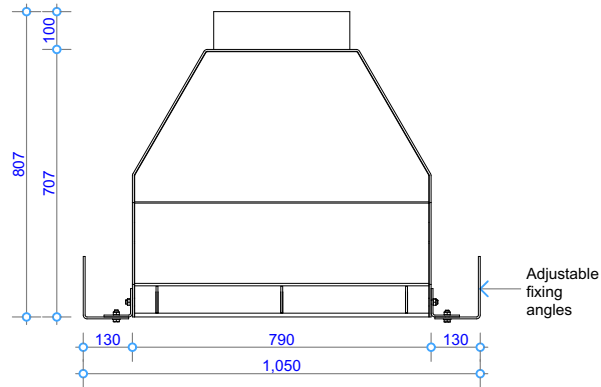

Front View

TOLERANCE = +/- 3mm

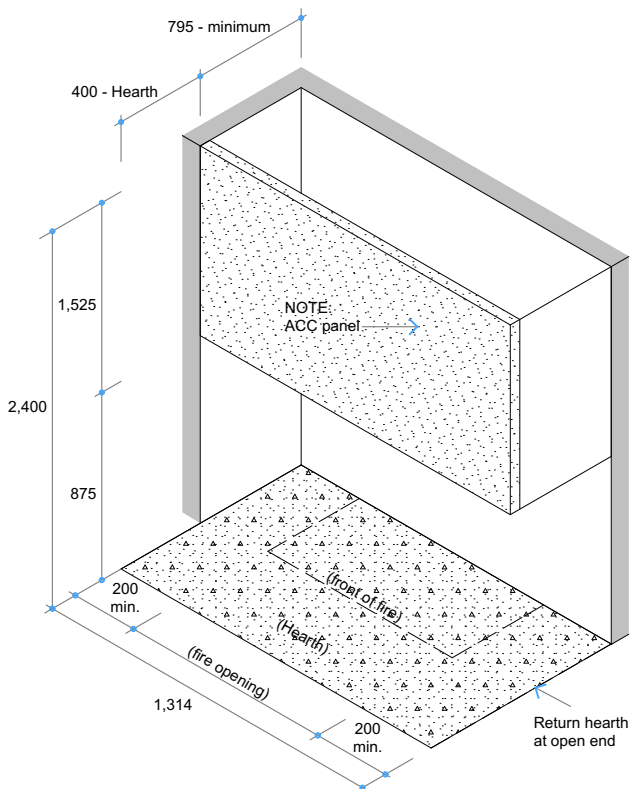

**Fire Installation Requirements & Hearth Size - Timber Cavity**

NOTE: Hearth to extend minimum of 200mm both sides of fire opening, and 400mm from front of fire opening

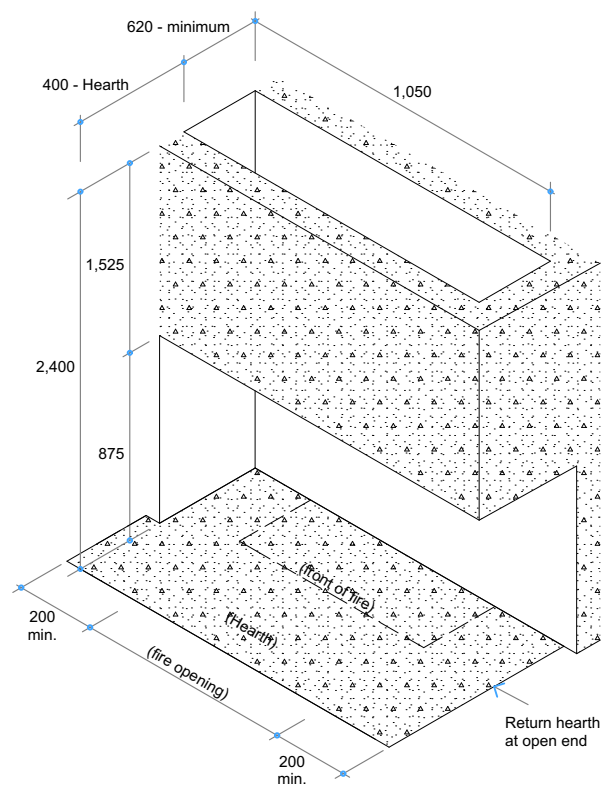

**Fire Installation Requirements & Hearth Size - Concrete Cavity**

NOTE: Hearth to extend minimum of 200mm both sides of fire opening, and 400mm from front of fire opening

COPYRIGHT©  
THIS DRAWING IS THE PROPERTY  
OF The Fire Dept.

Client: THE FIRE DEPT.		
Product: WD1OR-800		
Title: FIRE DIMENSIONS		
Drawn: SR	Date: 31/05/2018	
Chkd: JW	Date: 31/05/2018	
Appd: JW	Date: 31/05/2018	
Scale: on A4		

**THE FIRE DEPT.**

Drawing No. **WD1OR-800-901**

Sheet 01 of 15

Revision **4**

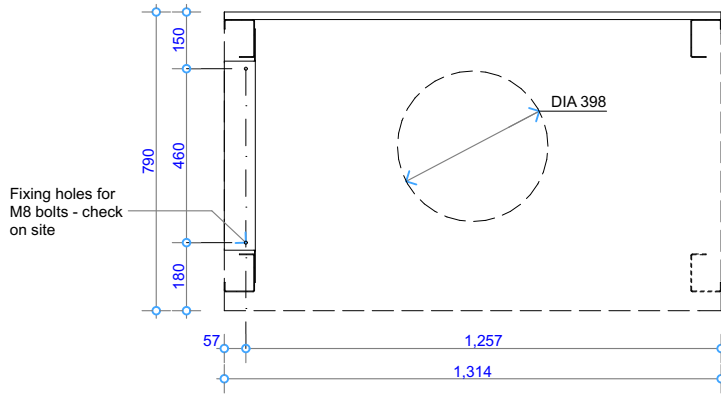

Information in this specification may be subject to change without notice. Please ensure you have the current version before beginning installation.

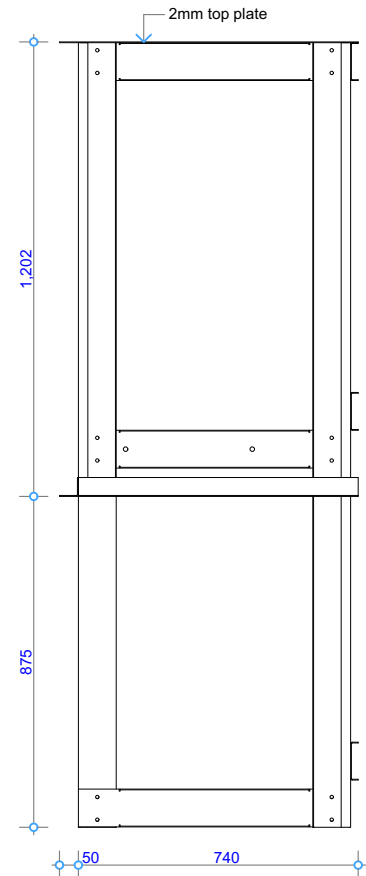
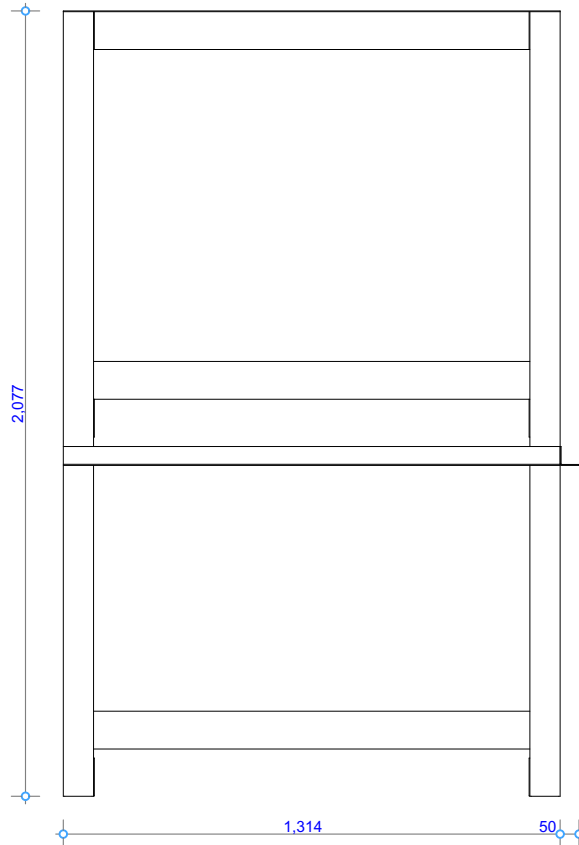

COPYRIGHT©  
THIS DRAWING IS THE PROPERTY  
OF **The Fire Dept.**

Client: THE FIRE DEPT.

Product: WD1OR-800

Title: STEEL SUPPORT FRAME DIMENSIONS

Drawn: SR

Date: 31/05/2018

Chkd: JW

Date: 31/05/2018

Appd: JW

Date: 31/05/2018

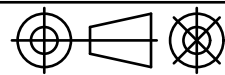

Scale: on A4

**THE FIRE DEPT.**

Drawing No. **WD1OR-800-902**

Sheet 02 of 15

Revision

4

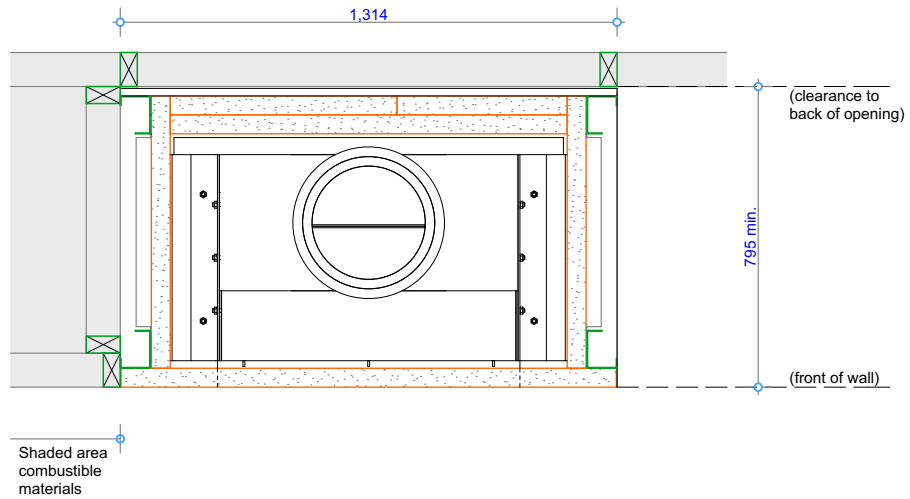

Plan View - Fire Insert (above fire gather)

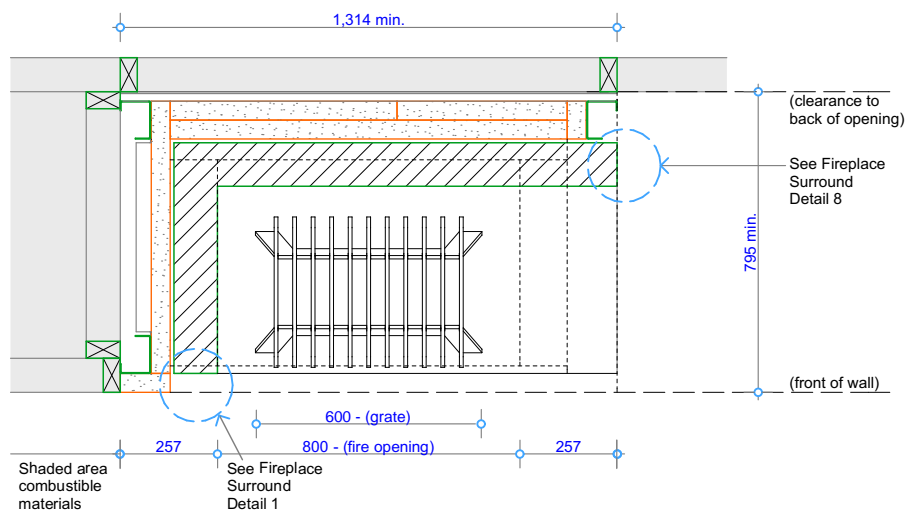

Plan View - Fire Insert (below fire gather)

COPYRIGHT©  
THIS DRAWING IS THE PROPERTY  
OF **The Fire Dept.**

Client: THE FIRE DEPT.

Product: WD1OR-800

Title: CAVITY CLEARANCES - TIMBER

Drawn: SR

Date: 31/05/2018

Chkd: JW

Date: 31/05/2018

Appd: JW

Date: 31/05/2018

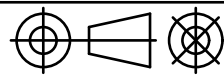

Scale: on A4

**THE FIRE DEPT.**

Drawing No. **WD1OR-800-903**

Sheet 03 of 15

Revision

4

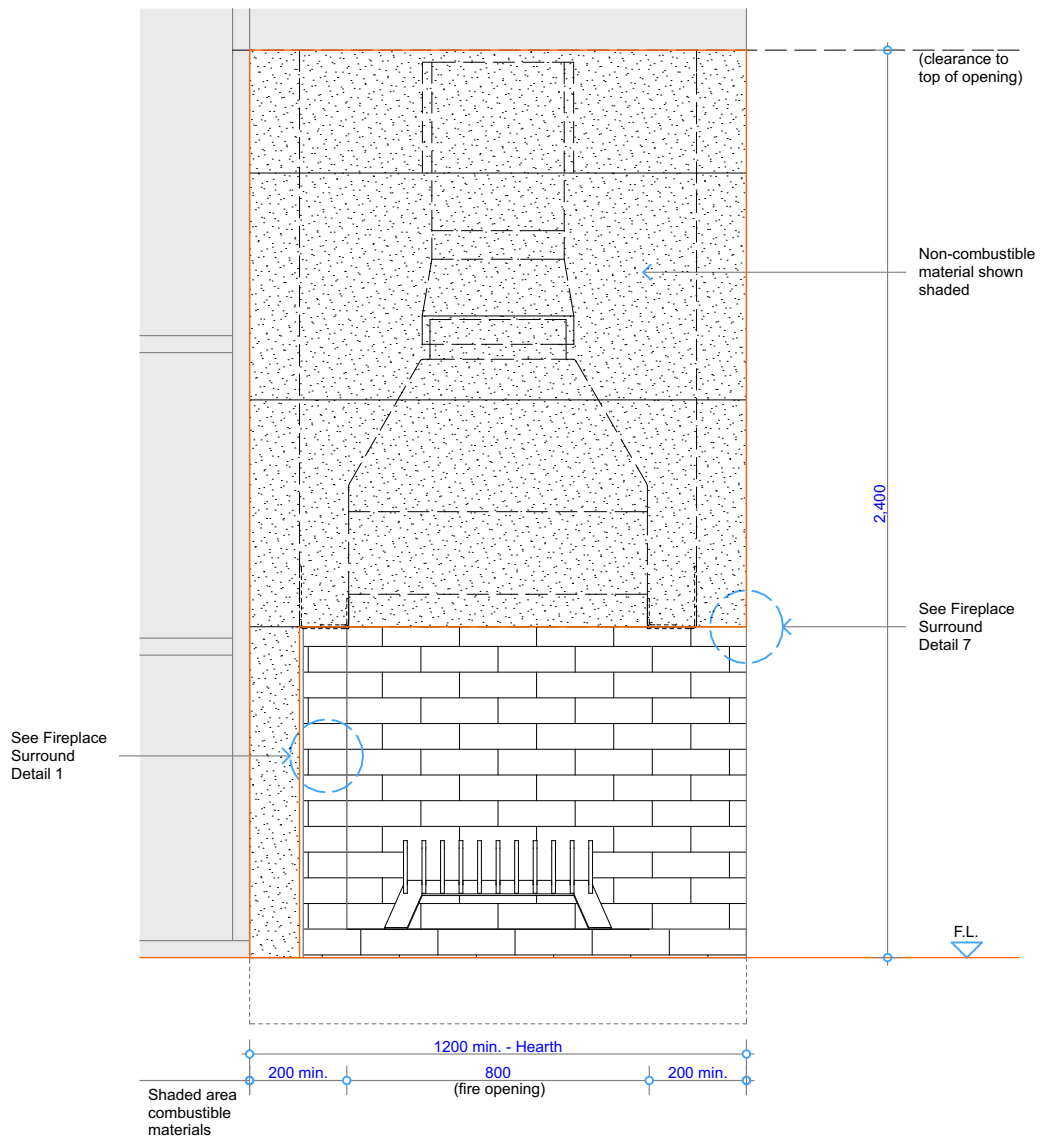

Front View - Fire Insert

COPYRIGHT©  
THIS DRAWING IS THE PROPERTY  
OF **The Fire Dept.**

Client: THE FIRE DEPT.

Product: WD1OR-800

Title: CAVITY CLEARANCES - TIMBER

Drawn: SR

Date: 31/05/2018

Chkd: JW

Date: 31/05/2018

Appd: JW

Date: 31/05/2018

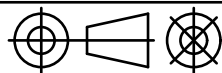

Scale: on A4

**THE FIRE DEPT.**

Drawing No. **WD1OR-800-904**

Sheet 04 of 15

Revision

4

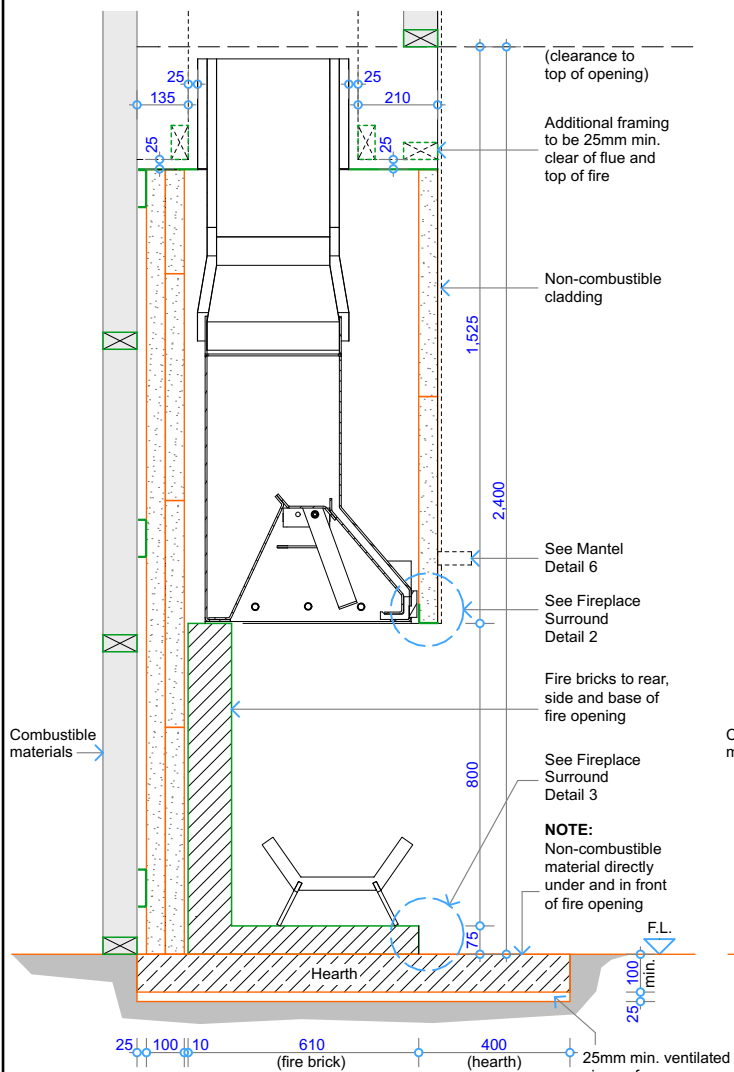

**Cross Section - Fire Insert at Floor Level**

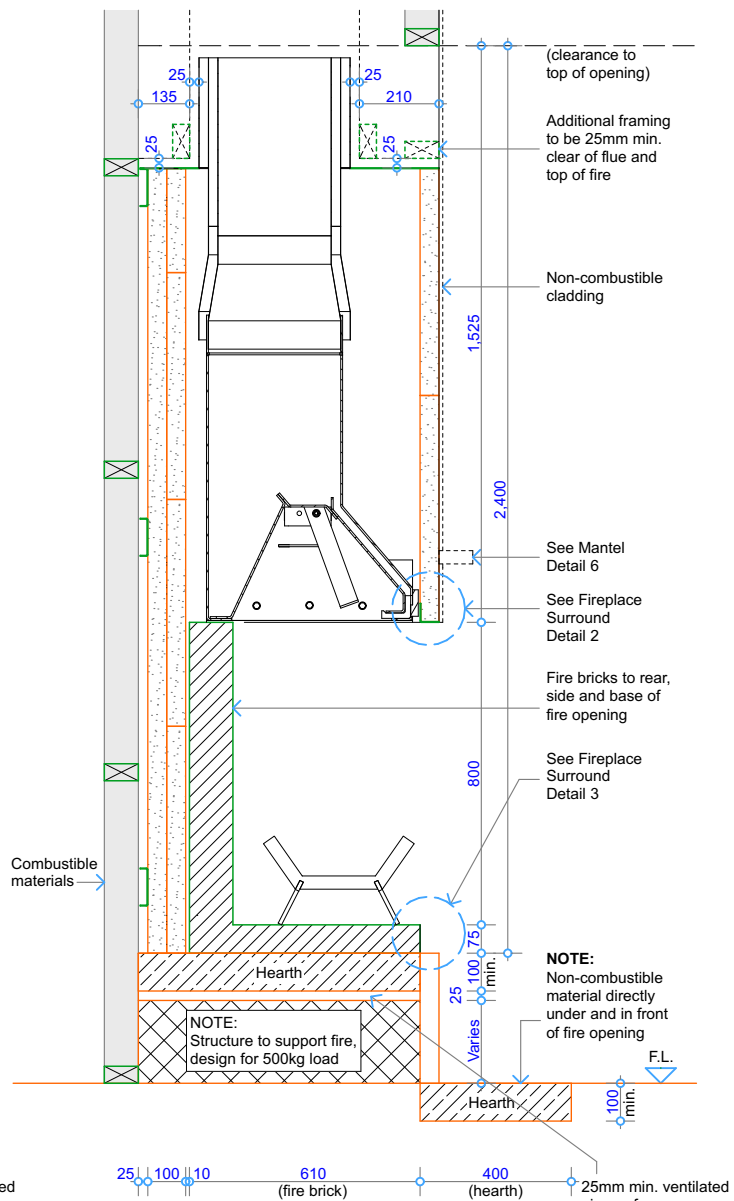

**Cross Section - Fire Insert on Raised Plinth**

NOTE: Plinth height can vary to suit

NOTE:  
Room requires air inlet  
equal to 100,000mm<sup>2</sup>.

COPYRIGHT©  
THIS DRAWING IS THE PROPERTY  
OF The Fire Dept.

Client: THE FIRE DEPT.

Product: WD1OR-800

Title: CAVITY CLEARANCES - TIMBER

Drawn: SR

Date: 31/05/2018

Chkd: JW

Date: 31/05/2018

Appd: JW

Date: 31/05/2018

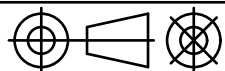

Scale: on A4

THE  
**FIRE  
DEPT.**

Drawing No. **WD1OR-800-905**

Sheet 05 of 15

Revision

4

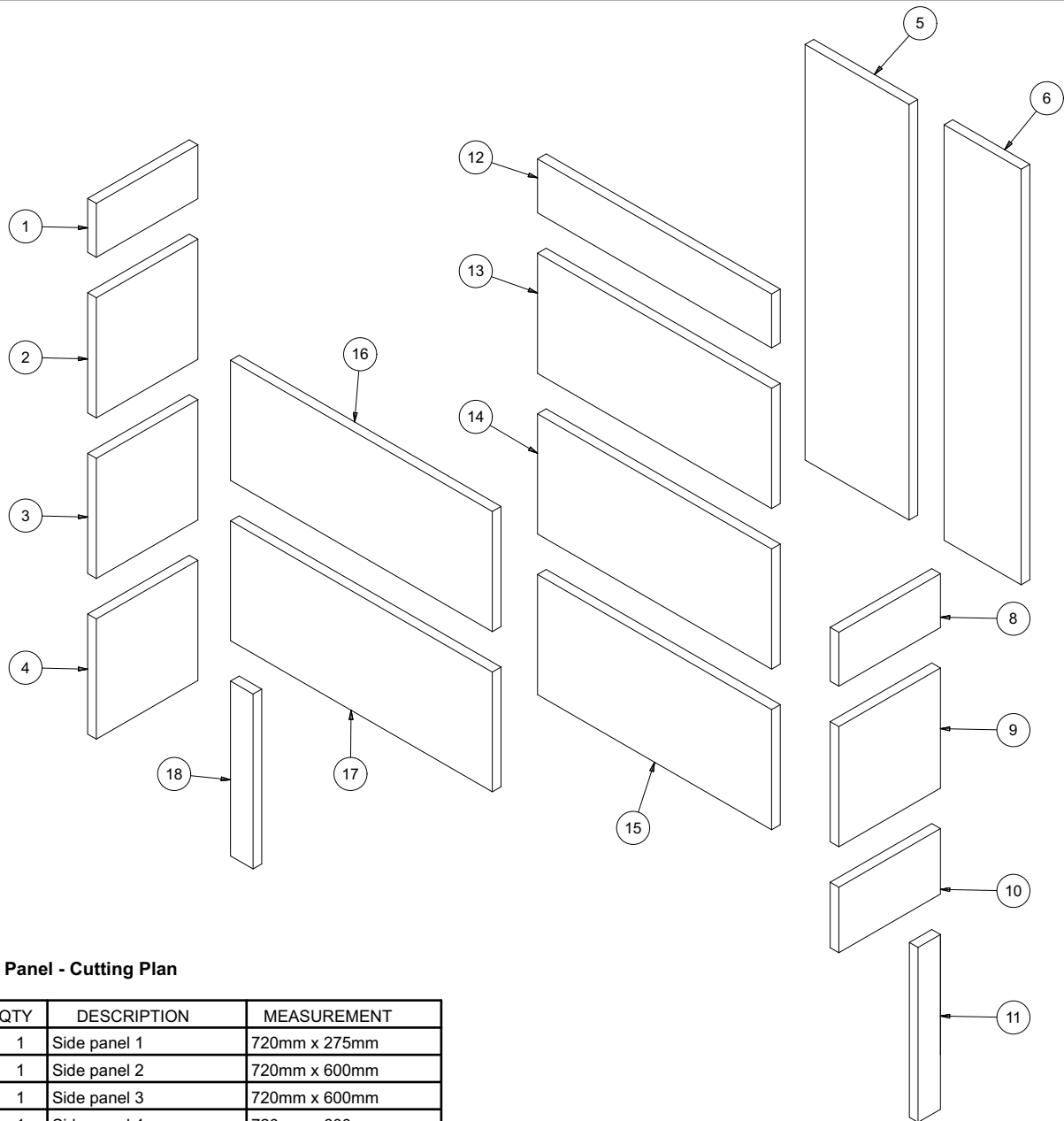

**Celcrete Panel - Cutting Plan**

ITEM	QTY	DESCRIPTION	MEASUREMENT
1	1	Side panel 1	720mm x 275mm
2	1	Side panel 2	720mm x 600mm
3	1	Side panel 3	720mm x 600mm
4	1	Side panel 4	720mm x 600mm
5	1	Back panel 1	600mm x 2075mm
6	1	Back panel 2	450mm x 2075mm
7		Panel not required	
8	1	Side panel 5	720mm x 275mm
9	1	Side panel 6	720mm x 600mm
10	1	Side panel 7	720mm x 325mm
11	1	Side panel 8	100mm x 875mm
12	1	Back panel 4	275mm x 1050mm
13	1	Back panel 5	600mm x 1050mm
14	1	Back panel 6	600mm x 1050mm
15	1	Back panel 7	600mm x 1050mm
16	1	Front panel 1	600mm x 1310mm
17	1	Front panel 2	600mm x 1310mm
18	1	Front panel 3	130mm x 875mm
19		Panel not required	

COPYRIGHT©  
 THIS DRAWING IS THE PROPERTY  
 OF **The Fire Dept.**

Client: THE FIRE DEPT.

Product: WD1OR-800

Title: CELCRETE CUTTING PLAN - TIMBER CAVITY

Drawn: SR

Date: 31/05/2018

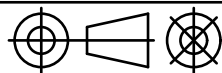

Chkd: JW

Date: 31/05/2018

Appd: JW

Date: 31/05/2018

Scale: on A4

**THE FIRE DEPT.**

Drawing No. **WD1OR-800-906**

Sheet 06 of 15

Revision **4**

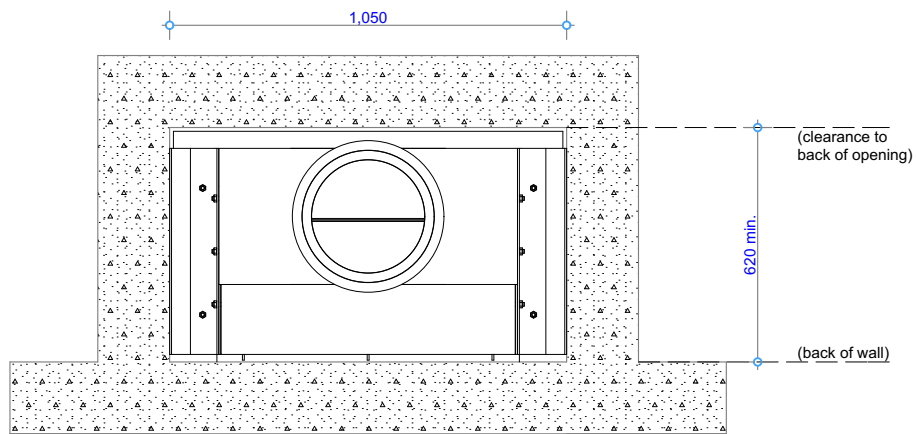

Plan View - Fire Insert (above fire gather)

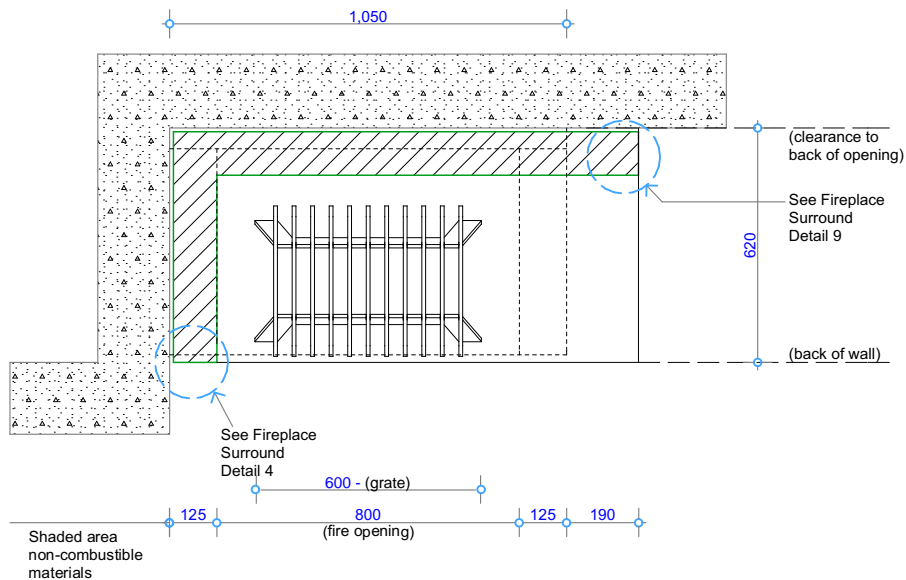

Plan View - Fire Insert (below fire gather)

COPYRIGHT©  
THIS DRAWING IS THE PROPERTY  
OF The Fire Dept.

Client: THE FIRE DEPT.

Product: WD1OR-800

Title: CAVITY CLEARANCES - CONCRETE

Drawn: SR

Date: 31/05/2018

Chkd: JW

Date: 31/05/2018

Appd: JW

Date: 31/05/2018

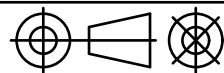

Scale: on A4

THE FIRE DEPT.

Drawing No. WD1OR-800-907

Sheet 07 of 15

Revision

4



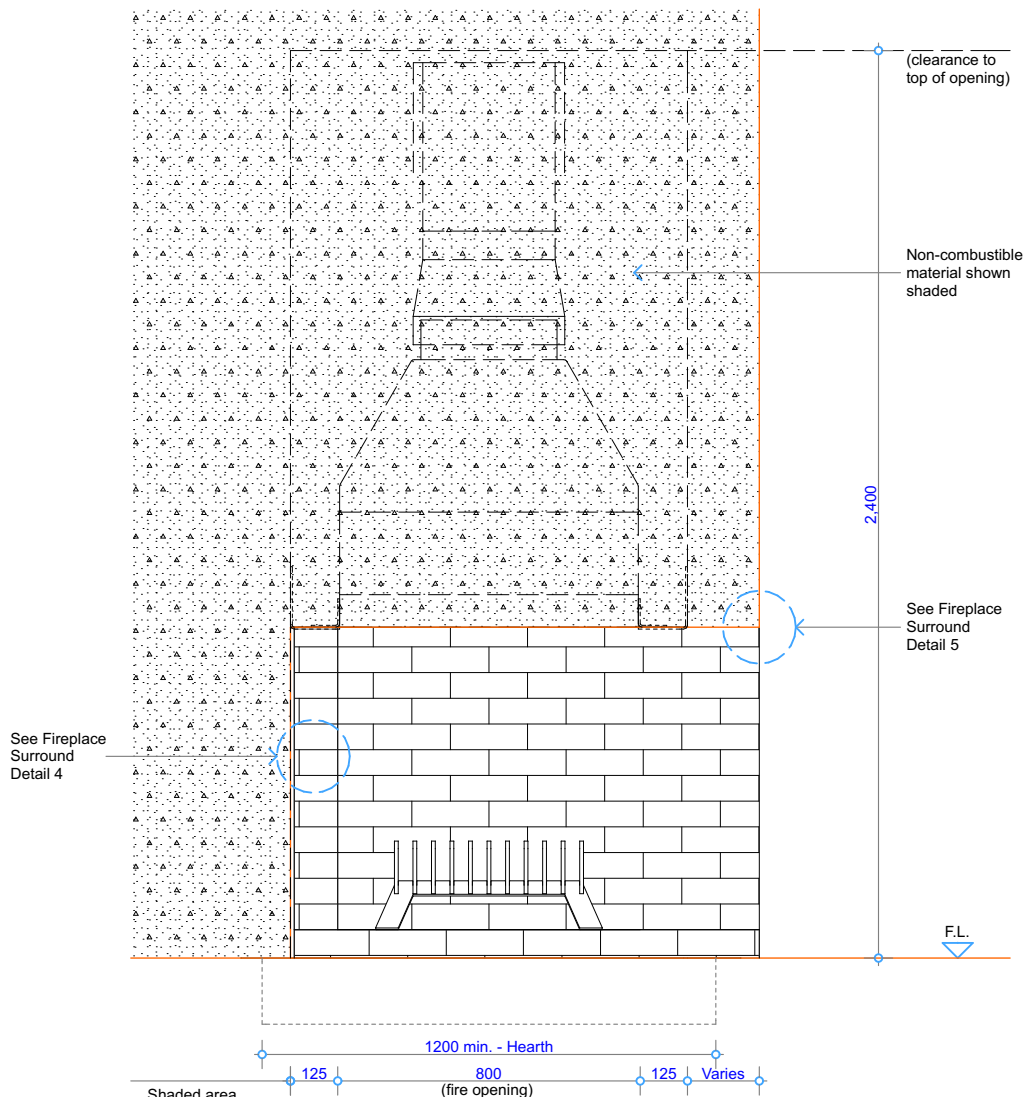

Front View - Fire Insert

COPYRIGHT©  
THIS DRAWING IS THE PROPERTY  
OF The Fire Dept.

Client: THE FIRE DEPT.

Product: WD1OR-800

Title: CAVITY CLEARANCES - CONCRETE

Drawn: SR

Date: 31/05/2018

Chkd: JW

Date: 31/05/2018

Appd: JW

Date: 31/05/2018

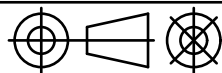

Scale: on A4

THE  
**FIRE  
DEPT.**

Drawing No. **WD1OR-800-908**

Sheet 08 of 15

Revision

4

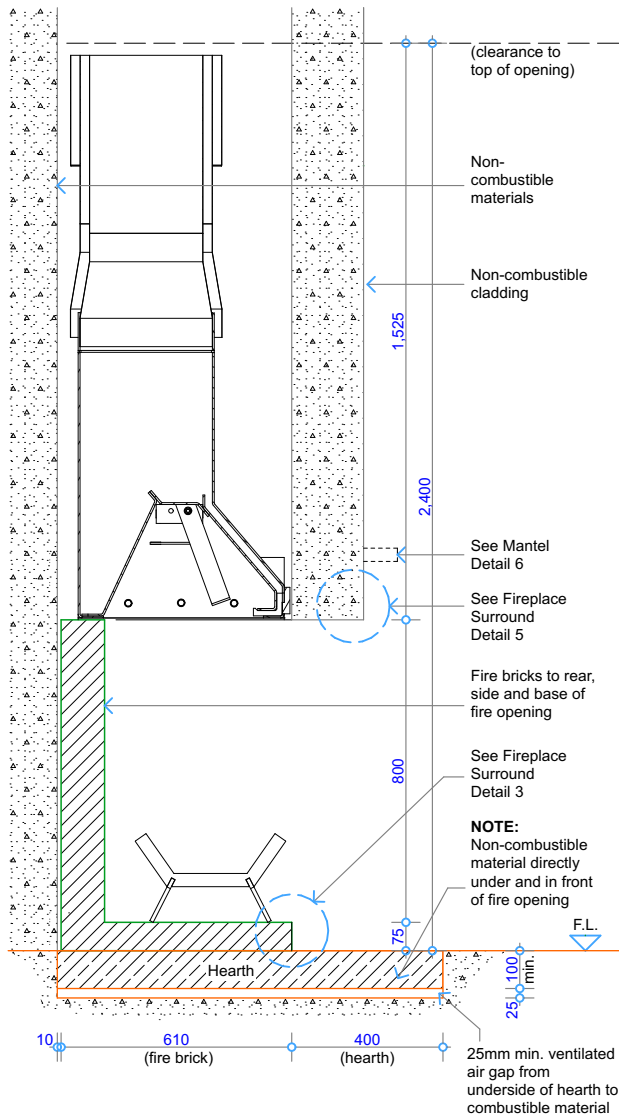

Cross Section - Fire Insert at Floor Level

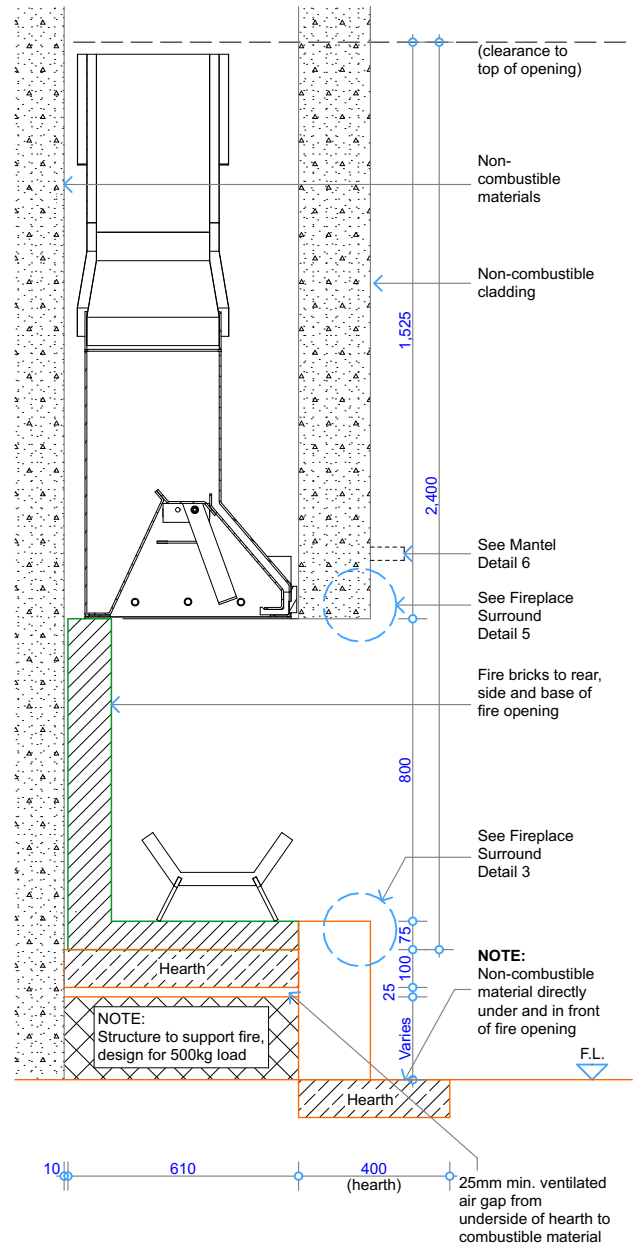

Cross Section - Fire Insert at Floor Level

NOTE:  
Room requires air inlet  
equal to 100,000mm<sup>2</sup>.

COPYRIGHT©  
THIS DRAWING IS THE PROPERTY  
OF The Fire Dept.

Client: THE FIRE DEPT.

Product: WD1OR-800

Title: CAVITY CLEARANCES - CONCRETE

Drawn: SR

Date: 31/05/2018

Chkd: JW

Date: 31/05/2018

Appd: JW

Date: 31/05/2018

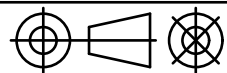

Scale: on A4

THE  
**FIRE  
DEPT.**

Drawing No. **WD1OR-800-909**

Sheet 09 of 15

Revision

4

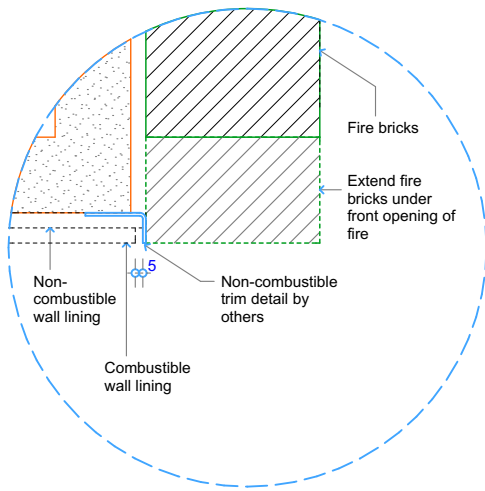

**Detail 1 - Plan View Fire Surround Opt. 1  
Timber Cavity**

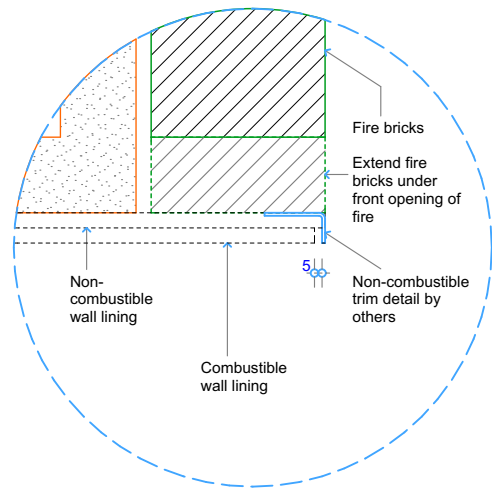

**Detail 1 - Plan View Fire Surround Opt. 2  
Timber Cavity**

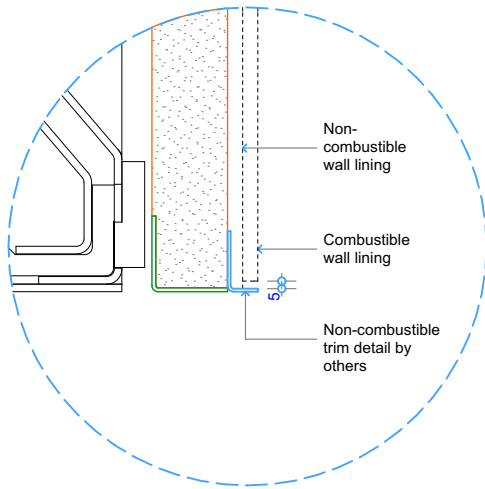

**Detail 2 - Cross Section Fire Surround Opt. 3  
Timber Cavity**

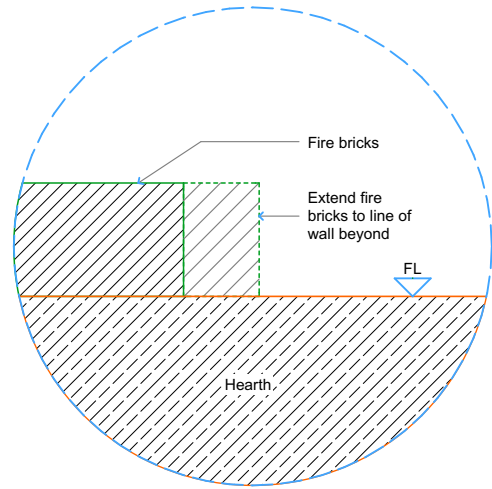

**Detail 3 - Cross Section Fire Surround Opt. 4  
Timber Cavity**

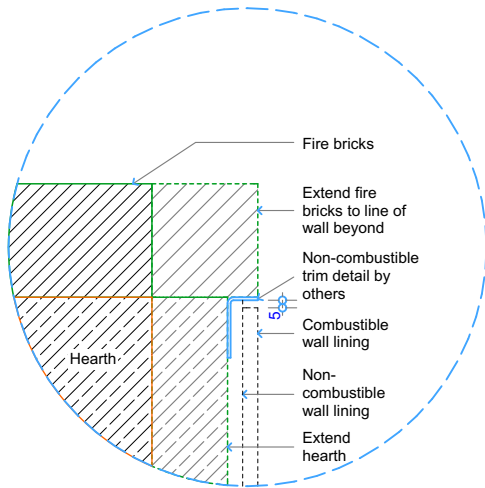

**Detail 3 - Cross Section Fire Surround Opt. 5  
Timber Cavity**

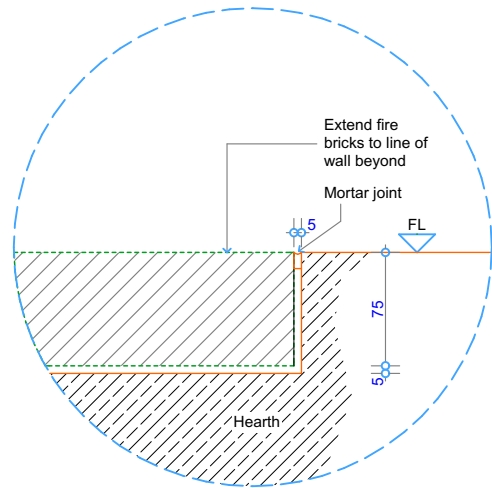

**Detail 3 - Cross Section Fire Surround Opt. 6  
Concrete Cavity**

COPYRIGHT© THIS DRAWING IS THE PROPERTY OF <b>The Fire Dept.</b>	Client: THE FIRE DEPT.				<b>THE FIRE DEPT.</b>			
	Product: WD1OR-800							
	Title: SURROUND DETAILS							
	Drawn: SR		Date: 31/05/2018					
	Chkd: JW		Date: 31/05/2018					
	Appd: JW		Date: 31/05/2018					
Drawing No.		WD1OR-800-910			Sheet 10 of 15		Revision <div>4</div>	

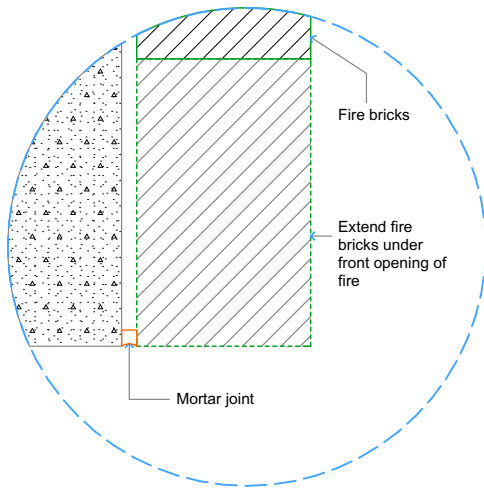

**Detail 4 - Plan View Fire Surround Opt. 7  
Concrete Cavity**

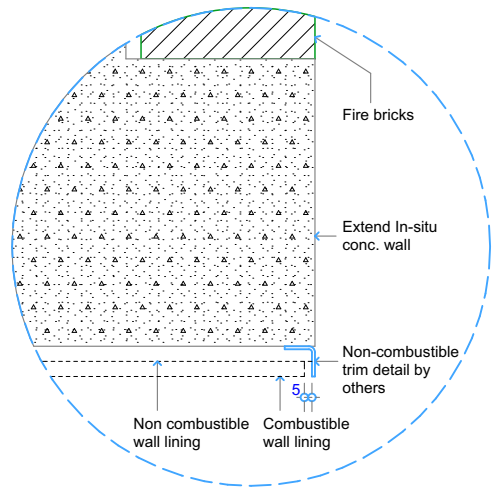

**Detail 4 - Plan View Fire Surround Opt. 8  
Concrete Cavity**

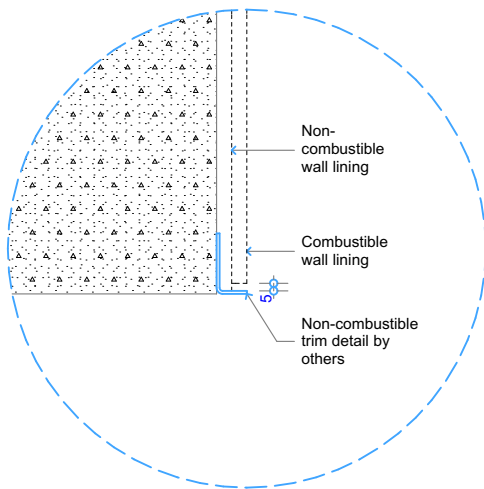

**Detail 5 - Cross Section Fire Surround Opt. 9  
Concrete Cavity**

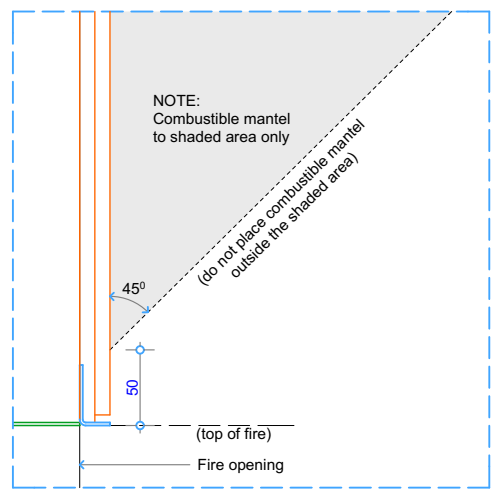

**Detail 6 - Top of Fire to Combustible Mantel**

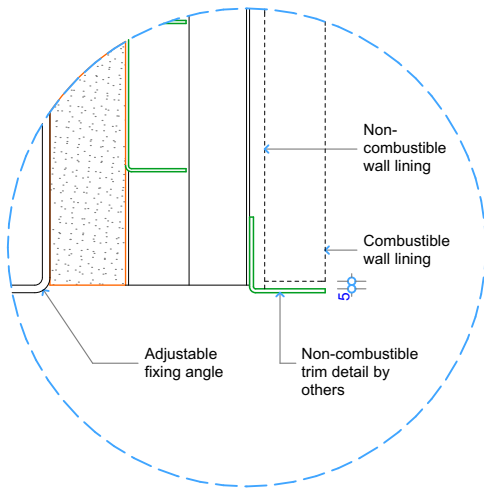

**Detail 7 - Cross Section Fire Surround  
Timber Cavity**

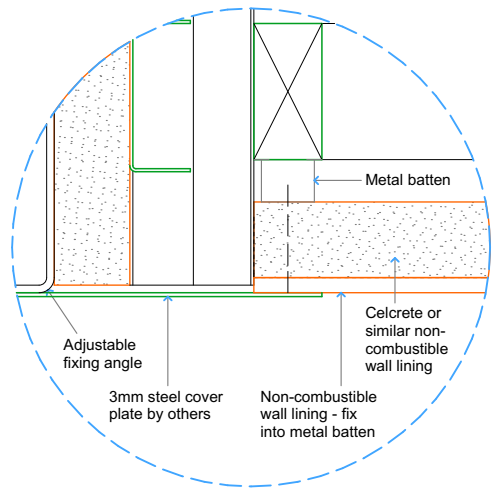

**Detail 7 - Cross Section Fire Surround Opt. 14  
Timber Cavity**

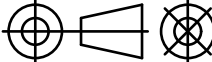
COPYRIGHT© THIS DRAWING IS THE PROPERTY OF <b>The Fire Dept.</b>	Client: THE FIRE DEPT.				<b>THE FIRE DEPT.</b>			
	Product: WD1OR-800							
	Title: SURROUND DETAILS							
	Drawn: SR	Date: 31/05/2018						
	Chkd: JW	Date: 31/05/2018						
	Appd: JW	Date: 31/05/2018	Scale:	on	A4			
Drawing No.		WD1OR-800-911			Sheet	11 of 15	Revision	<div>4</div>

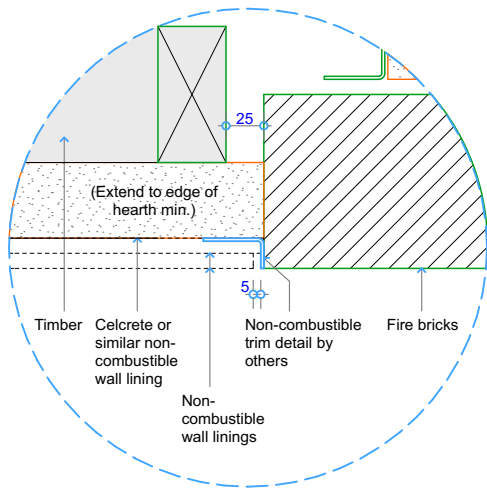

**Detail 8 - Plan View Fire Surround Opt. 10  
Timber Cavity**

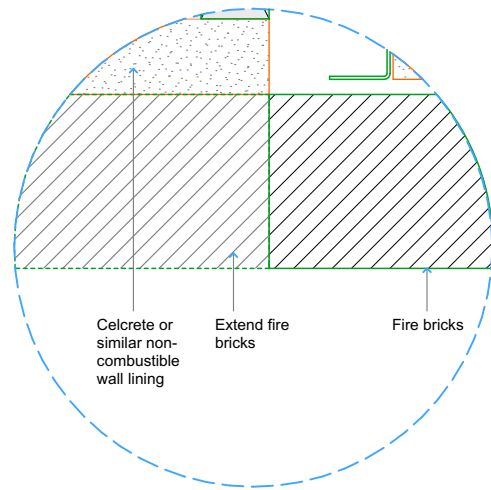

**Detail 8 - Plan View Fire Surround Opt. - 11  
Timber Cavity**

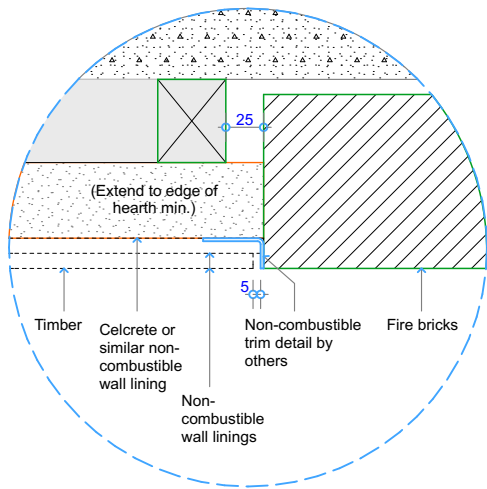

**Detail 9 - Plan View Fire Surround Opt. - 12  
Concrete Cavity**

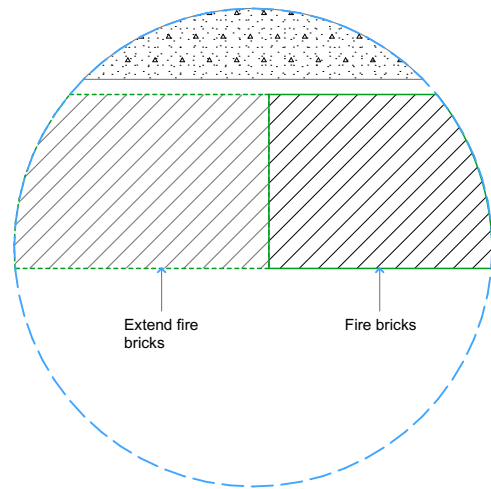

**Detail 9 - Plan View Fire Surround Opt. - 13  
Concrete Cavity**

COPYRIGHT©  
THIS DRAWING IS THE PROPERTY  
OF **The Fire Dept.**

Client: THE FIRE DEPT.

Product: WD1OR-800

Title: SURROUND DETAILS

Drawn: SR

Date: 31/05/2018

Chkd: JW

Date: 31/05/2018

Appd: JW

Date: 31/05/2018

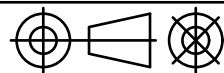

Scale: on A4

**THE FIRE  
DEPT.**

Drawing No. **WD1OR-800-912**

Sheet 12 of 15

Revision

4

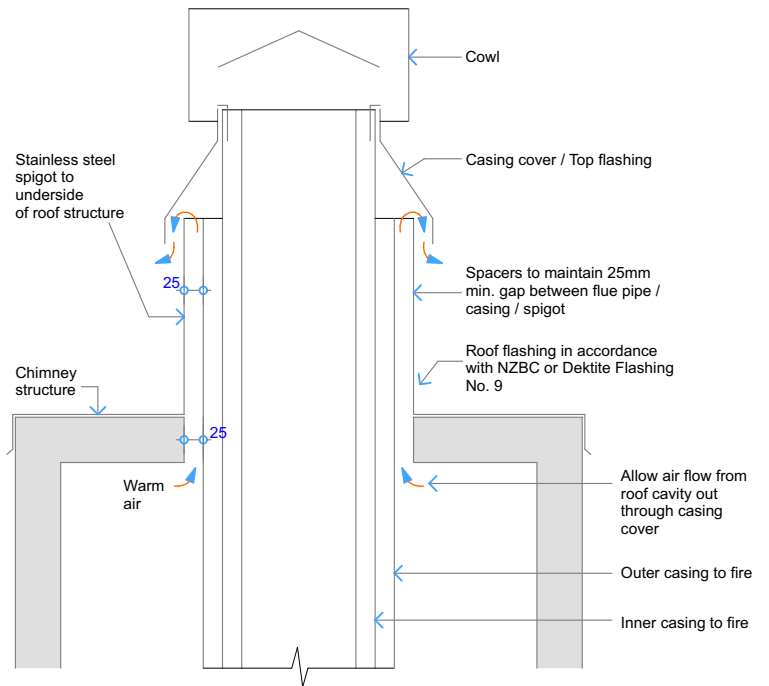
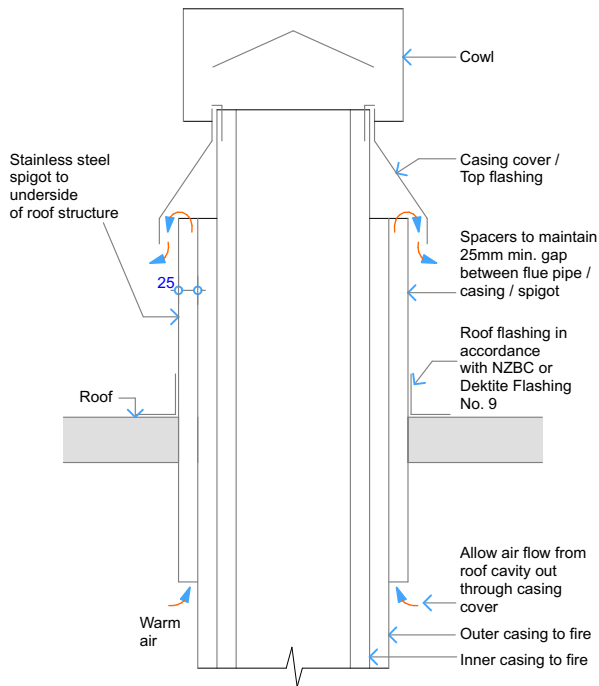

**Detail Roof - Air Ventilation through Casing cover/ Top flashing**

**Detail Chimney - Air Ventilation through Casing cover/ Top flashing Opt. 2**

Flue components:  
300mm dia. Flue  
350mm dia. Inner Casing  
400mm dia. Outer Casing  
450mm dia. S/S Spigot  
Deklite Flashing No. 9

**NOTE:**  
Flue components must be installed to AS/NZS2918:2001 requirements.  
All external penetration flashings must be installed in accordance with NZBC.  
Cavity airflow must be unobstructed from fire box to flue termination.  
25mm clearance between flue and combustible materials.  
75mm clearance between flue and wiring / plastic water pipes.  
Each flue joint must be sealed with a heat proof sealer.  
Each flue joint must have a minimum of 4 x Stainless Steel rivets.  
Flue to be adequately supported at 2m crs.

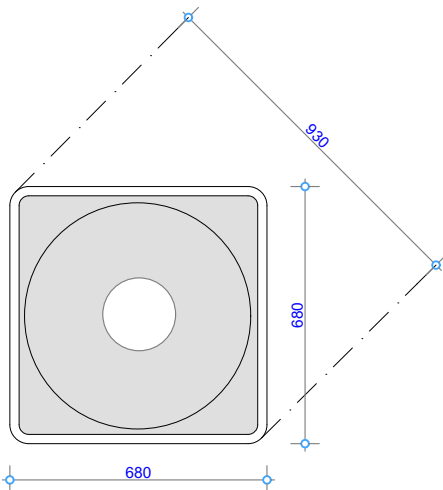

**Deklite Flashing No. 9 - Plan View**

COPYRIGHT© THIS DRAWING IS THE PROPERTY OF The Fire Dept.	Client: THE FIRE DEPT.					<div>THE FIRE DEPT.</div>		
	Product: WD1OR-800							
	Title: VERTICAL FLUE EXIT DETAILS							
	Drawn: SR		Date: 31/05/2018					
	Chkd: JW		Date: 31/05/2018					
	Appd: JW		Date: 31/05/2018					
			Scale:		on A4			
Drawing No.		WD1OR-800-913R			Sheet 13 of 15		Revision <div>4</div>	

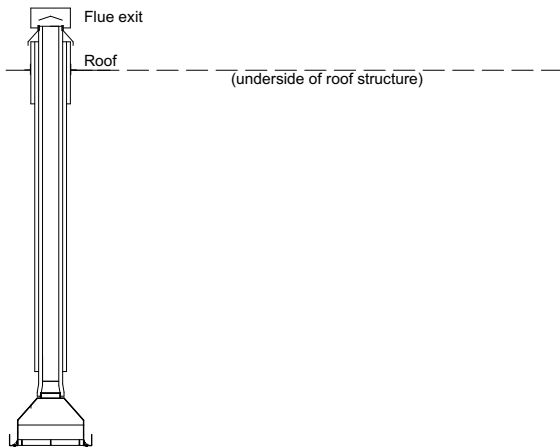

### Vertical Flue Combination WD1A

**NOTE:**

Flue components must be installed to AS/NZS2918:2001 requirements.  
All external penetration flashings must be installed in accordance with NZBC.  
Cavity airflow must be unobstructed from fire box to flue termination.  
25mm clearance between flue and combustible materials.  
75mm clearance between flue and wiring / plastic water pipes.  
Each flue joint must be sealed with a heat proof sealer.  
Each flue joint must have a minimum of 4 x Stainless Steel rivets.  
Flue to be adequately supported at 2m crs.

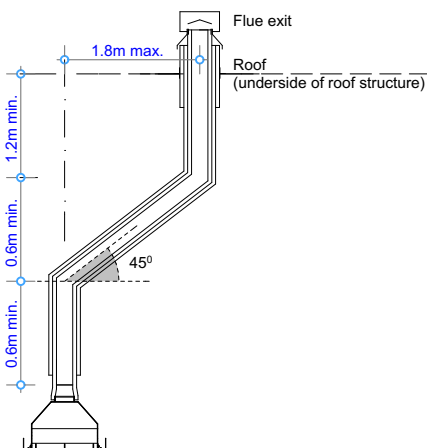

### Vertical Flue Combination WD1B

**NOTE:**

Flue components must be installed to AS/NZS2918:2001 requirements.  
All external penetration flashings must be installed in accordance with NZBC.  
Cavity airflow must be unobstructed from fire box to flue termination.  
25mm clearance between flue and combustible materials.  
75mm clearance between flue and wiring / plastic water pipes.  
Each flue joint must be sealed with a heat proof sealer.  
Each flue joint must have a minimum of 4 x Stainless Steel rivets.  
Flue to be adequately supported at 2m crs.

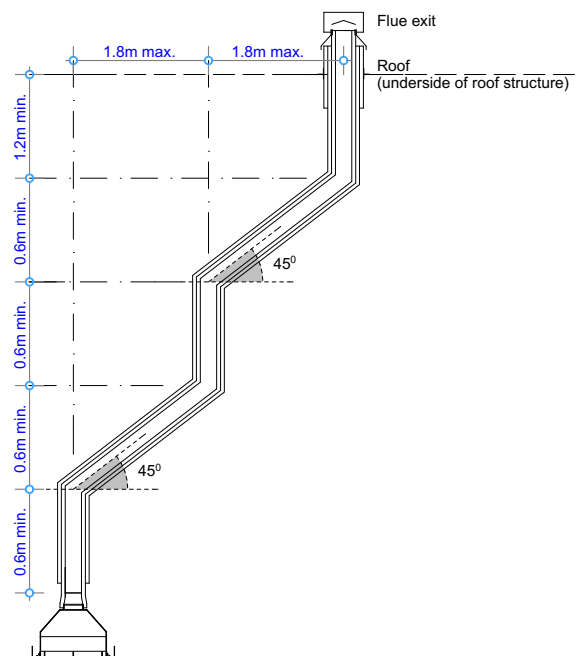

### Vertical Flue Combination WD1C

**NOTE:**

Flue components must be installed to AS/NZS2918:2001 requirements.  
All external penetration flashings must be installed in accordance with NZBC.  
Cavity airflow must be unobstructed from fire box to flue termination.  
25mm clearance between flue and combustible materials.  
75mm clearance between flue and wiring / plastic water pipes.  
Each flue joint must be sealed with a heat proof sealer.  
Each flue joint must have a minimum of 4 x Stainless Steel rivets.  
Flue to be adequately supported at 2m crs.

COPYRIGHT©  
THIS DRAWING IS THE PROPERTY  
OF The Fire Dept.

Client: THE FIRE DEPT.

Product: WD1OR-800

Title: VERTICAL FLUE COMBINATION OPTIONS

Drawn: SR

Date: 31/05/2018

Chkd: JW

Date: 31/05/2018

Appd: JW

Date: 31/05/2018

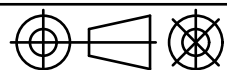

Scale: on A4

**THE FIRE DEPT.**

Drawing No. **WD1OR-800-914**

Sheet 14 of 15

Revision

4

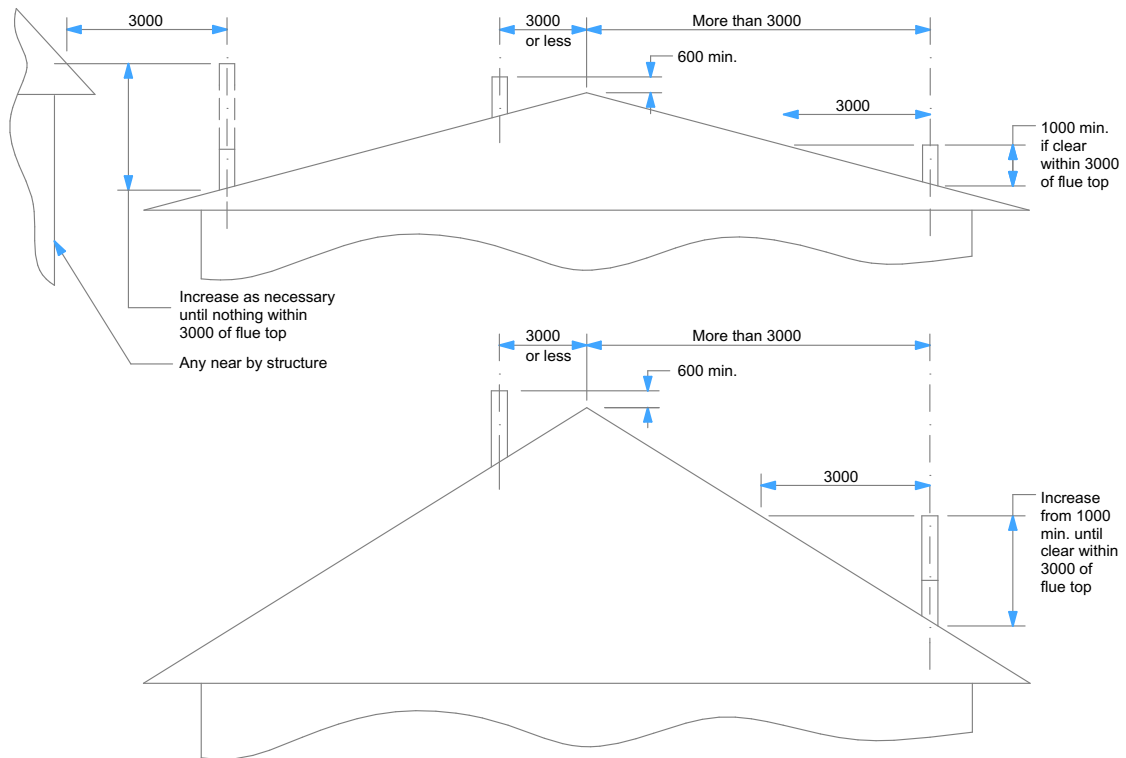

**Minimum Height of Flue System Exit**  
Or as per AS/NZS 2918:2001

COPYRIGHT©  
THIS DRAWING IS THE PROPERTY  
OF **The Fire Dept.**

Client: THE FIRE DEPT.

Product: WD1OR-800

Title: FLUE EXIT CLEARANCES

Drawn: SR

Date: 31/05/2018

Chkd: JW

Date: 31/05/2018

Appd: JW

Date: 31/05/2018

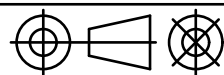

Scale: on A4

**THE FIRE DEPT.**

Drawing No. **WD1OR-800-915R**

Sheet 15 of 15

Revision **4**