

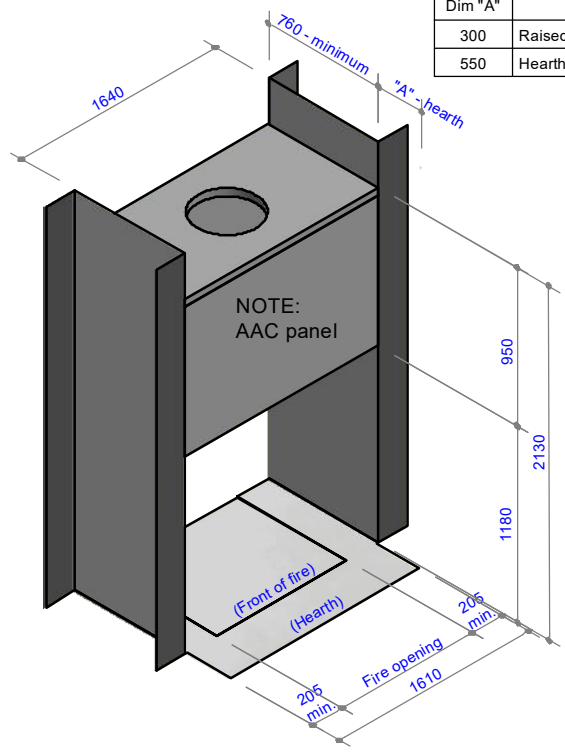

**WD2-1200**

**Specifications**

Dim "A"	DESCRIPTION
300	Raised hearth. Min 275mm high.
550	Hearth flush with floor.



Information in this specification may be subject to change without notice. Please ensure you have the current version before beginning installation.

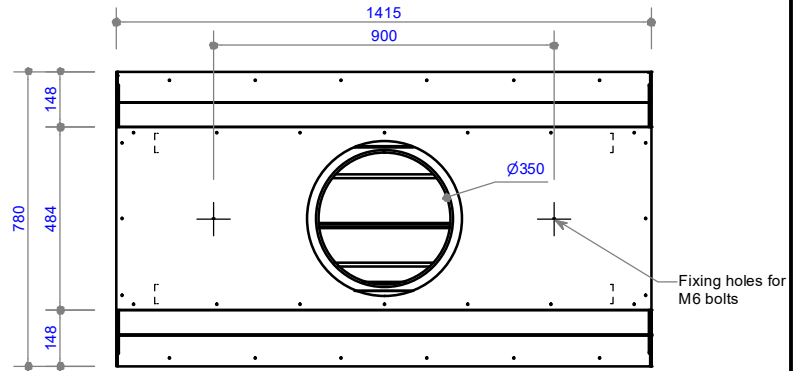

**Fire installation requirements & Hearth size - Timber cavity**  
 NOTE: Hearth to extend minimum of 205mm both sides of the fire opening, and 300mm from front of fire opening

Plan View

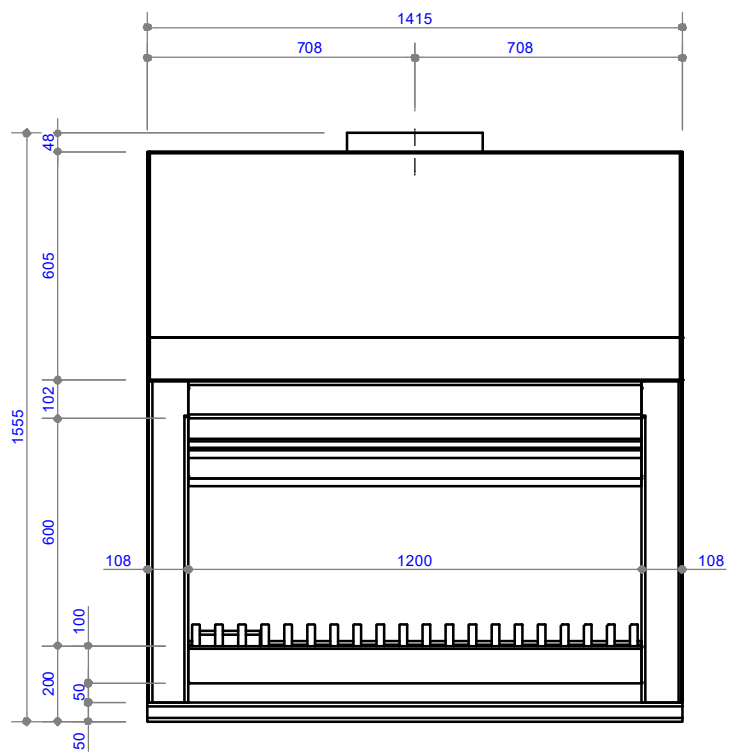
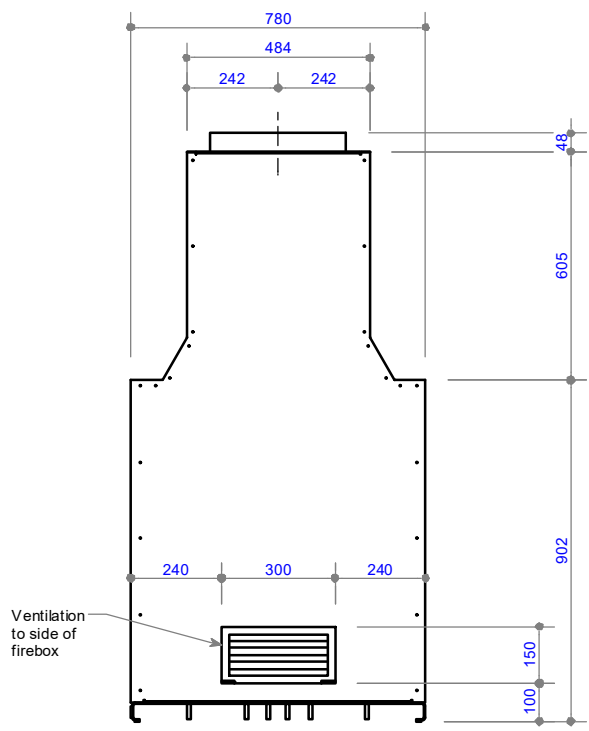

Side view

Front View

TOLERANCE = +/- 3mm

COPYRIGHT © THIS DRAWING IS THE PROPERTY OF The Fire Dept.	Client: THE FIRE DEPT.			
	Product: WD2-1200			
	Title: FIRE DIMENSIONS			
	Drawn: J.SCHOEMAN	Date: 24/08/2018		
	Chkd: J. WILSON	Date: 23/09/2018		
Appd: J. WILSON	Date: 23/09/2018			
Drawing No. WD2-1200-901	Sheet 1 of 9	Revision 2		

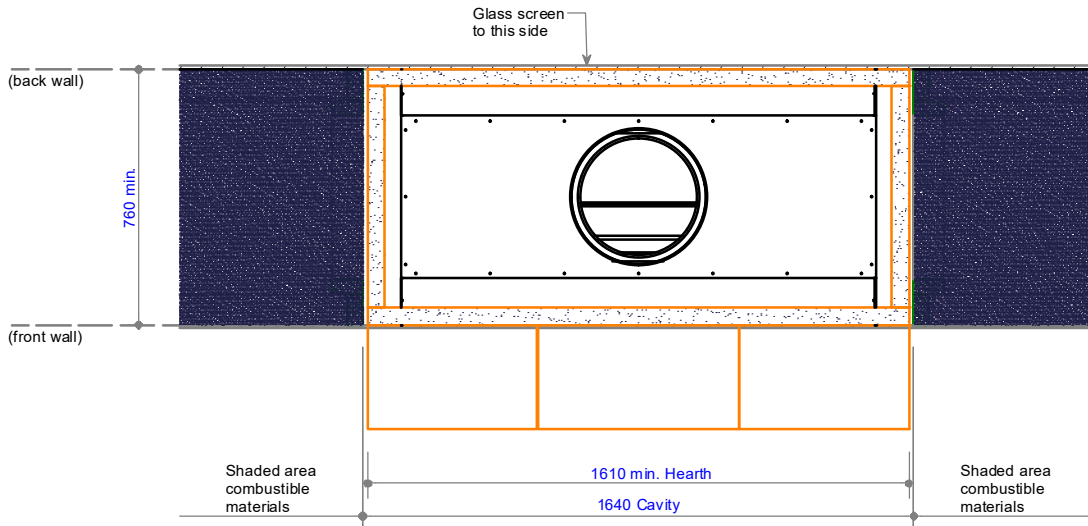

Plan View - Fire insert

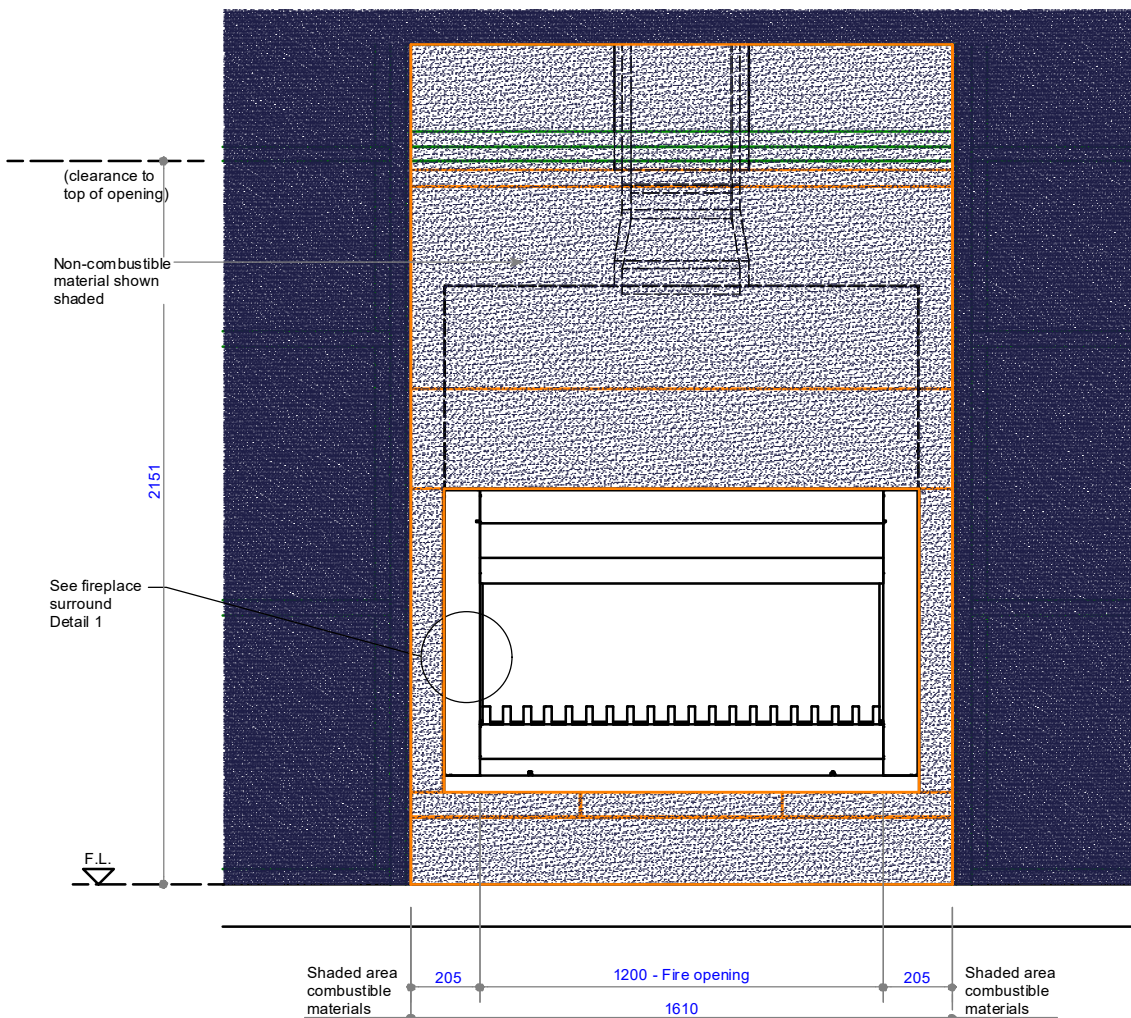

Front view - Fire insert

COPYRIGHT ©  
 THIS DRAWING IS THE PROPERTY  
 OF The Fire Dept.

Client: THE FIRE DEPT.	
Product: WD2-1200	
Title: CAVITY CLEARANCES - TIMBER	
Drawn: J SCHOEMAN	Date: 24/08/2018
Chkd: J. WILSON	Date: 23/09/2018
Appd: J. WILSON	Date: 23/09/2018
Scale: on A4	



Drawing No. <b>WD2-1200-902</b>	Sheet <b>2</b> of <b>9</b>	Revision <b>2</b>
---------------------------------	----------------------------	-------------------

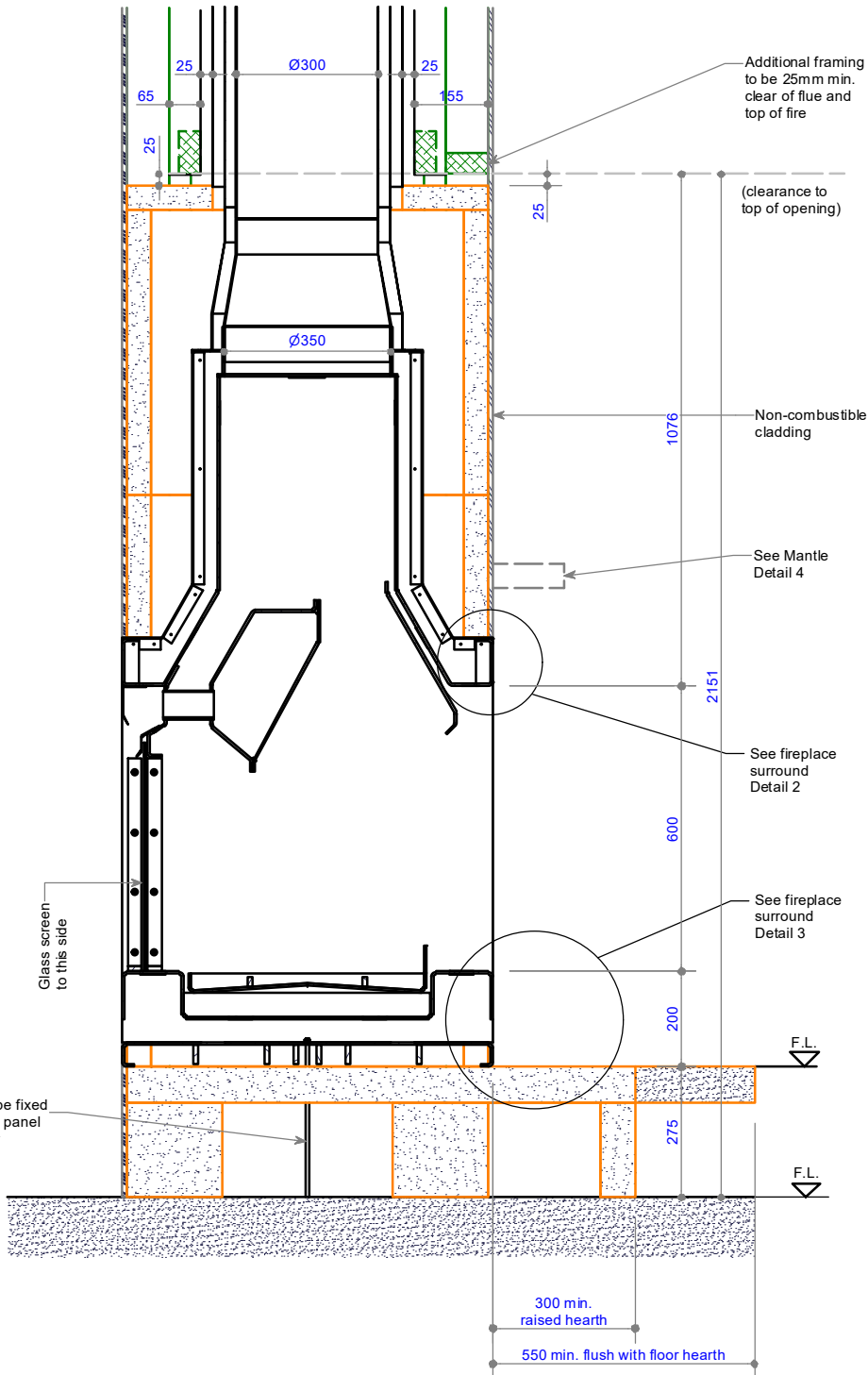

**Cross Section - Fire insert at floor level**

**COPYRIGHT©**  
THIS DRAWING IS THE PROPERTY  
OF **The Fire Dept.**

Client: THE FIRE DEPT.

Product: WD2-1200

Title: CAVITY CLEARANCES - TIMBER

Drawn: J.SCHOEMAN

Date: 24/08/2018

Chkd: J. WILSON

Date: 23/09/2018

Appd: J. WILSON

Date: 23/09/2018

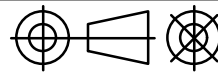

Scale: on A4

**THE FIRE DEPT.**  
**HAND CRAFTED FIRES**

Drawing No. **WD2-1200-903**

Sheet **3** of **9**

Revision **2**



**Option 1:**  
Inlet duct through side.  
Area equal or greater than 52 500mm<sup>2</sup>  
(e.g. 350mm x 150mm)  
Req'd both sides of fire

**Option 2:**  
Inlet duct through side.  
Area equal or greater than 52 500mm<sup>2</sup>  
(e.g. 350mm x 150mm)  
Req'd both sides of fire, or area equal or greater than 105 000mm<sup>2</sup>  
(e.g. 700mm x 350mm)  
Req'd from one side of fire.

**Option 3:**  
Inlet duct through floor.  
Area equal or greater than 105 000mm<sup>2</sup>  
(e.g. 700mm x 300mm)

**Option 1:**  
See note on left hand side.

**Option 2:**  
See note on left hand side.

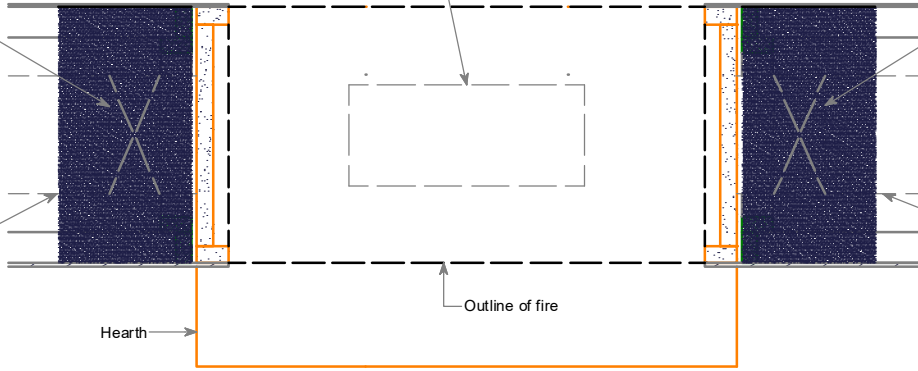

**Plan View**

**Option 1:**  
Inlet duct through side.  
Area equal or greater than 52 500mm<sup>2</sup>  
(e.g. 350mm x 150mm)  
Req'd both sides of fire

**Option 2:**  
Inlet duct through side.  
Area equal or greater than 52 500mm<sup>2</sup>  
(e.g. 350mm x 150mm)  
Req'd both sides of fire, or area equal or greater than 105 000mm<sup>2</sup>  
(e.g. 700mm x 350mm)  
Req'd from one side of fire.

**Option 1:**  
See note on left hand side.

**Option 2:**  
See note on left hand side.

ACC panel

F.L.

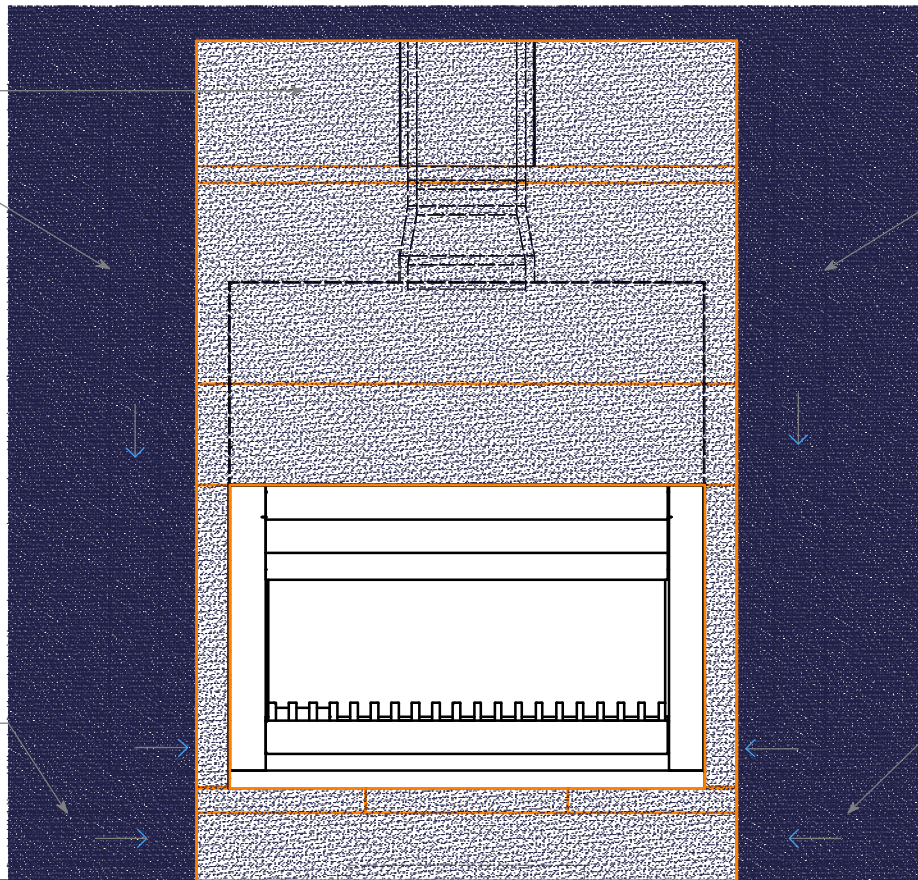

**Option 3:**  
Inlet duct through floor.  
Area equal or greater than 105 000mm<sup>2</sup>  
(e.g. 700mm x 300mm)

**Front view**

**NOTE - Air Introduction Requirements:**

Air introduction requirements are necessary to assist with the flow of air within the cavity surrounding the firebox. Air can be introduced from one of 3 locations as shown on the drawing above e.g. from above the fire, from side of fire at base and from underneath the fire. \*When introducing air via Options 2 & 3 the hearth will need to have openings cut at each end to allow air flow through the hearth and up to each side of the fire - See ACC panel cutting plan.

COPYRIGHT © THIS DRAWING IS THE PROPERTY OF The Fire Dept.	Client: THE FIRE DEPT.			<b>THE FIRE DEPT.</b> HAND CRAFTED FIRES
	Product: WD2-1200			
	Title: AIR INTRODUCTION REQUIREMENTS			
	Drawn: J.SCHOEMAN	Date: 24/08/2018		
	Chkd: J. WILSON	Date: 23/09/2018		
Appd: J. WILSON	Date: 23/09/2018	Scale: on A4		
Drawing No.	WD2-1200-904		Sheet 4 of 9	Revision <span style="border: 1px solid black; padding: 2px;">2</span>

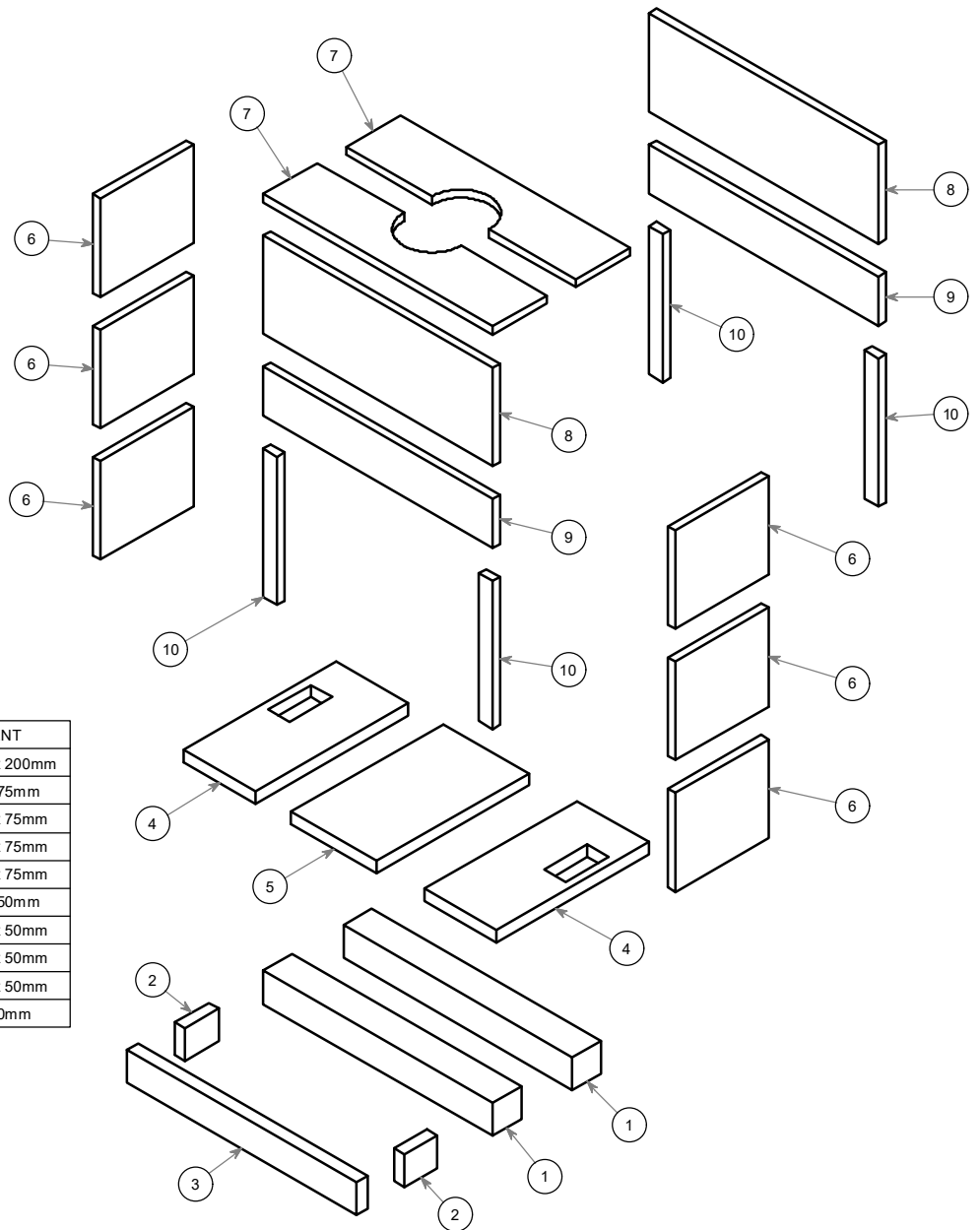

**ACC panel - Cutting plan**

ITEM	QTY	DESCRIPTION	MEASUREMENT
1	2	Base panel 1	200mm x 1610mm x 200mm
2	2	Base panel 2	200mm x 235mm x 75mm
3	1	Base panel 3	200mm x 1610mm x 75mm
4	2	Base panel 4	505mm x 1070mm x 75mm
5	1	Base panel 5	600mm x 1070mm x 75mm
6	6	Side panel	600mm x 658mm x 50mm
7	2	Top panel	380mm x 1610mm x 50mm
8	2	Front panel - Upper	600mm x 1610mm x 50mm
9	2	Front panel - middel	298mm x 1610mm x 50mm
10	4	Front panel - lower	97mm x 902mm x 50mm

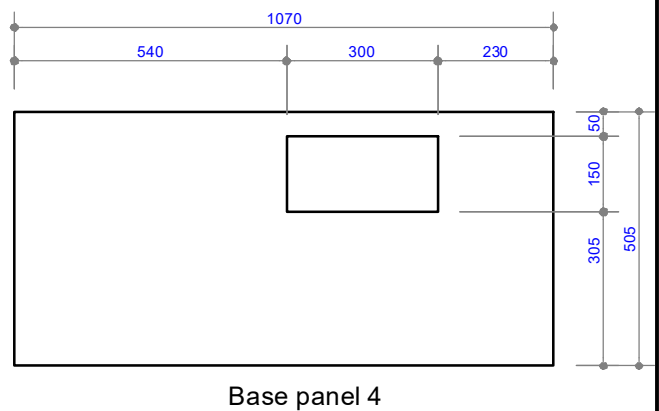
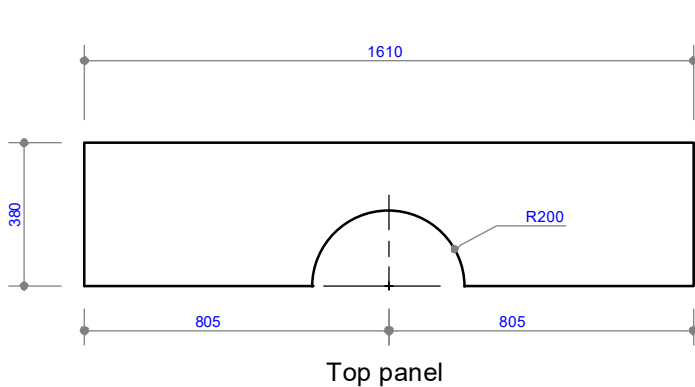

COPYRIGHT ©  
 THIS DRAWING IS THE PROPERTY  
 OF **The Fire Dept.**

Client: THE FIRE DEPT.

Product: WD2-1200

Title: AAC PANEL CUTTING PLAN - TIMBER CAVITY

Drawn: J.SCHOEMAN

Date: 24/08/2018

Chkd: J. WILSON

Date: 23/09/2018

Appd: J. WILSON

Date: 23/09/2018

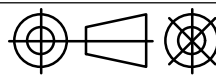

Scale: on A4



Drawing No. **WD2-1200-905**

Sheet 5 of 9

Revision **2**

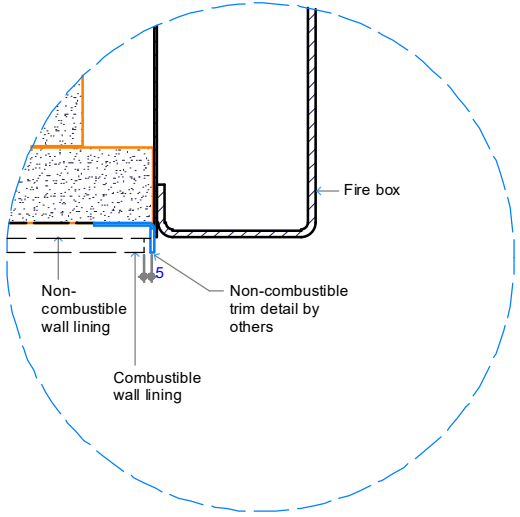

Detail 1 - Plan View Fire Surround Opt. 1  
Timber Cavity

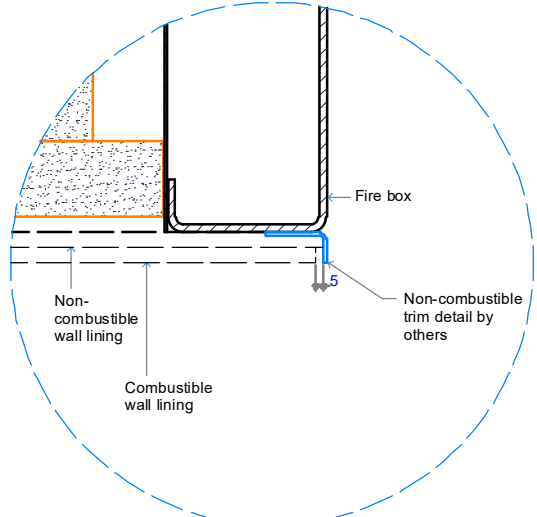

Detail 1 - Plan View Fire Surround Opt. 2  
Timber Cavity

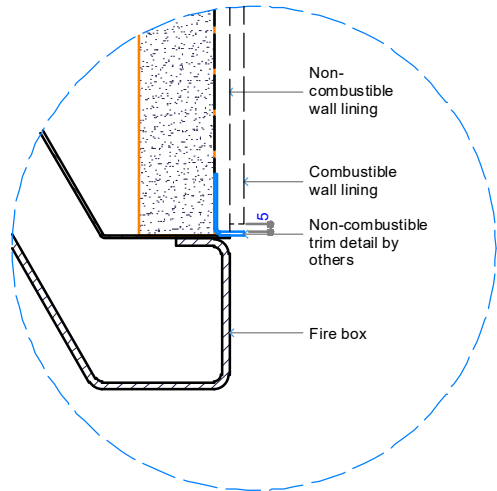

Detail 2 - Cross Section Fire Surround Opt. 3  
Timber Cavity

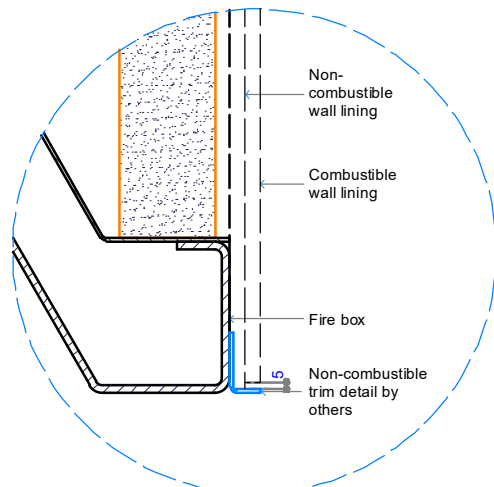

Detail 2 - Cross Section Fire Surround Opt. 4  
Timber Cavity

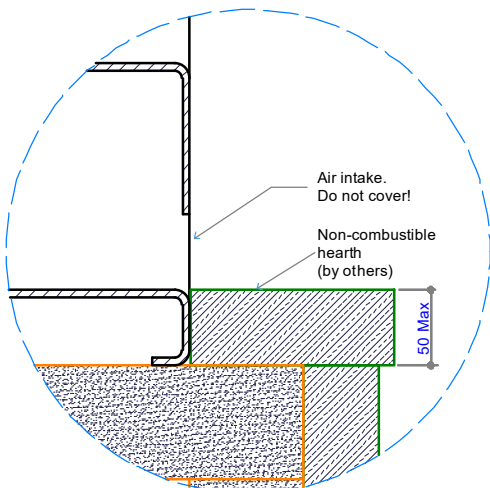

Detail 3 - Cross Section Fire Surround Opt. 5  
Timber Cavity

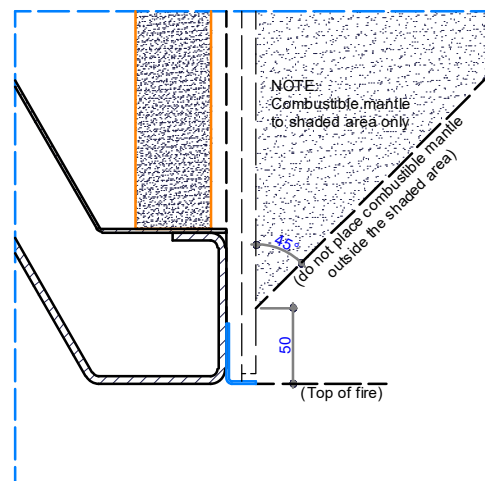

Detail 4 - Top of Fire to Combustible Mantel

COPYRIGHT©  
THIS DRAWING IS THE PROPERTY  
OF The Fire Dept.

Client: THE FIRE DEPT.

Product: WD2-1200

Title: SURROUND DETAILS

Drawn: J.SCHOEMAN

Date: 24/08/2018

Chkd: J. WILSON

Date: 23/09/2018

Appd: J. WILSON

Date: 23/09/2018

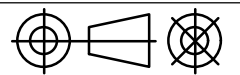

Scale: on A4

**THE FIRE DEPT.**  
**HAND CRAFTED FIRES**

Drawing No. **WD2-1200-906**

Sheet 6 of 9

Revision **2**

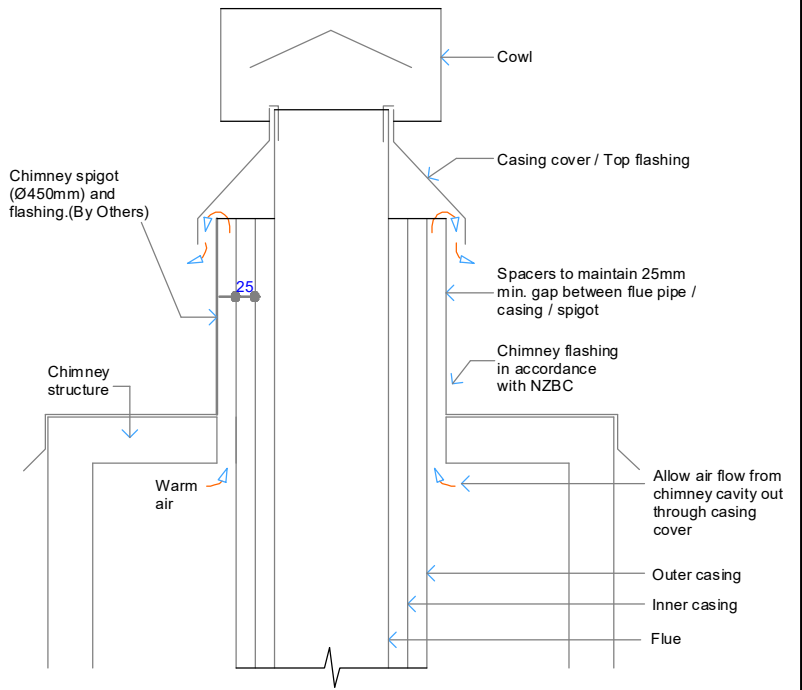
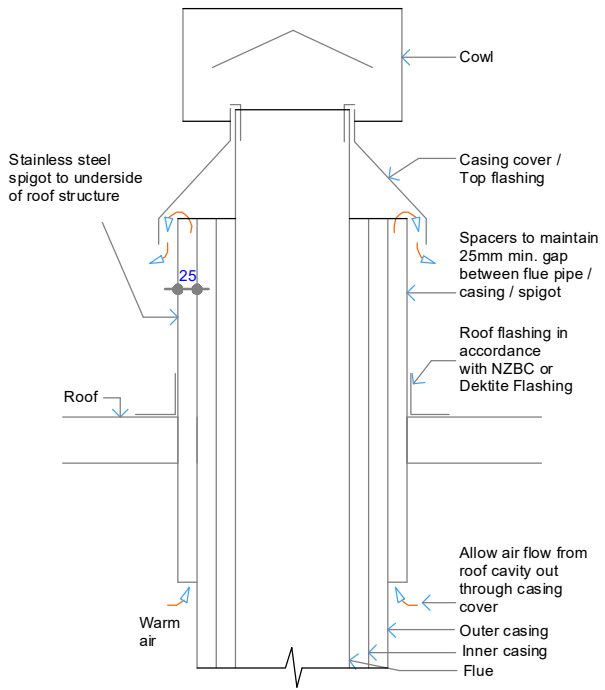

**Detail Roof - Air Ventilation through Casing cover / Top flashing**

**Detail Chimney - Air Ventilation through Casing cover / Top flashing Opt. 2**

Flue components:  
 300mm dia. Flue  
 350mm dia. Inner Casing  
 400mm dia. Outer Casing  
 450mm dia. S/S Spigot  
 Deklite Flashing No. 9

NOTE:  
 Flue components must be installed to AS/NZS2918:2001 requirements.  
 All external penetration flashings must be installed in accordance with NZBC.  
 Cavity airflow must be unobstructed from fire box to flue termination.  
 25mm clearance between flue and combustible materials.  
 75mm clearance between flue and wiring / plastic water pipes.  
 Each flue joint must be sealed with a heat proof sealer.  
 Each flue joint must have a minimum of 4 x Stainless Steel rivets.  
 Flue to be adequately supported at 2m crs.

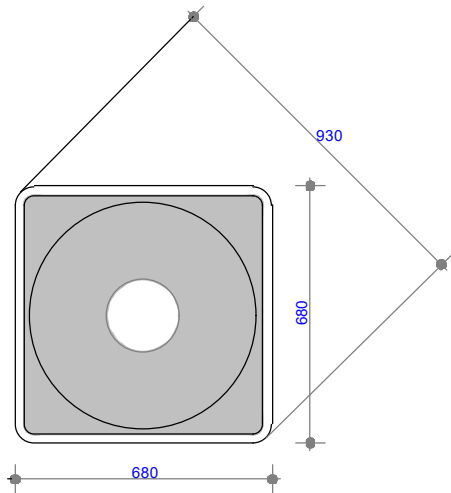

**Deklite Flashing No. 9 - Plan View**

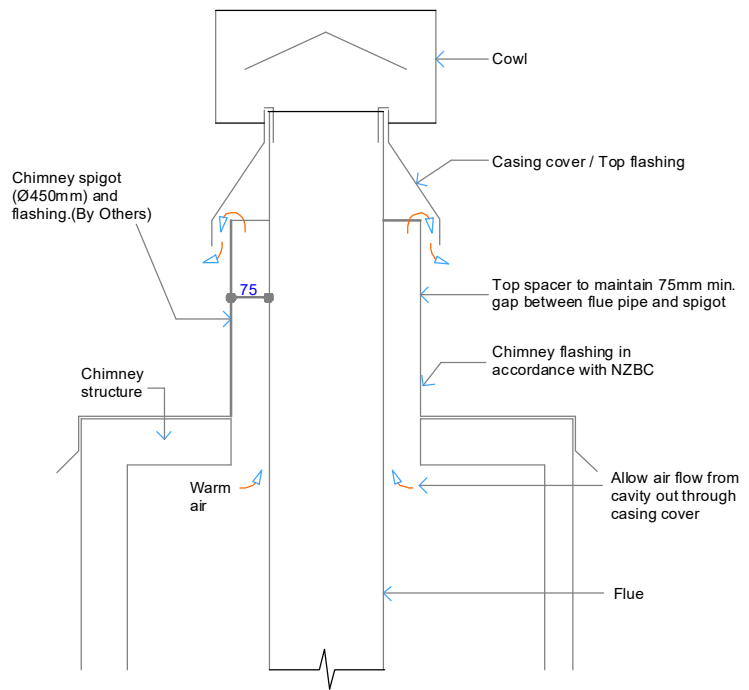

**Detail Chimney - Air Ventilation through Casing cover / Top flashing Opt. 3 (CONCRETE ONLY!)**

Flue components:  
 300mm dia. Flue  
 450mm dia. Spigot

COPYRIGHT ©  
 THIS DRAWING IS THE PROPERTY  
 OF The Fire Dept.

Client: THE FIRE DEPT.	
Product: WD2-1200	
Title: VERTICAL FLUE EXIT DETAILS	
Drawn: J.SCHOEMAN	Date: 24/08/2018
Chkd: J. WILSON	Date: 23/09/2018
Appd: J. WILSON	Date: 23/09/2018
Scale:	on A4



Drawing No. <b>WD2-1200-907</b>	Sheet <b>7</b> of <b>9</b>	Revision <b>2</b>
---------------------------------	----------------------------	-------------------



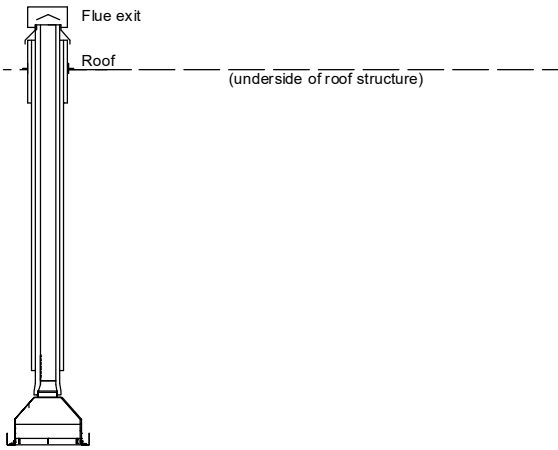

**Vertical Flue Combination WD2A**

**NOTE:**  
 Flue components must be installed to AS/NZS2918:2001 requirements.  
 All external penetration flashings must be installed in accordance with NZBC.  
 Cavity airflow must be unobstructed from fire box to flue termination.  
 25mm clearance between flue and combustible materials.  
 75mm clearance between flue and wiring / plastic water pipes.  
 Each flue joint must be sealed with a heat proof sealer.  
 Each flue joint must have a minimum of 4 x Stainless Steel rivets.  
 Flue to be adequately supported at 2m crs.

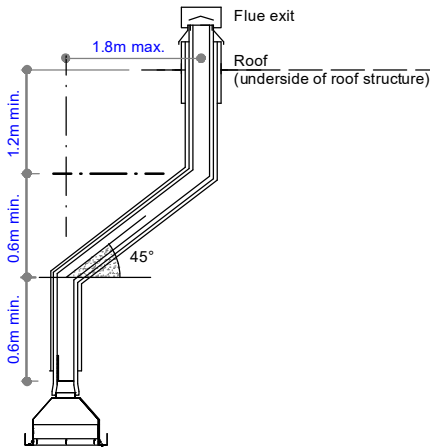

**Vertical Flue Combination WD2B**

**NOTE:**  
 Flue components must be installed to AS/NZS2918:2001 requirements.  
 All external penetration flashings must be installed in accordance with NZBC.  
 Cavity airflow must be unobstructed from fire box to flue termination.  
 25mm clearance between flue and combustible materials.  
 75mm clearance between flue and wiring / plastic water pipes.  
 Each flue joint must be sealed with a heat proof sealer.  
 Each flue joint must have a minimum of 4 x Stainless Steel rivets.  
 Flue to be adequately supported at 2m crs.

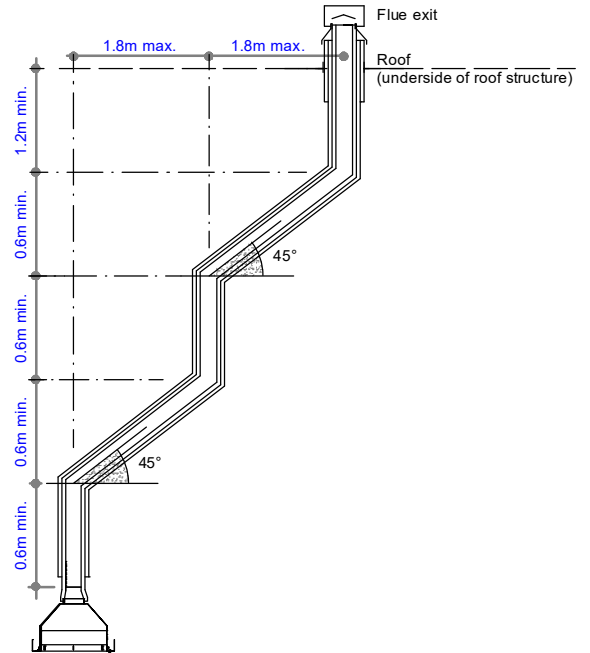

**Vertical Flue Combination WD2C**

**NOTE:**  
 Flue components must be installed to AS/NZS2918:2001 requirements.  
 All external penetration flashings must be installed in accordance with NZBC.  
 Cavity airflow must be unobstructed from fire box to flue termination.  
 25mm clearance between flue and combustible materials.  
 75mm clearance between flue and wiring / plastic water pipes.  
 Each flue joint must be sealed with a heat proof sealer.  
 Each flue joint must have a minimum of 4 x Stainless Steel rivets.  
 Flue to be adequately supported at 2m crs.

COPYRIGHT ©  
 THIS DRAWING IS THE PROPERTY  
 OF The Fire Dept.

Client: THE FIRE DEPT.	
Product: WD2-1200	
Title: VERTICAL FLUE COMBINATION OPTIONS	
Drawn: J.SCHOEMAN	Date: 24/08/2018
Chkd: J. WILSON	Date: 23/09/2018
Appd: J. WILSON	Date: 23/09/2018
Scale:	on A4



Drawing No. <b>WD2-1200-908</b>	Sheet <b>8</b> of <b>9</b>	Revision <b>2</b>
---------------------------------	----------------------------	-------------------



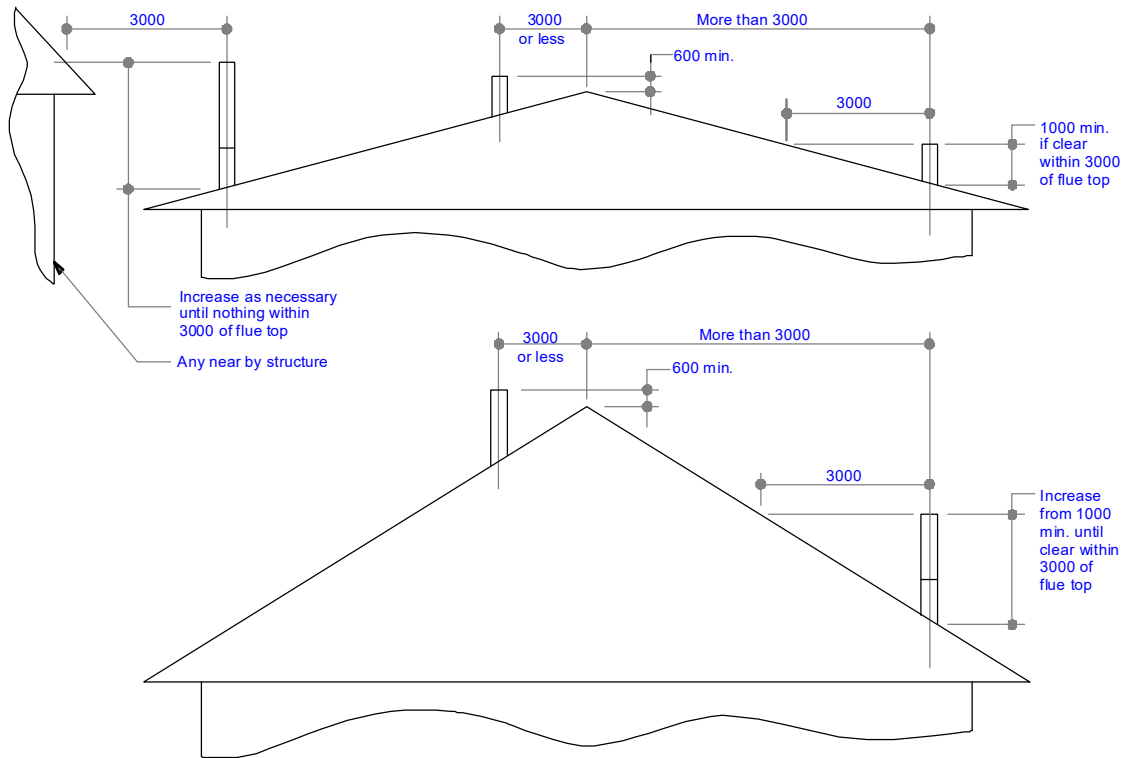

**Minimum Height of Flue System Exit**  
Or as per AS/NZS 2918:2001

COPYRIGHT ©  
 THIS DRAWING IS THE PROPERTY  
 OF **The Fire Dept.**

Client: THE FIRE DEPT.

Product: WD2-1200

Title: FLUE EXIT CLEARANCES

Drawn: J.SCHOEMAN

Date: 24/08/2018

Chkd: J. WILSON

Date: 23/09/2018

Appd: J. WILSON

Date: 23/09/2018

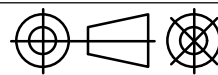

Scale: on A4



Drawing No. **WD2-1200-909**

Sheet 9 of 9

Revision **2**