

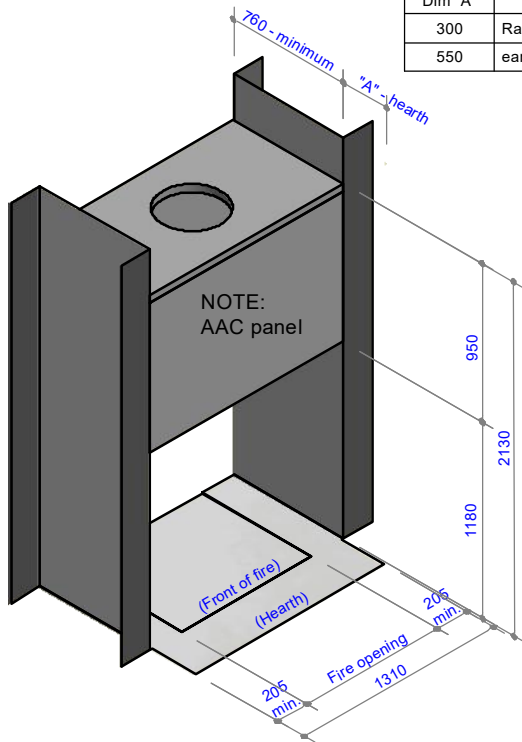

WD2-900

Specifications

| Dim "A" | DESCRIPTION |
|---------|-------------------------------|
| 300 | Raise hearth. Min 275mm high. |
| 550 | earth flush with floor |



Information in this specification may be subject to change without notice. Please ensure you have the current version before beginning installation.

Fire installation requirements & Hearth size - Timber cavity

NOTE: Hearth to extend minimum of 205mm both sides of the fire opening, and 300mm from front of fire opening

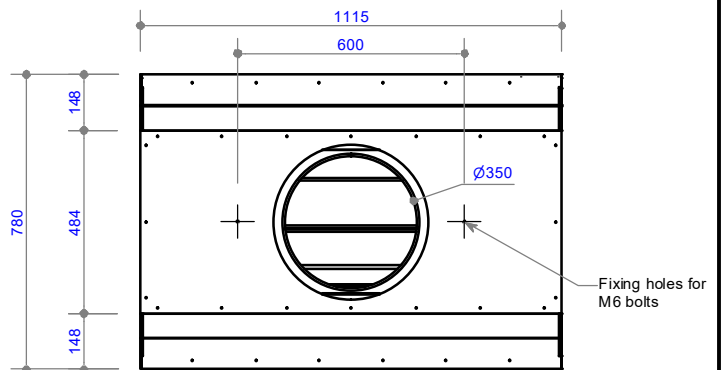

Plan View

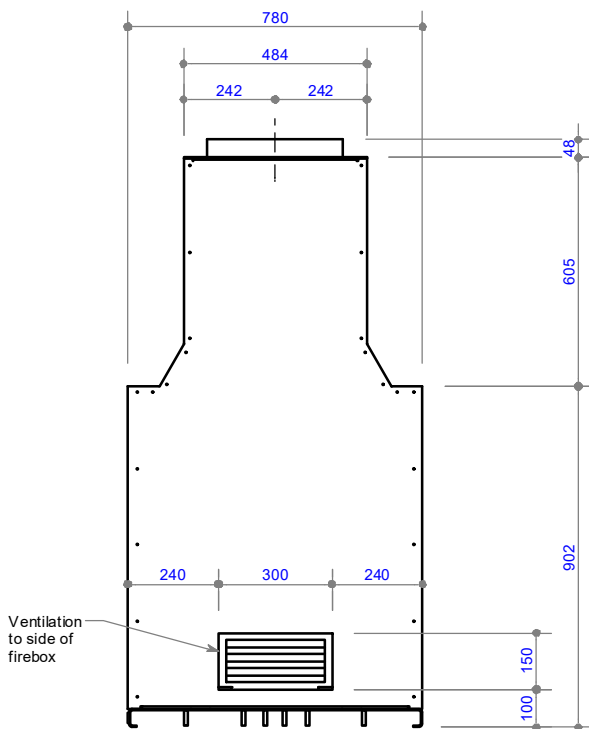

Side view

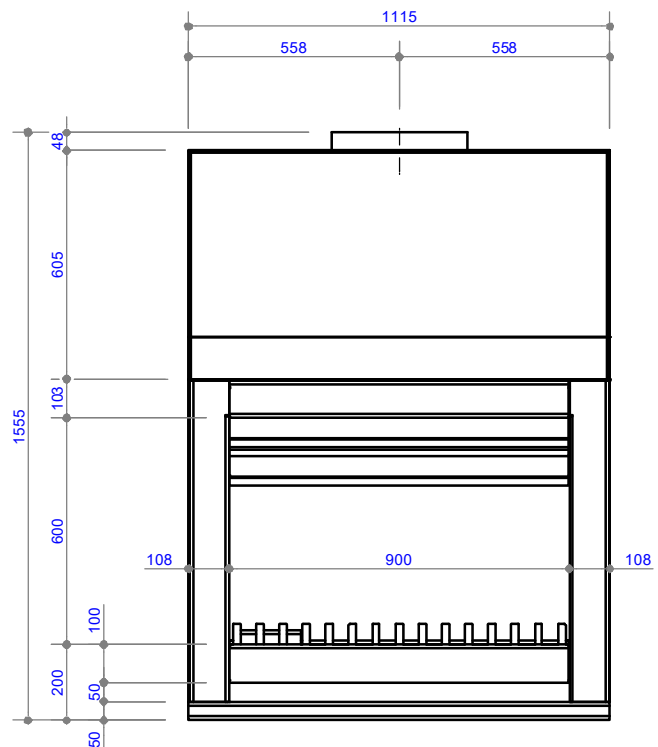

Front View

TOLERANCE = +/- 3mm

COPYRIGHT©
THIS DRAWING IS THE PROPERTY
OF The Fire Dept.

Client: THE FIRE DEPT.

Product: WD2-0900

Title: FIRE DIMENSIONS

Drawn: J.SCHOEMAN

Date: 24/08/2018

Chkd: J. WILSON

Date: 23/09/2018

Appd: J. WILSON

Date: 23/09/2018

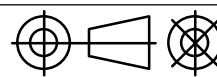

THE
**FIRE
DEPT.**
HAND CRAFTED FIRES

Drawing No. **WD2-0900-901**

Sheet 1 of 9

Revision **2**

WD2-0900-901.idw

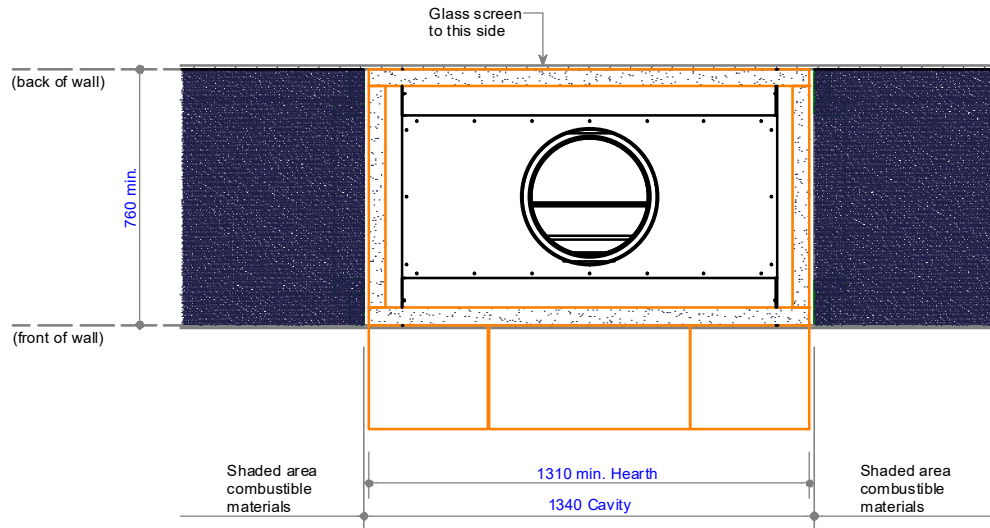

Plan View - Fire insert

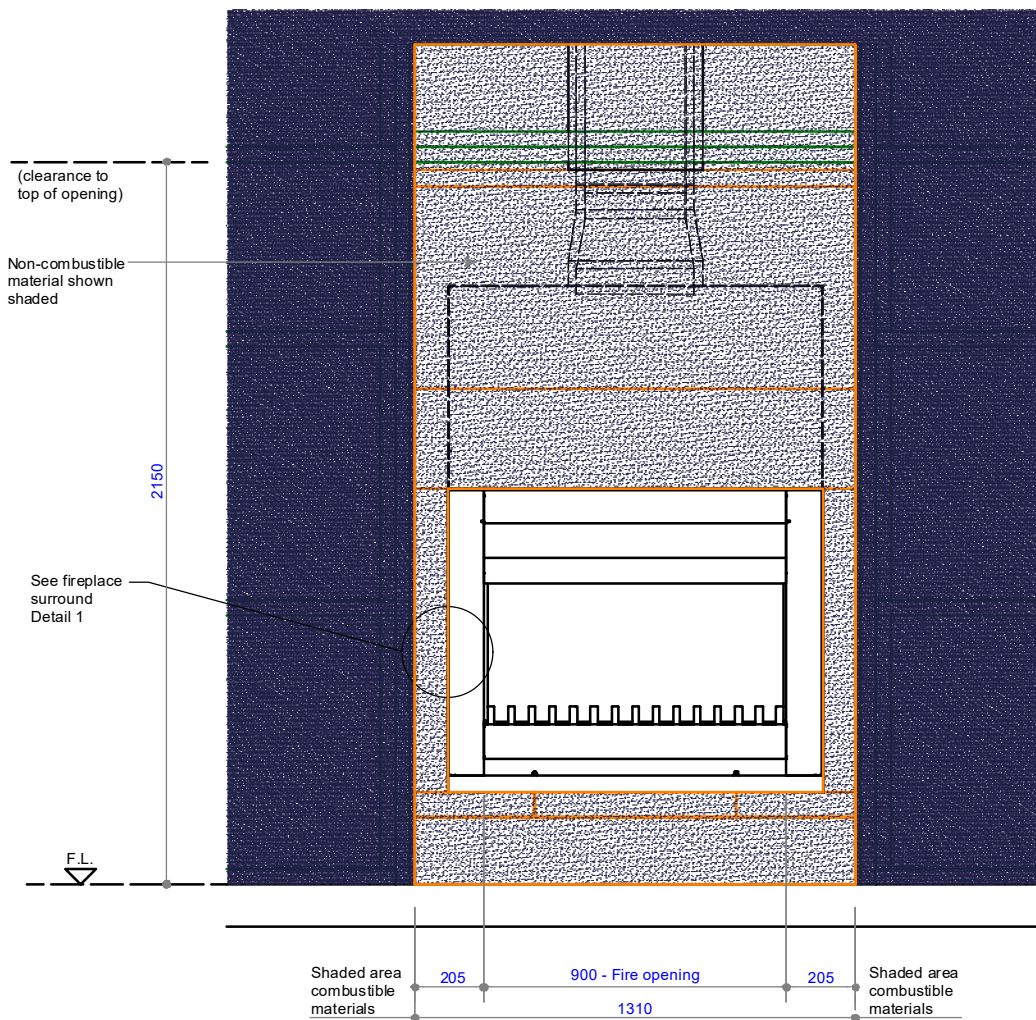

Front view - Fire insert

COPYRIGHT©
THIS DRAWING IS THE PROPERTY
OF The Fire Dept.

Client: THE FIRE DEPT.

Product: WD2-0900

Title: CAVITY CLEARANCES - TIMBER

Drawn: J SCHOEMAN

Date: 24/08/2018

Chkd: J. WILSON

Date: 23/09/2018

Appd: J. WILSON

Date: 23/09/2018

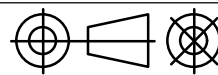

Scale: on A4

THE FIRE DEPT.
HAND CRAFTED FIRES

Drawing No. **WD2-0900-902**

Sheet 2 of 9

Revision **2**

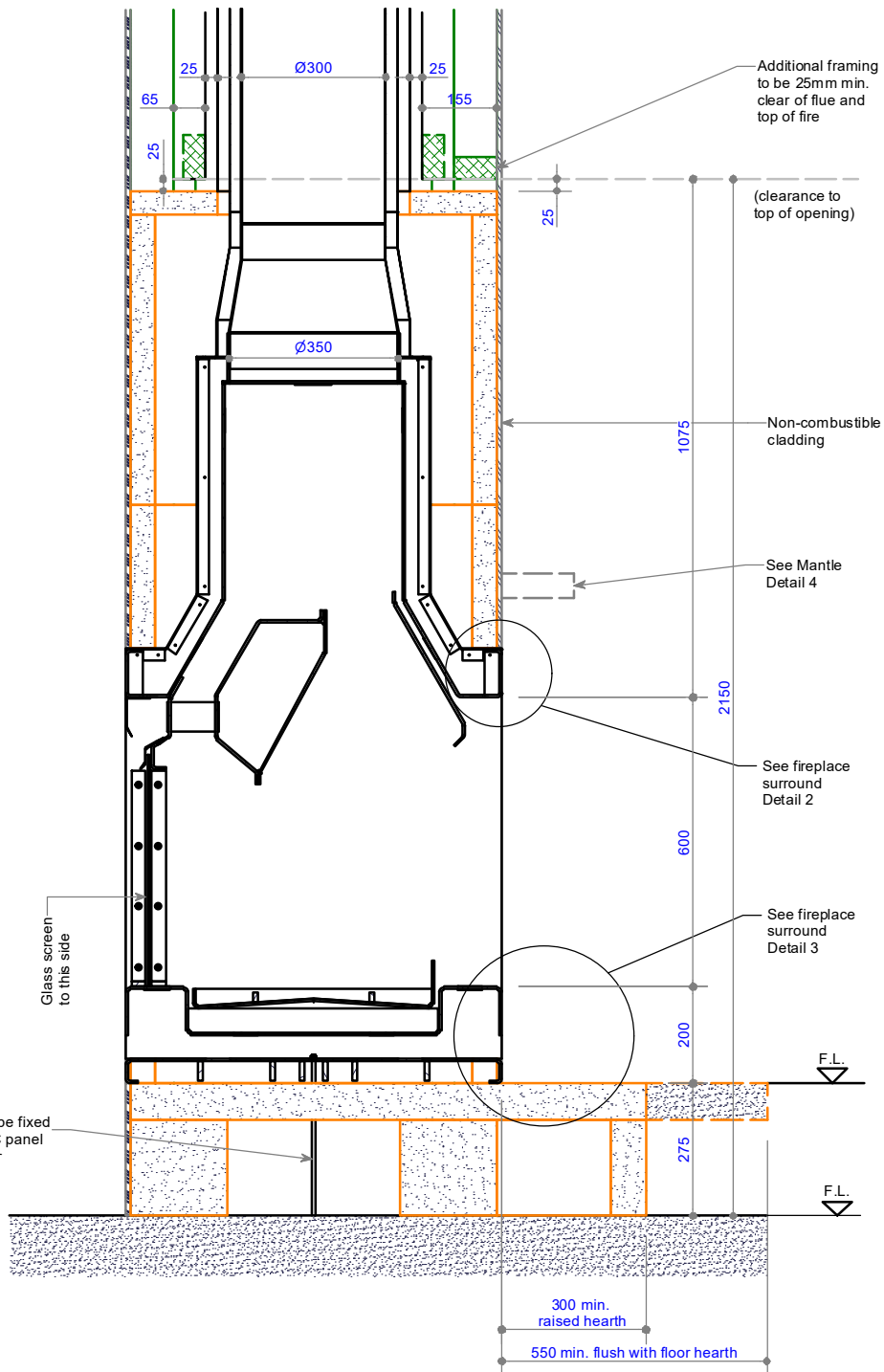

Cross Section - Fire insert at floor level

COPYRIGHT©
THIS DRAWING IS THE PROPERTY
OF **The Fire Dept.**

Client: THE FIRE DEPT.

Product: WD2-0900

Title: CAVITY CLEARANCES - TIMBER

Drawn: J.SCHOEMAN

Date: 24/08/2018

Chkd: J. WILSON

Date: 23/09/2018

Appd: J. WILSON

Date: 23/09/2018

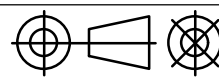

Scale: on A4

THE FIRE DEPT.
HAND CRAFTED FIRES

Drawing No. **WD2-0900-903**

Sheet 3 of 9

Revision **2**

Option 1:
Inlet duct through side.
Area equal or greater
than 52 500mm²
(e.g. 350mm x 150mm)
Req'd both sides of fire

Option 2:
Inlet duct through side.
Area equal or greater
than 52 500mm²
(e.g. 350mm x 150mm)
Req'd both sides of fire,
or area equal or greater
than 105 000mm²
(e.g. 700mm x 350mm)
Req'd from one side of fire.

Option 3:
Inlet duct through floor.
Area equal or greater
than 105 000mm²
(e.g. 700mm x 300mm)

Option 1:
See note on left hand side.

Option 2:
See note on left hand side.

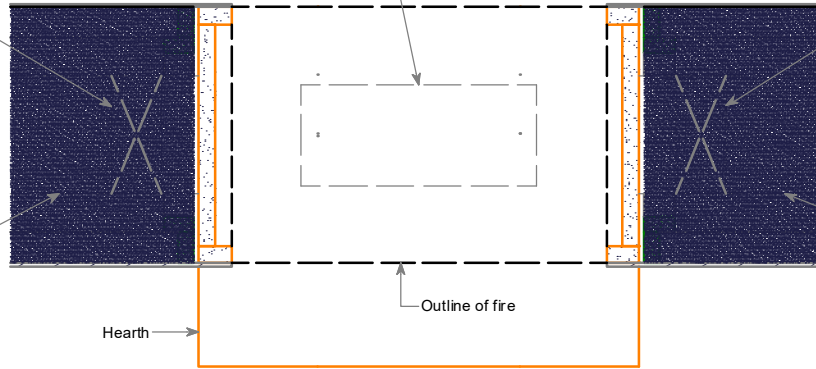

Plan View

Option 1:
Inlet duct through side.
Area equal or greater
than 52 500mm²
(e.g. 350mm x 150mm)
Req'd both sides of fire

Option 2:
Inlet duct through side.
Area equal or greater
than 52 500mm²
(e.g. 350mm x 150mm)
Req'd both sides of fire,
or area equal or greater
than 105 000mm²
(e.g. 700mm x 350mm)
Req'd from one side of fire.

Option 1:
See note on left hand side.

Option 2:
See note on left hand side.

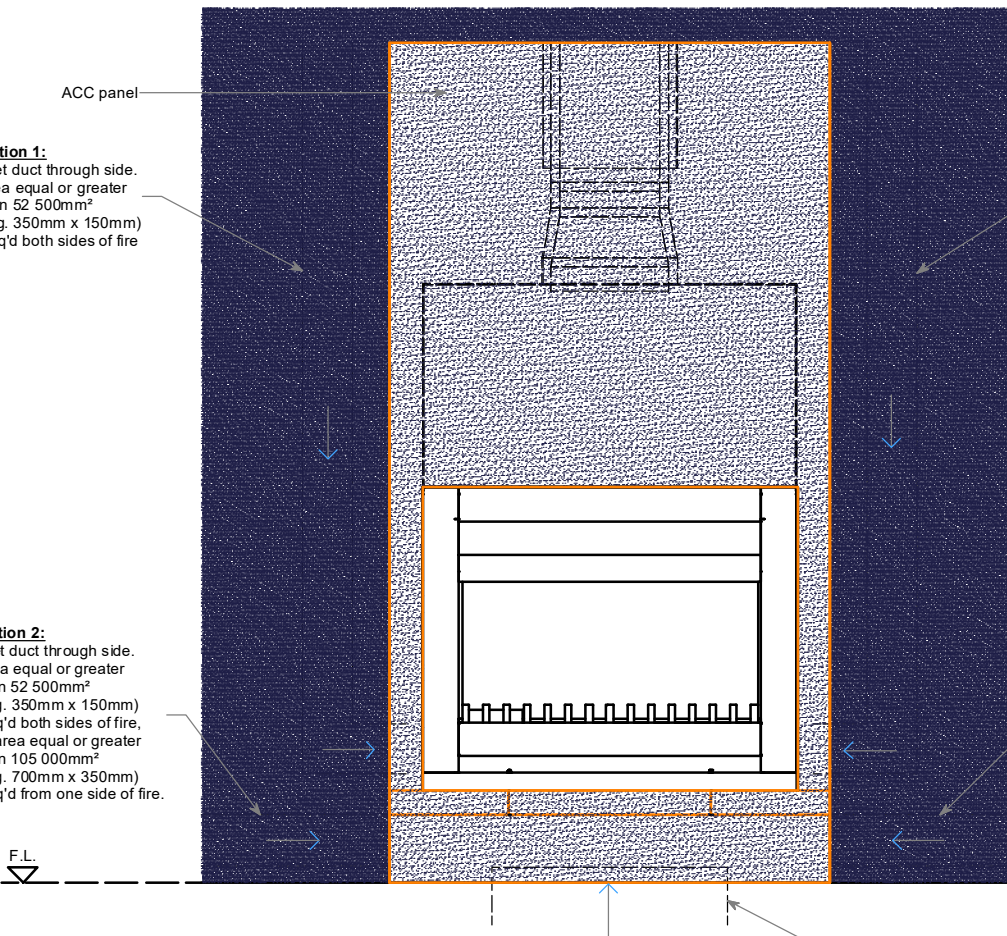

Front view

NOTE - Air Introduction Requirements:

Air introduction requirements are necessary to assist with the flow of air within the cavity surrounding the firebox. Air can be introduced from one of 3 locations as shown on the drawing above e.g. from above the fire, from side of fire at base and from underneath the fire. *When introducing air via Options 2 & 3 the hearth will need to have openings cut at each end to allow air flow through the hearth and up to each side of the fire - See ACC panel cutting plan.

COPYRIGHT©
THIS DRAWING IS THE PROPERTY
OF The Fire Dept.

Client: THE FIRE DEPT.

Product: WD2-0900

Title: AIR INTRODUCTION REQUIREMENTS

Drawn: J.SCHOEMAN

Date: 24/08/2018

Chkd: J. WILSON

Date: 23/09/2018

Appd: J. WILSON

Date: 23/09/2018

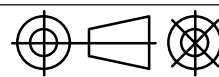

Scale: on A4

THE FIRE DEPT.
HAND CRAFTED FIRES

Drawing No. **WD2-0900-904**

Sheet 4 of 9

Revision **2**

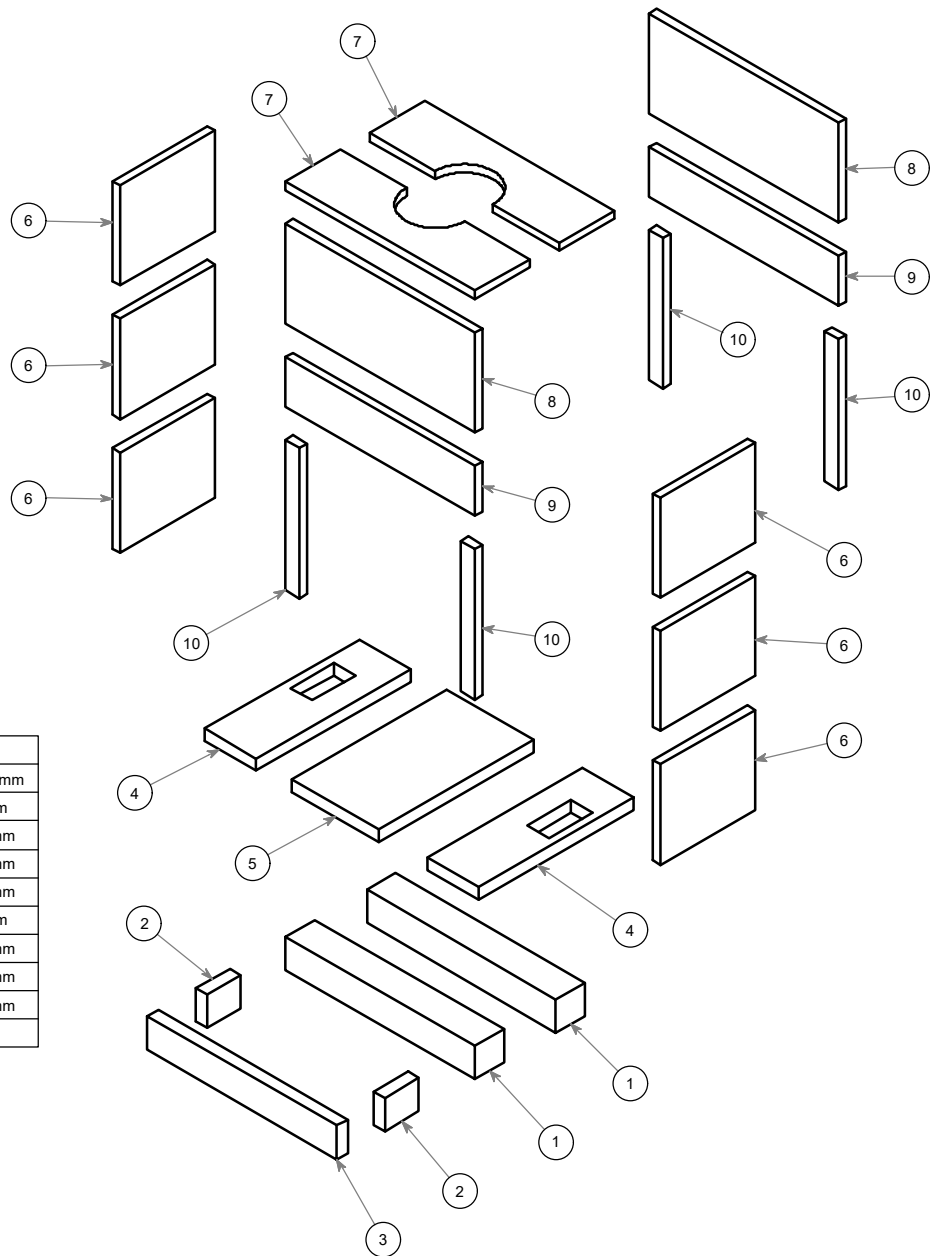

ACC panel - Cutting plan

| ITEM | QTY | DESCRIPTION | MEASUREMENT |
|------|-----|----------------------|------------------------|
| 1 | 2 | Base panel 1 | 200mm x 1310mm x 200mm |
| 2 | 2 | Base panel 2 | 200mm x 235mm x 75mm |
| 3 | 1 | Base panel 3 | 200mm x 1310mm x 75mm |
| 4 | 2 | Base panel 4 | 355mm x 1070mm x 75mm |
| 5 | 1 | Base panel 5 | 600mm x 1070mm x 75mm |
| 6 | 6 | Side panel | 600mm x 658mm x 50mm |
| 7 | 2 | Top panel | 380mm x 1310mm x 50mm |
| 8 | 2 | Front panel - Upper | 600mm x 1310mm x 50mm |
| 9 | 2 | Front panel - middel | 298mm x 1310mm x 50mm |
| 10 | 4 | Front panel - lower | 97mm x 902mm x 50mm |

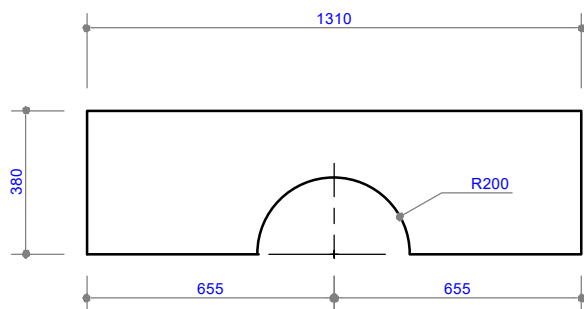

Top panel

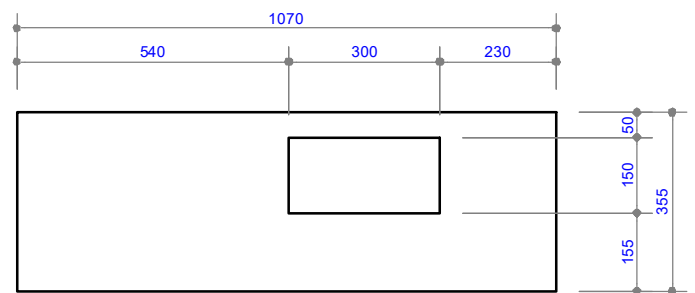

Base panel 4

COPYRIGHT©
 THIS DRAWING IS THE PROPERTY
 OF **The Fire Dept.**

Client: THE FIRE DEPT.

Product: WD2-0900

Title: AAC PANEL CUTTING PLAN - TIMBER CAVITY

Drawn: J.SCHOEMAN

Date: 24/08/2018

Chkd: J. WILSON

Date: 23/09/2018

Appd: J. WILSON

Date: 23/09/2018

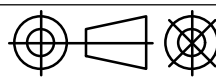

Scale: on A4

THE FIRE DEPT.
HAND CRAFTED FIRES

Drawing No. **WD2-0900-905**

Sheet 5 of 9

Revision **2**

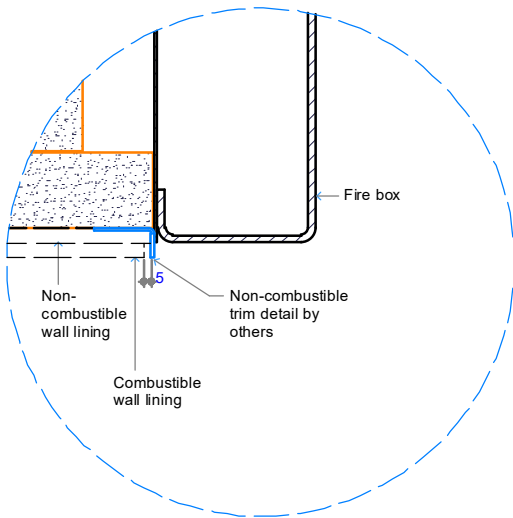

**Detail 1 - Plan View Fire Surround Opt. 1
Timber Cavity**

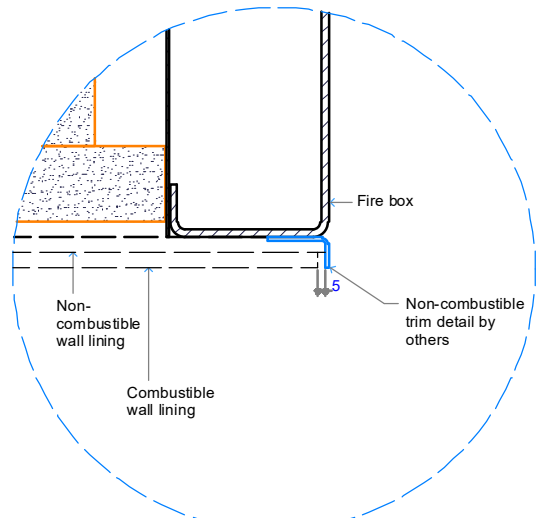

**Detail 1 - Plan View Fire Surround Opt. 2
Timber Cavity**

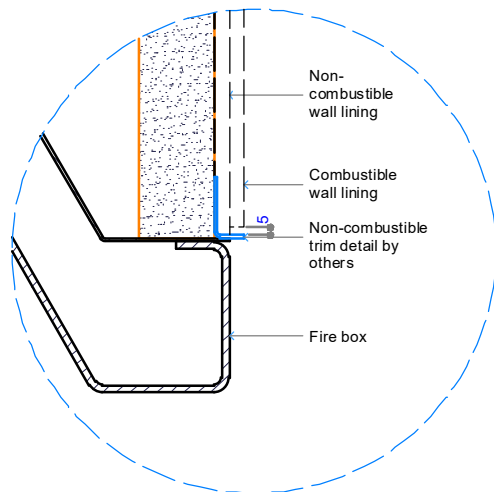

**Detail 2 - Cross Section Fire Surround Opt. 3
Timber Cavity**

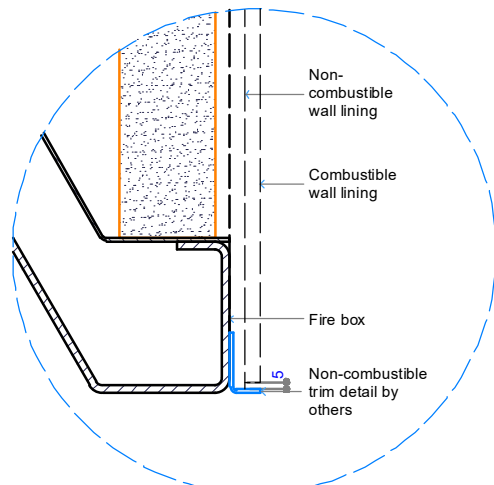

**Detail 2 - Cross Section Fire Surround Opt. 4
Timber Cavity**

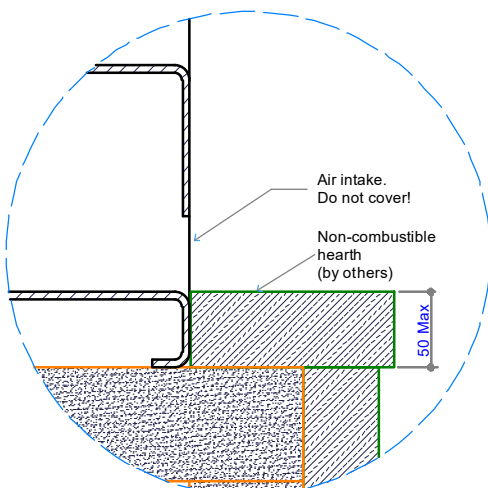

**Detail 3 - Cross Section Fire Surround Opt. 5
Timber Cavity**

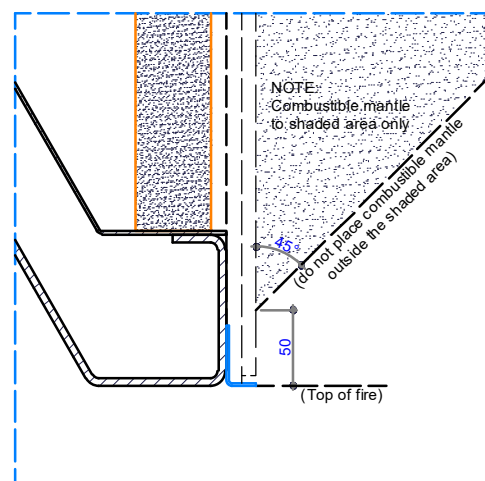

Detail 4 - Top of Fire to Combustible Mantel

COPYRIGHT©
THIS DRAWING IS THE PROPERTY
OF **The Fire Dept.**

Client: THE FIRE DEPT.

Product: WD2-0900

Title: SURROUND DETAILS

Drawn: J.SCHOEMAN

Date: 24/08/2018

Chkd: J. WILSON

Date: 23/09/2018

Appd: J. WILSON

Date: 23/09/2018

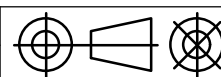

Scale: on A4

THE FIRE DEPT.
HAND CRAFTED FIRES

Drawing No. **WD2-0900-906**

Sheet **6** of **9**

Revision **2**

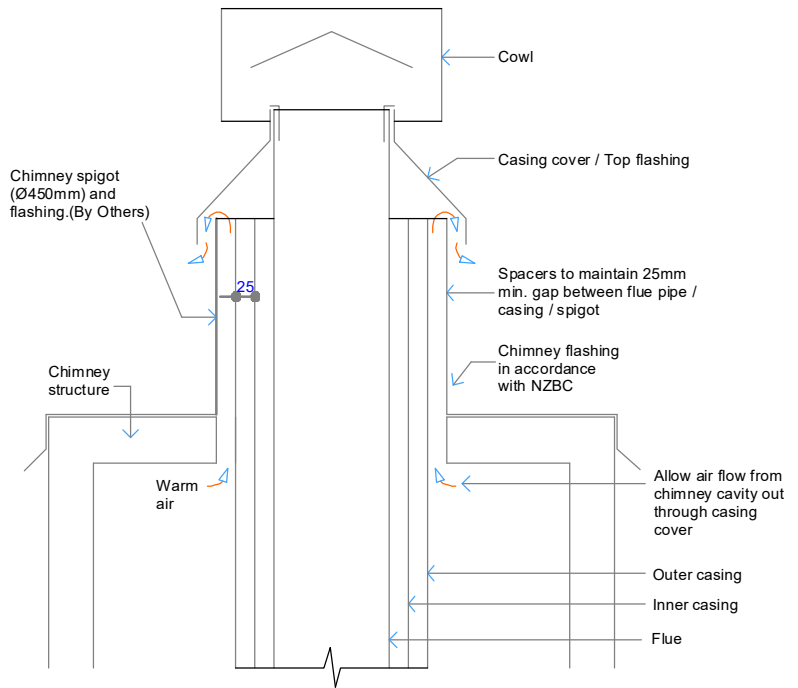
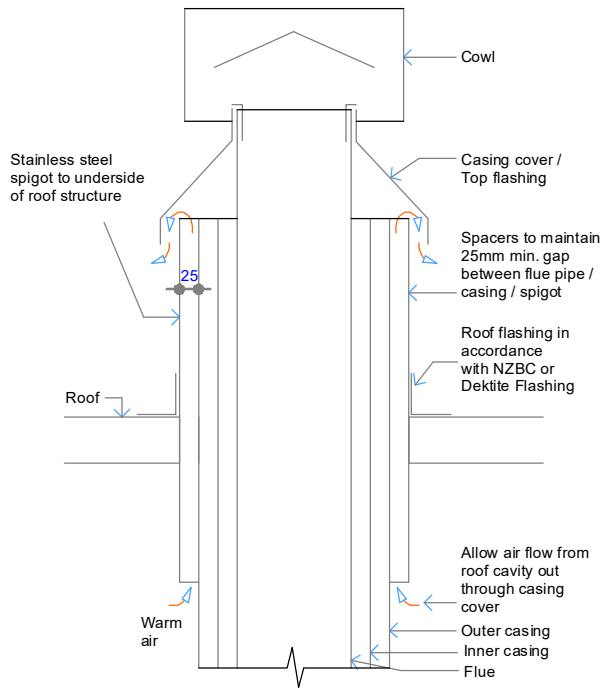

Detail Roof - Air Ventilation through Casing cover / Top flashing

Detail Chimney - Air Ventilation through Casing cover / Top flashing Opt. 2

Flue components:
300mm dia. Flue
350mm dia. Inner Casing
400mm dia. Outer Casing
450mm dia. S/S Spigot
Deklite Flashing No. 9

NOTE:
Flue components must be installed to AS/NZS2918:2001 requirements.
All external penetration flashings must be installed in accordance with NZBC.
Cavity airflow must be unobstructed from fire box to flue termination.
25mm clearance between flue and combustible materials.
75mm clearance between flue and wiring / plastic water pipes.
Each flue joint must be sealed with a heat proof sealer.
Each flue joint must have a minimum of 4 x Stainless Steel rivets.
Flue to be adequately supported at 2m crs.

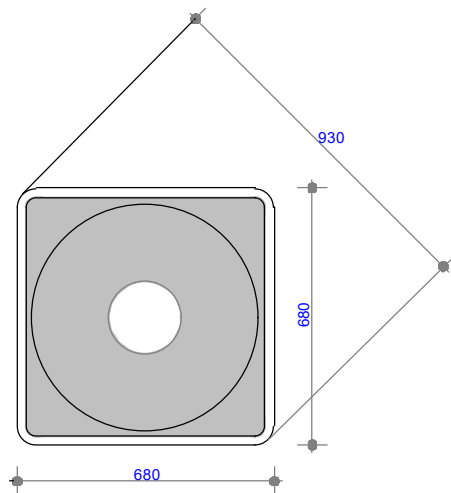

Deklite Flashing No. 9 - Plan View

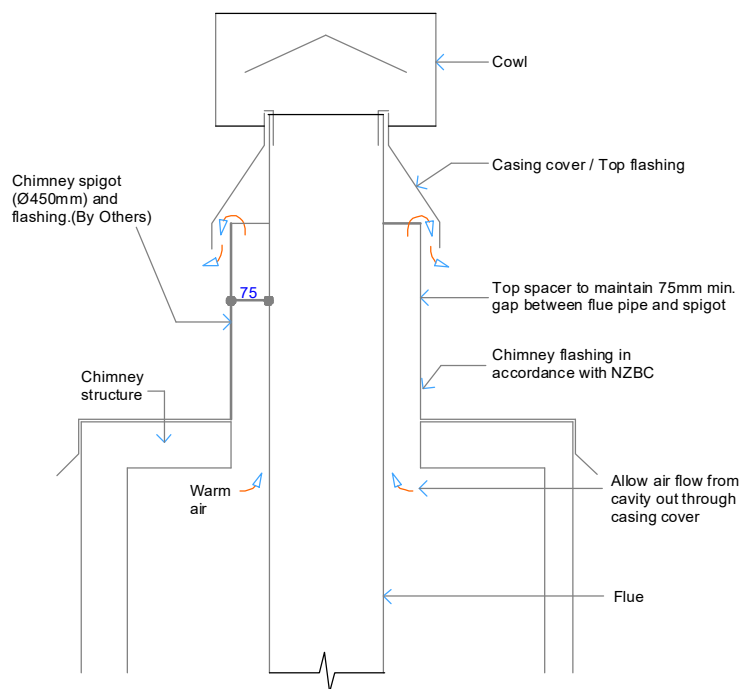

Detail Chimney - Air Ventilation through Casing cover / Top flashing Opt. 3 (CONCRETE ONLY!)

Flue components:
300mm dia. Flue
450mm dia. Spigot

COPYRIGHT©
THIS DRAWING IS THE PROPERTY
OF The Fire Dept.

Client: THE FIRE DEPT.

Product: WD2-0900

Title: VERTICAL FLUE EXIT DETAILS

Drawn: J.SCHOEMAN

Date: 24/08/2018

Chkd: J. WILSON

Date: 23/09/2018

Appd: J. WILSON

Date: 23/09/2018

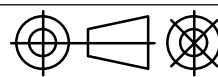

Scale: on A4

Drawing No. **WD2-0900-907**

Sheet 7 of 9

Revision **2**

THE FIRE DEPT.
HAND CRAFTED FIRES

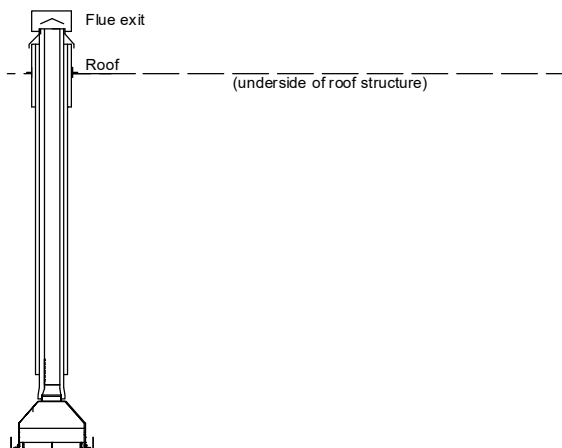

Vertical Flue Combination WD2A

NOTE:

Flue components must be installed to AS/NZS2918:2001 requirements.
All external penetration flashings must be installed in accordance with NZBC.
Cavity airflow must be unobstructed from fire box to flue termination.
25mm clearance between flue and combustible materials.
75mm clearance between flue and wiring / plastic water pipes.
Each flue joint must be sealed with a heat proof sealer.
Each flue joint must have a minimum of 4 x Stainless Steel rivets.
Flue to be adequately supported at 2m crs.

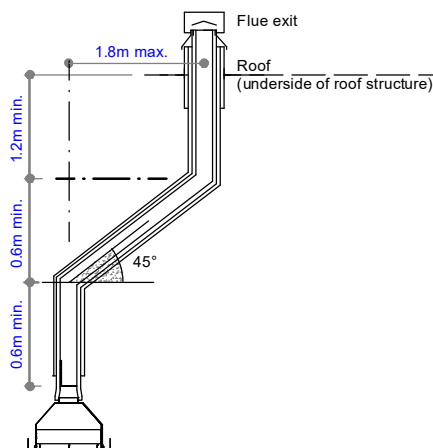

Vertical Flue Combination WD2B

NOTE:

Flue components must be installed to AS/NZS2918:2001 requirements.
All external penetration flashings must be installed in accordance with NZBC.
Cavity airflow must be unobstructed from fire box to flue termination.
25mm clearance between flue and combustible materials.
75mm clearance between flue and wiring / plastic water pipes.
Each flue joint must be sealed with a heat proof sealer.
Each flue joint must have a minimum of 4 x Stainless Steel rivets.
Flue to be adequately supported at 2m crs.

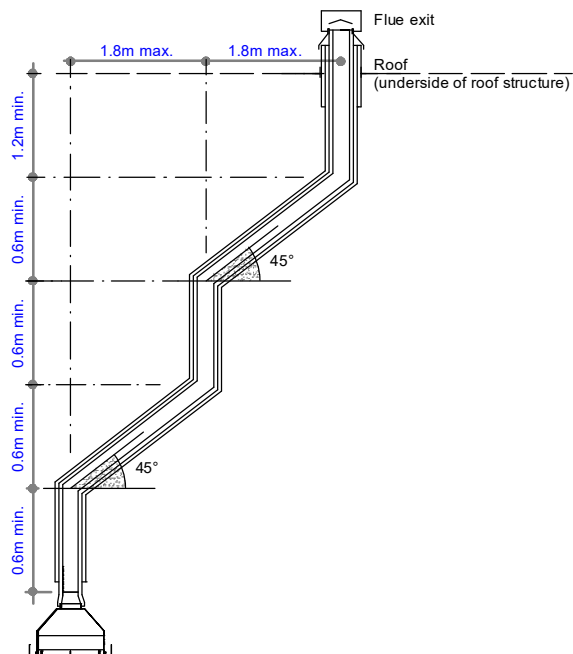

Vertical Flue Combination WD2C

NOTE:

Flue components must be installed to AS/NZS2918:2001 requirements.
All external penetration flashings must be installed in accordance with NZBC.
Cavity airflow must be unobstructed from fire box to flue termination.
25mm clearance between flue and combustible materials.
75mm clearance between flue and wiring / plastic water pipes.
Each flue joint must be sealed with a heat proof sealer.
Each flue joint must have a minimum of 4 x Stainless Steel rivets.
Flue to be adequately supported at 2m crs.

COPYRIGHT©
THIS DRAWING IS THE PROPERTY
OF The Fire Dept.

Client: THE FIRE DEPT.

Product: WD2-0900

Title: VERTICAL FLUE COMBINATION OPTIONS

Drawn: J.SCHOEMAN

Date: 24/08/2018

Chkd: J. WILSON

Date: 23/09/2018

Appd: J. WILSON

Date: 23/09/2018

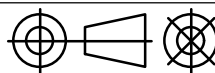

Scale: on A4

THE FIRE DEPT.
HAND CRAFTED FIRES

Drawing No. **WD2-0900-908**

Sheet 8 of 9

Revision **2**

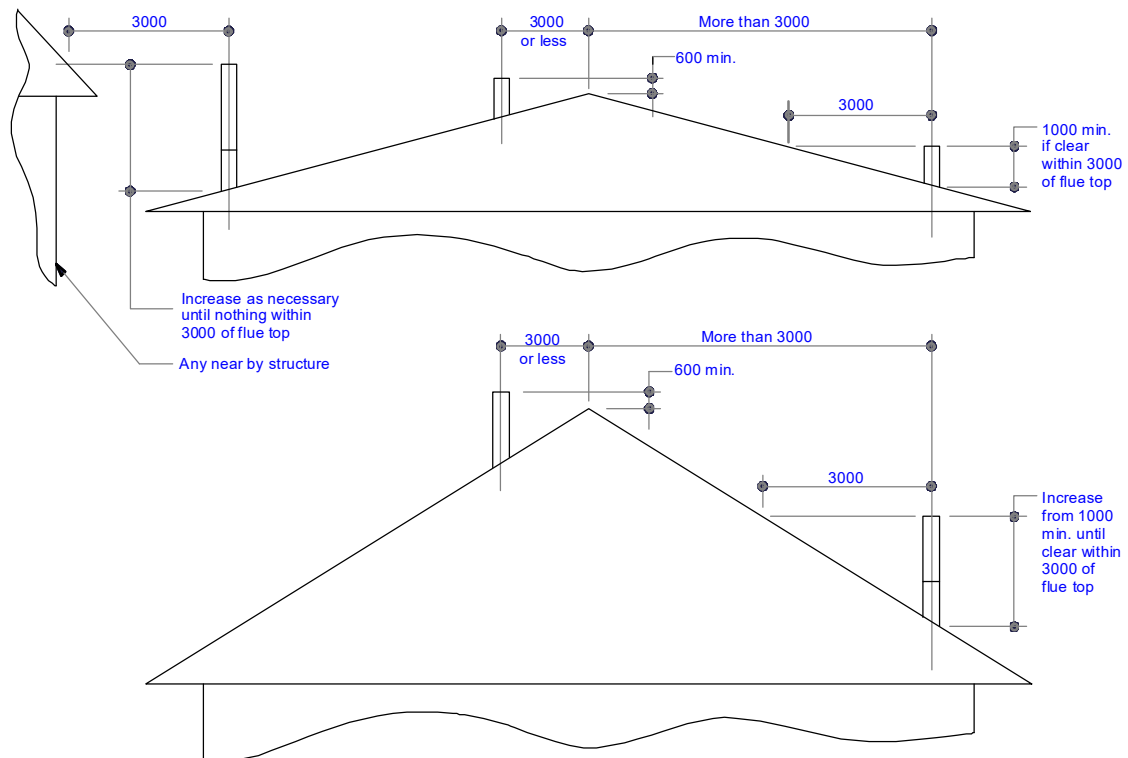

Minimum Height of Flue System Exit
Or as per AS/NZS 2918:2001

COPYRIGHT©

THIS DRAWING IS THE PROPERTY

OF **The Fire Dept.**

Client: THE FIRE DEPT.

Product: WD2-0900

Title: FLUE EXIT CLEARANCES

Drawn: J.SCHOEMAN

Date: 24/08/2018

Chkd: J. WILSON

Date: 23/09/2018

Appd: J. WILSON

Date: 23/09/2018

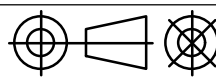

Scale: on A4

THE FIRE DEPT.
HAND CRAFTED FIRES

Drawing No. **WD2-0900-909**

Sheet 9 of 9

Revision **2**