

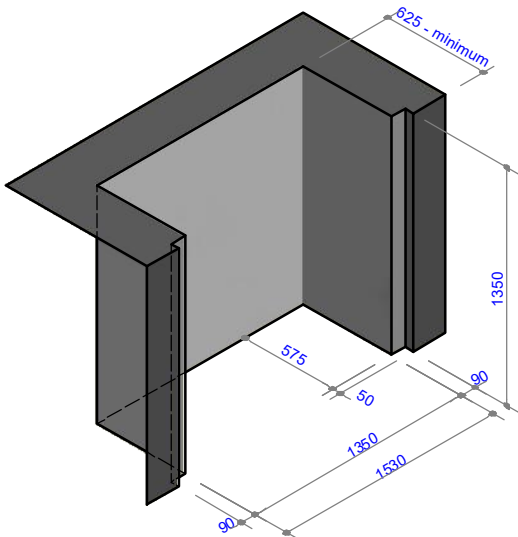

WD4-1200

Specifications



Information in this specification may be subject to change without notice. Please ensure you have the current version before beginning installation.

Fire installation requirements & Hearth size - Timber cavity

NOTE: Hearth to extend minimum of 200mm both sides of the fire opening, and 300mm from front of fire opening

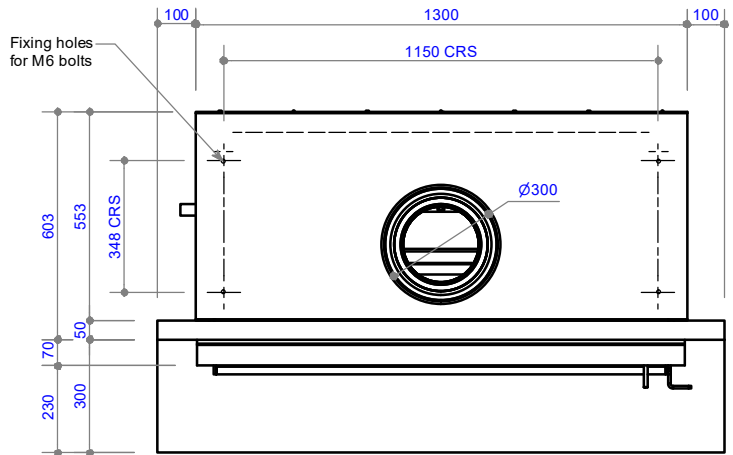

Plan View

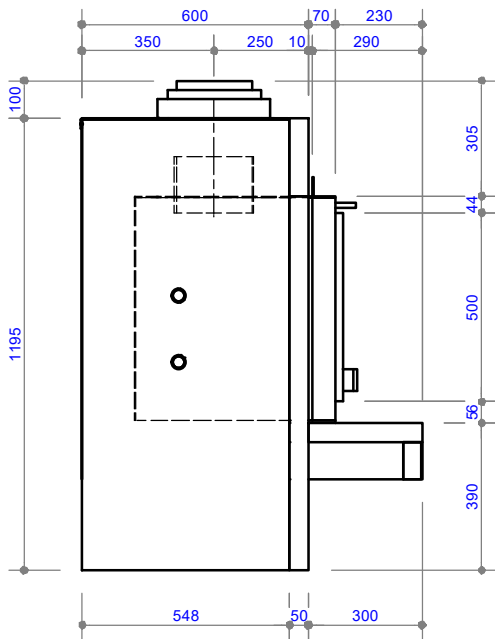

Side view

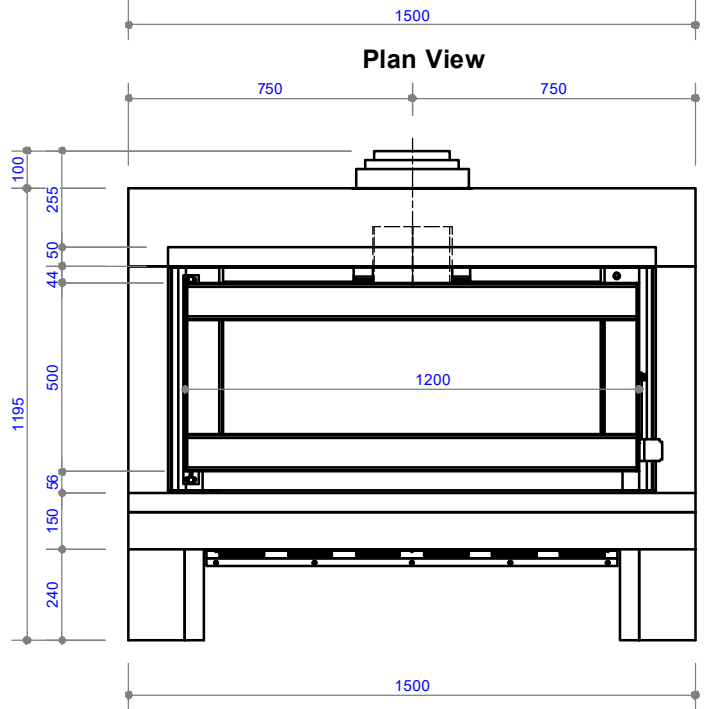

Front View

TOLERANCE = +/- 3mm

COPYRIGHT©
THIS DRAWING IS THE PROPERTY
OF The Fire Dept.

Client: THE FIRE DEPT.		
Product: WD4-1200		
Title: FIRE DIMENSIONS		
Drawn: J.SCHOEMAN	Date: 1/10/2018	
Chkd: J. WILSON	Date: 1/10/2018	
Appd: J. WILSON	Date: 1/10/2018	
Scale:		on A4



Drawing No. WD4-1200-901	Sheet 1 of 8	Revision 1
---------------------------------	----------------------------	-------------------

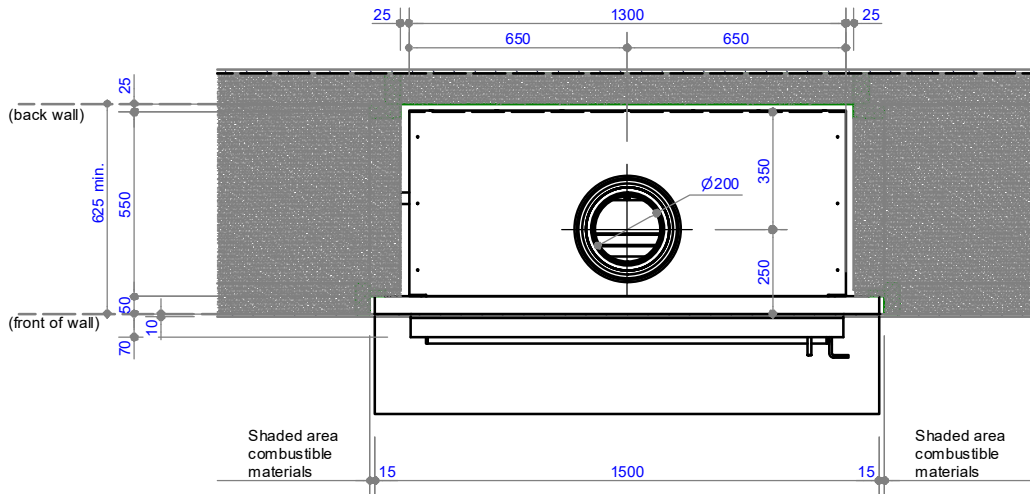

Plan View - Fire insert

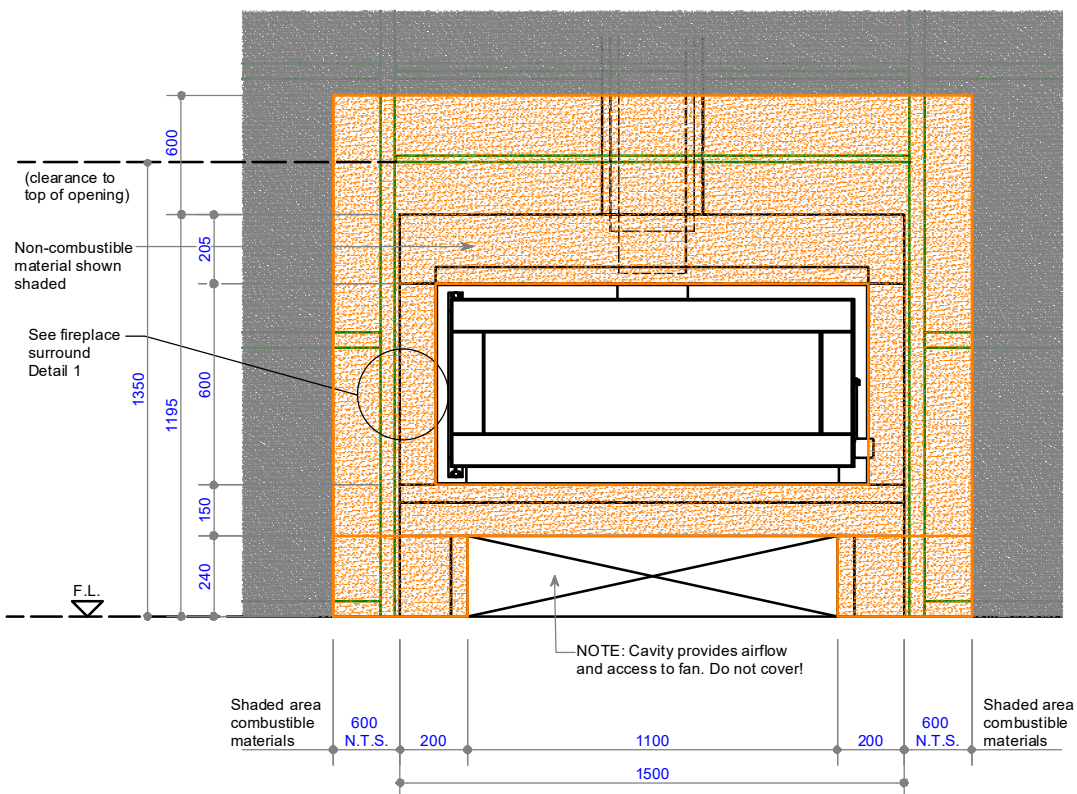

Front view - Fire insert

COPYRIGHT©
THIS DRAWING IS THE PROPERTY
OF The Fire Dept.

Client: THE FIRE DEPT.

Product: WD4-1200

Title: CAVITY CLEARANCES - TIMBER

Drawn: J SCHOEMAN

Date: 1/10/2018

Chkd: J. WILSON

Date: 1/10/2018

Appd: J. WILSON

Date: 1/10/2018

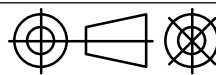

Scale: on A4

THE FIRE DEPT.
HAND CRAFTED FIRES

Drawing No. **WD4-1200-902**

Sheet 2 of 8

Revision **1**

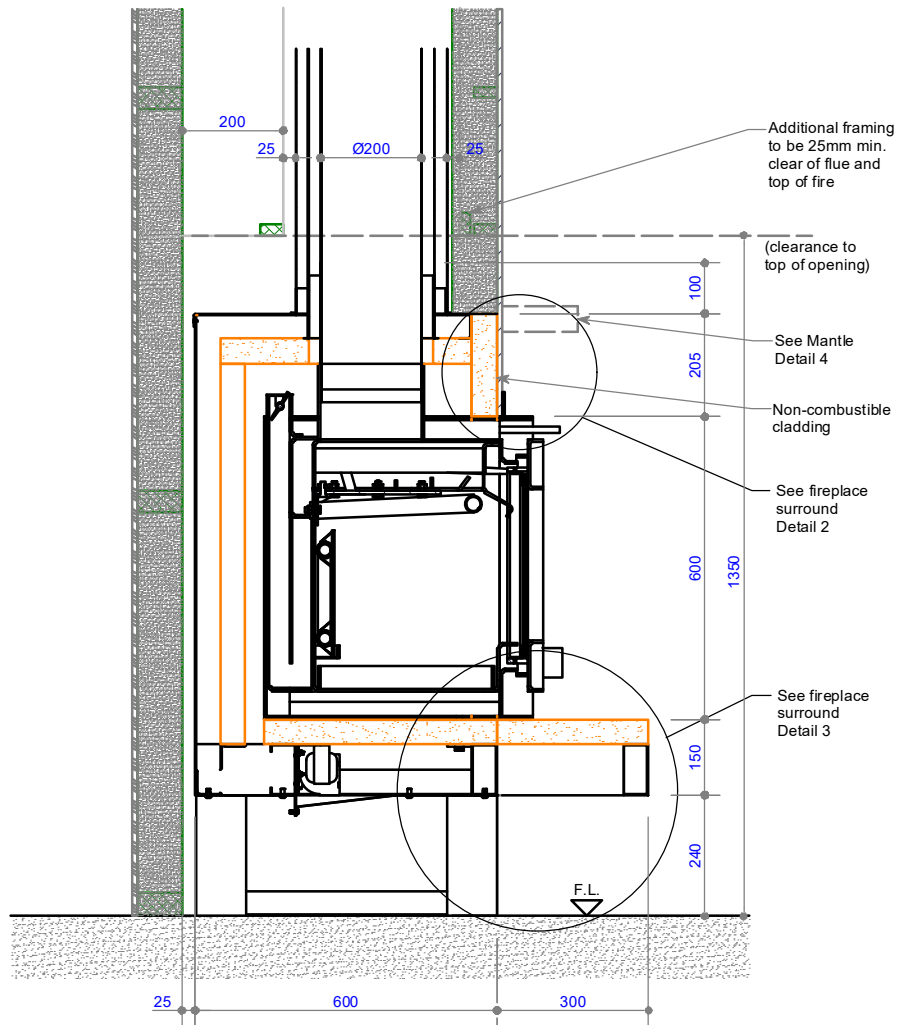

Cross Section - Fire insert at floor level

NOTE:
Room requires air inlet
equal to 100 000mm²

COPYRIGHT©
THIS DRAWING IS THE PROPERTY
OF **The Fire Dept.**

Client: THE FIRE DEPT.

Product: WD4-1200

Title: CAVITY CLEARANCES - TIMBER

Drawn: J.SCHOEMAN

Date: 1/10/2018

Chkd: J. WILSON

Date: 1/10/2018

Appd: J. WILSON

Date: 1/10/2018

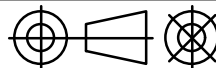

Scale: on A4

THE FIRE DEPT.
HAND CRAFTED FIRES

Drawing No. **WD4-1200-903**

Sheet **3** of **8**

Revision **1**

ACC panel - Cutting plan

ITEM	QTY	DESCRIPTION	MEASUREMENT
1	1	ACC panel no.1	300mm x 1500mm
2	1	ACC panel no.2	461mm x 1200mm
3	1	ACC panel no.3	548mm x 1193mm
4	1	ACC panel no.4	548mm x 1193mm
5	1	ACC panel no.5	499mm x 1200mm
6	1	ACC panel no.6	150mm x 990mm
7	1	ACC panel no.7	150mm x 990mm
8	1	ACC panel no.8	205mm x 1500mm
9	1	ACC panel no.9	600mm x 754mm
10	1	ACC panel no.10	600mm x 754mm

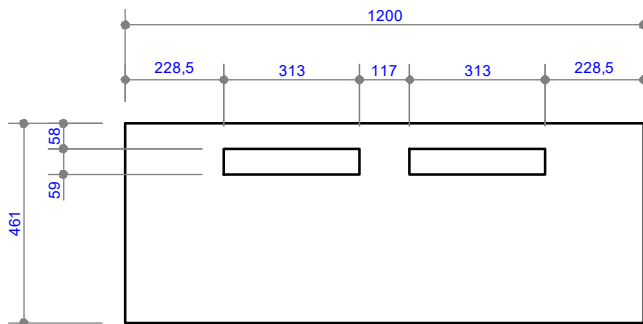
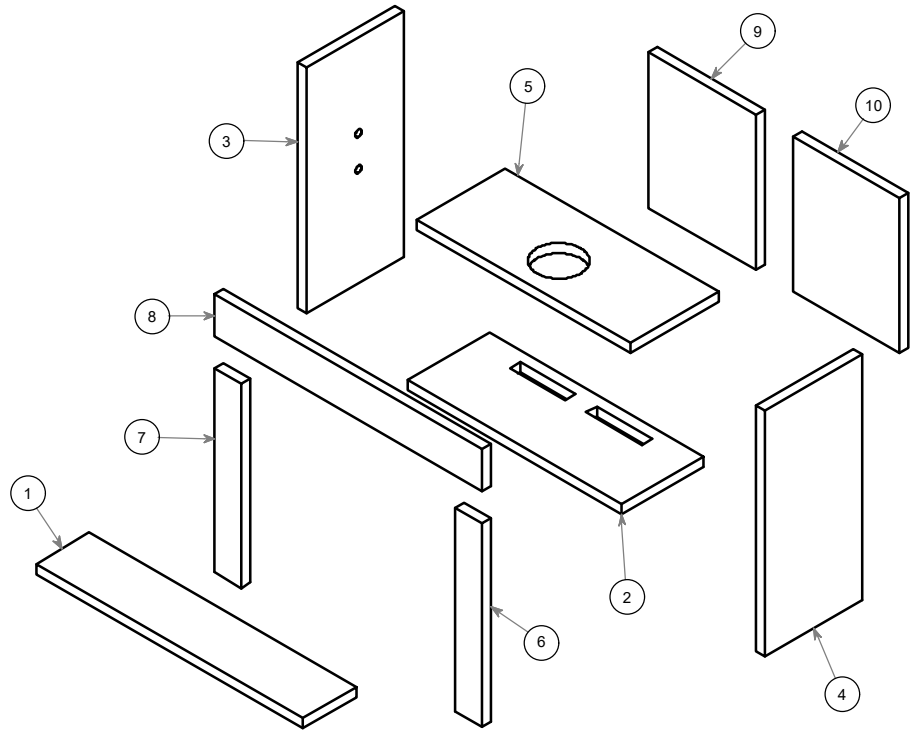

WD4-1200-216-02

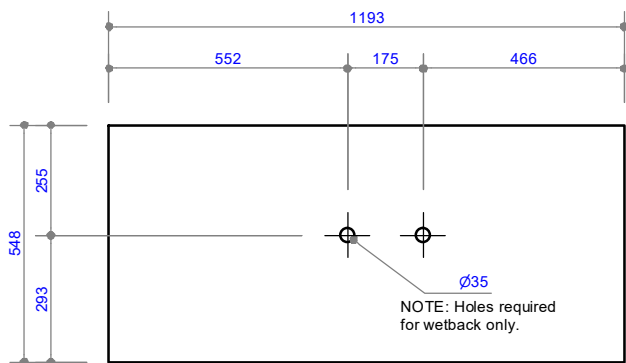

WD4-1200-216-03

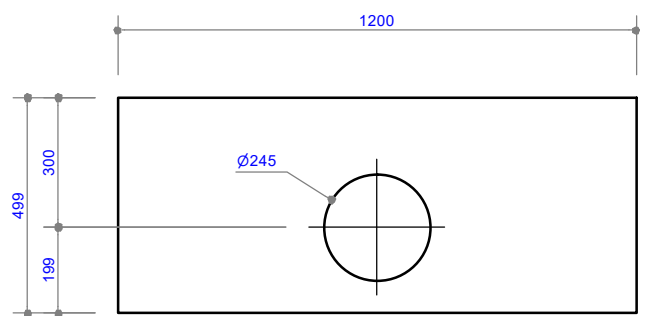

WD4-1200-216-05

COPYRIGHT©
 THIS DRAWING IS THE PROPERTY
 OF **The Fire Dept.**

Client: THE FIRE DEPT.		
Product: WD4-1200		
Title: AAC PANEL CUTTING PLAN - TIMBER CAVITY		
Drawn: J.SCHOEMAN	Date: 1/10/2018	
Chkd: J. WILSON	Date: 1/10/2018	
Appd: J. WILSON	Date: 1/10/2018	
Scale:		on A4



Drawing No. WD4-1200-904	Sheet 4 of 8	Revision 1
---------------------------------	----------------------------	-------------------

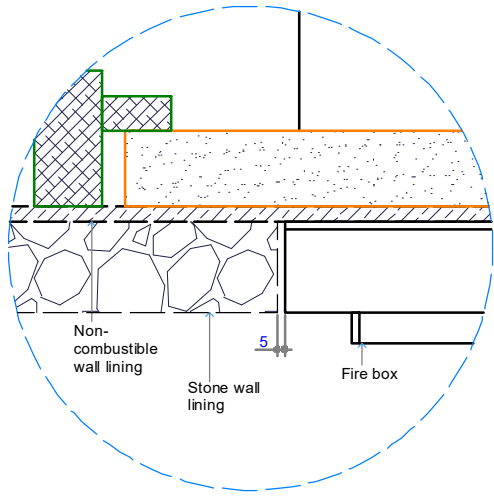

Detail 1 - Plan View Fire Surround Opt. 1
Timber Cavity

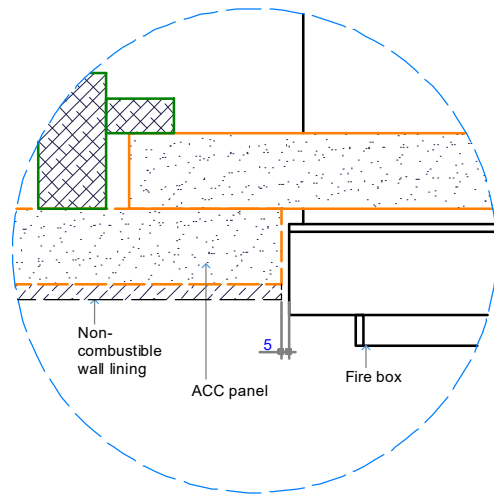

Detail 1 - Plan View Fire Surround Opt. 2
Timber Cavity

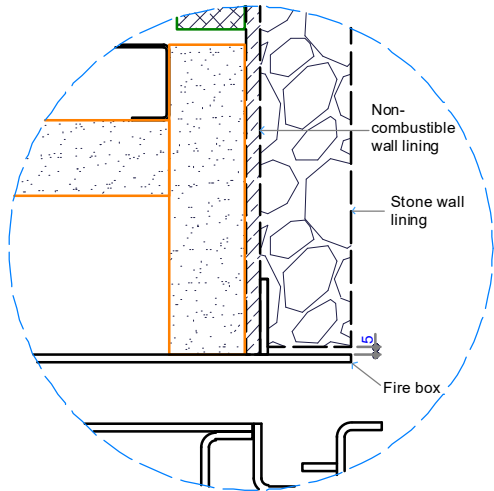

Detail 2 - Cross Section Fire Surround Opt. 3
Timber Cavity

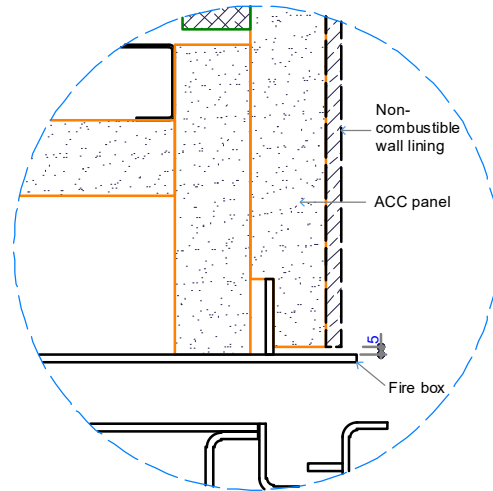

Detail 2 - Cross Section Fire Surround Opt. 4
Timber Cavity

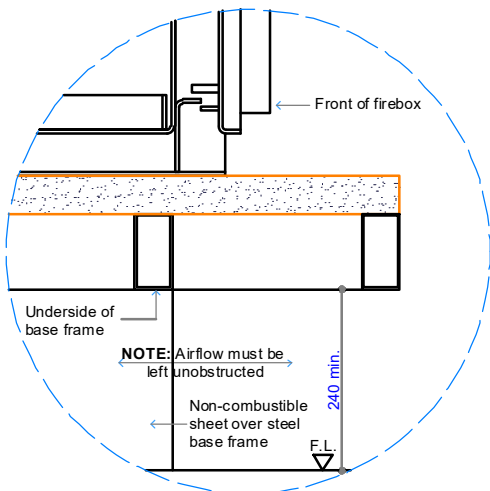

Detail 3 - Cross Section Fire Surround Opt. 5
Timber Cavity

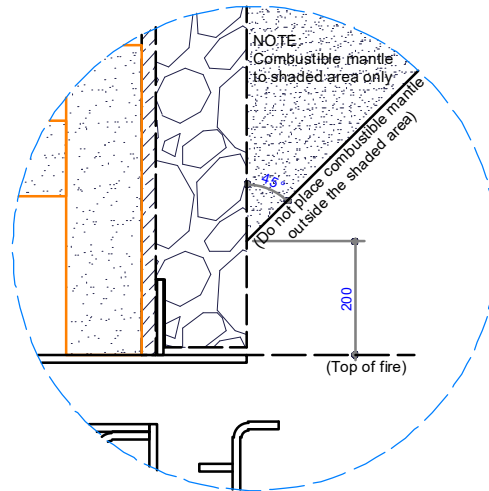

Detail 4 - Top of fire to Combustible Mantle

COPYRIGHT ©
 THIS DRAWING IS THE PROPERTY
 OF The Fire Dept.

Client: THE FIRE DEPT.

Product: WD4-1200

Title: SURROUND DETAILS

Drawn: J.SCHOEMAN

Date: 1/10/2018

Chkd: J. WILSON

Date: 1/10/2018

Appd: J. WILSON

Date: 1/10/2018

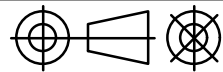

Scale: on A4



Drawing No. **WD4-1200-905**

Sheet 5 of 8

Revision **1**

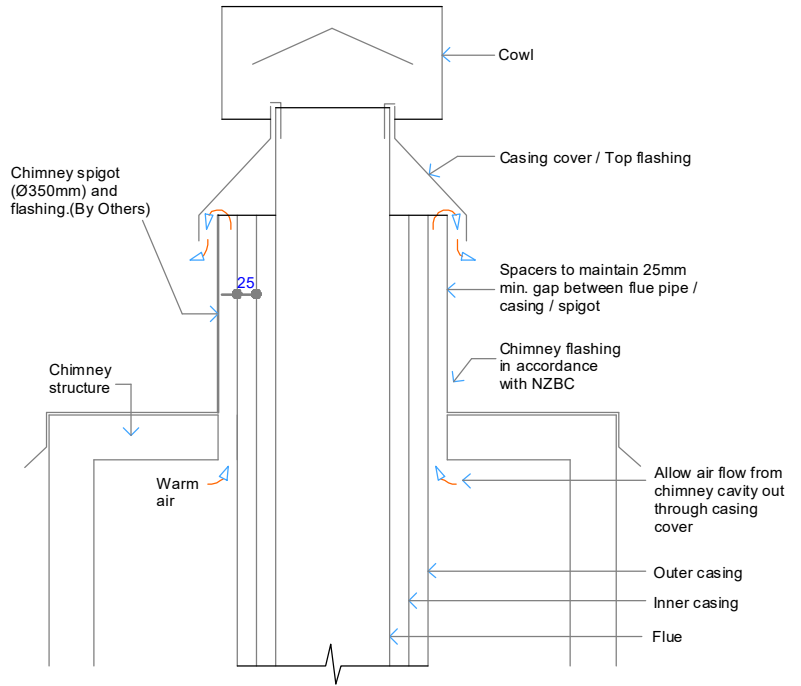
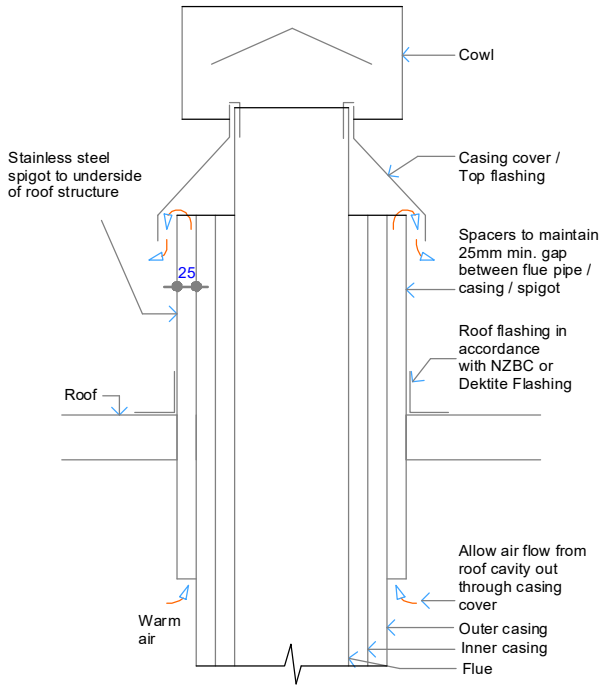

Detail Roof - Air Ventilation through Casing cover / Top flashing

Detail Chimney - Air Ventilation through Casing cover / Top flashing Opt. 2

Flue components:
 200mm dia. Flue
 250mm dia. Inner Casing
 300mm dia. Outer Casing
 350mm dia. S/S Spigot
 Deklite Flashing No. 8

NOTE:
 Flue components must be installed to AS/NZS2918:2001 requirements.
 All external penetration flashings must be installed in accordance with NZBC.
 Cavity airflow must be unobstructed from fire box to flue termination.
 25mm clearance between flue and combustible materials.
 75mm clearance between flue and wiring / plastic water pipes.
 Each flue joint must be sealed with a heat proof sealer.
 Each flue joint must have a minimum of 4 x Stainless Steel rivets.
 Flue to be adequately supported at 2m crs.

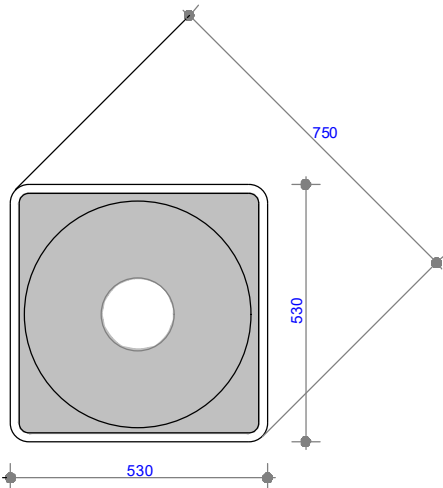

Deklite Flashing No. 8 - Plan View

COPYRIGHT ©
 THIS DRAWING IS THE PROPERTY
 OF **The Fire Dept.**

Client: THE FIRE DEPT.

Product: WD4-1200

Title: VERTICAL FLUE EXIT DETAILS

Drawn: J.SCHOEMAN

Date: 1/10/2018

Chkd: J. WILSON

Date: 1/10/2018

Appd: J. WILSON

Date: 1/10/2018

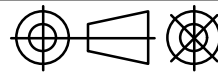

Scale: on A4



Drawing No. **WD4-1200-906**

Sheet 6 of 8

Revision **1**

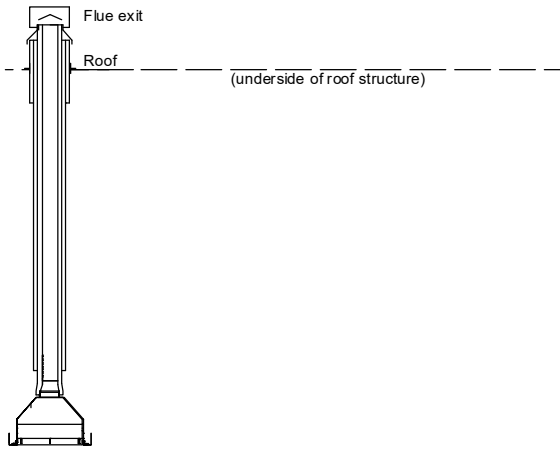

Vertical Flue Combination WD4A

NOTE:
 Flue components must be installed to AS/NZS2918:2001 requirements.
 All external penetration flashings must be installed in accordance with NZBC.
 Cavity airflow must be unobstructed from fire box to flue termination.
 25mm clearance between flue and combustible materials.
 75mm clearance between flue and wiring / plastic water pipes.
 Each flue joint must be sealed with a heat proof sealer.
 Each flue joint must have a minimum of 4 x Stainless Steel rivets.
 Flue to be adequately supported at 2m crs.

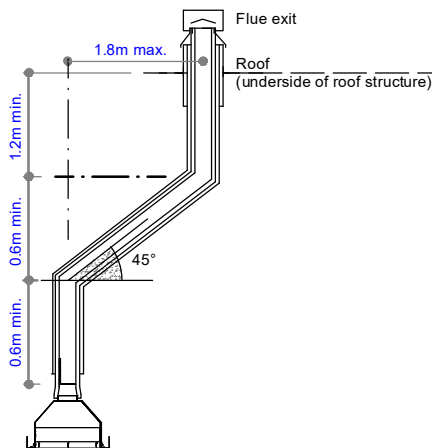

Vertical Flue Combination WD4B

NOTE:
 Flue components must be installed to AS/NZS2918:2001 requirements.
 All external penetration flashings must be installed in accordance with NZBC.
 Cavity airflow must be unobstructed from fire box to flue termination.
 25mm clearance between flue and combustible materials.
 75mm clearance between flue and wiring / plastic water pipes.
 Each flue joint must be sealed with a heat proof sealer.
 Each flue joint must have a minimum of 4 x Stainless Steel rivets.
 Flue to be adequately supported at 2m crs.

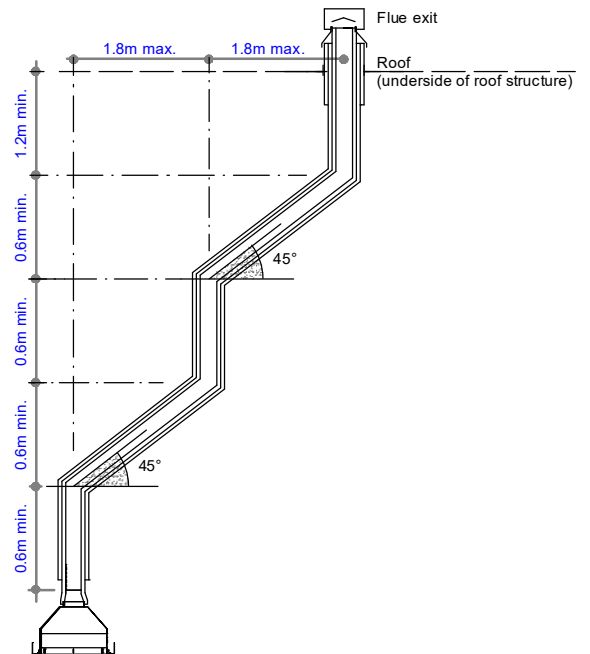

Vertical Flue Combination WD4C

NOTE:
 Flue components must be installed to AS/NZS2918:2001 requirements.
 All external penetration flashings must be installed in accordance with NZBC.
 Cavity airflow must be unobstructed from fire box to flue termination.
 25mm clearance between flue and combustible materials.
 75mm clearance between flue and wiring / plastic water pipes.
 Each flue joint must be sealed with a heat proof sealer.
 Each flue joint must have a minimum of 4 x Stainless Steel rivets.
 Flue to be adequately supported at 2m crs.

COPYRIGHT ©
 THIS DRAWING IS THE PROPERTY
 OF The Fire Dept.

Client: THE FIRE DEPT.		
Product: WD4-1200		
Title: VERTICAL FLUE COMBINATION OPTIONS		
Drawn: J.SCHOEMAN	Date: 1/10/2018	
Chkd: J. WILSON	Date: 1/10/2018	
Appd: J. WILSON	Date: 1/10/2018	
Scale: on A4		



Drawing No. WD4-1200-907	Sheet 7 of 8	Revision 1
---------------------------------	----------------------------	-------------------

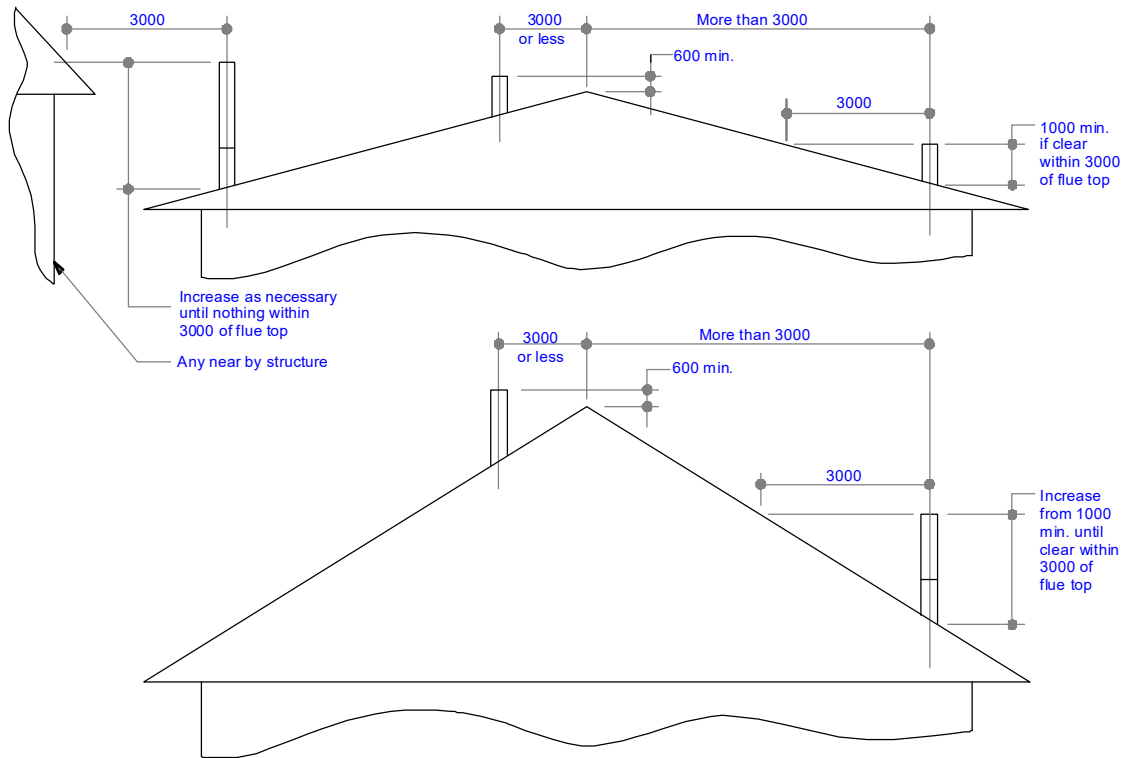

Minimum Height of Flue System Exit
Or as per AS/NZS 2918:2001

COPYRIGHT ©
 THIS DRAWING IS THE PROPERTY
 OF **The Fire Dept.**

Client: THE FIRE DEPT.

Product: WD4-1200

Title: FLUE EXIT CLEARANCES

Drawn: J.SCHOEMAN

Date: 1/10/2018

Chkd: J. WILSON

Date: 1/10/2018

Appd: J. WILSON

Date: 1/10/2018

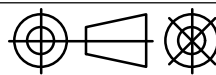

Scale: on A4



Drawing No. **WD4-1200-908**

Sheet 8 of 8

Revision **1**