

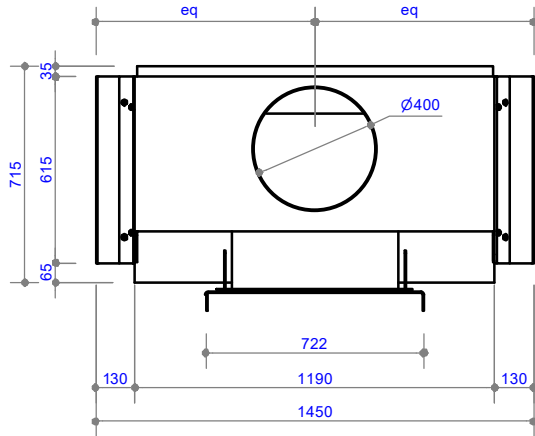

WD5-1200

Specifications

Information in this specification may be subject to change without notice. Please ensure you have the current version before beginning installation.



Plan View

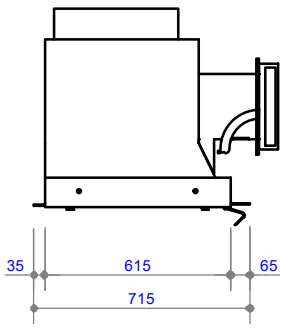

Side view

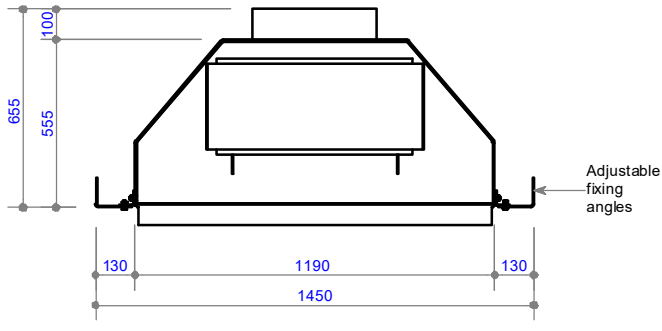

Front View

TOLERANCE = +/- 3mm

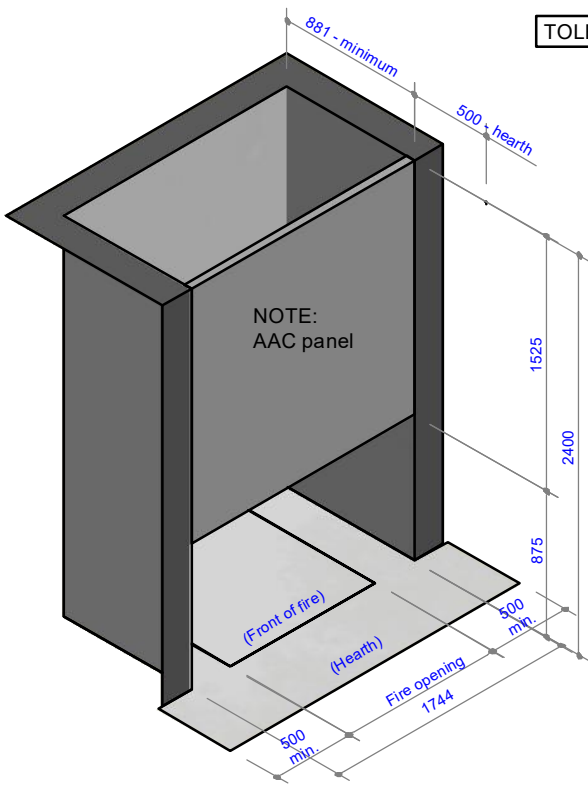

Fire installation requirements & Hearth size - Timber cavity

NOTE: Hearth to extend minimum of 500mm both sides of the fire opening, and 500mm from front of fire opening

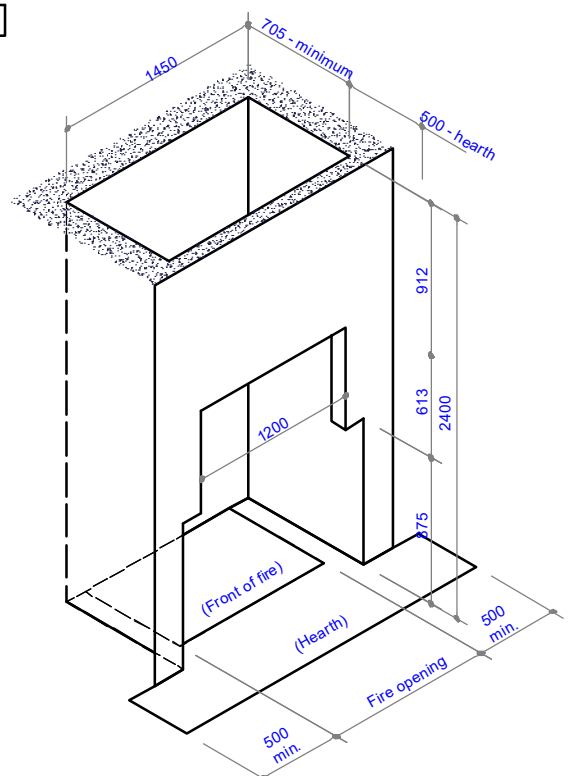

Fire installation requirements & Hearth Size - Concrete cavity

NOTE: Hearth to extend minimum of 500mm both sides of the fire opening, and 500mm from front of fire opening

COPYRIGHT © THIS DRAWING IS THE PROPERTY OF The Fire Dept.	Client: THE FIRE DEPT.			
	Product: WD5-1200			
	Title: FIRE DIMENSIONS			
	Drawn: J.SCHOEMAN	Date: 24/08/2018		
	Chkd: J. WILSON	Date: 23/08/2018		
Appd: J. WILSON	Date: 23/08/2018			
Drawing No. WD5-1200-901	Sheet 1 of 14	Revision 1		

Information in this specification may be subject to change without notice. Please ensure you have the current version before beginning installation.

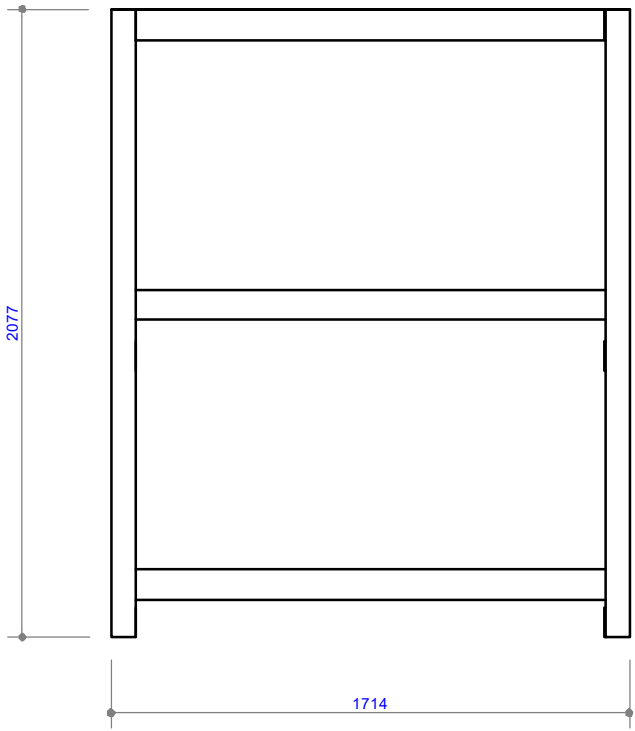
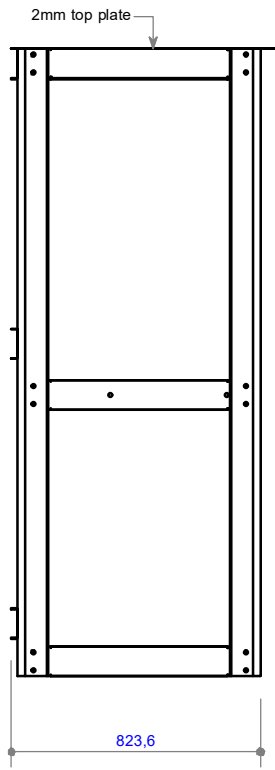
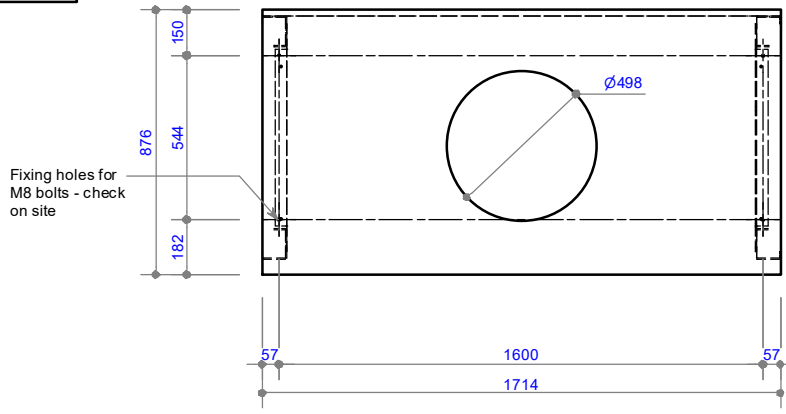

COPYRIGHT ©
 THIS DRAWING IS THE PROPERTY
 OF **The Fire Dept.**

Client: THE FIRE DEPT.	
Product: WD5-1200	
Title: STEEL SUPPORT FRAME DIMENSIONS	
Drawn: J.SCHOEMAN	Date: 24/08/2018
Chkd: J. WILSON	Date: 23/08/2018
Appd: J. WILSON	Date: 23/08/2018
Scale:	on A4



Drawing No. WD5-1200-902	Sheet 2 of 14	Revision 1
---------------------------------	-----------------------------	-------------------

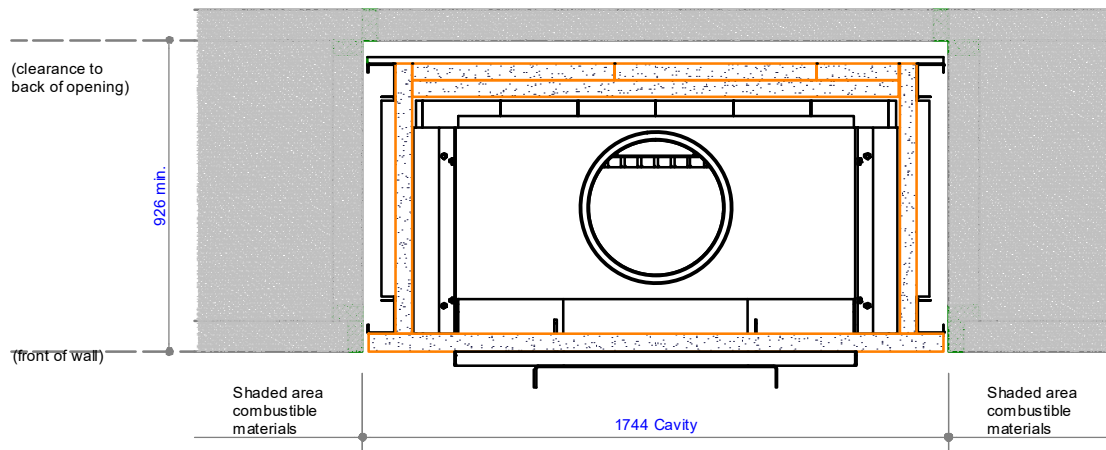

Plan View - Fire insert (above fire gather)

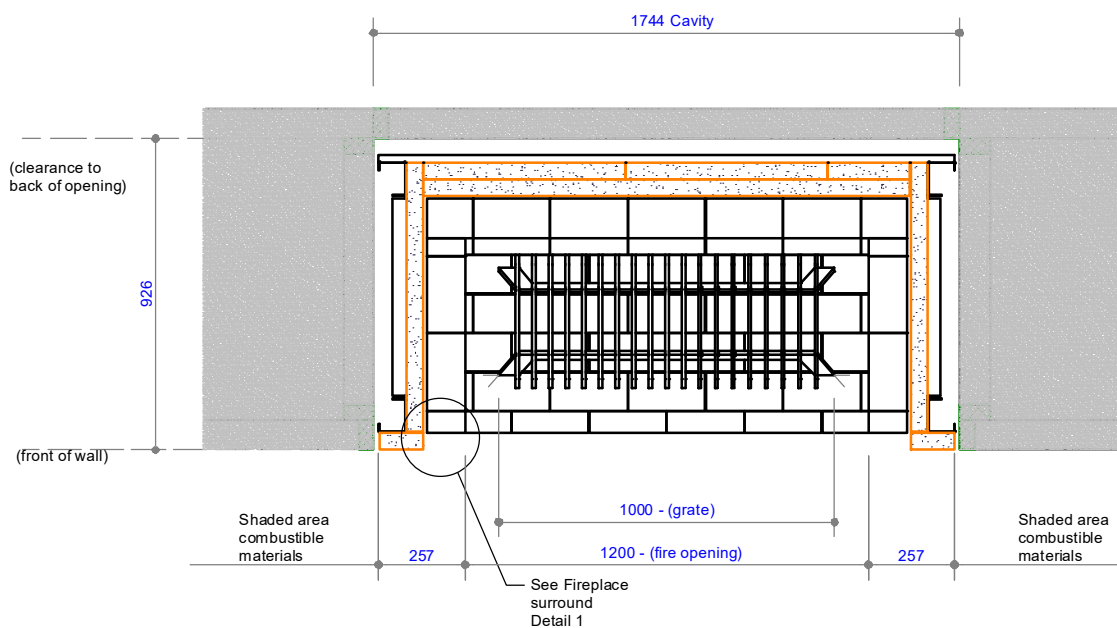

Plan view - Fire insert (below fire gather)

COPYRIGHT © THIS DRAWING IS THE PROPERTY OF The Fire Dept.	Client: THE FIRE DEPT.			
	Product: WD5-1200			
	Title: CAVITY CLEARANCES - TIMBER			
	Drawn: J SCHOEMAN	Date: 24/08/2018		
	Chkd: J. WILSON	Date: 23/08/2018		
Appd: J. WILSON	Date: 23/08/2018	Scale: on A4		
Drawing No.	WD5-1200-903		Sheet 3 of 14	
			Revision 1	

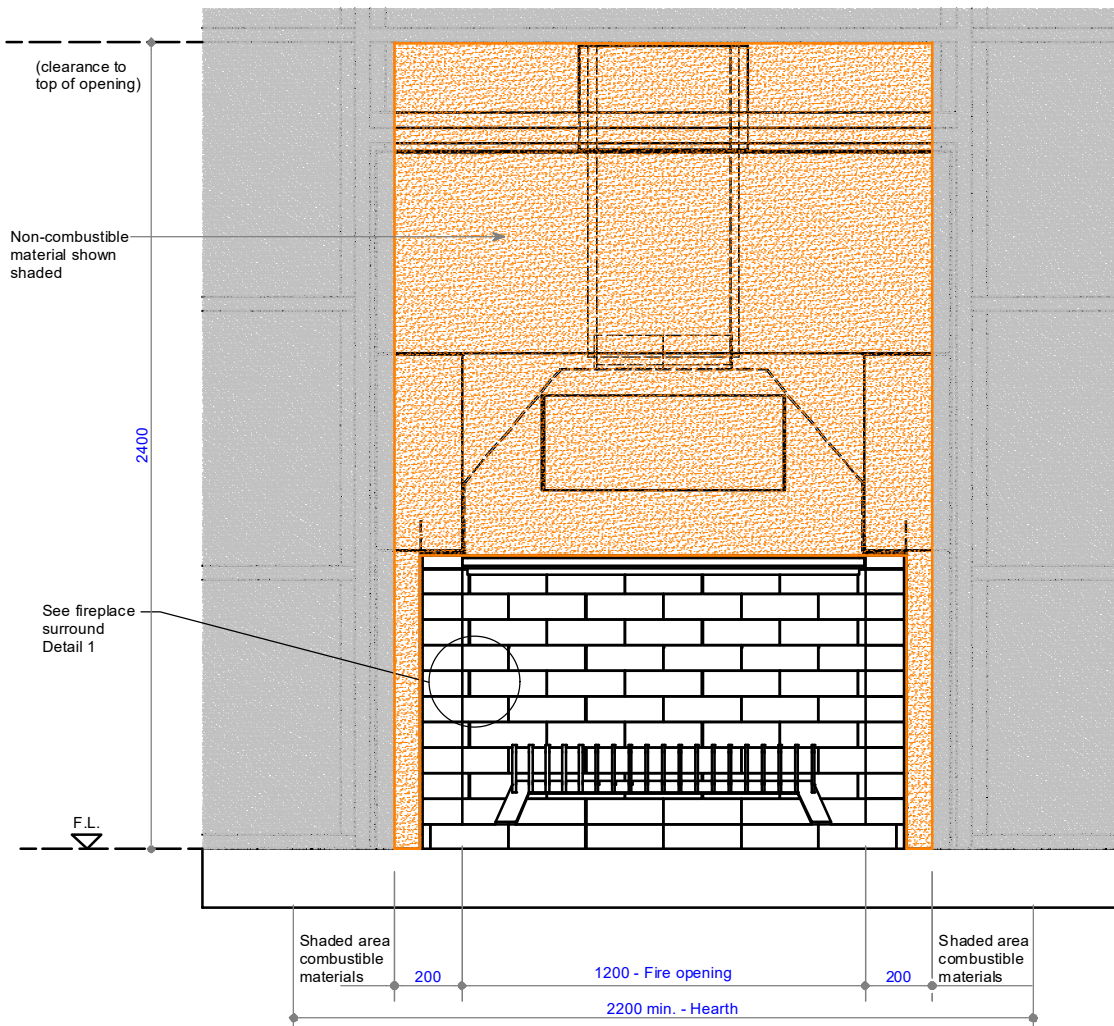

Front view - Fire insert

COPYRIGHT©
THIS DRAWING IS THE PROPERTY
OF The Fire Dept.

Client: THE FIRE DEPT.

Product: WD5-1200

Title: CAVITY CLEARANCES - TIMBER

Drawn: J.SCHOEMAN

Date: 24/08/2018

Chkd: J. WILSON

Date: 23/08/2018

Appd: J. WILSON

Date: 23/08/2018

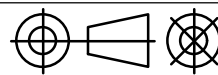

Scale: on A4

THE FIRE DEPT.
HAND CRAFTED FIRES

Drawing No. **WD5-1200-904**

Sheet 4 of 14

Revision **1**

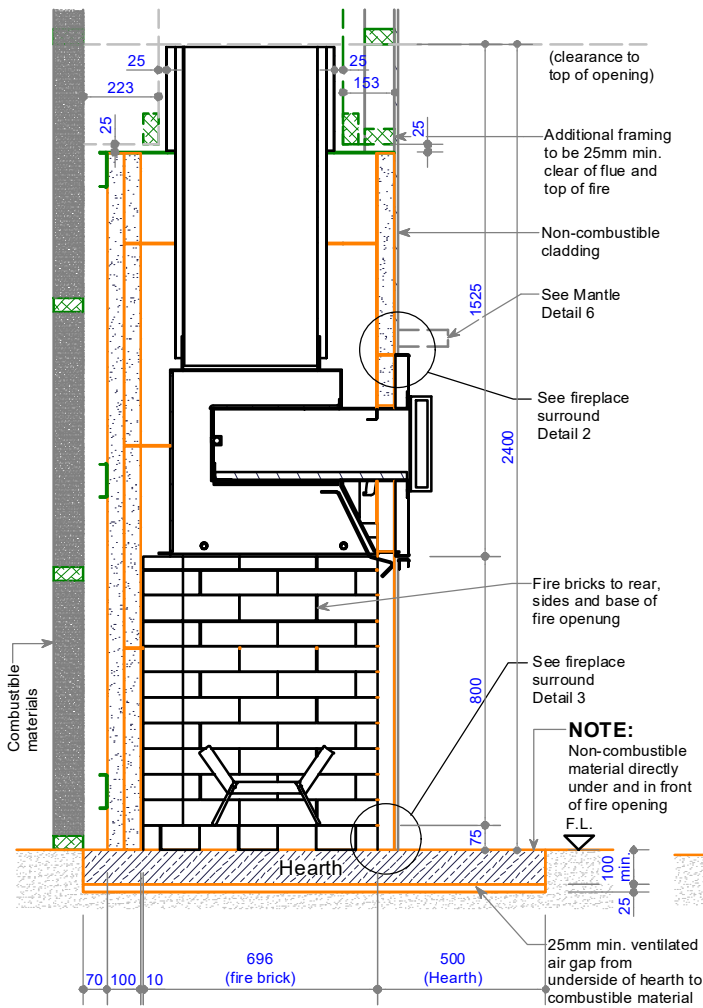

Cross Section - Fire insert at floor level

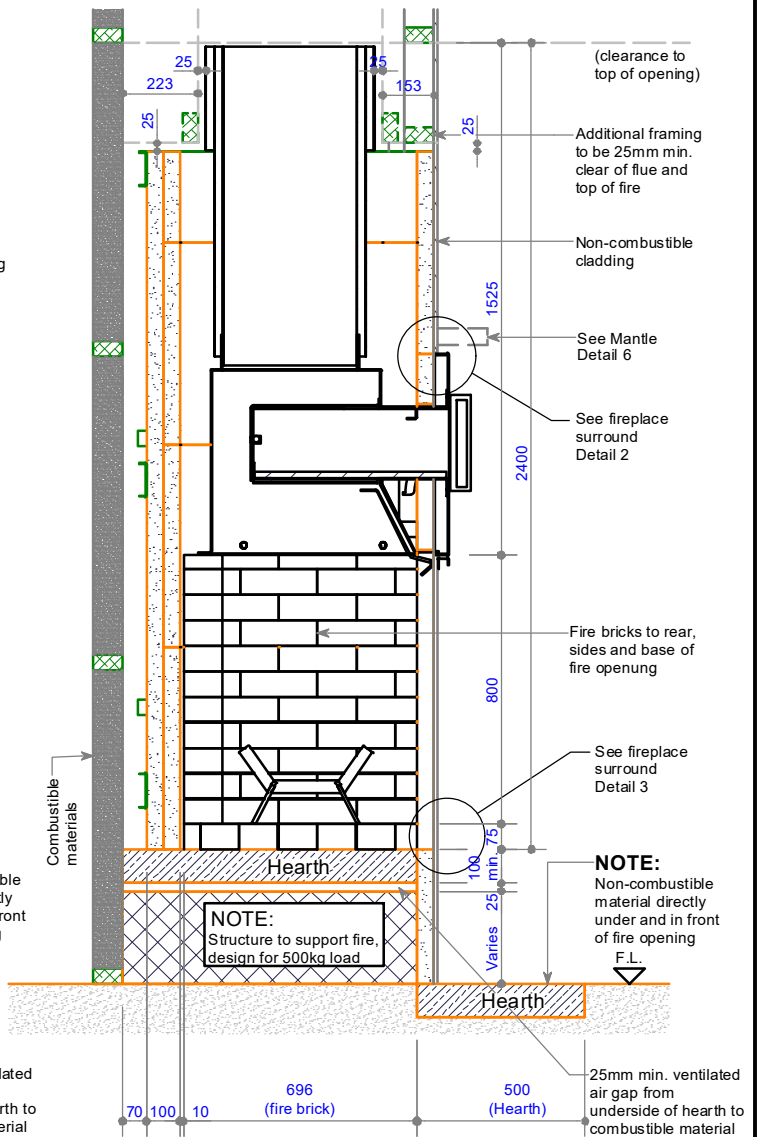

Cross Section - Fire insert on raised plinth

NOTE: Plinth height can vary to suit

NOTE:
Room requires air inlet
equal to 100 000mm²

COPYRIGHT ©
 THIS DRAWING IS THE PROPERTY
 OF The Fire Dept.

Client: THE FIRE DEPT.

Product: WD5-1200

Title: CAVITY CLEARANCES - TIMBER

Drawn: J.SCHOEMAN

Date: 24/08/2018

Chkd: J. WILSON

Date: 23/08/2018

Appd: J. WILSON

Date: 23/08/2018

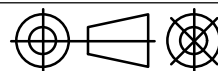

Scale: on A4

THE FIRE DEPT.
HAND CRAFTED FIRES

Drawing No. **WD5-1200-905**

Sheet 5 of 14

Revision **1**

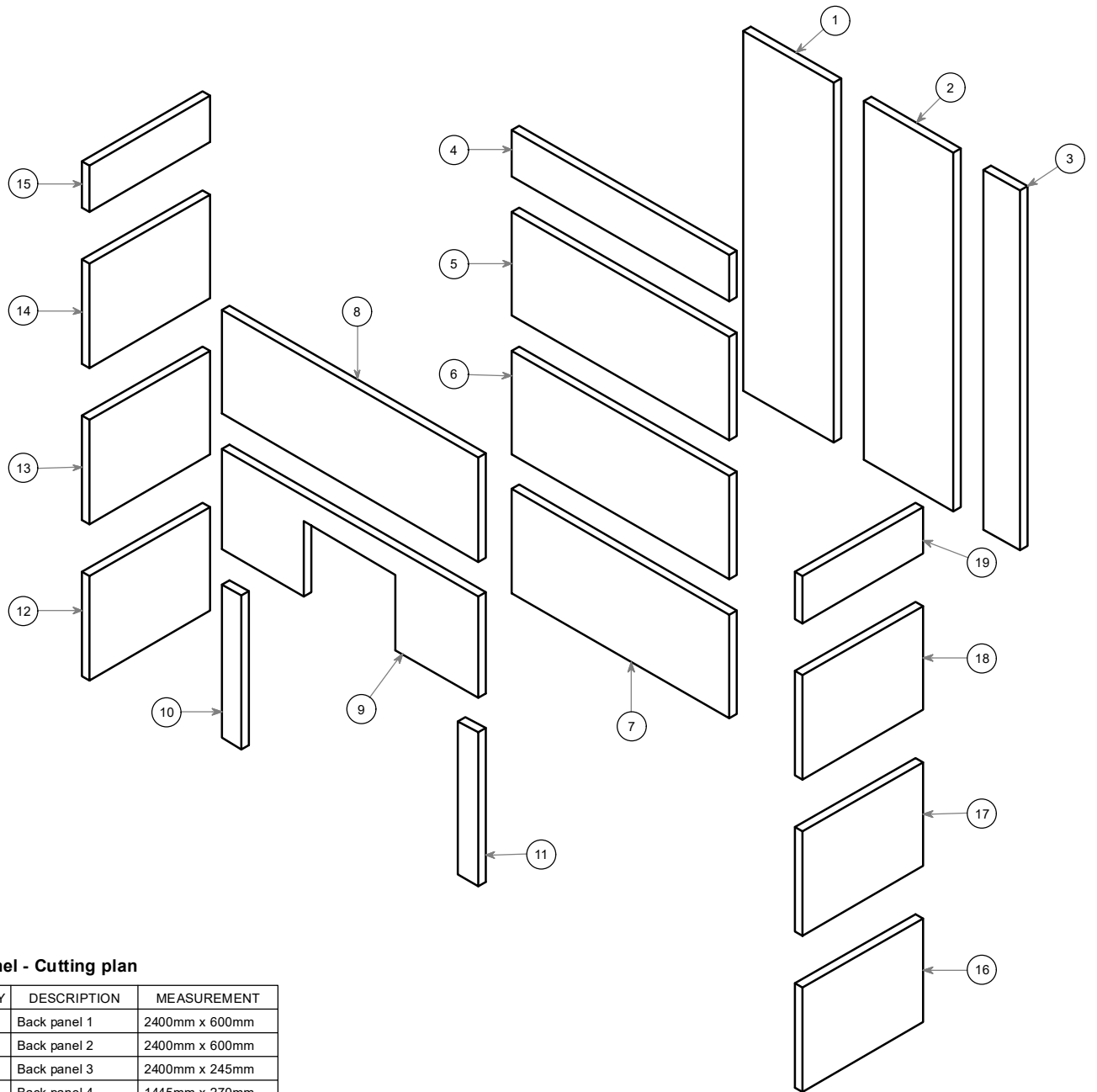

ACC panel - Cutting plan

ITEM	QTY	DESCRIPTION	MEASUREMENT
1	1	Back panel 1	2400mm x 600mm
2	1	Back panel 2	2400mm x 600mm
3	1	Back panel 3	2400mm x 245mm
4	1	Back panel 4	1445mm x 270mm
5	1	Back panel 5	1445mm x 600mm
6	1	Back panel 6	1445mm x 600mm
7	1	Back panel 7	1445mm x 600mm
8	1	Front panel 1	1710mm x 600mm
9	1	Front panel 2	1710mm x 583mm
10	1	Front panel 3	888mm x 130mm
11	1	Front panel 4	888mm x 130mm
12	1	Side panel 1	804mm x 600mm
13	1	Side panel 2	804mm x 600mm
14	1	Side panel 3	804mm x 600mm
15	1	Side panel 4	804mm x 275mm
16	1	Side panel 5	804mm x 600mm
17	1	Side panel 6	804mm x 600mm
18	1	Side panel 7	804mm x 600mm
19	1	Side panel 8	804mm x 275mm

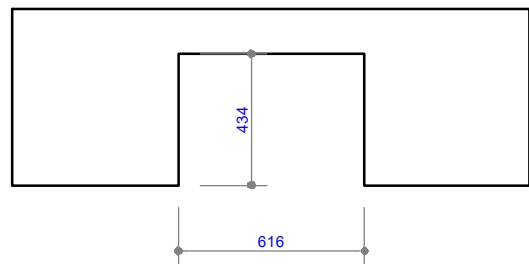

COPYRIGHT ©
 THIS DRAWING IS THE PROPERTY
 OF **The Fire Dept.**

Client: THE FIRE DEPT.	
Product: WD5-1200	
Title: AAC PANEL CUTTING PLAN - TIMBER CAVITY	
Drawn: J.SCHOEMAN	Date: 24/08/2018
Chkd: J. WILSON	Date: 23/08/2018
Appd: J. WILSON	Date: 23/08/2018
Scale:	on A4



Drawing No. WD5-1200-906	Sheet 6 of 14	Revision 1
---------------------------------	-----------------------------	-------------------

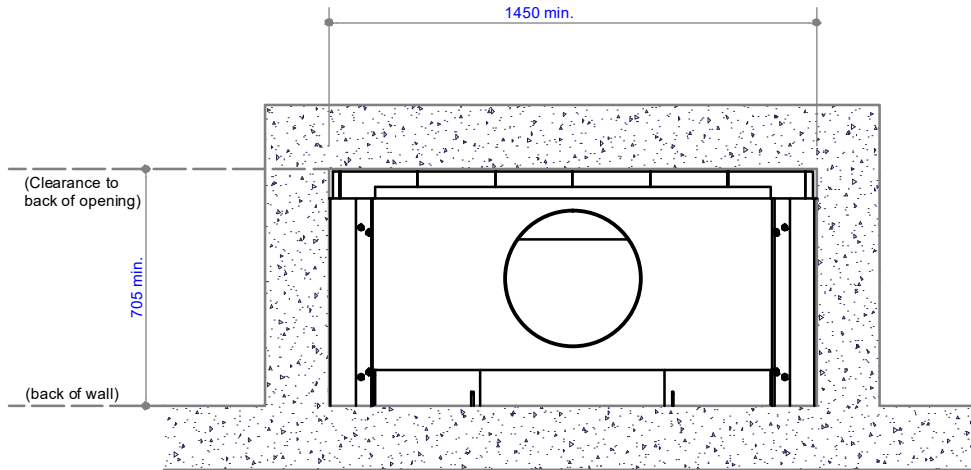

Plan View - Fire insert (above fire gather)

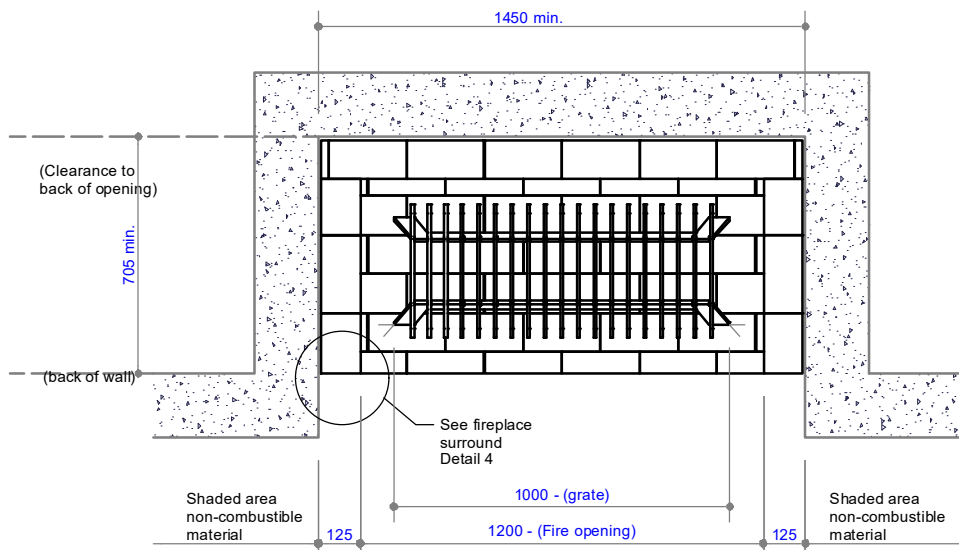

Plan View - Fire insert (below fire gather)

COPYRIGHT ©
 THIS DRAWING IS THE PROPERTY
 OF **The Fire Dept.**

Client: THE FIRE DEPT.

Product: WD5-1200

Title: CAVITY CLEARANCES - CONCRETE

Drawn: J.SCHOEMAN

Date: 24/08/2018

Chkd: J. WILSON

Date: 23/08/2018

Appd: J. WILSON

Date: 23/08/2018

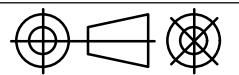

Scale: on A4



Drawing No. **WD5-1200-907**

Sheet 7 of 14

Revision **1**

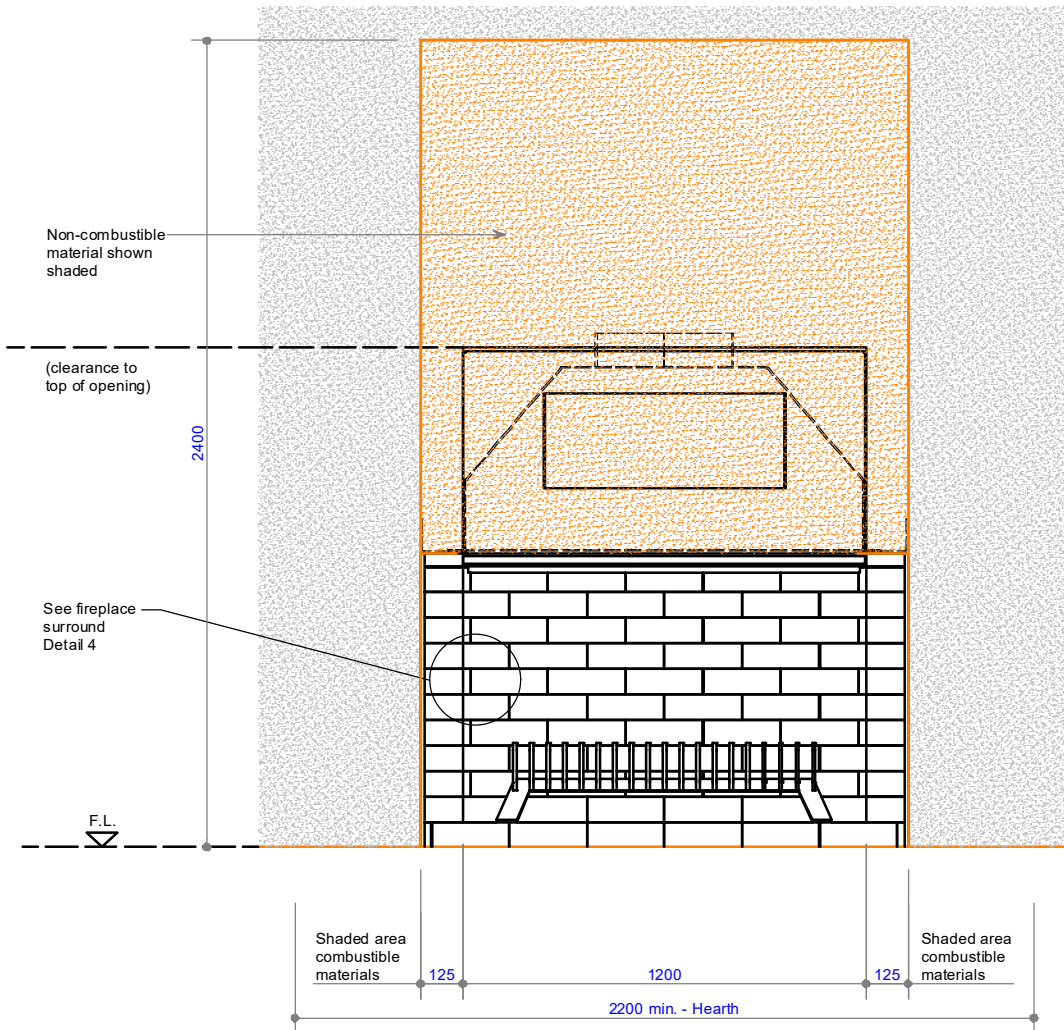

Front view - Fire insert

COPYRIGHT ©
 THIS DRAWING IS THE PROPERTY
 OF **The Fire Dept.**

Client: THE FIRE DEPT.

Product: WD5-1200

Title: CAVITY CLEARANCES - CONCRETE

Drawn: J.SCHOEMAN

Date: 24/08/2018

Chkd: J. WILSON

Date: 23/08/2018

Appd: J. WILSON

Date: 23/08/2018

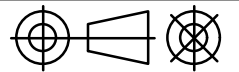

Scale: on A4



Drawing No. **WD5-1200-908**

Sheet 8 of 14

Revision **1**

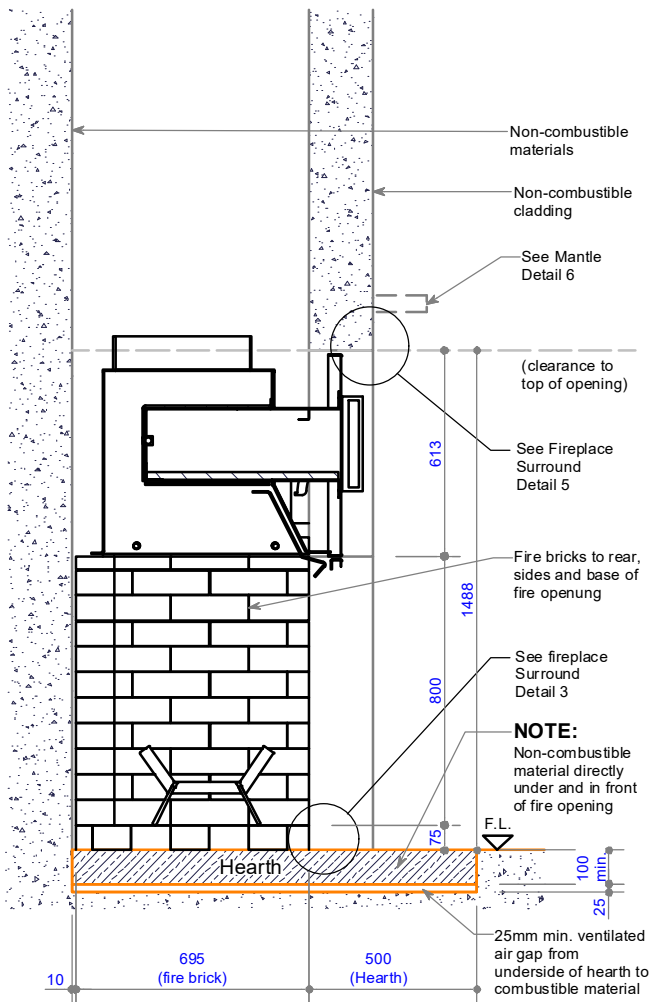

Cross Section - Fire insert at floor level

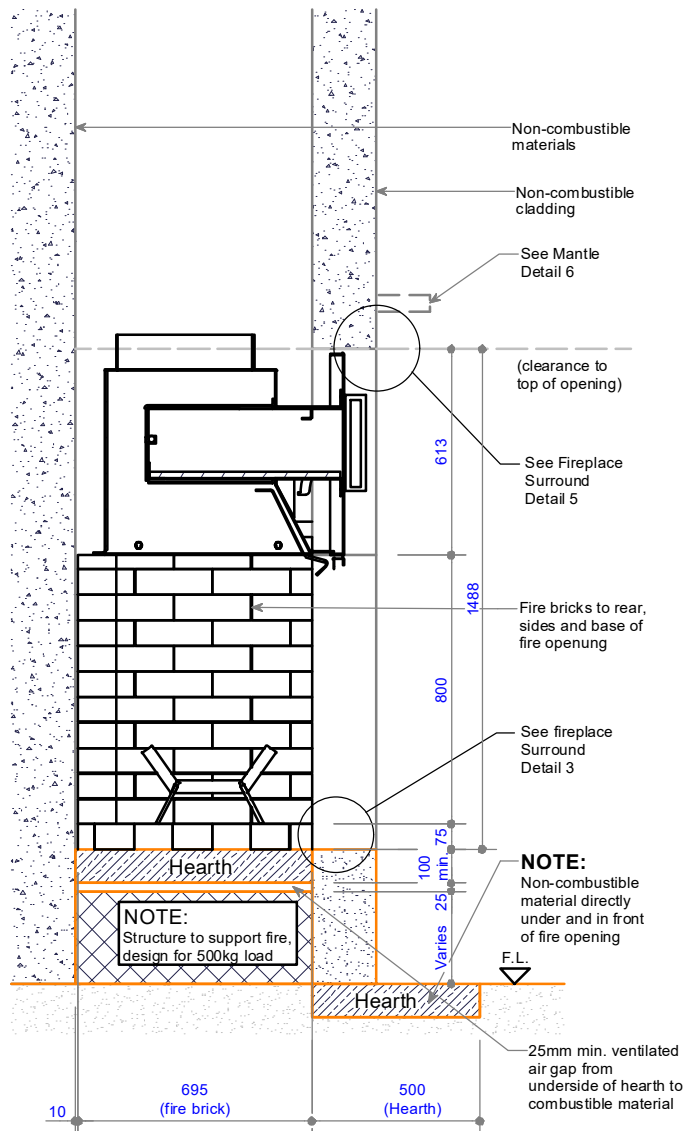

Cross Section - Fire insert on raised plinth

NOTE: Plinth height can vary to suit

NOTE:
Room requires air inlet equal to 100 000mm²

COPYRIGHT ©
 THIS DRAWING IS THE PROPERTY
 OF **The Fire Dept.**

Client: THE FIRE DEPT.

Product: WD5-1200

Title: CAVITY CLEARANCES - CONCRETE

Drawn: J.SCHOEMAN

Date: 24/08/2018

Chkd: J. WILSON

Date: 23/08/2018

Appd: J. WILSON

Date: 23/08/2018

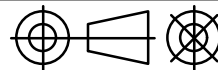

Scale: on A4



Drawing No. **WD5-1200-909**

Sheet 9 of 14

Revision **1**

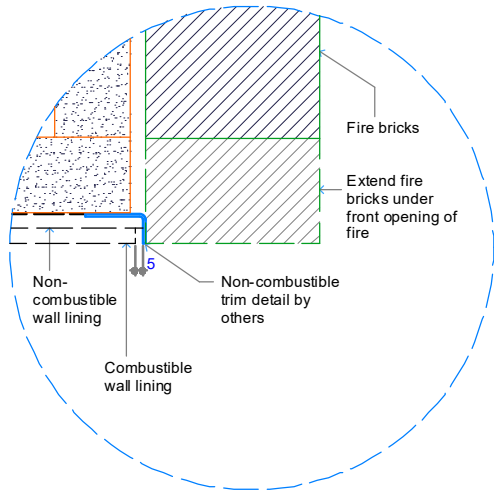

**Detail 1 - Plan View Fire Surround Opt. 1
Timber Cavity**

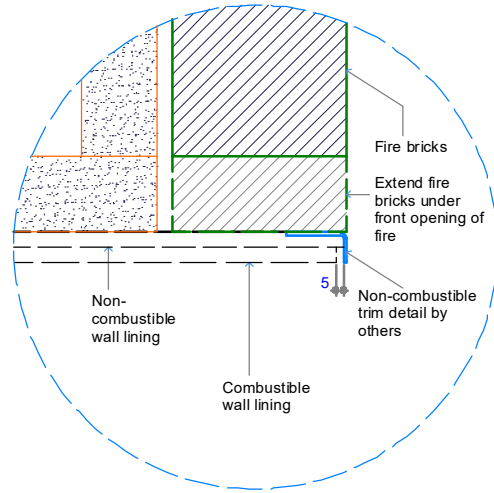

**Detail 1 - Plan View Fire Surround Opt. 2
Timber Cavity**

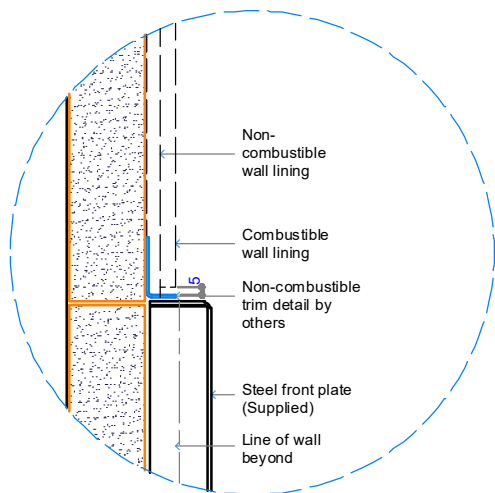

**Detail 2 - Cross Section Fire Surround Opt. 3
Timber Cavity**

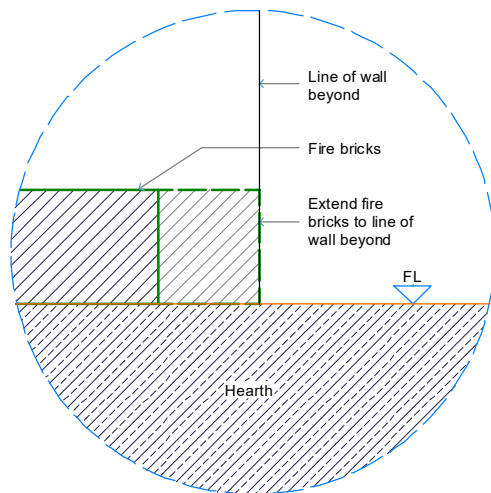

**Detail 3 - Cross Section Fire Surround Opt. 4
Timber Cavity**

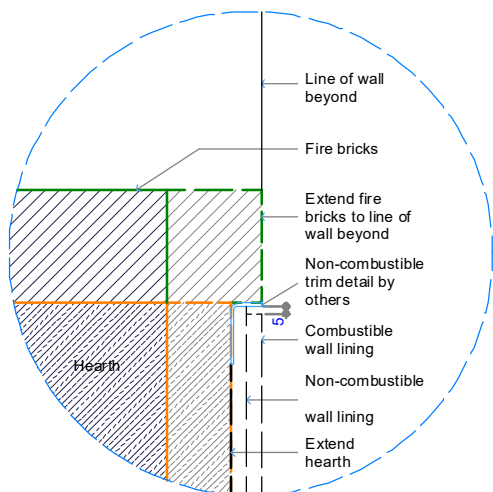

**Detail 3 - Cross Section Fire Surround Opt. 5
Timber Cavity**

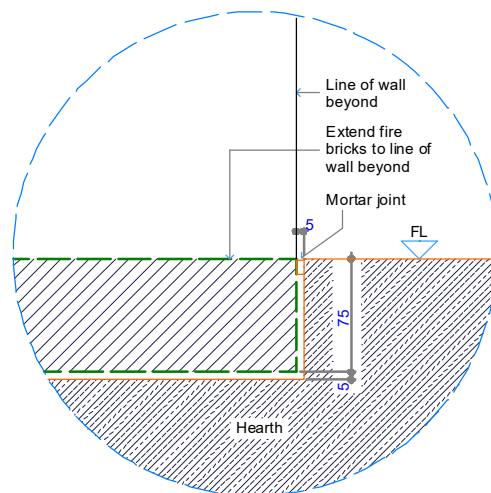

**Detail 3 - Cross Section Fire Surround Opt. 6
Concrete Cavity**

COPYRIGHT ©
 THIS DRAWING IS THE PROPERTY
 OF **The Fire Dept.**

Client: THE FIRE DEPT.

Product: WD5-1200

Title: SURROUND DETAILS

Drawn: J.SCHOEMAN

Date: 24/08/2018

Chkd: J. WILSON

Date: 23/08/2018

Appd: J. WILSON

Date: 23/08/2018

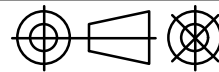

Scale: on A4



Drawing No. **WD5-1200-910**

Sheet 10 of 14

Revision **1**

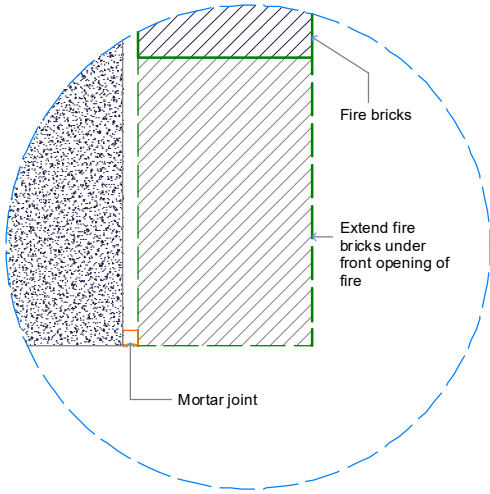

**Detail 4 - Plan View Fire Surround Opt. 7
Concrete Cavity**

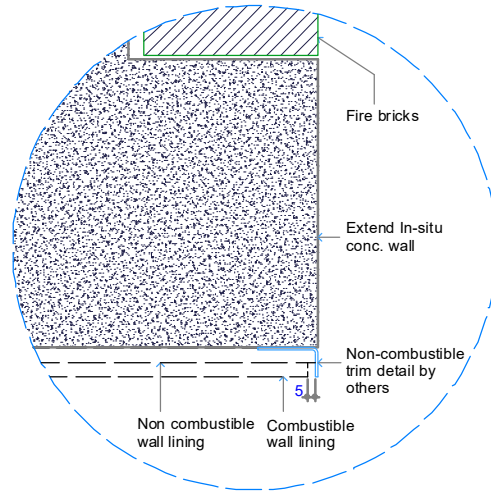

**Detail 4 - Plan View Fire Surround Opt. 8
Concrete Cavity**

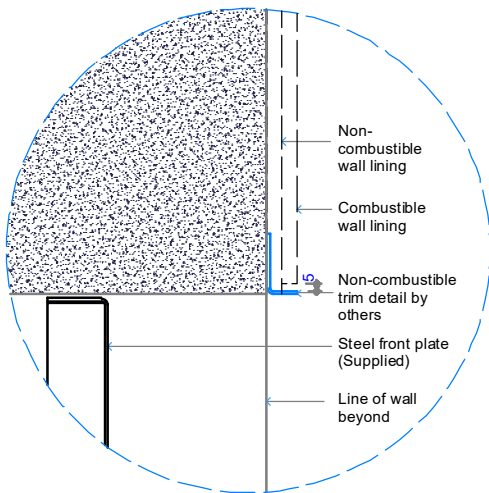

**Detail 5 - Cross Section Fire Surround Opt. 3
Concrete Cavity**

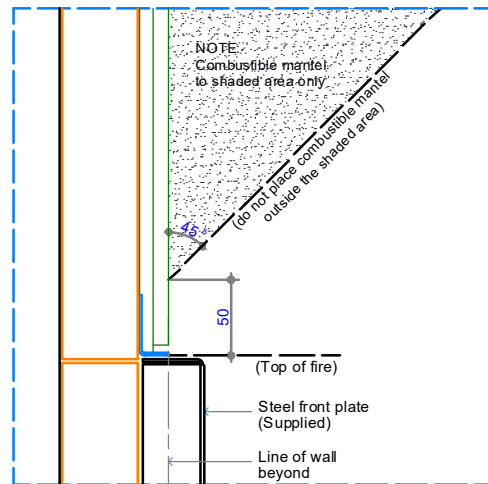

Detail 6 - Top of Fire to Combustible Mantel

COPYRIGHT ©
 THIS DRAWING IS THE PROPERTY
 OF **The Fire Dept.**

Client: THE FIRE DEPT.

Product: WD5-1200

Title: SURROUND DETAILS

Drawn: J.SCHOEMAN

Date: 24/08/2018

Chkd: J. WILSON

Date: 23/08/2018

Appd: J. WILSON

Date: 23/08/2018

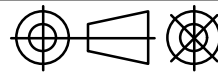

Scale: on A4



Drawing No. **WD5-1200-911**

Sheet 11 of 14

Revision **1**

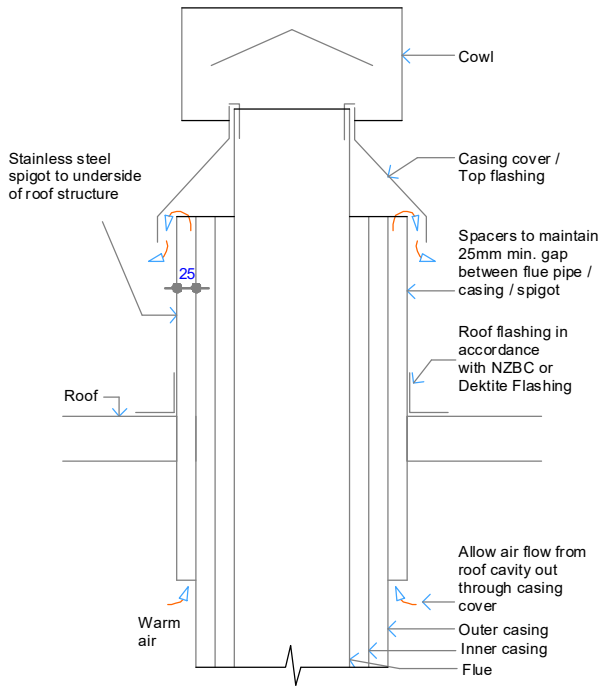

Detail Roof - Air Ventilation through Casing cover / Top flashing

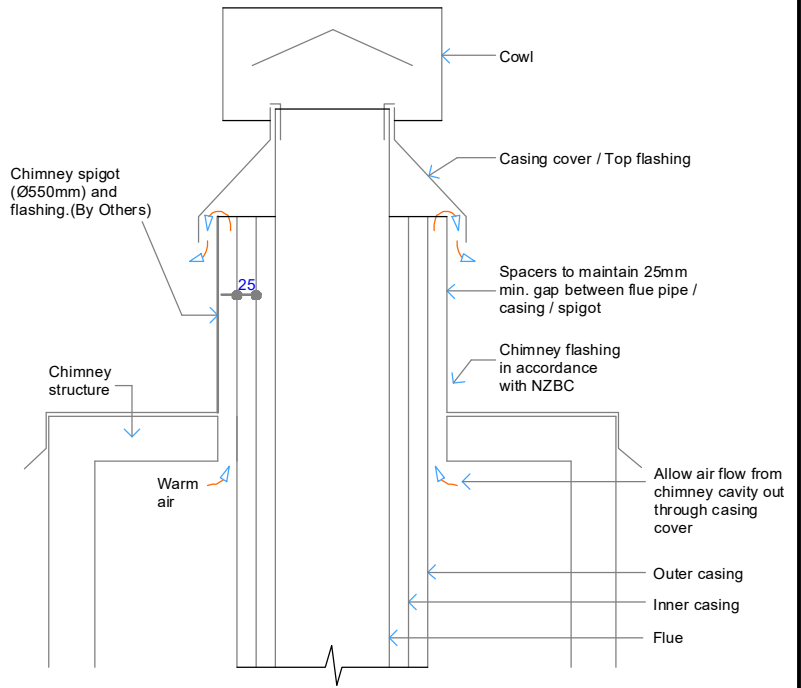

Detail Chimney - Air Ventilation through Casing cover / Top flashing Opt. 2

Flue components:
 400mm dia. Flue
 450mm dia. Inner Casing
 500mm dia. Outer Casing
 550mm dia. S/S Spigot
 Deklite Soaker Flashing DF606

NOTE:
 Flue components must be installed to AS/NZS2918:2001 requirements.
 All external penetration flashings must be installed in accordance with NZBC.
 Cavity airflow must be unobstructed from fire box to flue termination.
 25mm clearance between flue and combustible materials.
 75mm clearance between flue and wiring / plastic water pipes.
 Each flue joint must be sealed with a heat proof sealer.
 Each flue joint must have a minimum of 4 x Stainless Steel rivets.
 Flue to be adequately supported at 2m crs.

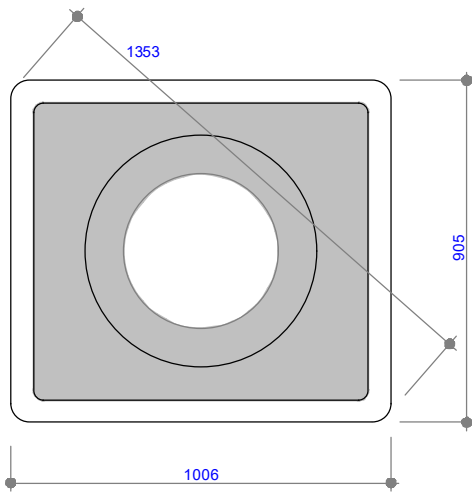

Dektite Soaker Flashing DF606 Plan View

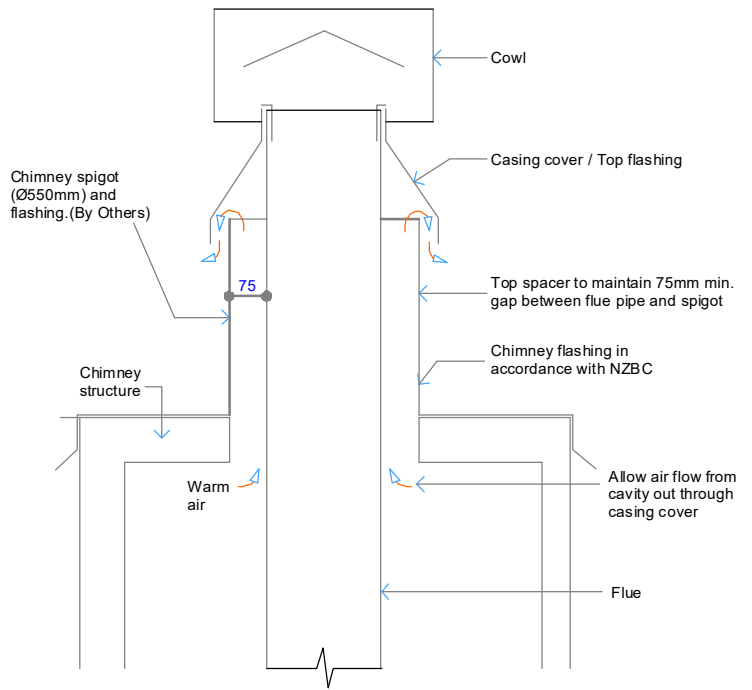

Detail Chimney - Air Ventilation through Casing cover / Top flashing Opt. 3 (CONCRETE ONLY!)

Flue components:
 400mm dia. Flue
 550mm dia. Spigot

COPYRIGHT ©
 THIS DRAWING IS THE PROPERTY
 OF The Fire Dept.

Client: THE FIRE DEPT.	
Product: WD5-1200	
Title: VERTICAL FLUE EXIT DETAILS	
Drawn: J.SCHOEMAN	Date: 24/08/2018
Chkd: J. WILSON	Date: 23/08/2018
Appd: J. WILSON	Date: 23/08/2018
Scale:	on A4



Drawing No.	WD5-1200-912	Sheet 12 of 14	Revision 1
-------------	---------------------	----------------	-------------------

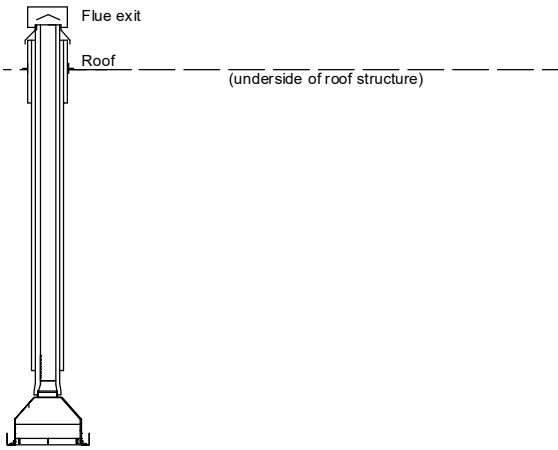

Vertical Flue Combination WD5A

NOTE:
 Flue components must be installed to AS/NZS2918:2001 requirements.
 All external penetration flashings must be installed in accordance with NZBC.
 Cavity airflow must be unobstructed from fire box to flue termination.
 25mm clearance between flue and combustible materials.
 75mm clearance between flue and wiring / plastic water pipes.
 Each flue joint must be sealed with a heat proof sealer.
 Each flue joint must have a minimum of 4 x Stainless Steel rivets.
 Flue to be adequately supported at 2m crs.

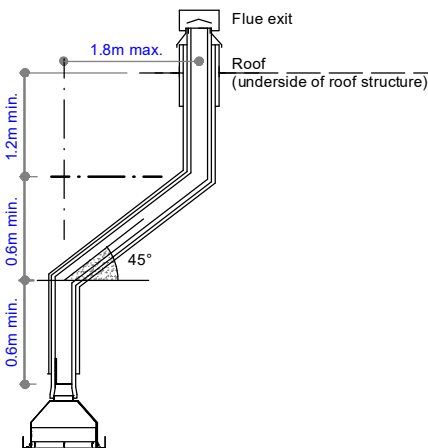

Vertical Flue Combination WD5B

NOTE:
 Flue components must be installed to AS/NZS2918:2001 requirements.
 All external penetration flashings must be installed in accordance with NZBC.
 Cavity airflow must be unobstructed from fire box to flue termination.
 25mm clearance between flue and combustible materials.
 75mm clearance between flue and wiring / plastic water pipes.
 Each flue joint must be sealed with a heat proof sealer.
 Each flue joint must have a minimum of 4 x Stainless Steel rivets.
 Flue to be adequately supported at 2m crs.

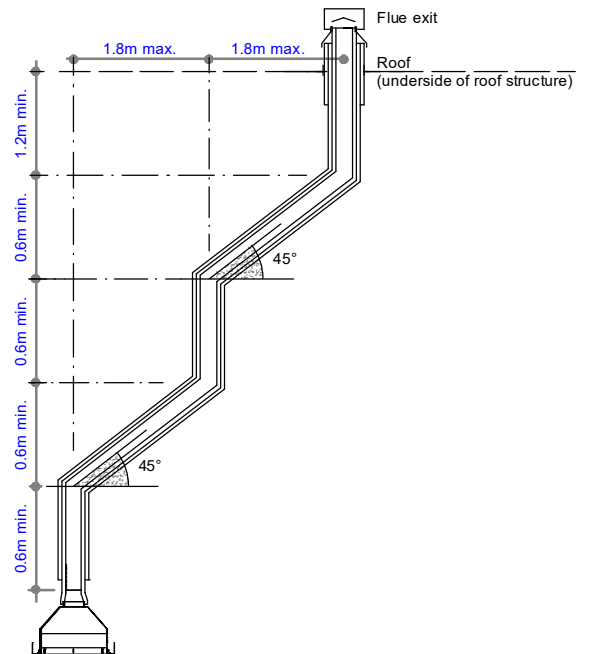

Vertical Flue Combination WD5C

NOTE:
 Flue components must be installed to AS/NZS2918:2001 requirements.
 All external penetration flashings must be installed in accordance with NZBC.
 Cavity airflow must be unobstructed from fire box to flue termination.
 25mm clearance between flue and combustible materials.
 75mm clearance between flue and wiring / plastic water pipes.
 Each flue joint must be sealed with a heat proof sealer.
 Each flue joint must have a minimum of 4 x Stainless Steel rivets.
 Flue to be adequately supported at 2m crs.

COPYRIGHT ©
 THIS DRAWING IS THE PROPERTY
 OF The Fire Dept.

Client: THE FIRE DEPT.	
Product: WD5-1200	
Title: VERTICAL FLUE COMBINATION OPTIONS	
Drawn: J.SCHOEMAN	Date: 24/08/2018
Chkd: J. WILSON	Date: 23/08/2018
Appd: J. WILSON	Date: 23/08/2018
Scale: on A4	



Drawing No. WD5-1200-913	Sheet 13 of 14	Revision 1
---------------------------------	----------------	-------------

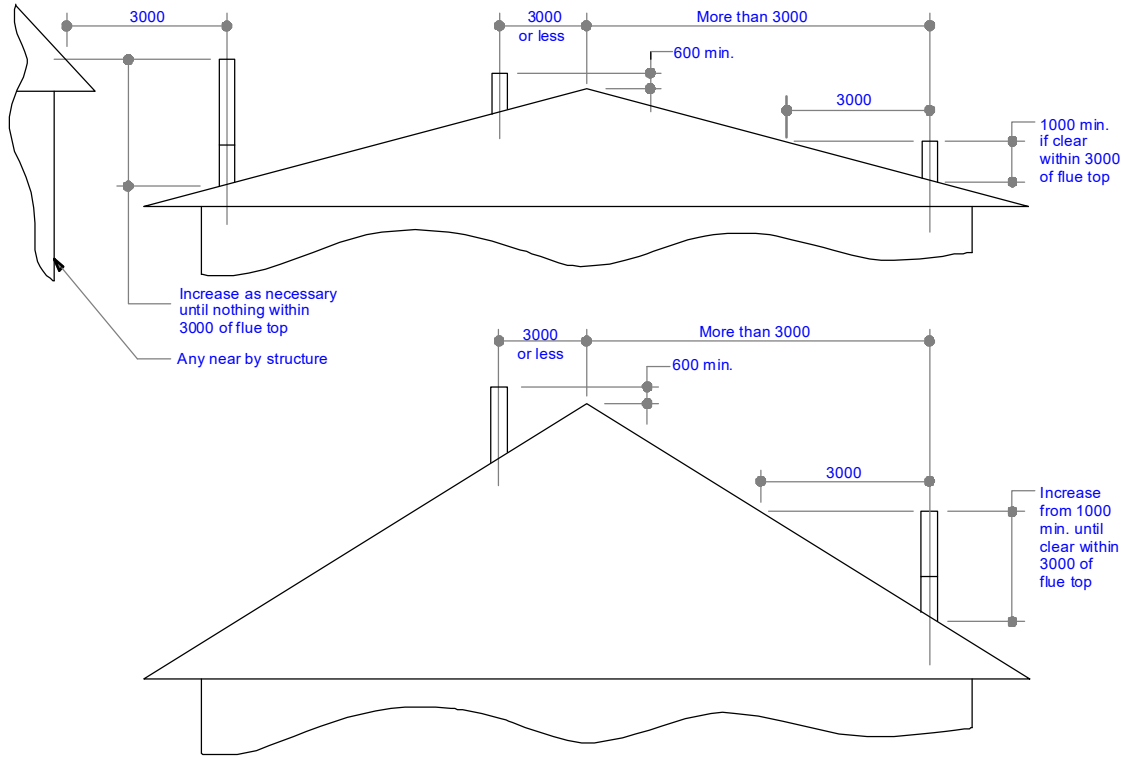

Minimum Height of Flue System Exit
Or as per AS/NZS 2918:2001

COPYRIGHT ©
 THIS DRAWING IS THE PROPERTY
 OF **The Fire Dept.**

Client: THE FIRE DEPT.

Product: WD5-1200

Title: FLUE EXIT CLEARANCES

Drawn: J.SCHOEMAN

Date: 24/08/2018

Chkd: J. WILSON

Date: 23/08/2018

Appd: J. WILSON

Date: 23/08/2018

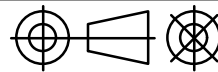

Scale: on A4



Drawing No. **WD5-1200-914**

Sheet 14 of 14

Revision **1**