

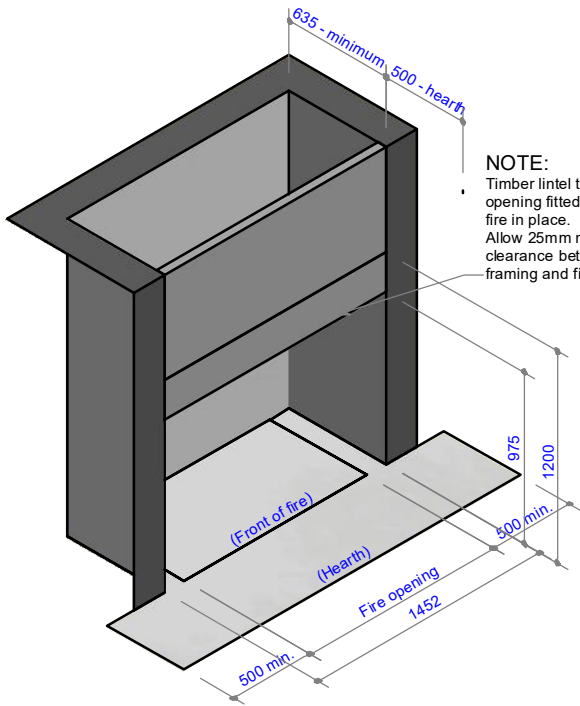

WD6-1200

Specifications

Information in this specification may be subject to change without notice. Please ensure you have the current version before beginning installation.



NOTE:
Timber lintel to suit opening fitted after fire in place. Allow 25mm min. clearance between framing and fire box

Fire installation requirements & Hearth size - Timber cavity

NOTE: Hearth to extend minimum of 500mm both sides of the fire opening, and 500mm from front of fire opening. Framed cavity must be vented at the bottom. Air inlet to be equal or greater than 15 000mm².

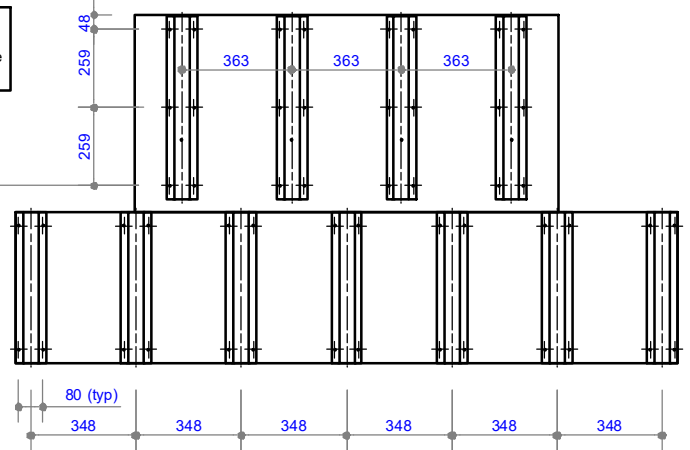

Bottom View

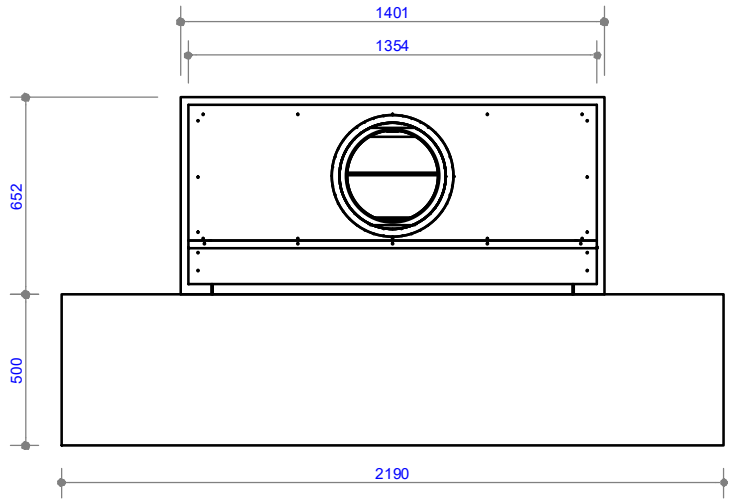

Top View

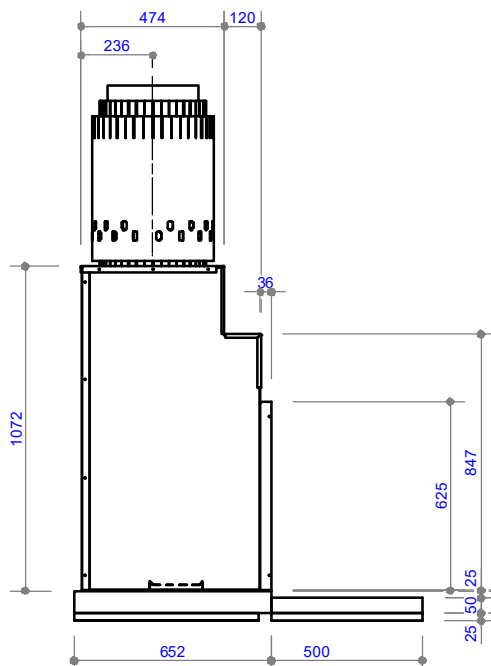

Side View

TOLERANCE = +/- 3mm

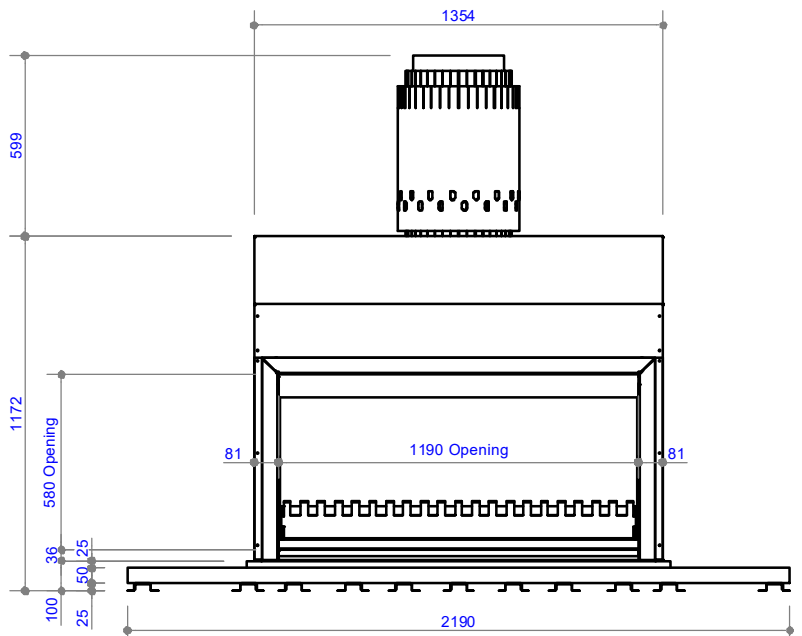

Front View

COPYRIGHT©
THIS DRAWING IS THE PROPERTY
OF **The Fire Dept.**

Client: THE FIRE DEPT.

Product: WD6-1200

Title: FIRE DIMENSIONS

Drawn: J.SCHOEMAN

Date: 03/10/2018

Chkd: J. WILSON

Date: 03/10/2018

Appd: J. WILSON

Date: 03/10/2018

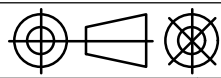

Scale: on A4

THE FIRE DEPT.
HAND CRAFTED FIRES

Drawing No. **WD6-1200-901**

Sheet 1 of 8

Revision **1**

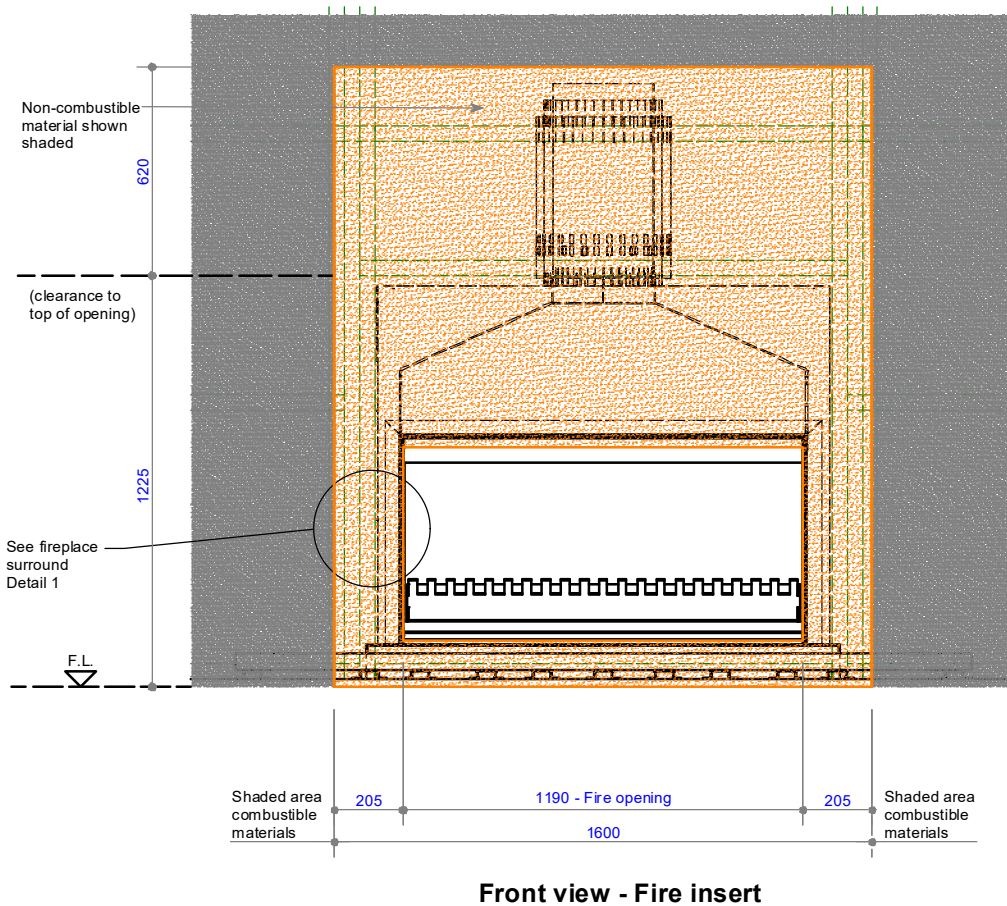
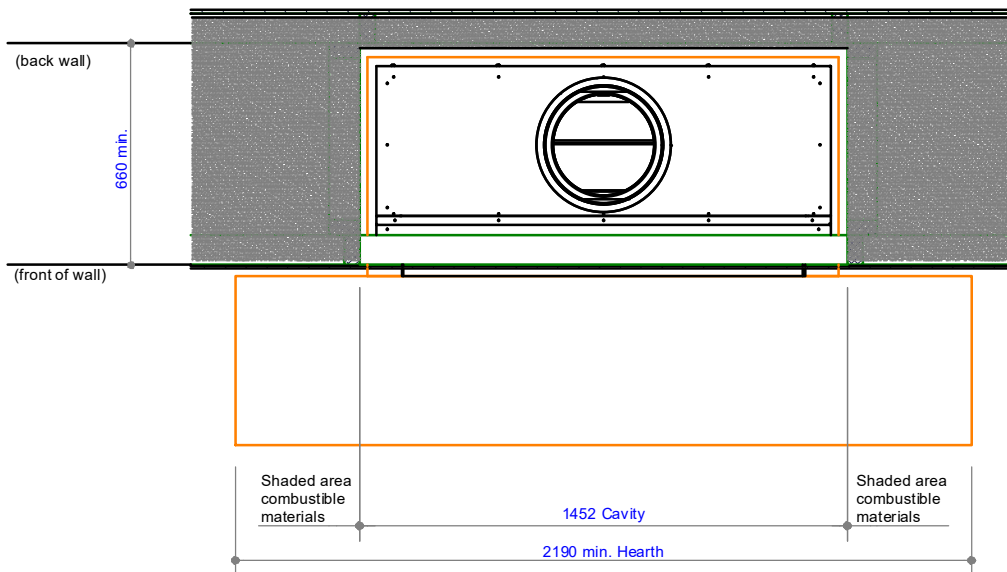

Client: THE FIRE DEPT.			
Product: WD6-1200			
Title: CAVITY CLEARANCES - TIMBER			
Drawn: J SCHOEMAN	Date: 03/10/2018		
Chkd: J. WILSON	Date: 03/10/2018		
Appd: J. WILSON	Date: 03/10/2018	Scale:	on A4
Drawing No.	WD6-1200-902		Sheet

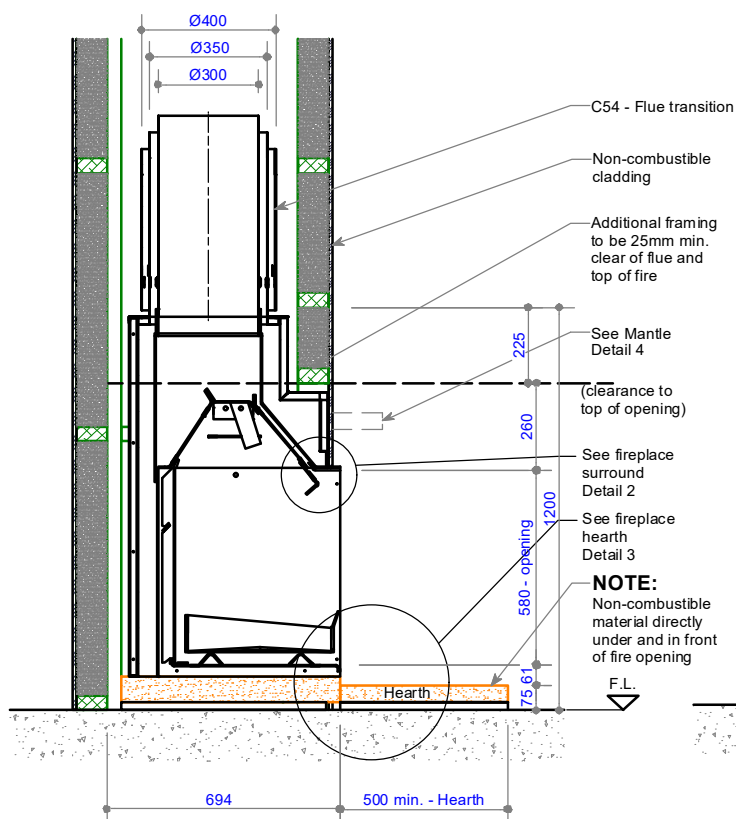

Cross Section - Fire insert at floor level

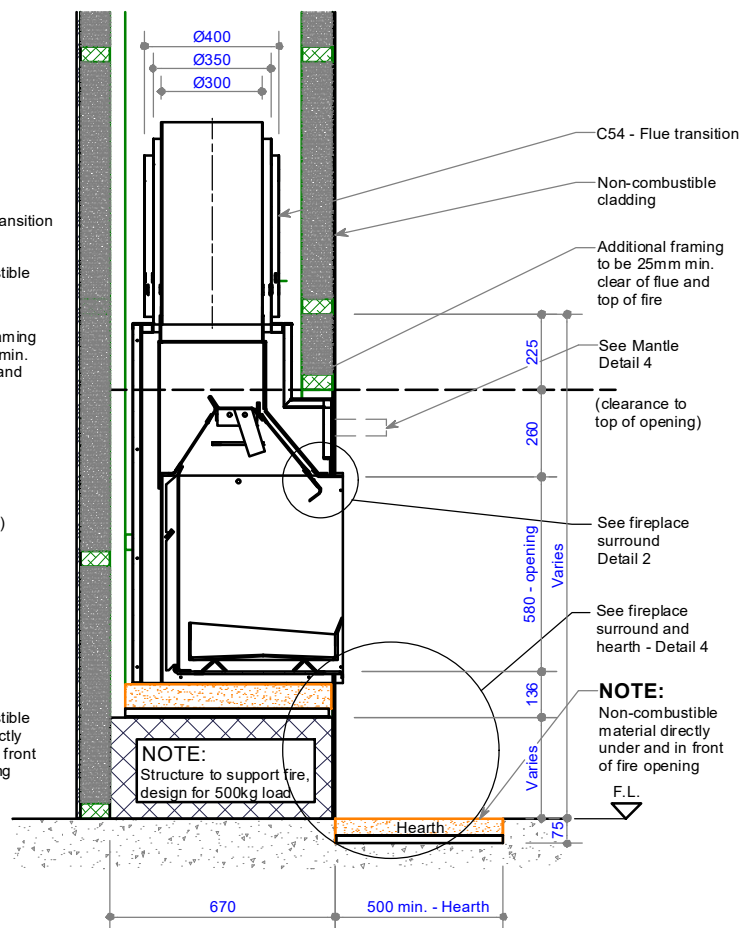

Cross Section - Fire insert at floor level

NOTE:
Room requires air inlet
equal to 100 000mm²

COPYRIGHT©
THIS DRAWING IS THE PROPERTY
OF The Fire Dept.

Client: THE FIRE DEPT.

Product: WD6-1200

Title: CAVITY CLEARANCES - TIMBER

Drawn: J.SCHOEMAN

Date: 03/10/2018

Chkd: J. WILSON

Date: 03/10/2018

Appd: J. WILSON

Date: 03/10/2018

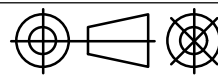

Scale: on A4

THE
**FIRE
DEPT.**
HAND CRAFTED FIRES

Drawing No. **WD6-1200-903**

Sheet 3 of 8

Revision 1

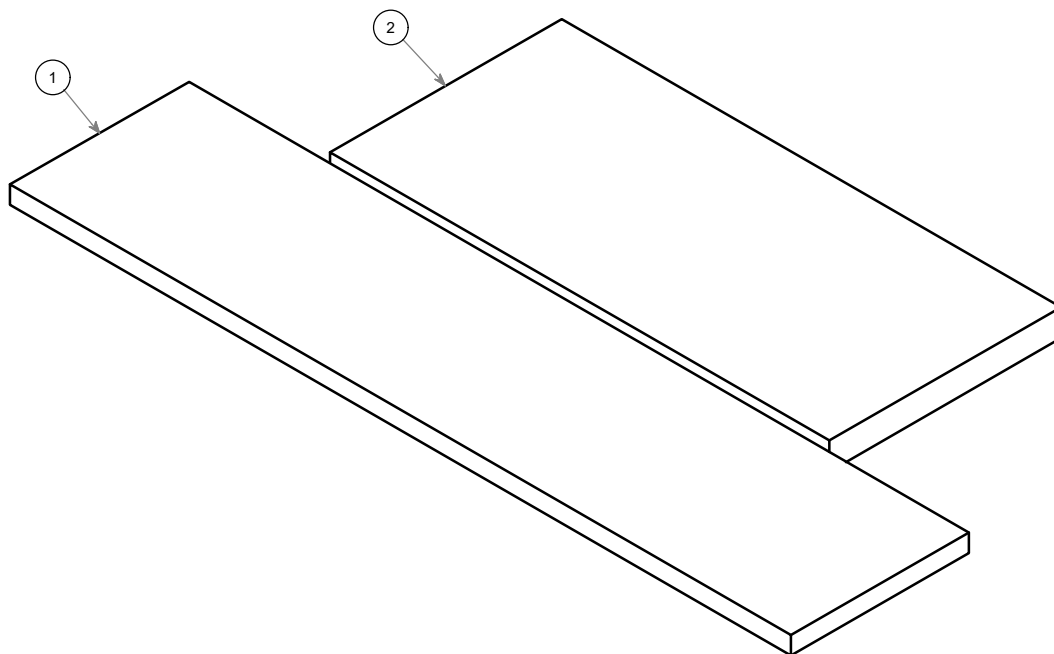

AAC panel - Cutting plan

ITEM	QTY	DESCRIPTION	MEASUREMENT
1	1	Hearth AAC panel	500mm x 2190mm x 50mm
2	1	Firebox base AAC panel (Fireplace flush with floor)	651mm x 1401mm x 75mm
2	1	Firebox base AAC panel (Fireplace raised above floor)	615mm x 1401mm x 75mm

COPYRIGHT©

THIS DRAWING IS THE PROPERTY

OF The Fire Dept.

Client: THE FIRE DEPT.

Product: WD6-1200

Title: AAC PANEL CUTTING PLAN - TIMBER CAVITY

Drawn: J.SCHOEMAN

Date: 03/10/2018

Chkd: J. WILSON

Date: 03/10/2018

Appd: J. WILSON

Date: 03/10/2018

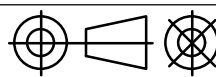

Scale: on A4

THE FIRE DEPT.
HAND CRAFTED FIRES

Drawing No. **WD6-1200-904**

Sheet 4 of 8

Revision **1**

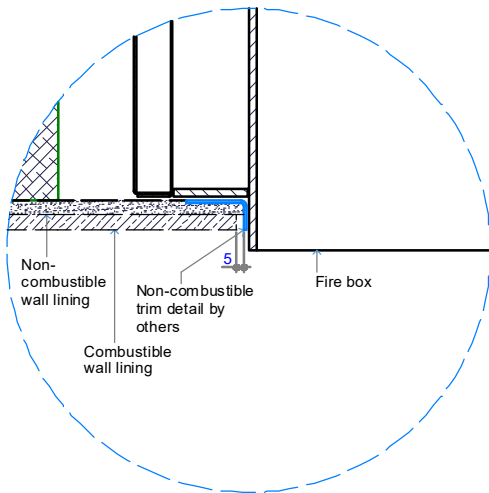

Detail 1 - Plan View Fire Surround

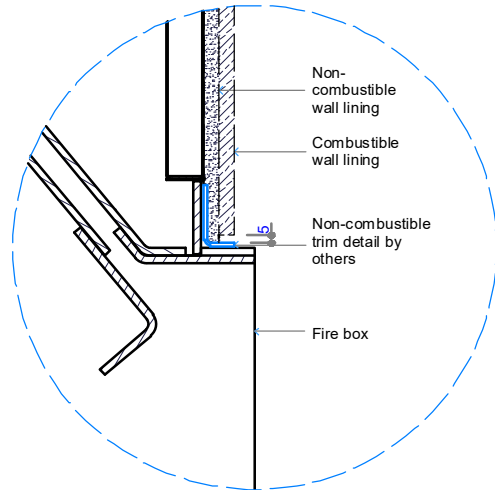

Detail 2 - Cross Section Fire Surround

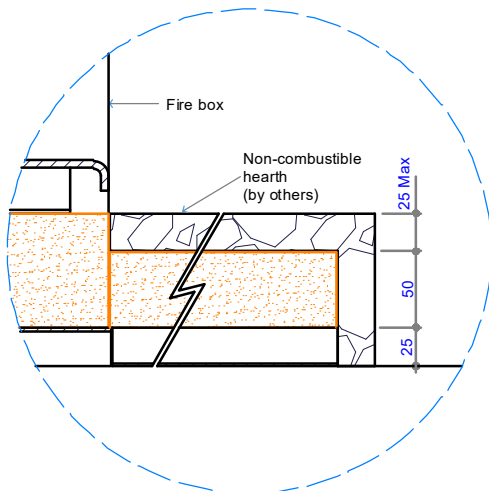

Detail 3 - Cross Section Fire hearth - Opt. 1

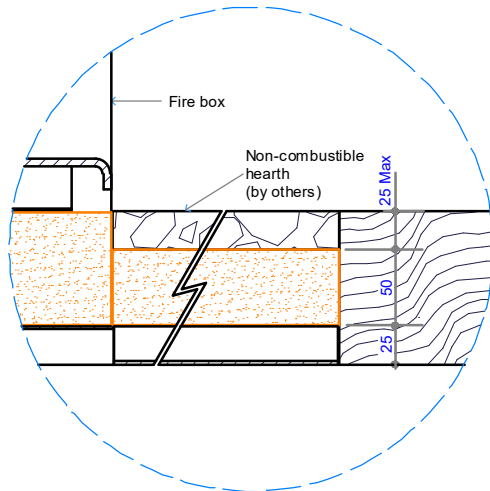

Detail 3 - Cross Section Fire hearth - Opt. 2

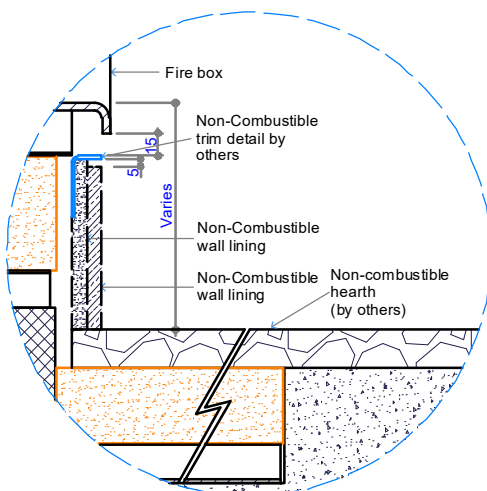

Detail 4 - Cross Section Fire Surround

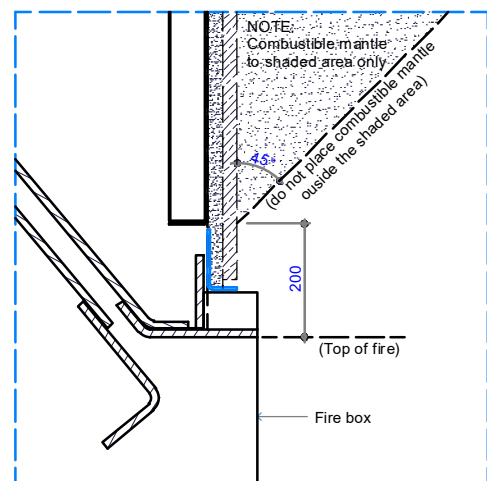

Detail 5 - Top of Fire to Combustible Mantle

COPYRIGHT©
THIS DRAWING IS THE PROPERTY
OF The Fire Dept.

Client: THE FIRE DEPT.

Product: WD6-1200

Title: SURROUND DETAILS

Drawn: J.SCHOEMAN

Date: 03/10/2018

Chkd: J. WILSON

Date: 03/10/2018

Appd: J. WILSON

Date: 03/10/2018

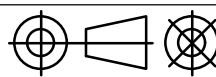

Scale: on A4

THE
**FIRE
DEPT.**
HAND CRAFTED FIRES

Drawing No. **WD6-1200-905**

Sheet 5 of 8

Revision **1**

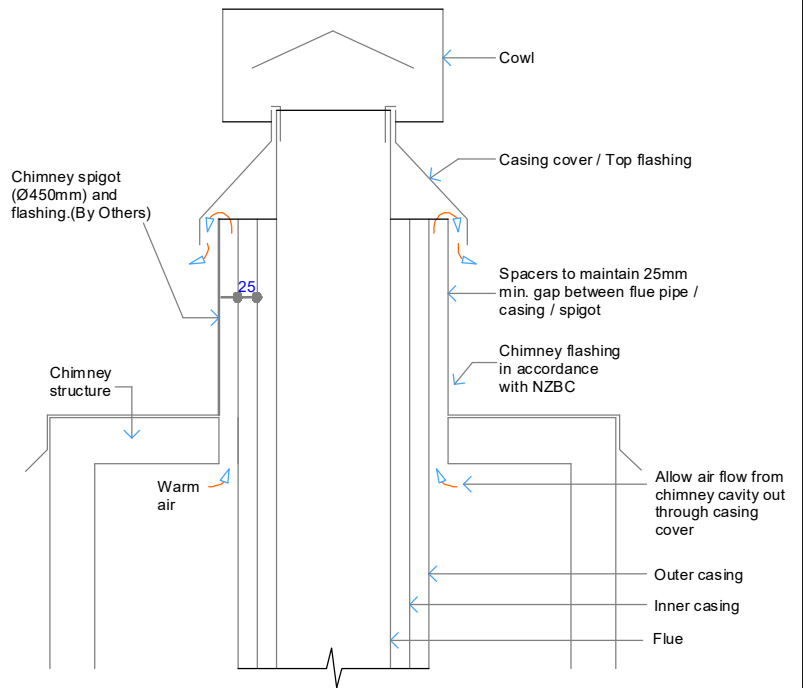
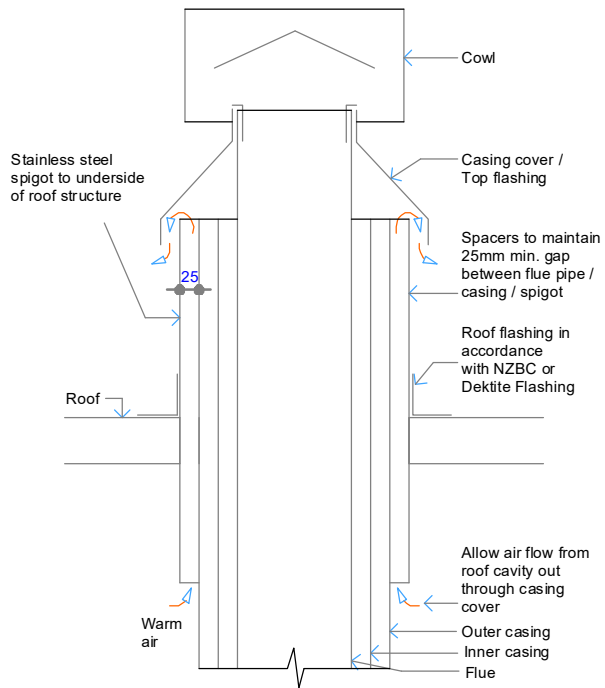

Detail Roof - Air Ventilation through Casing cover / Top flashing

Detail Chimney - Air Ventilation through Casing cover / Top flashing Opt. 2

Flue components:
300mm dia. Flue
350mm dia. Inner Casing
400mm dia. Outer Casing
450mm dia. S/S Spigot
Deklite Flashing No. 9

NOTE:
Flue components must be installed to AS/NZS2918:2001 requirements.
All external penetration flashings must be installed in accordance with NZBC.
Cavity airflow must be unobstructed from fire box to flue termination.
25mm clearance between flue and combustible materials.
75mm clearance between flue and wiring / plastic water pipes.
Each flue joint must be sealed with a heat proof sealer.
Each flue joint must have a minimum of 4 x Stainless Steel rivets.
Flue to be adequately supported at 2m crs.

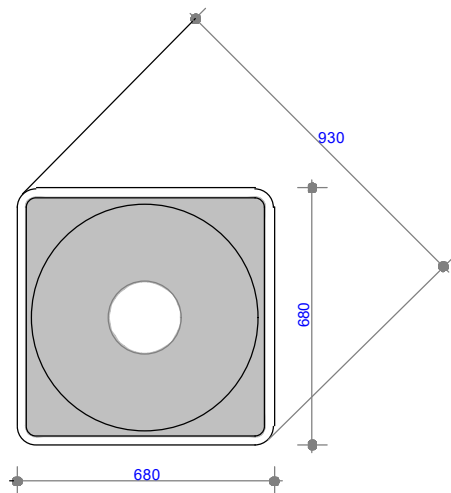

Deklite Flashing No. 9 - Plan View

COPYRIGHT©
THIS DRAWING IS THE PROPERTY
OF **The Fire Dept.**

Client: THE FIRE DEPT.

Product: WD6-1200

Title: VERTICAL FLUE EXIT DETAILS

Drawn: J.SCHOEMAN

Date: 03/10/2018

Chkd: J. WILSON

Date: 03/10/2018

Appd: J. WILSON

Date: 03/10/2018

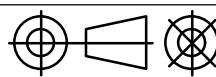

Scale: on A4

THE FIRE DEPT.
HAND CRAFTED FIRES

Drawing No. **WD6-1200-906**

Sheet 6 of 8

Revision **1**

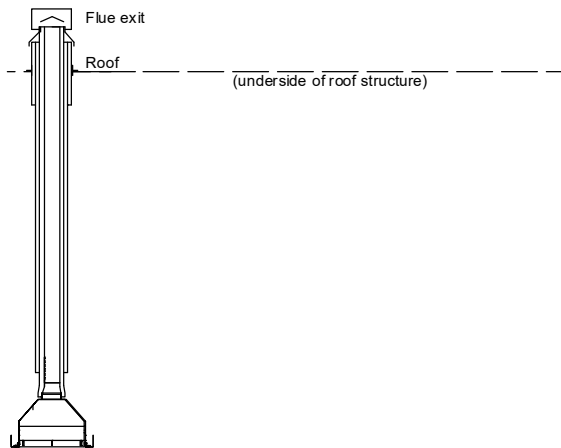

Vertical Flue Combination WD6A

NOTE:

Flue components must be installed to AS/NZS2918:2001 requirements.
All external penetration flashings must be installed in accordance with NZBC.
Cavity airflow must be unobstructed from fire box to flue termination.
25mm clearance between flue and combustible materials.
75mm clearance between flue and wiring / plastic water pipes.
Each flue joint must be sealed with a heat proof sealer.
Each flue joint must have a minimum of 4 x Stainless Steel rivets.
Flue to be adequately supported at 2m crs.

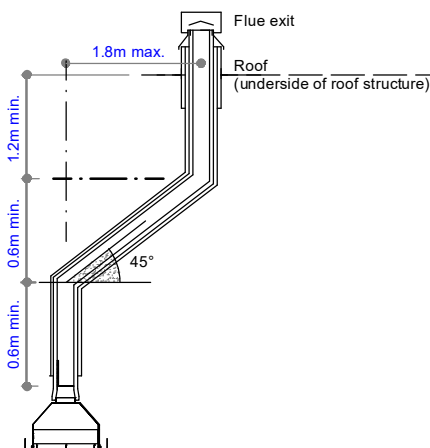

Vertical Flue Combination WD6B

NOTE:

Flue components must be installed to AS/NZS2918:2001 requirements.
All external penetration flashings must be installed in accordance with NZBC.
Cavity airflow must be unobstructed from fire box to flue termination.
25mm clearance between flue and combustible materials.
75mm clearance between flue and wiring / plastic water pipes.
Each flue joint must be sealed with a heat proof sealer.
Each flue joint must have a minimum of 4 x Stainless Steel rivets.
Flue to be adequately supported at 2m crs.

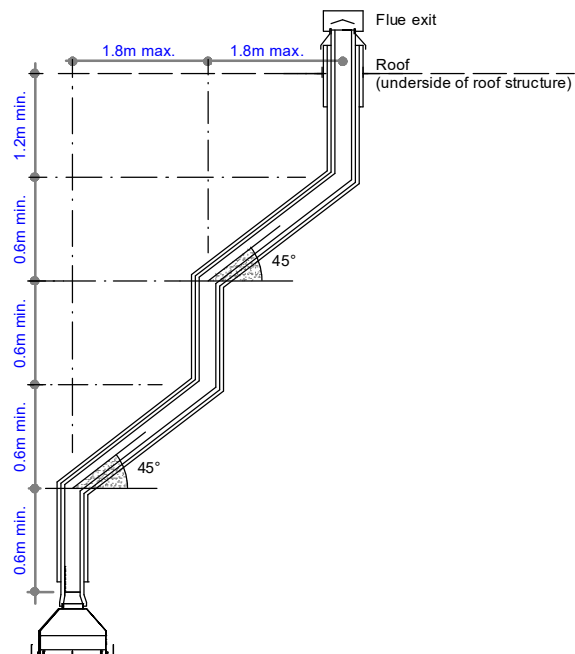

Vertical Flue Combination WD6C

NOTE:

Flue components must be installed to AS/NZS2918:2001 requirements.
All external penetration flashings must be installed in accordance with NZBC.
Cavity airflow must be unobstructed from fire box to flue termination.
25mm clearance between flue and combustible materials.
75mm clearance between flue and wiring / plastic water pipes.
Each flue joint must be sealed with a heat proof sealer.
Each flue joint must have a minimum of 4 x Stainless Steel rivets.
Flue to be adequately supported at 2m crs.

COPYRIGHT©
 THIS DRAWING IS THE PROPERTY
 OF The Fire Dept.

Client: THE FIRE DEPT.

Product: WD6-1200

Title: VERTICAL FLUE COMBINATION OPTIONS

Drawn: J.SCHOEMAN

Date: 03/10/2018

Chkd: J. WILSON

Date: 03/10/2018

Appd: J. WILSON

Date: 03/10/2018

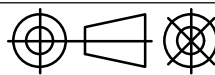

Scale: on A4

THE FIRE DEPT.
HAND CRAFTED FIRES

Drawing No. **WD6-1200-907**

Sheet 7 of 8

Revision **1**

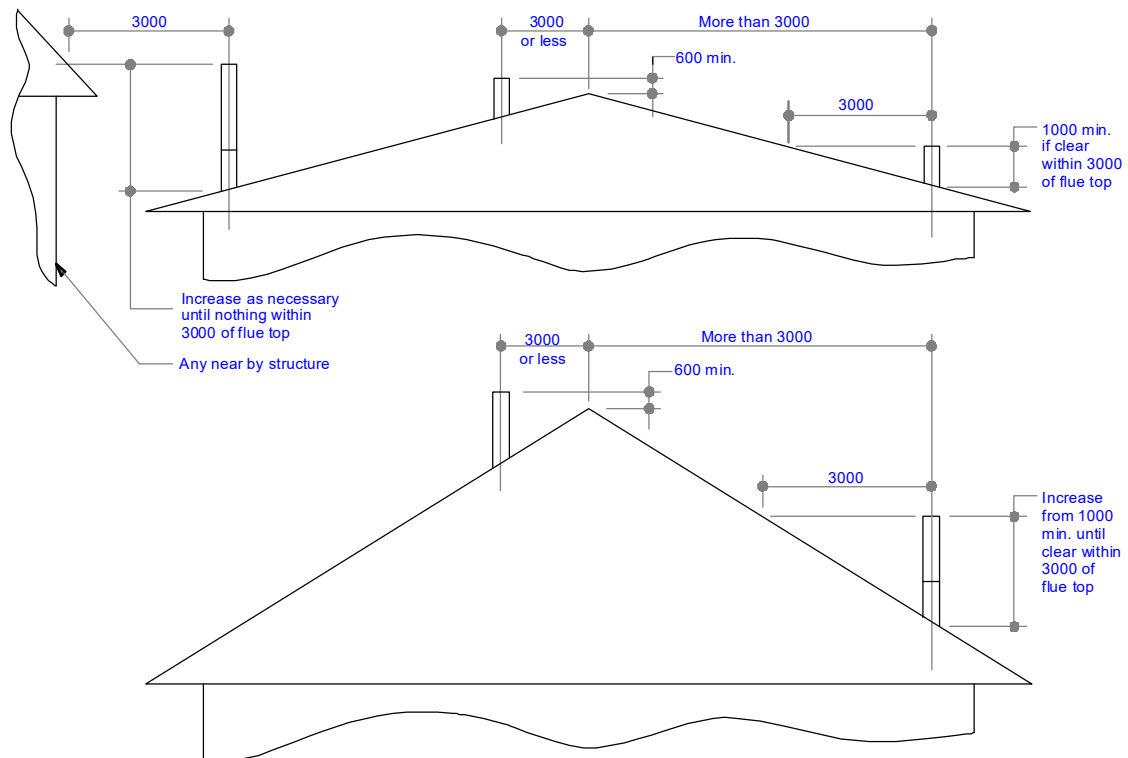

Minimum Height of Flue System Exit
Or as per AS/NZS 2918:2001

COPYRIGHT©
THIS DRAWING IS THE PROPERTY
OF **The Fire Dept.**

Client: THE FIRE DEPT.

Product: WD6-1200

Title: FLUE EXIT CLEARANCES

Drawn: J.SCHOEMAN

Date: 03/10/2018

Chkd: J. WILSON

Date: 03/10/2018

Appd: J. WILSON

Date: 03/10/2018

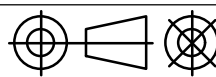

Scale: on A4

THE FIRE DEPT.
HAND CRAFTED FIRES

Drawing No. **WD6-1200-908**

Sheet 8 of 8

Revision **1**