

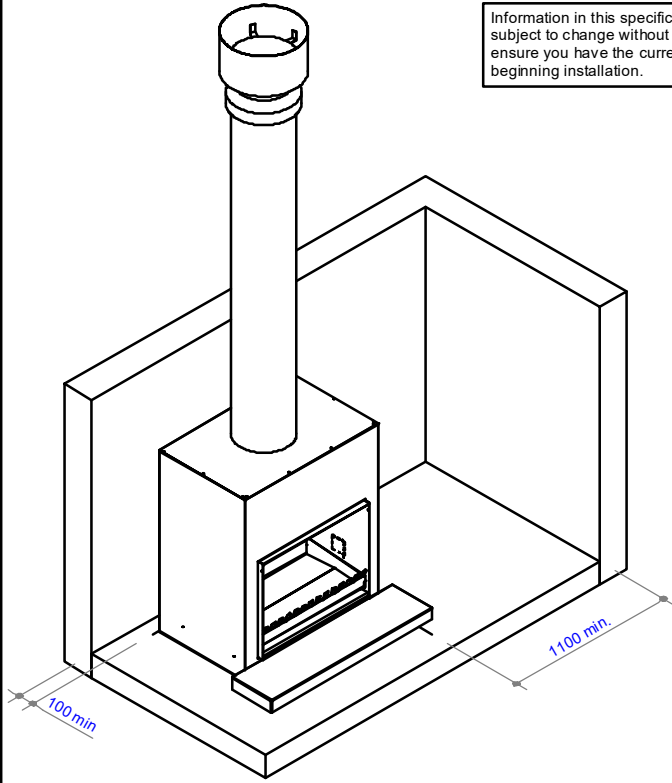

**WD60**

**Specifications**

Information in this specification may be subject to change without notice. Please ensure you have the current version before beginning installation.



**Fire installation requirements & Hearth size**  
 NOTE: Hearth to extend minimum of 200mm both sides of the fire opening, and 300mm from front of fire opening.

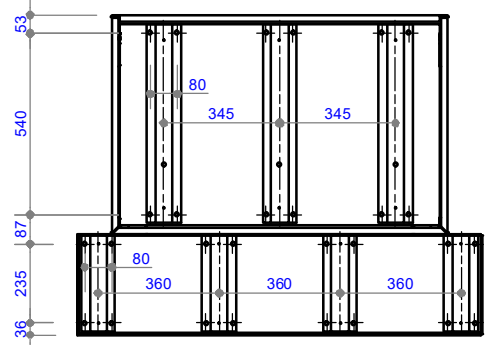

**Bottom View**

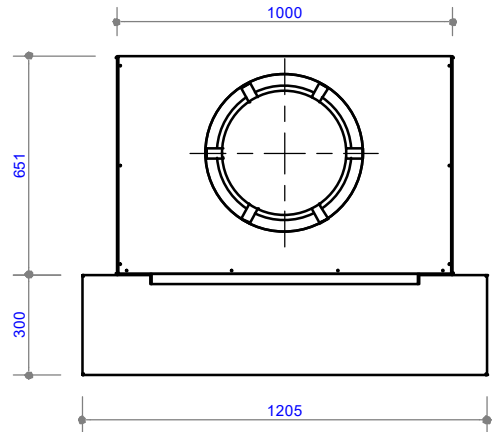

**Top View**

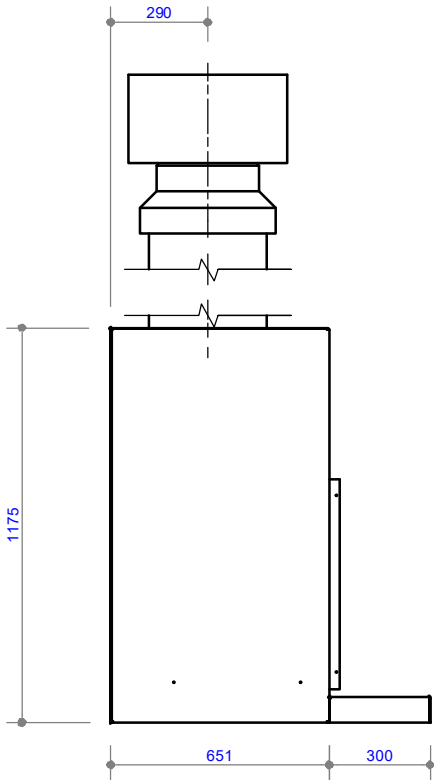

**Side View**

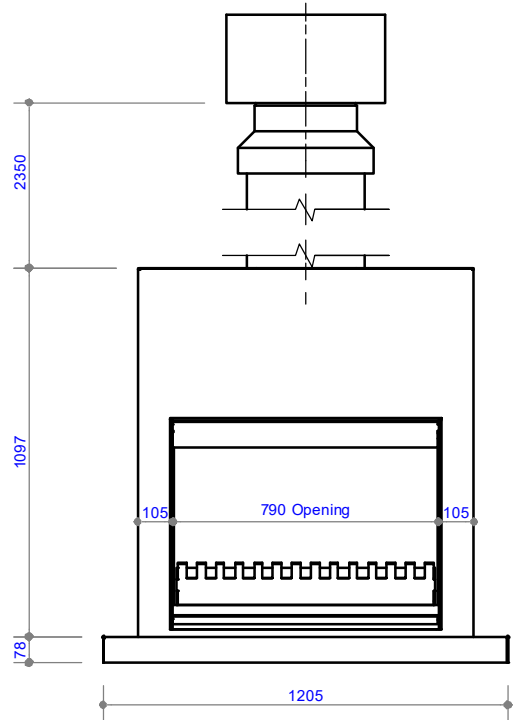

**Front View**

TOLERANCE = +/- 3mm

COPYRIGHT ©  
 THIS DRAWING IS THE PROPERTY  
 OF **The Fire Dept.**

Client: THE FIRE DEPT.		
Product: WD60-1000		
Title: FIRE DIMENSIONS		
Drawn: J.SCHOEMAN	Date: 3/10/2018	
Chkd: J. WILSON	Date: 3/10/2018	
Appd: J. WILSON	Date: 3/10/2018	
Scale:		on A4



Drawing No. <b>WD60-1000-901</b>	Sheet <b>1</b> of <b>6</b>	Revision <b>1</b>
----------------------------------	----------------------------	-------------------

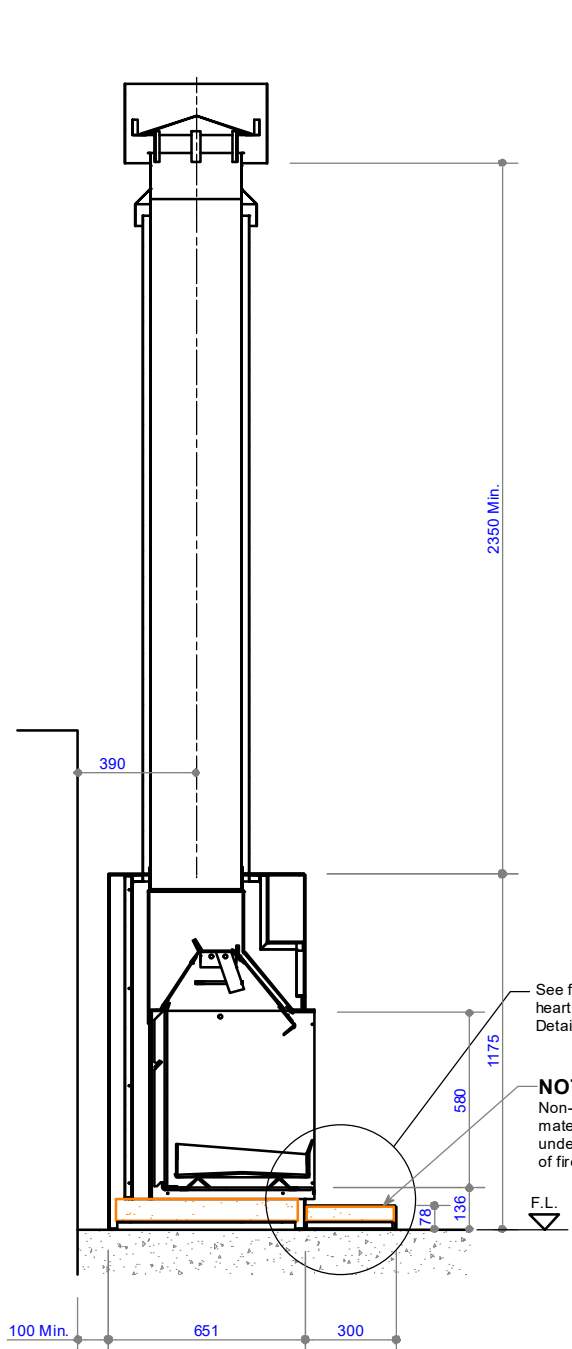

**Cross Section - Fire at floor level**

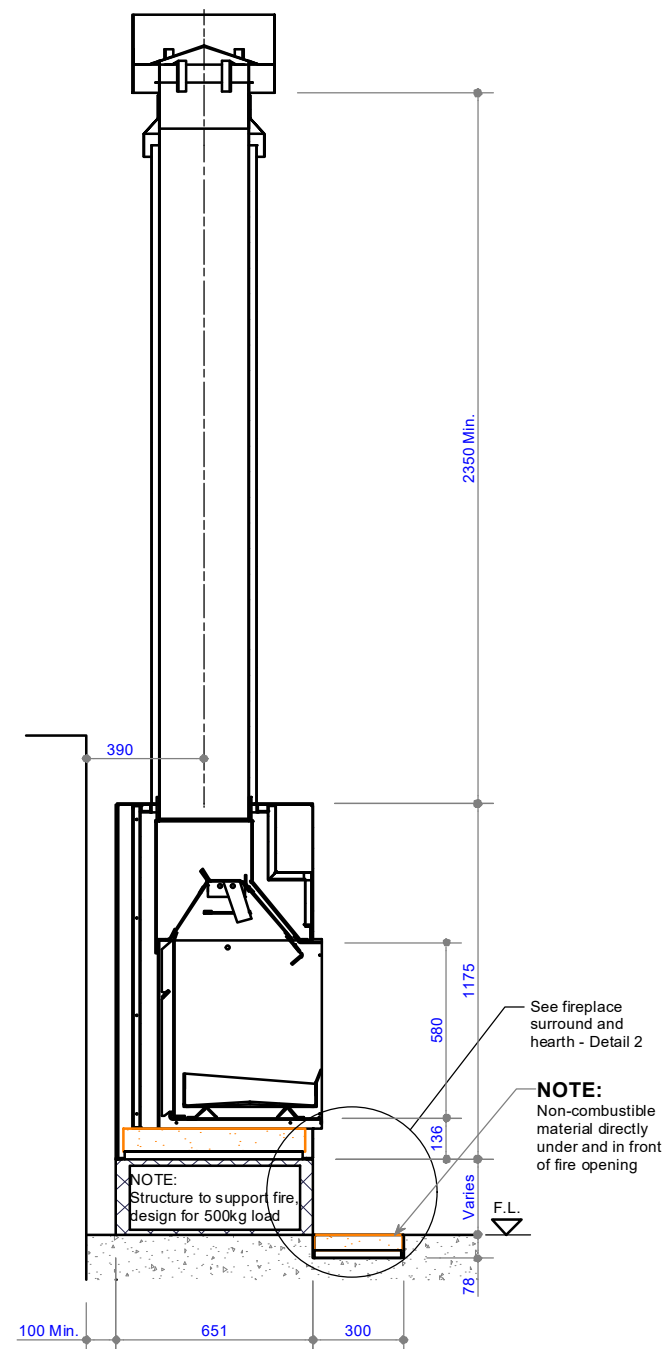

**Cross Section - Fire on raised plinth**  
NOTE: Plinth height can vary to suit

COPYRIGHT © THIS DRAWING IS THE PROPERTY OF <b>The Fire Dept.</b>	Client: THE FIRE DEPT.			
	Product: WD60-1000			
	Title: CAVITY CLEARANCES			
	Drawn: J.SCHOEMAN	Date: 3/10/2018		
	Chkd: J. WILSON	Date: 3/10/2018		
Appd: J. WILSON	Date: 3/10/2018			
Drawing No. <b>WD60-1000-902</b>		Scale:          on A4	Sheet <b>2</b> of <b>6</b>	Revision <b>1</b>

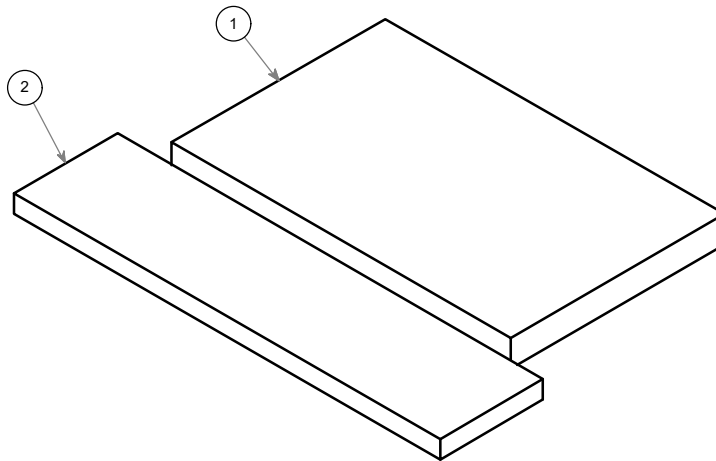

**ACC panel - Cutting plan**

ITEM	QTY	DESCRIPTION	MEASUREMENT
1	1	Firebox base AAC panel	600mm x 950mm x 75mm
2	1	Hearth AAC panel	300mm x 1200mm x 50mm

COPYRIGHT ©  
 THIS DRAWING IS THE PROPERTY  
 OF **The Fire Dept.**

Client: THE FIRE DEPT.

Product: WD60-1000

Title: AAC PANEL CUTTING PLAN

Drawn: J.SCHOEMAN

Date: 3/10/2018

Chkd: J. WILSON

Date: 3/10/2018

Appd: J. WILSON

Date: 3/10/2018

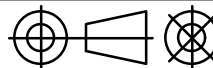

Scale: on A4

**THE FIRE DEPT.**  
**HAND CRAFTED FIRES**

Drawing No. **WD60-1000-903**

Sheet 3 of 6

Revision **1**

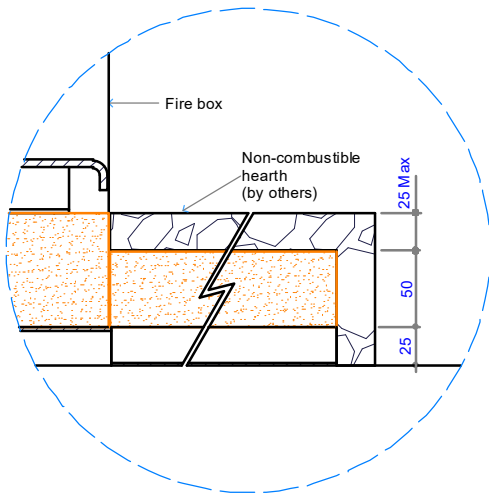

Detail 1 - Cross Section Fire hearth - Opt. 1

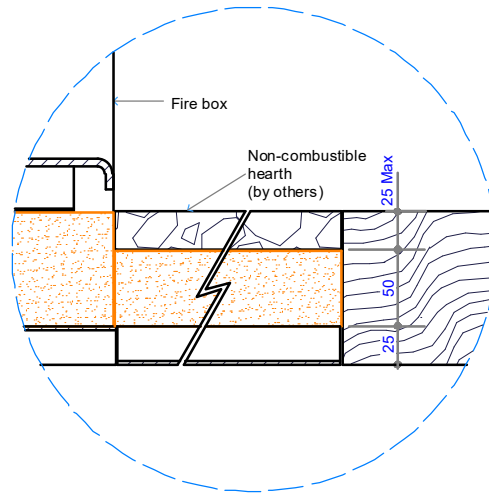

Detail 1 - Cross Section Fire hearth - Opt. 2

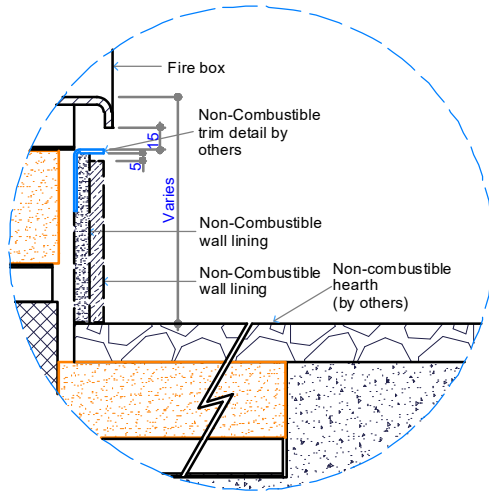

Detail 4 - Cross Section Fire Surround

COPYRIGHT ©  
 THIS DRAWING IS THE PROPERTY  
 OF **The Fire Dept.**

Client: THE FIRE DEPT.

Product: WD60-1000

Title: SURROUND DETAILS

Drawn: J.SCHOEMAN

Date: 3/10/2018

Chkd: J. WILSON

Date: 3/10/2018

Appd: J. WILSON

Date: 3/10/2018

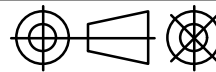

Scale: on A4

**THE FIRE DEPT.**  
**HAND CRAFTED FIRES**

Drawing No. **WD60-1000-904**

Sheet 4 of 6

Revision **1**

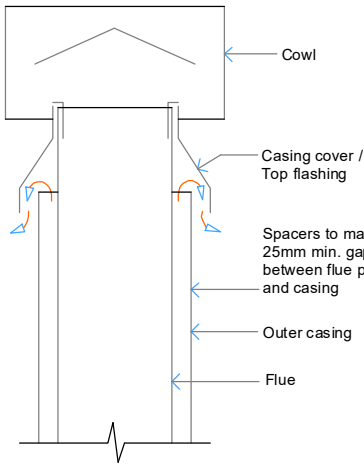

Flue components:  
 300mm dia. Flue  
 350mm dia. S/S Outer casing

**NOTE:**  
 Flue components must be installed to AS/NZS2918:2001 requirements.  
 All external penetration flashings must be installed in accordance with NZBC.  
 Cavity airflow must be unobstructed from fire box to flue termination.  
 50mm clearance between flue and combustible materials.  
 125mm clearance between flue and wiring / plastic water pipes.  
 Each flue joint must be sealed with a heat proof sealer.  
 Each flue joint must have a minimum of 4 x Stainless Steel rivets.

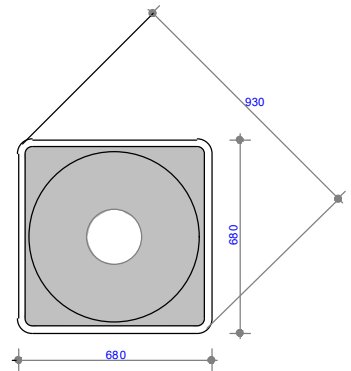

Deklite Flashing No. 9 - Plan View

**Option 1 - Free standing fire flue detail -  
 Air Ventilation through Casing cover / Top flashing**

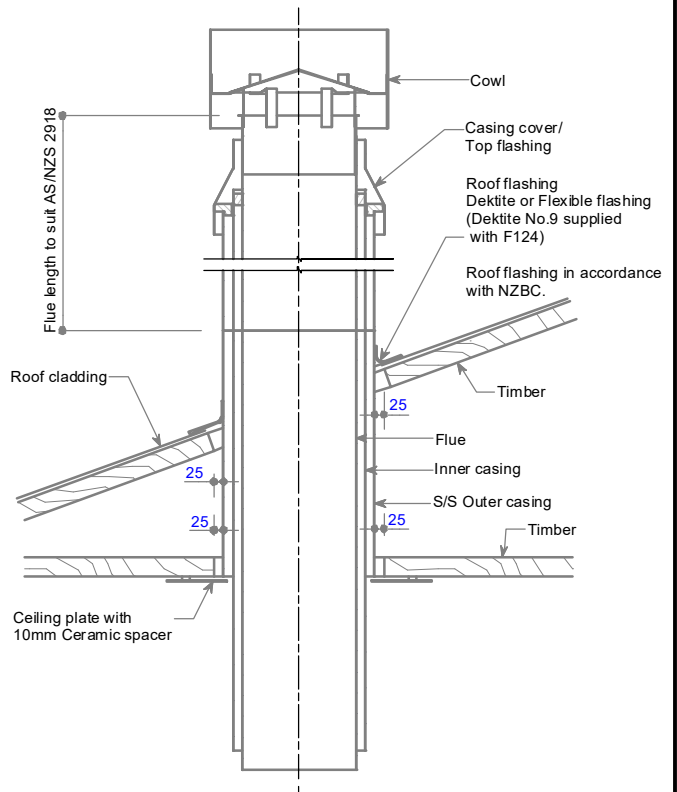
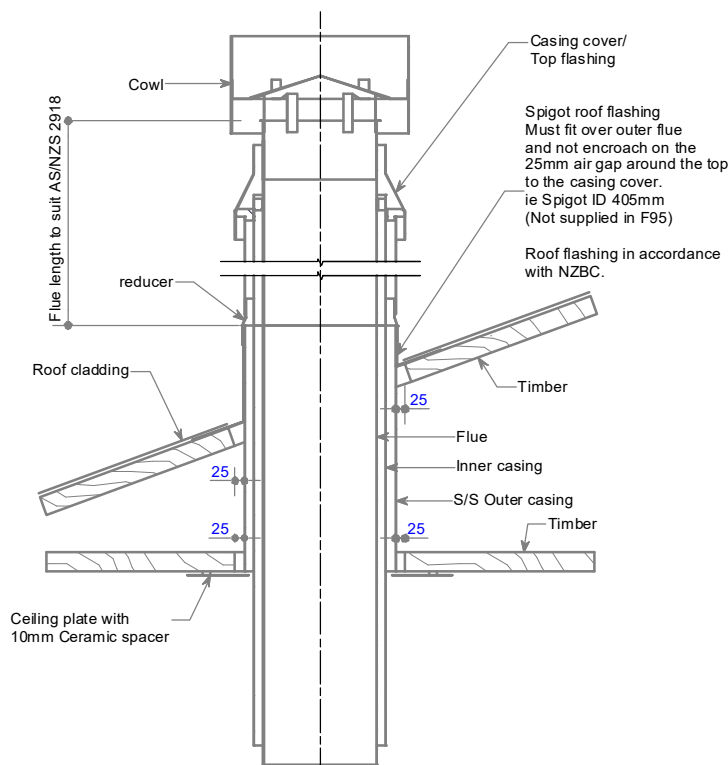

**Option 2 - Roof penetration flue detail - (Spigot)  
 Air Ventilation through Casing cover / Top flashing**

**Option 3 - Roof penetration flue detail - (Deklite / Flashing)  
 Air Ventilation through Casing cover / Top flashing**

Flue components:  
 300mm dia. Flue  
 350mm dia. Inner casing  
 400mm dia. S/S Outer casing  
 410mm dia ID to 395mm dia OD reducer

**NOTE:**  
 Flue components must be installed to AS/NZS2918:2001 requirements.  
 All external penetration flashings must be installed in accordance with NZBC.  
 Cavity airflow must be unobstructed from fire box to flue termination.  
 25mm clearance between flue and combustible materials.  
 75mm clearance between flue and wiring / plastic water pipes.  
 Each flue joint must be sealed with a heat proof sealer.  
 Each flue joint must have a minimum of 4 x Stainless Steel rivets.  
 Flue to be adequately supported at 2m crs.

Flue components:  
 300mm dia. Flue  
 350mm dia. Inner casing  
 400mm dia. S/S Outer casing  
 Deklite No.9

COPYRIGHT ©  
 THIS DRAWING IS THE PROPERTY  
 OF The Fire Dept.

Client: THE FIRE DEPT.			
Product: WD60-1000			
Title: FLUE EXIT DETAILS			
Drawn: J.SCHOEMAN	Date: 3/10/2018		
Chkd: J. WILSON	Date: 3/10/2018		
Appd: J. WILSON	Date: 3/10/2018		
Scale:		on A4	



Drawing No.	<b>WD60-1000-905</b>	Sheet	5	of	6	Revision	1
-------------	----------------------	-------	---	----	---	----------	---

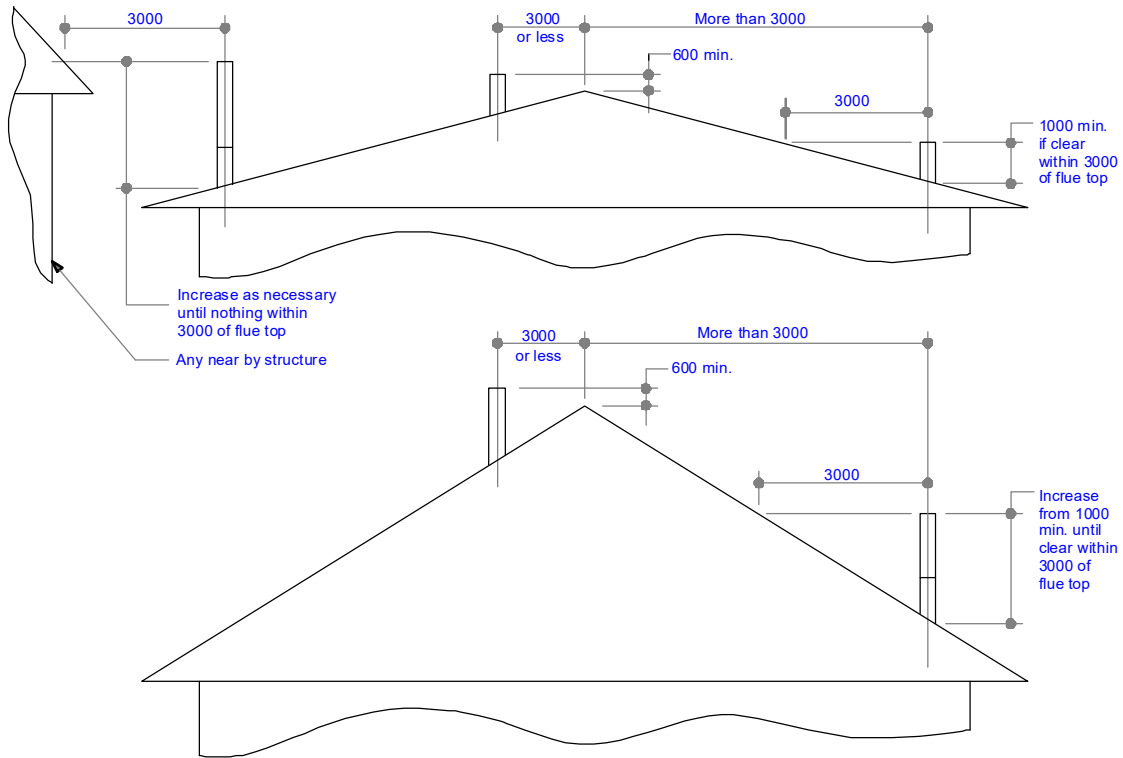

**Minimum Height of Flue System Exit**  
 Or as per AS/NZS 2918:2001

COPYRIGHT © THIS DRAWING IS THE PROPERTY OF <b>The Fire Dept.</b>	Client: THE FIRE DEPT.			<b>THE FIRE DEPT.</b> <b>HAND CRAFTED FIRES</b>
	Product: WD60-1000			
	Title: FLUE EXIT CLEARANCES			
	Drawn: J.SCHOEMAN	Date: 3/10/2018		
	Chkd: J. WILSON	Date: 3/10/2018		
Appd: J. WILSON	Date: 3/10/2018	Scale:          on A4		
Drawing No.	<b>WD60-1000-906</b>		Sheet 6 of 6	Revision <span style="border: 1px solid black; padding: 2px;">1</span>