

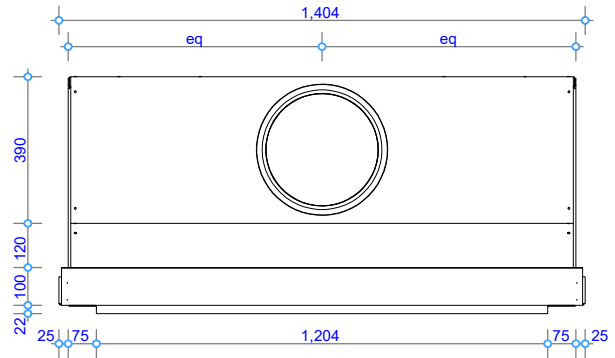

GD8 | 1200
EXPOSED BURNER
SPECIFICATIONS

Information in this specification may be subject to change without notice. Please ensure you have the current version before beginning installation.



Plan View

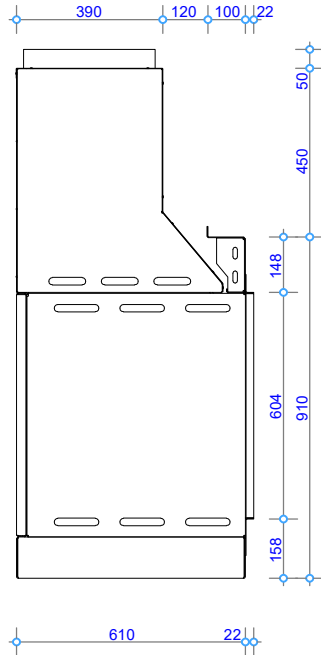

Side View

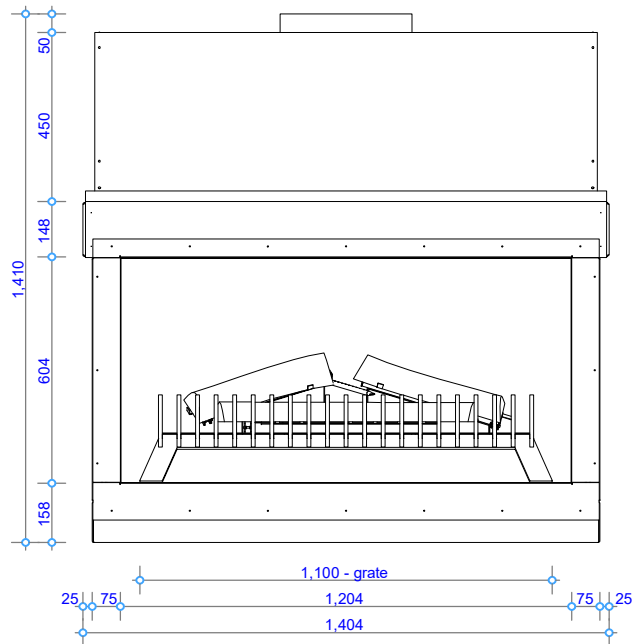

Front View

TOLERANCE = +/- 3mm

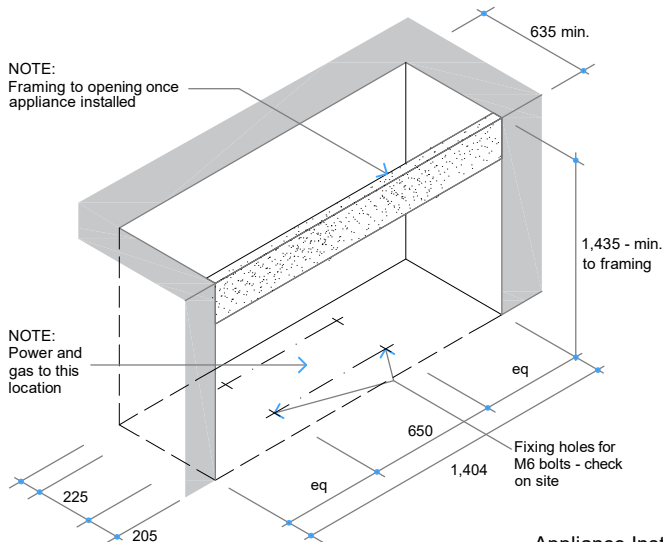

Appliance Installation - Trim Sizes
NOTE: Confirm fixing holes on site prior to drilling

COPYRIGHT©
THIS DRAWING IS THE PROPERTY
OF The Fire Dept.

Client: THE FIRE DEPT.

Product: GD8-1200-Exposed Burner

Title: FIREBOX DIMENSIONS

Drawn: LB

Date: 20/05/2020

Chkd: JW

Date: 08/05/2018

Appd: JW

Date: 08/05/2018

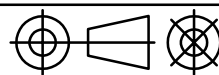

Scale: on A4

THE
**FIRE
DEPT.**
HAND CRAFTED FIRES

Drawing No.

GD8-1200-901EB

Sheet 01 of 11

Revision

4

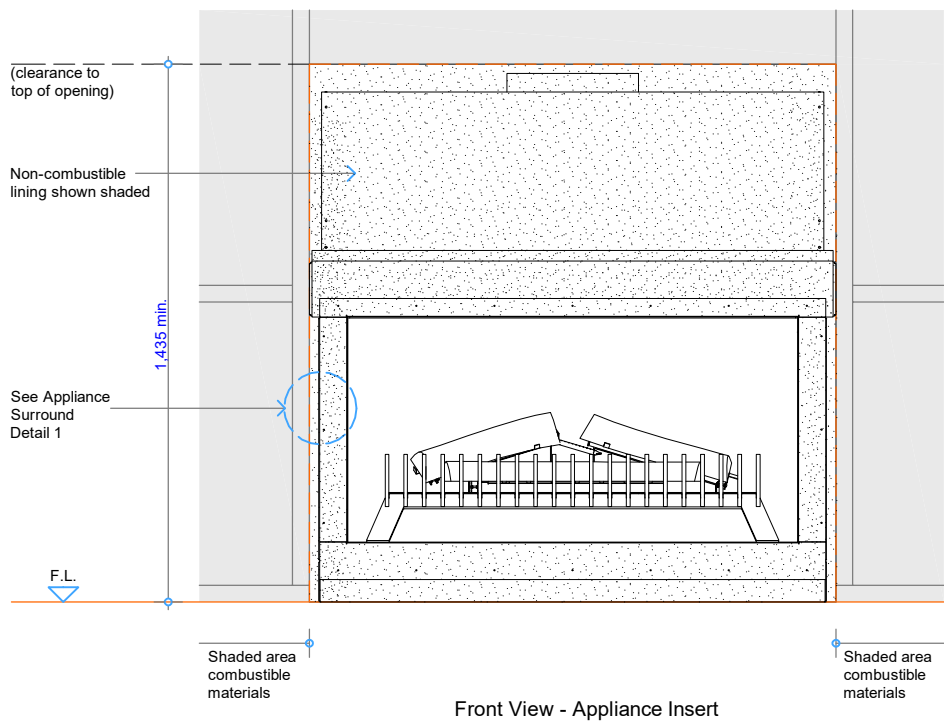
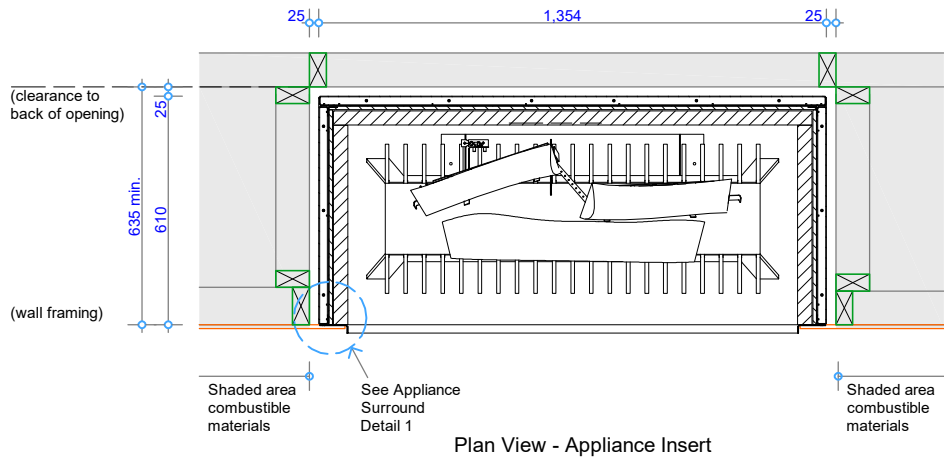

COPYRIGHT©
THIS DRAWING IS THE PROPERTY
OF The Fire Dept.

Client: THE FIRE DEPT.

Product: GD8-1200-Exposed Burner

Title: CAVITY CLEARANCES

Drawn: LB

Date: 20/05/2020

Chkd: JW

Date: 08/05/2018

Appd: JW

Date: 08/05/2018

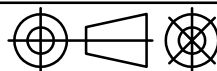

Scale: on A4

THE
**FIRE
DEPT.**
HAND CRAFTED FIRES

Drawing No.

GD8-1200-902EB

Sheet 02 of 11

Revision

4

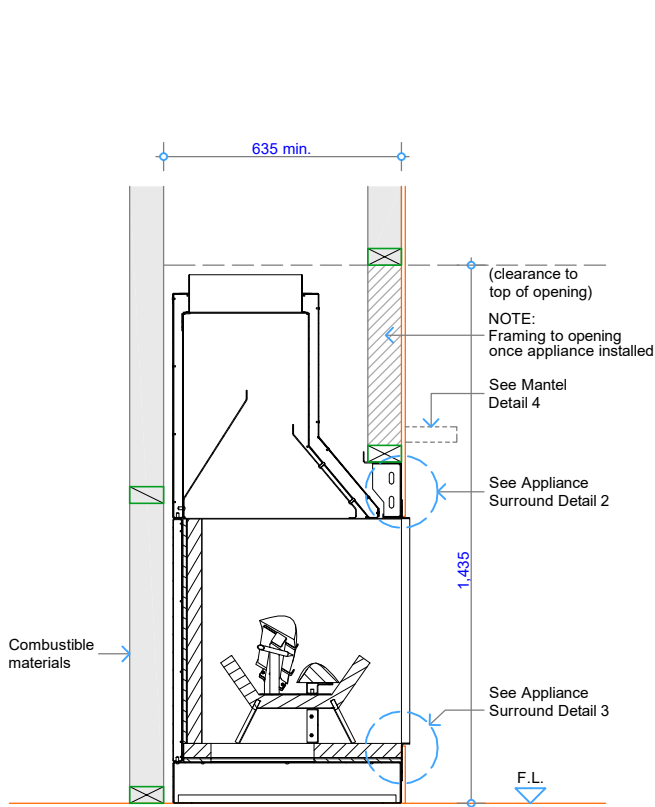

Cross Section - Appliance Insert at Floor Level

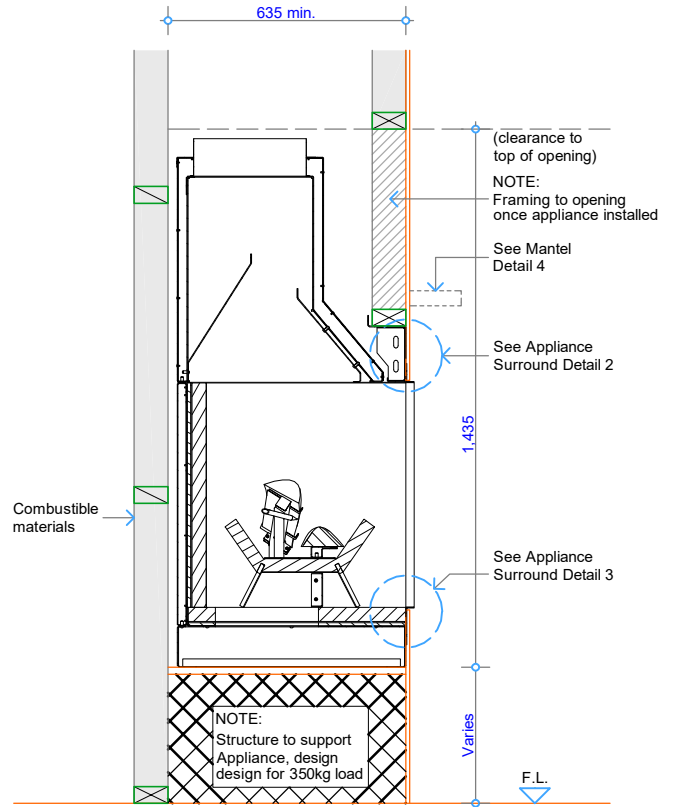

Cross Section - Appliance Insert at Floor Level

NOTE: Plinth height can vary to suit

COPYRIGHT©
 THIS DRAWING IS THE PROPERTY
 OF The Fire Dept.

Client: THE FIRE DEPT.

Product: GD8-1200-Exposed Burner

Title: CAVITY CLEARANCES

Drawn: LB

Date: 20/05/2020

Chkd: JW

Date: 08/05/2018

Appd: JW

Date: 08/05/2018

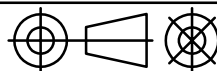

Scale: on A4

THE
**FIRE
 DEPT.**
 HAND CRAFTED FIRES

Drawing No.

GD8-1200-903EB

Sheet 03 of 11

Revision

4

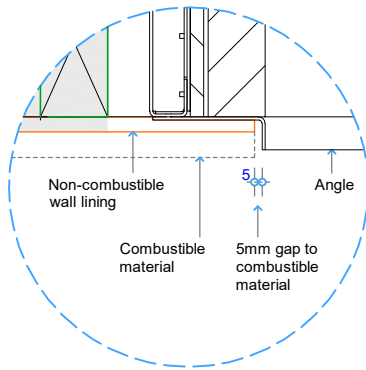

Detail 1 - Plan View Appliance Surround

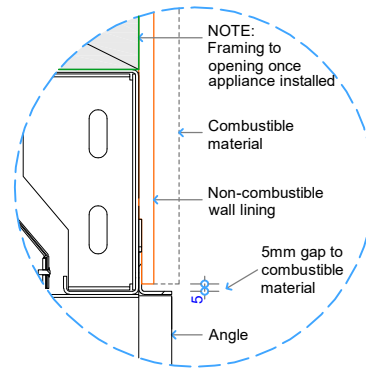

Detail 2 - Top of Appliance to Combustible Materials

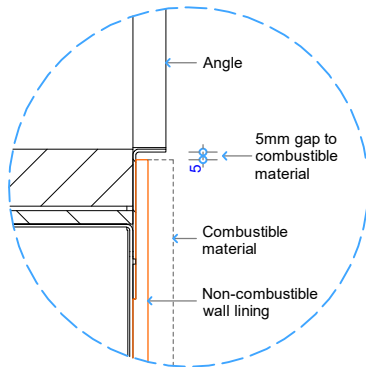

Detail 3 - Bottom of Appliance to Floor

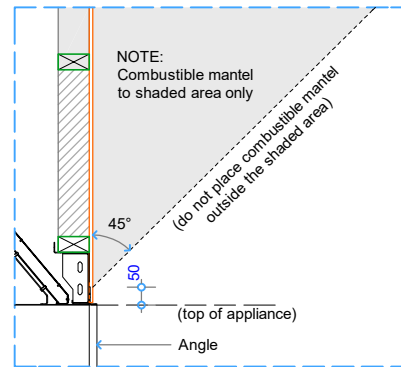

Detail 4 - Top of Fire to Combustible Mantel

COPYRIGHT©
THIS DRAWING IS THE PROPERTY
OF The Fire Dept.

Client: THE FIRE DEPT.		
Product: GD8-1200-Exposed Burner		
Title: SURROUND DETAILS		
Drawn: LB	Date: 20/05/2020	
Chkd: JW	Date: 08/05/2018	
Appd: JW	Date: 08/05/2018	
Scale:		

THE
**FIRE
DEPT.**
HAND CRAFTED FIRES

Drawing No. **GD8-1200-904EB**

Sheet 04 of 11

Revision

4

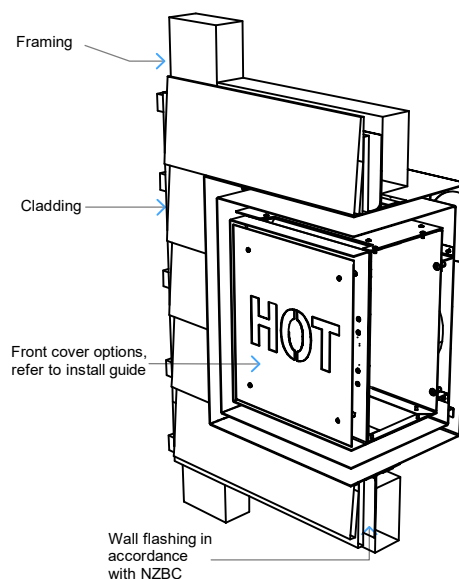

Detail - Wall cowl, vertical exit

Flue components must be installed to AS/NZSS5601 requirements.
All external penetration flashings must be installed in accordance with NZBC.
Appliance supplied with 6m of 5 core cable from appliance to fan.
Cavity airflow must be unobstructed from appliance to flue termination.
25mm clearance between flue and combustible materials.
75mm clearance between flue and wiring / plastic water pipes.
Horizontal flue run must fall 20mm for every 1000mm towards the appliance.
Each flue joint must be sealed with a heat proof sealer.
Each flue joint must have a minimum of 4 x rivets.
Flue to be adequately supported at 2.4m crs.

Flue components:
150mm dia. Flue
200mm dia. Casing
250mm dia. Spigot

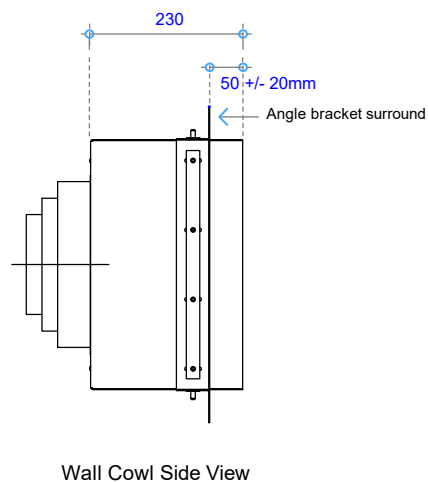

NOTE:
The angle bracket surround of the wall cowl fan is adjustable 10mm to either side.

Scale: on A4

THE FIRE DEPT.
HAND CRAFTED FIRES

Revision

△

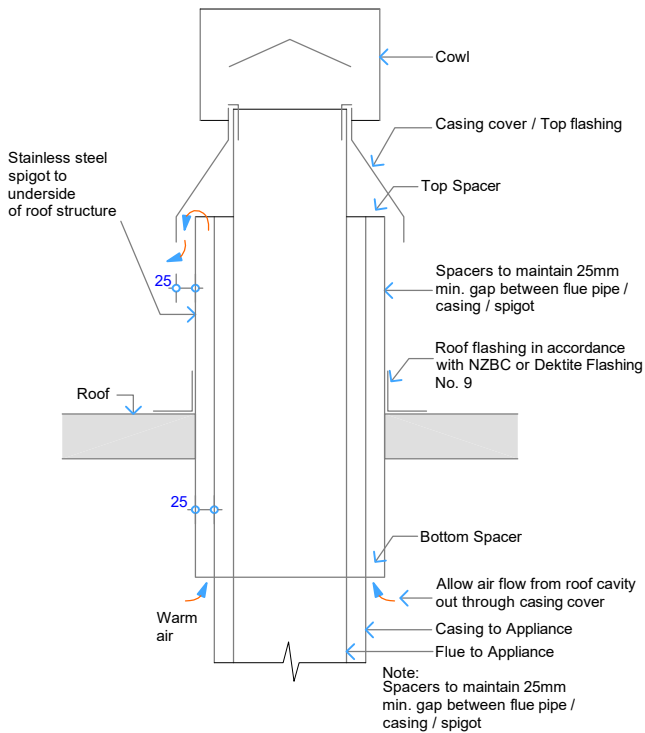

Detail - Air Ventilation through Casing cover/ Top flashing
- Without Fan

Flue components:
300mm dia. Flue
350mm dia. Casing
400mm dia. Spigot
Deklite Flashing No. 9

NOTE:
Flue components must be installed to AS/NZS5601 requirements.
All external penetration flashings must be installed in accordance with NZBC.
Appliance supplied with 6m of 5 core cable from appliance to fan.
Cavity airflow must be unobstructed from fan to flue termination.
25mm clearance between flue and combustible materials.
75mm clearance between flue and wiring / plastic water pipes.
Horizontal flue run must fall 20mm for every 1000mm towards the appliance.
Each flue joint must be sealed with a heat proof sealer.
Each flue joint must have a minimum of 4 x rivets.
Flue to be adequately supported at 2.4m crs.

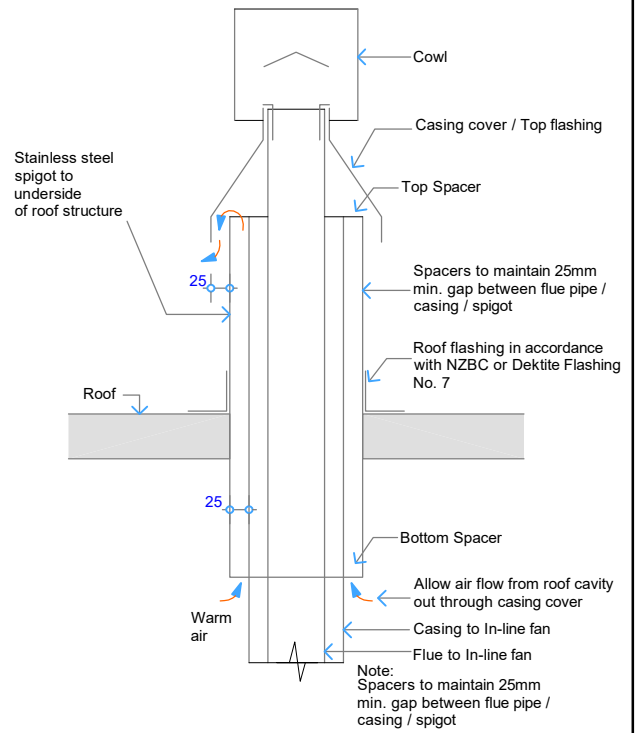

Detail - Air Ventilation through Casing cover/ Top flashing
- With Fan

Flue components (from Appliance to Fan):
300mm dia. Flue
350mm dia. Casing
400mm dia. Spigot

Flue components (from Fan to Flue Exit):
150mm dia. Flue
200mm dia. Casing
250mm dia. Spigot
Deklite Flashing No. 7

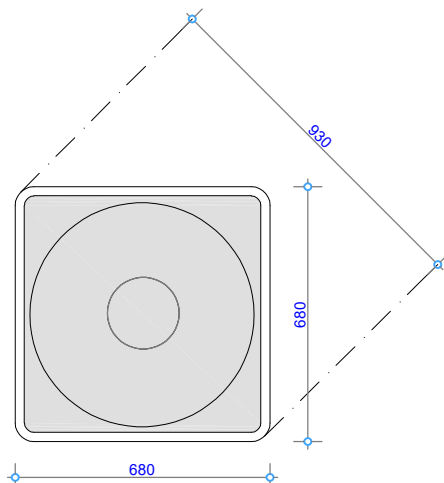

Deklite Flashing No. 9 - Plan View

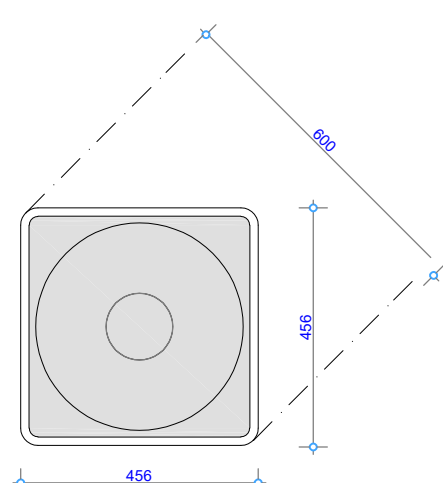

Deklite Flashing No. 7 - Plan View

COPYRIGHT©
THIS DRAWING IS THE PROPERTY
OF The Fire Dept.

Client: THE FIRE DEPT.

Product: GD8-1200-Exposed Burner

Title: VERTICAL FLUE EXIT DETAILS

Drawn: LB

Date: 20/05/2020

Chkd: JW

Date: 08/05/2018

Appd: JW

Date: 08/05/2018

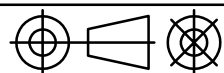

Scale: on A4

THE
**FIRE
DEPT.**
HAND CRAFTED FIRES

Drawing No. **GD8-1200-906EB**

Sheet 06 of 11

Revision **4**

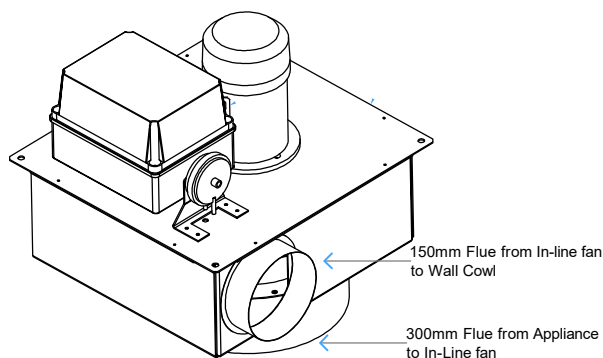

Detail - In-Line Fan

NOTE: Requires access hatch for maintenance

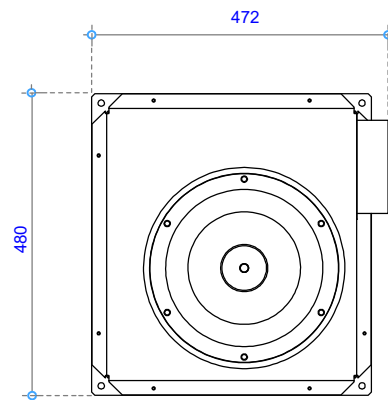

Detail-In-Line Fan Top view

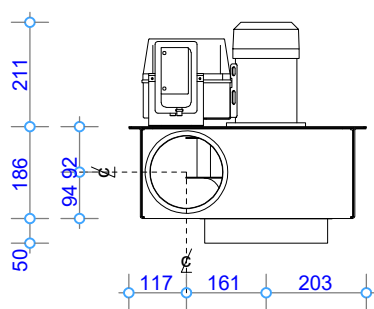

Detail - In-Line Fan - Front view

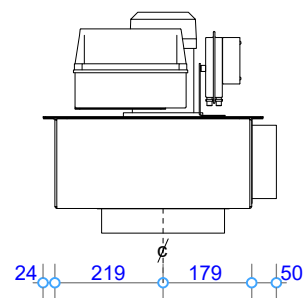

Detail - In-line Fan Side view

COPYRIGHT©
THIS DRAWING IS THE PROPERTY
OF The Fire Dept.

Client: THE FIRE DEPT.

Product: GD8-1200-Exposed Burner

Title: VERTICAL & HORIZONTAL FLUE EXIT DETAILS

Drawn: LB

Date: 20/05/2020

Chkd: JW

Date: 08/05/2018

Appd: JW

Date: 08/05/2018

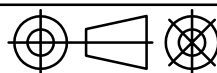

Scale: on A4

THE
**FIRE
DEPT.**
HAND CRAFTED FIRES

Drawing No. **GD8-1200-907EB**

Sheet 07 of 11

Revision

4

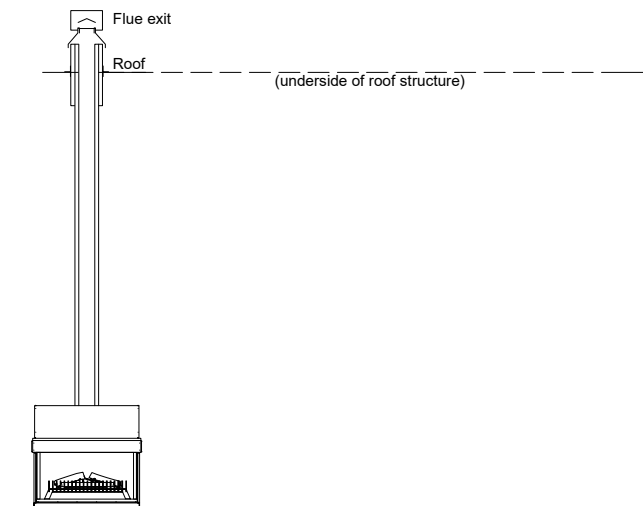

Vertical Flue Combination GD8A

NOTE:
 Flue components must be installed to AS/NZS5601 requirements.
 All external penetration flashings must be installed in accordance with NZBC.
 Cavity airflow must be unobstructed from appliance to flue termination.
 25mm clearance between flue and combustible materials.
 75mm clearance between flue and wiring / plastic water pipes.
 Each flue joint must be sealed with a heat proof sealer.
 Each flue joint must have a minimum of 4 x rivets.
 Flue to be adequately supported at 2.4m crs.

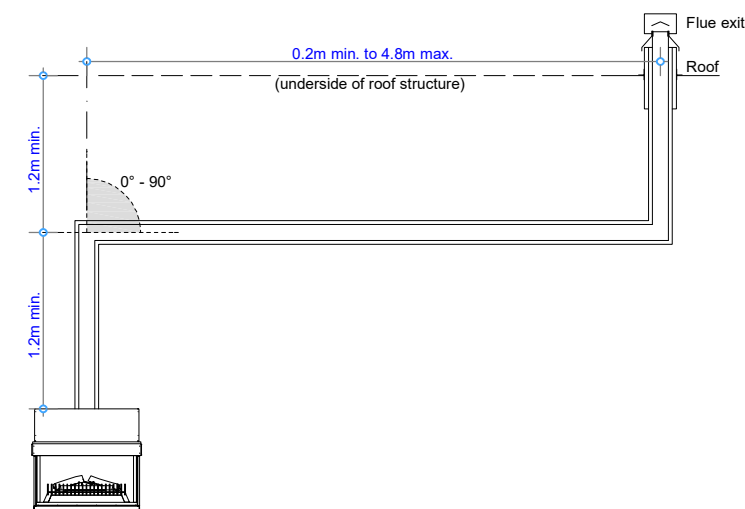

Vertical Flue Combination GD8B

NOTE:
 Flue components must be installed to AS/NZS5601 requirements.
 All external penetration flashings must be installed in accordance with NZBC.
 Cavity airflow must be unobstructed from appliance to flue termination.
 25mm clearance between flue and combustible materials.
 75mm clearance between flue and wiring / plastic water pipes.
 Horizontal flue run must fall 20mm for every 1000mm towards the appliance.
 Each flue joint must be sealed with a heat proof sealer.
 Each flue joint must have a minimum of 4 x rivets.
 Flue to be adequately supported at 2.4m crs.

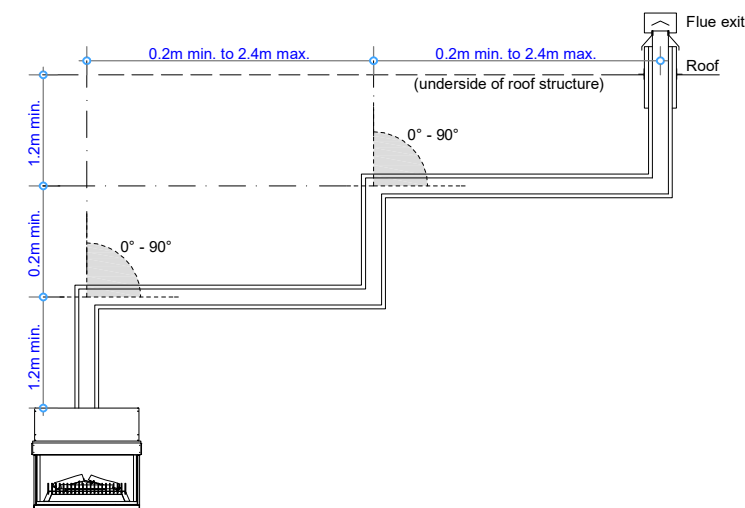

Vertical Flue Combination GD8C

NOTE:
 Flue components must be installed to AS/NZS5601 requirements.
 All external penetration flashings must be installed in accordance with NZBC.
 Cavity airflow must be unobstructed from appliance to flue termination.
 25mm clearance between flue and combustible materials.
 75mm clearance between flue and wiring / plastic water pipes.
 Horizontal flue run must fall 20mm for every 1000mm towards the appliance.
 Each flue joint must be sealed with a heat proof sealer.
 Each flue joint must have a minimum of 4 x rivets.
 Flue to be adequately supported at 2.4m crs.

COPYRIGHT© THIS DRAWING IS THE PROPERTY OF The Fire Dept.	Client: THE FIRE DEPT.					<div>THE FIRE DEPT. HAND CRAFTED FIRES</div>		
	Product: GD8-1200-Exposed Burner							
	Title: VERTICAL FLUE COMBINATION OPTIONS - WITHOUT FAN							
	Drawn: LB		Date: 20/05/2020					
	Chkd: JW		Date: 08/05/2018					
	Appd: JW		Date: 08/05/2018			Scale:	on	A4
	Drawing No.		GD8-1200-908EB			Sheet 08 of 11		Revision

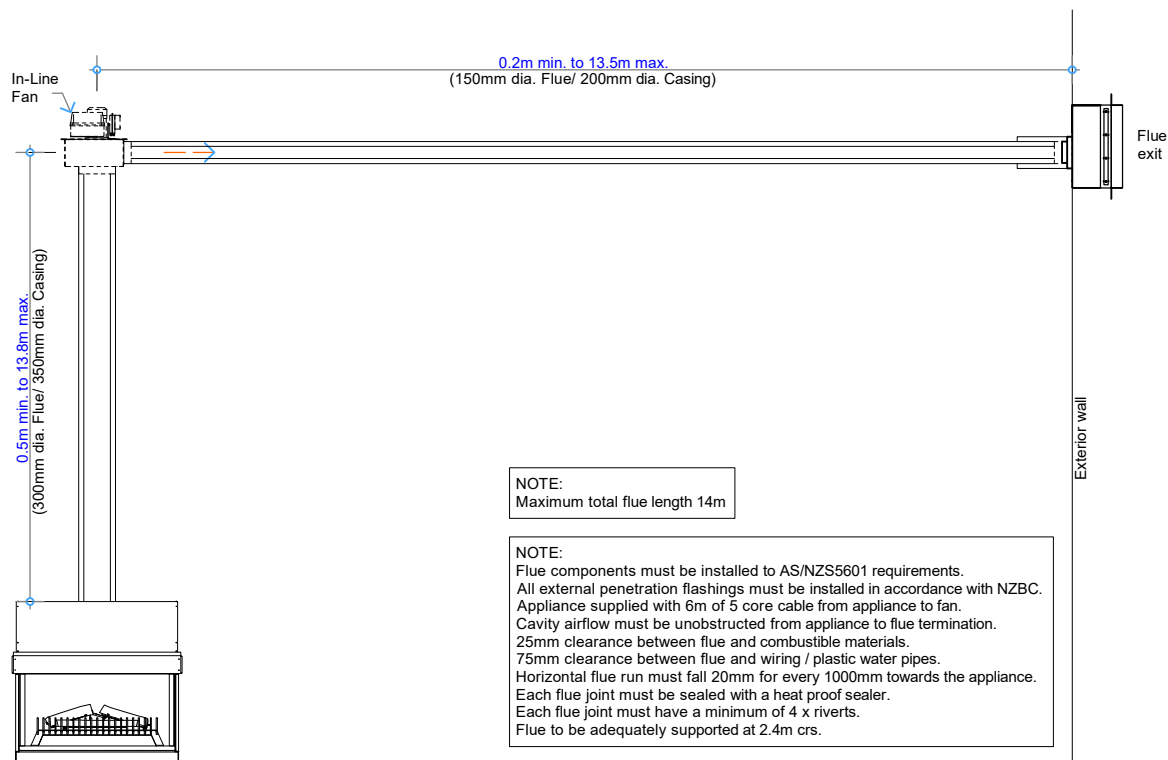

Horizontal Flue Combination GD8D

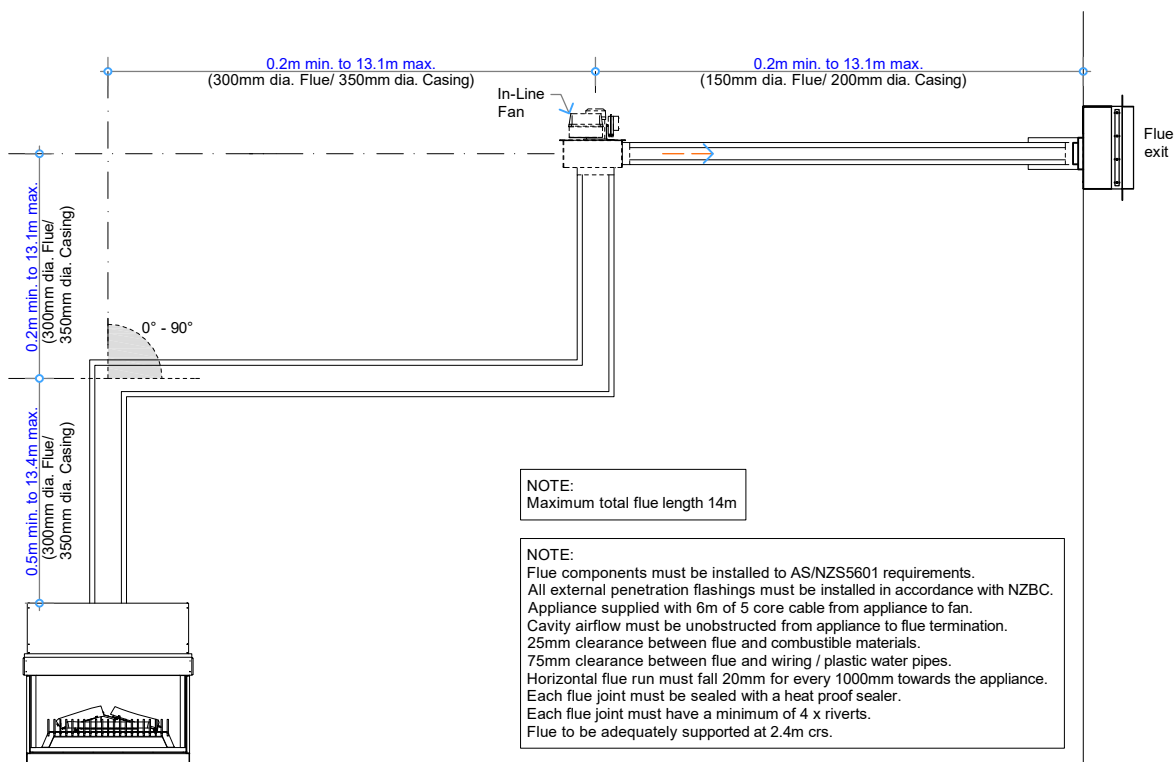

Horizontal Flue Combination GD8E

COPYRIGHT©
THIS DRAWING IS THE PROPERTY
OF The Fire Dept.

Client: THE FIRE DEPT.

Product: GD8-1200-Exposed Burner

Title: HORIZONTAL FLUE COMBINATION OPTIONS

Drawn: LB

Date: 20/05/2020

Chkd: JW

Date: 08/05/2018

Appd: JW

Date: 08/05/2018

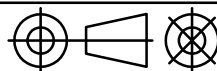

Scale: on A4

THE
**FIRE
DEPT.**
HAND CRAFTED FIRES

Drawing No. **GD8-1200-909EB**

Sheet 09 of 11

Revision

4

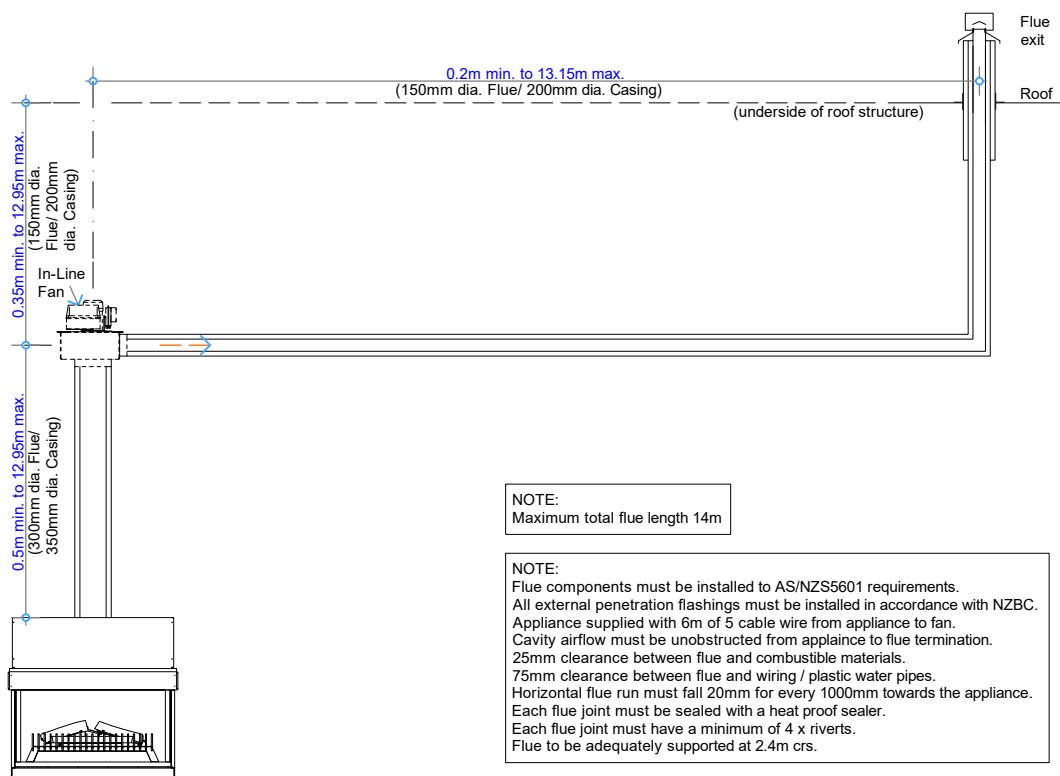

Vertical Flue Combination GD8F

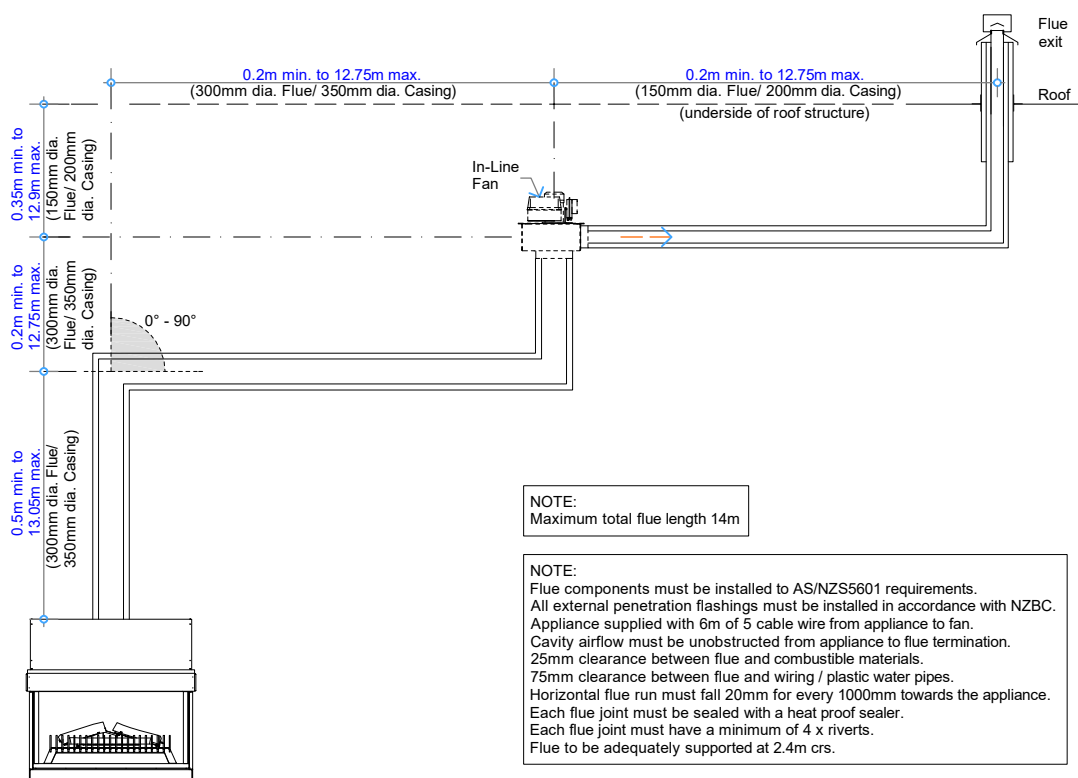

Vertical Flue Combination GD8G

COPYRIGHT©
THIS DRAWING IS THE PROPERTY
OF The Fire Dept.

Client: THE FIRE DEPT.

Product: GD8-1200-Exposed Burner

Title: VERTICAL FLUE COMBINATION OPTIONS

Drawn: LB

Date: 20/05/2020

Chkd: JW

Date: 08/05/2018

Appd: JW

Date: 08/05/2018

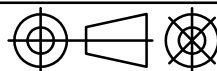

Scale: on A4

THE
**FIRE
DEPT.**
HAND CRAFTED FIRES

Drawing No. **GD8-1200-910EB**

Sheet 10 of 11

Revision

4

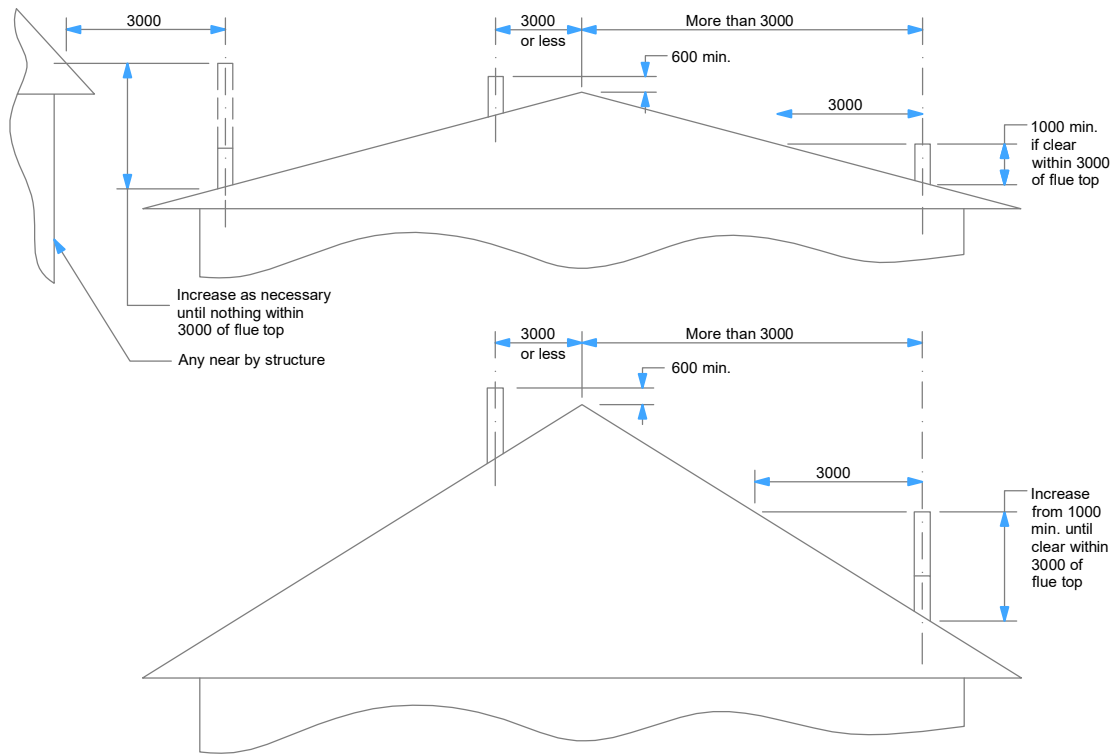

Minimum Height of Flue System Exit
Or as per AS/NZS 5601

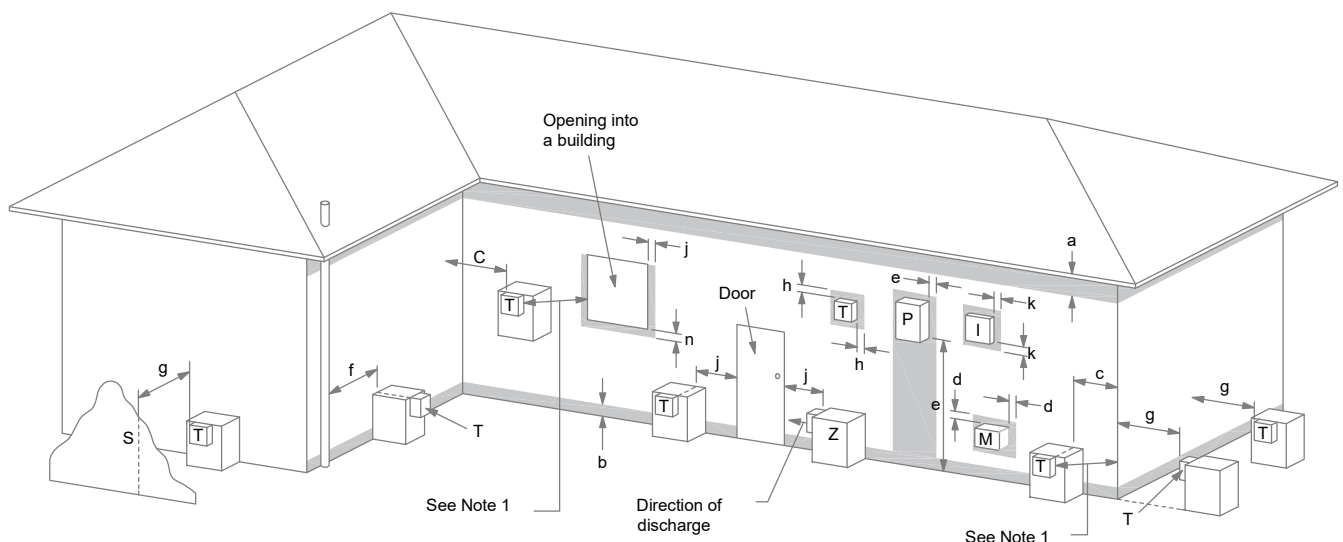

LEGEND:

I = Mechanical air inlet
M = Gas meter
P = Electricity meter or fuse box
S = Structure
T = Flue terminal
Z = Fan-assisted appliance only

a = 200
b = 300
c = 300
d = 1000
e = 500
f = 75
g = 500
h = 300
j = 300 (at window) & 1500 (fan-assisted appliance by the door)
k = 1000
n = 500

NOTES:

1 Where dimensions c, j or k cannot be achieved an equivalent horizontal distance measured diagonally from the nearest discharge point of the terminal to the opening may be deemed by the Technical Regulator to comply.

Shading indicates prohibited area for flue terminals

Location of Flue Terminals of Balanced Flue,
Room-Sealed, Fan-Assisted or Outdoor Appliances

NOTE: To be read in conjunction with AS/NZS 5601.1:2013

COPYRIGHT©
THIS DRAWING IS THE PROPERTY
OF The Fire Dept.

Client: THE FIRE DEPT.

Product: GD8-1200-Exposed Burner

Title: FLUE EXIT CLEARANCES

Drawn: LB

Date: 20/05/2020

Chkd: JW

Date: 08/05/2018

Appd: JW

Date: 08/05/2018

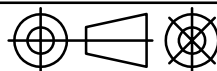

Scale: on A4

THE
**FIRE
DEPT.**
HAND CRAFTED FIRES

Drawing No. **GD8-1200-911EB**

Sheet 11 of 11

Revision

4