

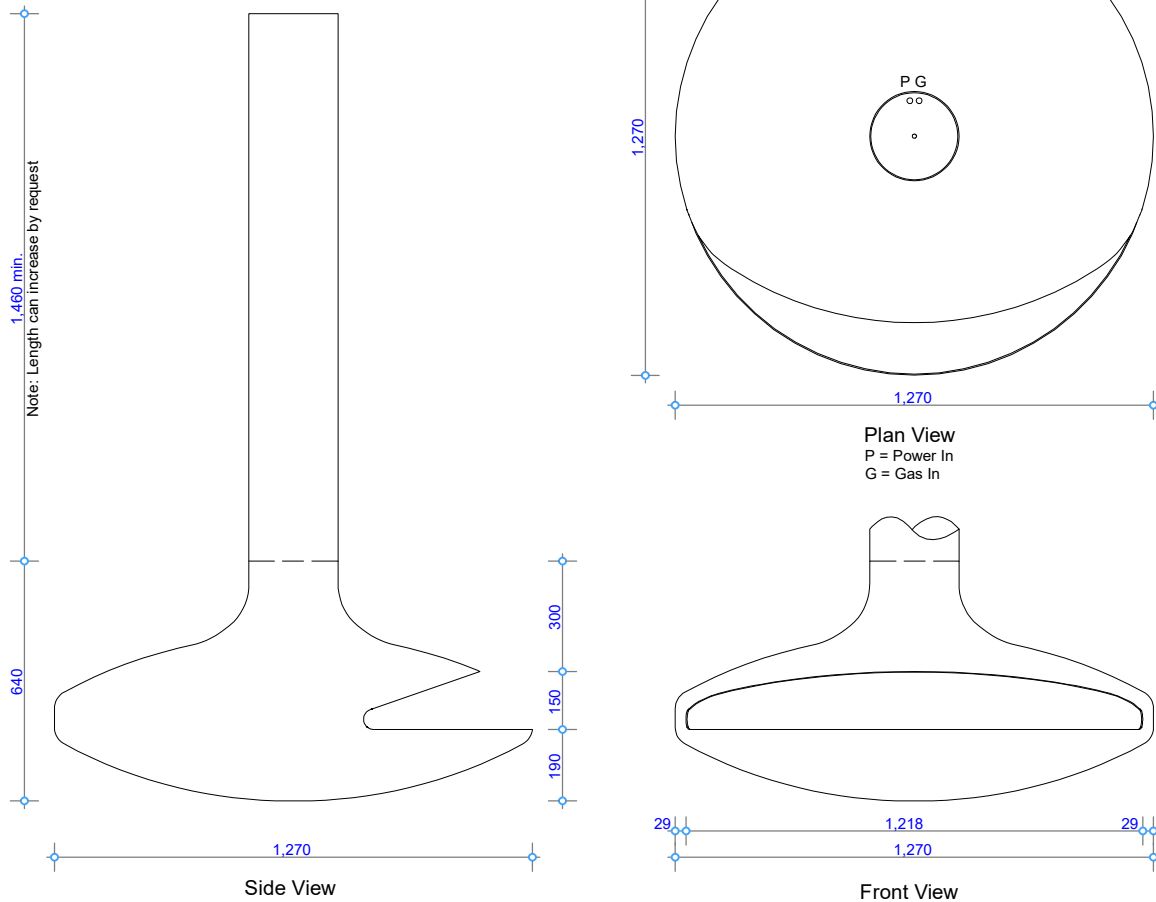

GD7 | 1270
SPECIFICATIONS

Information in this specification may be subject to change without notice. Please ensure you have the current version before beginning installation.



TOLERANCE = +/- 3mm

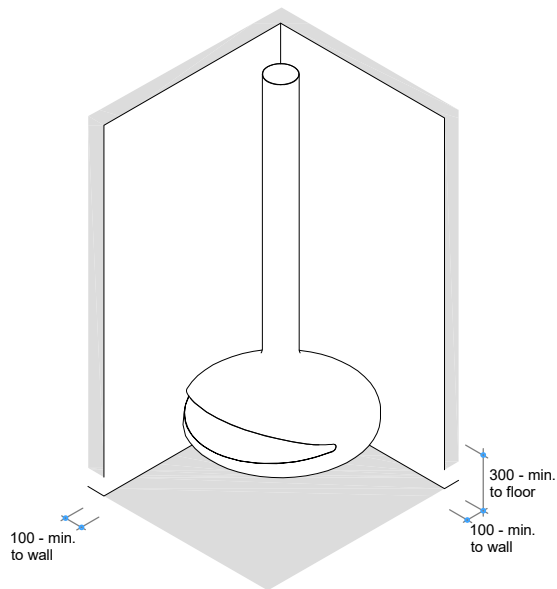

Appliance Installation - Clearance to Combustibles

COPYRIGHT©
THIS DRAWING IS THE PROPERTY
OF The Fire Dept.

Client: THE FIRE DEPT.

Product: GD7-1270

Title: FIREBOX DIMENSIONS

Drawn: LB

Date: 20/05/2020

Chkd: JW

Date: 08/05/2018

Appd: JW

Date: 08/05/2018

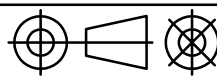

THE
**FIRE
DEPT.**
HAND CRAFTED FIRES

Drawing No.

GD7-1270-901

Sheet 01 of 09

Revision

6

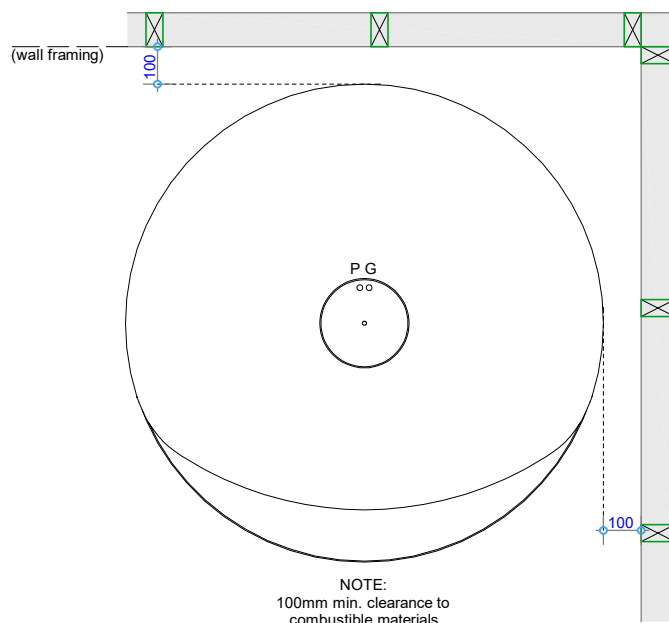

Plan View - Appliance Insert

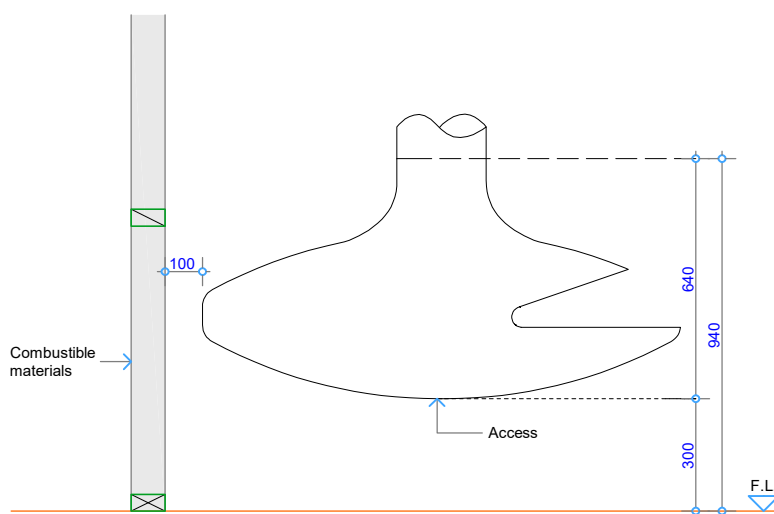

Cross Section - Appliance Insert at Floor Level

COPYRIGHT©

THIS DRAWING IS THE PROPERTY
OF The Fire Dept.

Client: THE FIRE DEPT.

Product: GD7-1270

Title: CAVITY CLEARANCES

Drawn: LB

Date: 20/05/2020

Chkd: JW

Date: 08/05/2018

Appd: JW

Date: 08/05/2018

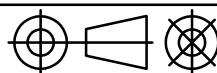

Scale: on A4

THE
**FIRE
DEPT.**
HAND CRAFTED FIRES

Drawing No.

GD7-1270-902

Sheet 02 of 09

Revision

6

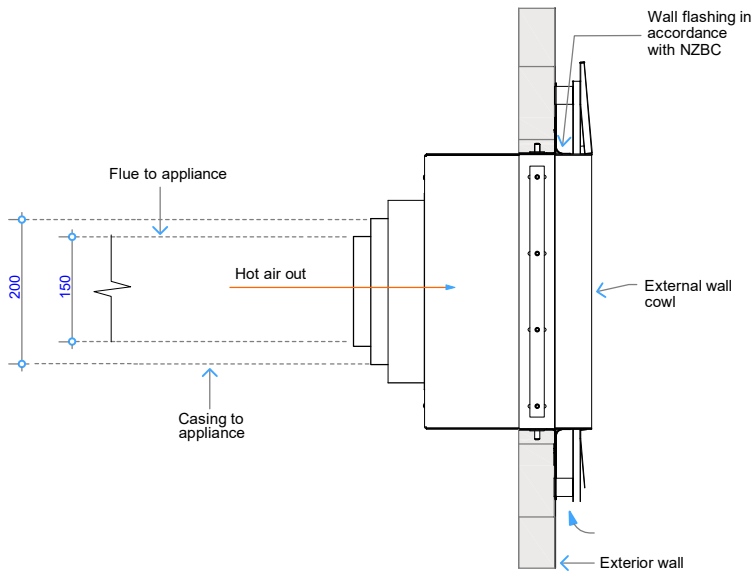

Detail - Air Ventilation through wall

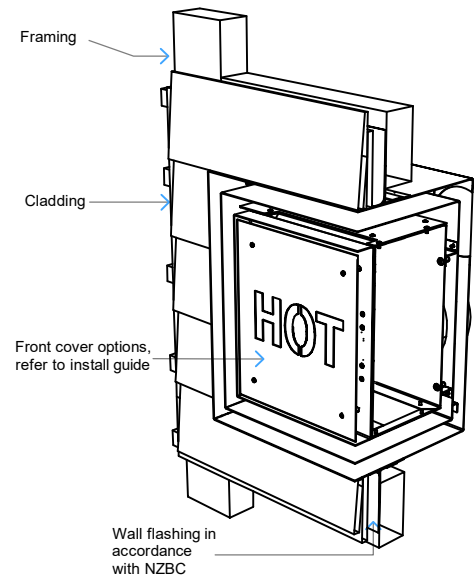

Detail - Wall cowl, vertical exit

NOTE:

Flue components must be installed to AS/NZS5601 requirements.
All external penetration flashings must be installed in accordance with NZBC.
Appliance supplied with 6m of 5 core cable from appliance to fan.
Cavity airflow must be unobstructed from appliance to flue termination.
25mm clearance between flue and combustible materials.
75mm clearance between flue and wiring / plastic water pipes.
Horizontal flue run must fall 20mm for every 1000mm towards the appliance.
Each flue joint must be sealed with a heat proof sealer.
Each flue joint must have a minimum of 4 x rivets.
Flue to be adequately supported at 2.4m crs.

Flue components:
150mm dia. Flue
200mm dia. Casing
250mm dia. Spigot

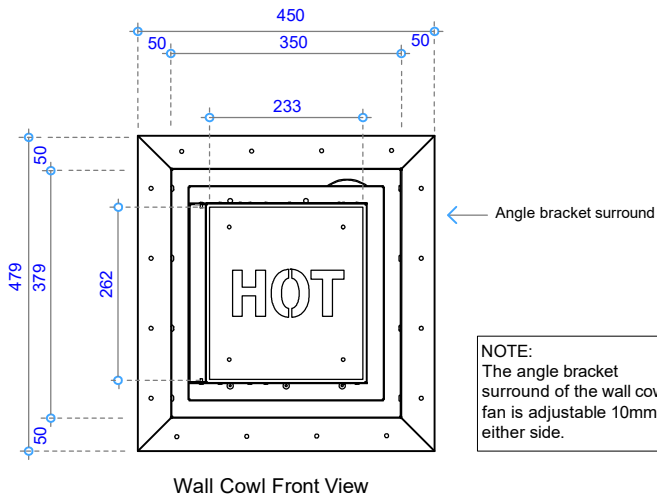

Wall Cowl Front View

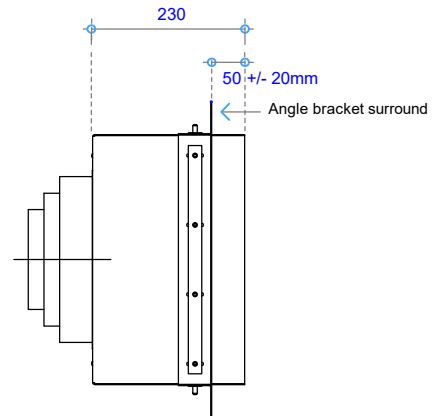

Wall Cowl Side View

NOTE:

The angle bracket surround of the wall cowl fan is adjustable 10mm to either side.

COPYRIGHT©
THIS DRAWING IS THE PROPERTY
OF The Fire Dept.

Client: THE FIRE DEPT.

Product:

Title: VERTICAL WALL COWL, EXIT DETAILS

Drawn: LB

Date: 20/05/2020

Chkd: JW

Date: 08/05/2018

Appd: JW

Date: 08/05/2018

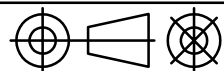

Scale: on A4

THE
**FIRE
DEPT.**
HAND CRAFTED FIRES

Drawing No. **GD7-1270-903**

Sheet 03 of 09

Revision

6

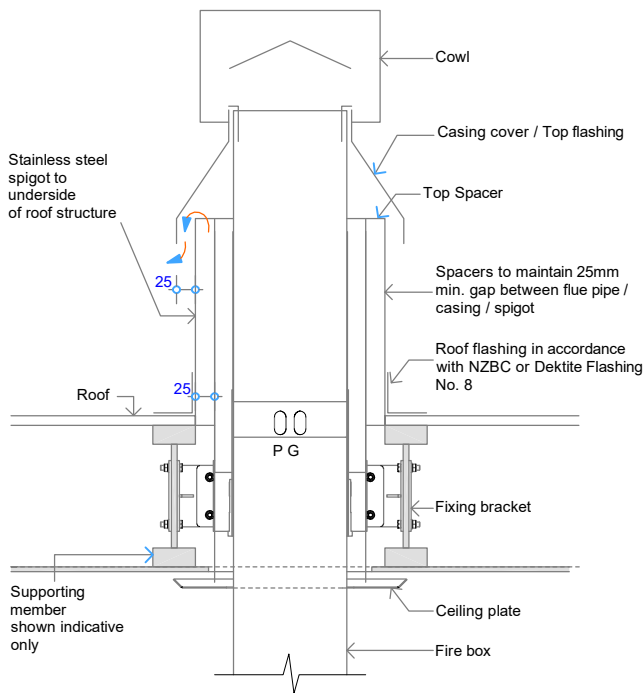

Detail - Air Ventilation through Casing cover / Top flashing
- Without Fan

Flue components:
240mm dia. Flue
290mm dia. Casing
340mm dia. Spigot
Deklite Flashing No. 8

NOTE:
Flue components must be installed to AS/NZS5601 requirements.
All external flue penetration flashings must be installed in accordance with NZBC.
Appliance supplied with 6m of 5 core cable from fixing bracket to fan.
Cavity airflow must be unobstructed from appliance to flue termination.
25mm clearance between flue and combustible materials.
75mm clearance between flue and wiring / plastic water pipes.
Horizontal flue run must fall 20mm for every 1000mm towards the appliance.
Each flue joint must be sealed with a heat proof sealer.
Each flue joint must have a minimum of 4 x rivets.
Flue to be adequately supported at 2.4m crs.

*Fixing Bracket design must be confirmed by Engineer

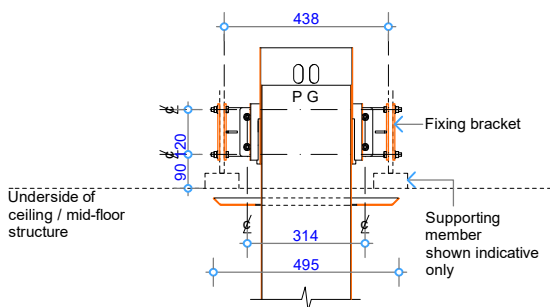

Detail - Fixing bracket

NOTE:
Weight of appliance with factory supplied exposed 1460mm length flue = 200kg.
Additional 20kg for every 1200mm exposed flue section.
Bracket engineering required (by others).

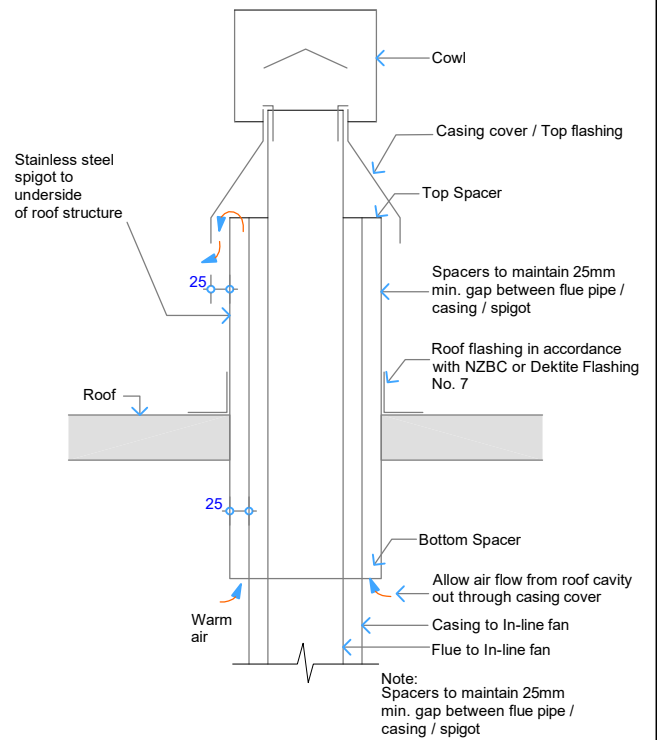

Detail - Air Ventilation through Casing cover / Top flashing
- With Fan

Flue components (from Appliance to Fan):
240mm dia. Flue
290mm dia. Casing

Flue components (from Fan to Flue Exit):
150mm dia. Flue
200mm dia. Casing
250mm dia. Spigot
Deklite Flashing No. 7

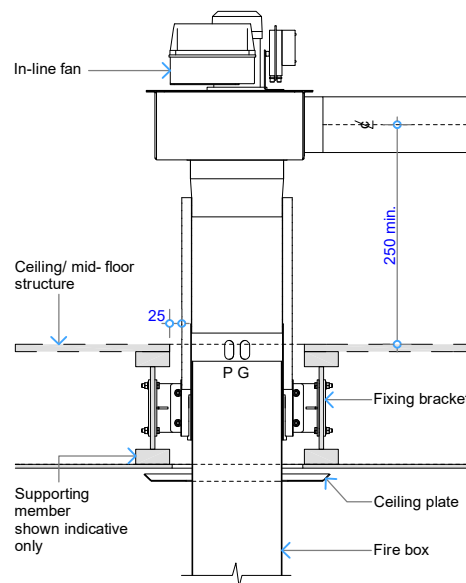

Detail - Firebox to In-line fan connection

COPYRIGHT©
THIS DRAWING IS THE PROPERTY
OF The Fire Dept.

Client: THE FIRE DEPT.

Product: GD7-1270

Title: VERTICAL FLUE EXIT DETAILS

Drawn: LB

Date: 20/05/2020

Chkd: JW

Date: 08/05/2018

Appd: JW

Date: 08/05/2018

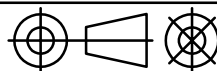

Scale: on A4

Drawing No. **GD7-1270-904**

Sheet 04 of 09

Revision

6

THE FIRE DEPT.
HAND CRAFTED FIRES

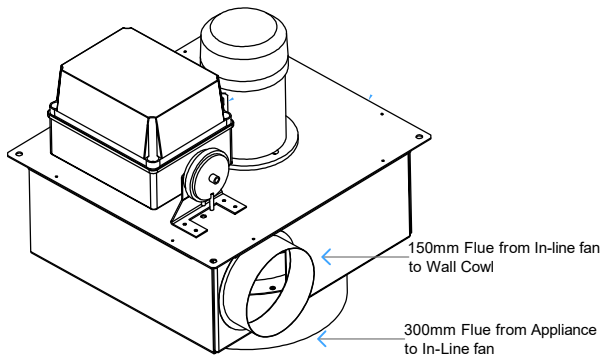

Detail - In-Line Fan

NOTE:
Requires access hatch for maintenance.
Cavity for In-line fan must have unobstructed air flow from fire to flue termination.

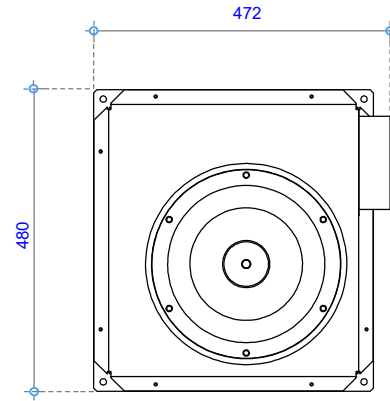

Detail-In-Line Fan Top view

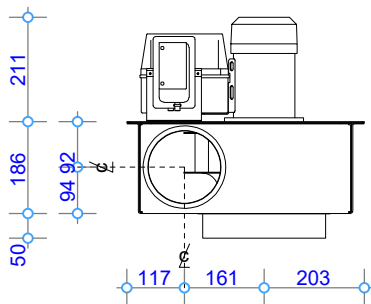

Detail - In-Line Fan - Front view

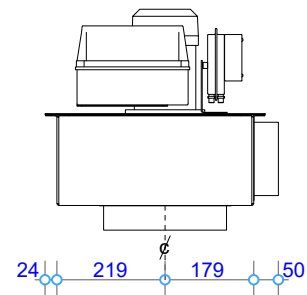

Detail - In-line Fan Side view

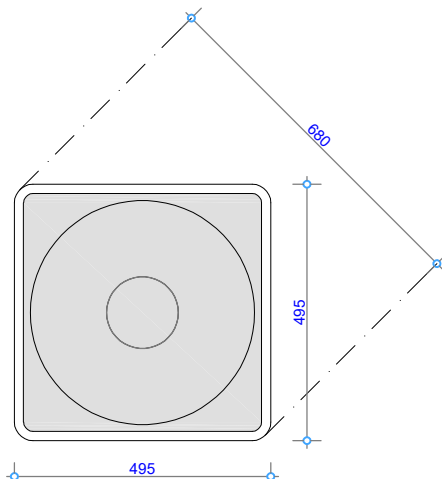

Deklite Flashing No. 8 - Plan View

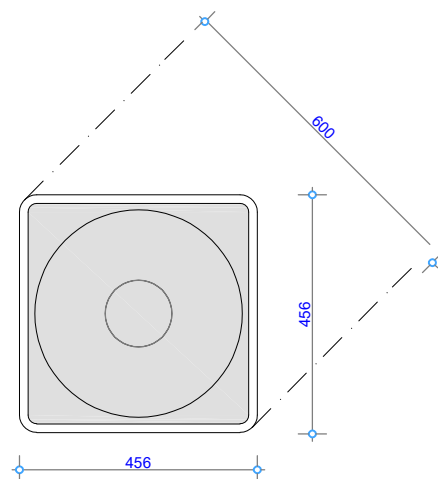

Deklite Flashing No. 7 - Plan View

COPYRIGHT©
 THIS DRAWING IS THE PROPERTY
 OF The Fire Dept.

Client: THE FIRE DEPT.

Product: GD7-1270

Title: VERTICAL & HORIZONTAL FLUE EXIT DETAILS

Drawn: LB

Date: 20/05/2020

Chkd: JW

Date: 08/05/2018

Appd: JW

Date: 08/05/2018

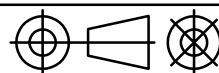

Scale: on A4

THE FIRE DEPT.
HAND CRAFTED FIRES

Drawing No. **GD7-1270-905**

Sheet 05 of 09

Revision

6

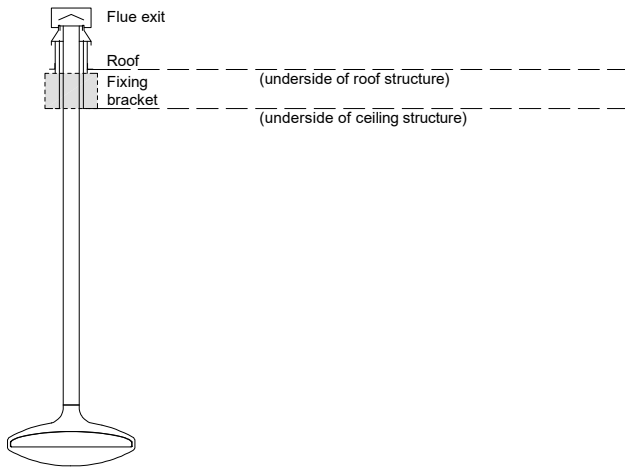

Vertical Flue Combination GD7A

NOTE:

Flue components must be installed to AS/NZS5601 requirements.
All external penetration flashings must be installed in accordance with NZBC.
Cavity airflow must be unobstructed from appliance to flue termination.
25mm clearance between flue and combustible materials.
75mm clearance between flue and wiring / plastic water pipes.
Each flue joint must be sealed with a heat proof sealer.
Each flue joint must have a minimum of 4 x rivets.
Flue to be adequately supported at 2.4m crs.

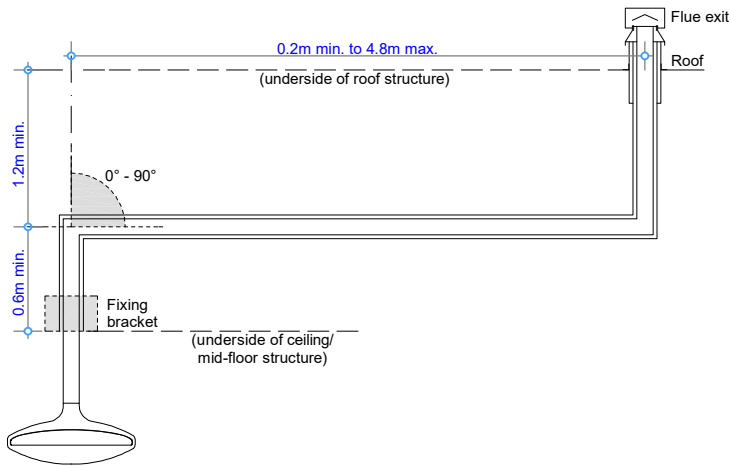

Vertical Flue Combination GD7B

NOTE:

Flue components must be installed to AS/NZS5601 requirements.
All external penetration flashings must be installed in accordance with NZBC.
Cavity airflow must be unobstructed from appliance to flue termination.
25mm clearance between flue and combustible materials.
75mm clearance between flue and wiring / plastic water pipes.
Horizontal flue run must fall 20mm for every 1000mm towards the appliance.
Each flue joint must be sealed with a heat proof sealer.
Each flue joint must have a minimum of 4 x rivets.
Flue to be adequately supported at 2.4m crs.

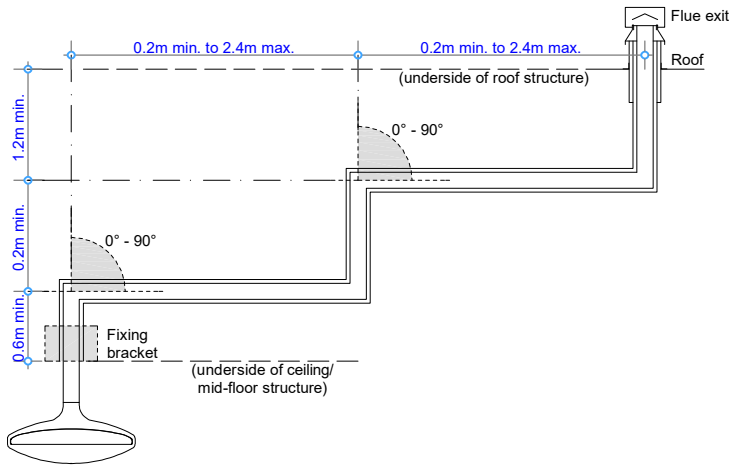

Vertical Flue Combination GD7C

NOTE:

Flue components must be installed to AS/NZS5601 requirements.
All external penetration flashings must be installed in accordance with NZBC.
Cavity airflow must be unobstructed from appliance to flue termination.
25mm clearance between flue and combustible materials.
75mm clearance between flue and wiring / plastic water pipes.
Horizontal flue run must fall 20mm for every 1000mm towards the appliance.
Each flue joint must be sealed with a heat proof sealer.
Each flue joint must have a minimum of 4 x rivets.
Flue to be adequately supported at 2.4m crs.

COPYRIGHT©
THIS DRAWING IS THE PROPERTY
OF The Fire Dept.

Client: THE FIRE DEPT.

Product: GD7-1270

Title: VERTICAL FLUE COMBINATION OPTIONS - WITHOUT FAN

Drawn: LB

Date: 20/05/2020

Chkd: JW

Date: 08/05/2018

Appd: JW

Date: 08/05/2018

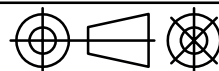

Scale: on A4

THE FIRE DEPT.
HAND CRAFTED FIRES

Drawing No. **GD7-1270-906**

Sheet 06 of 09

Revision **6**

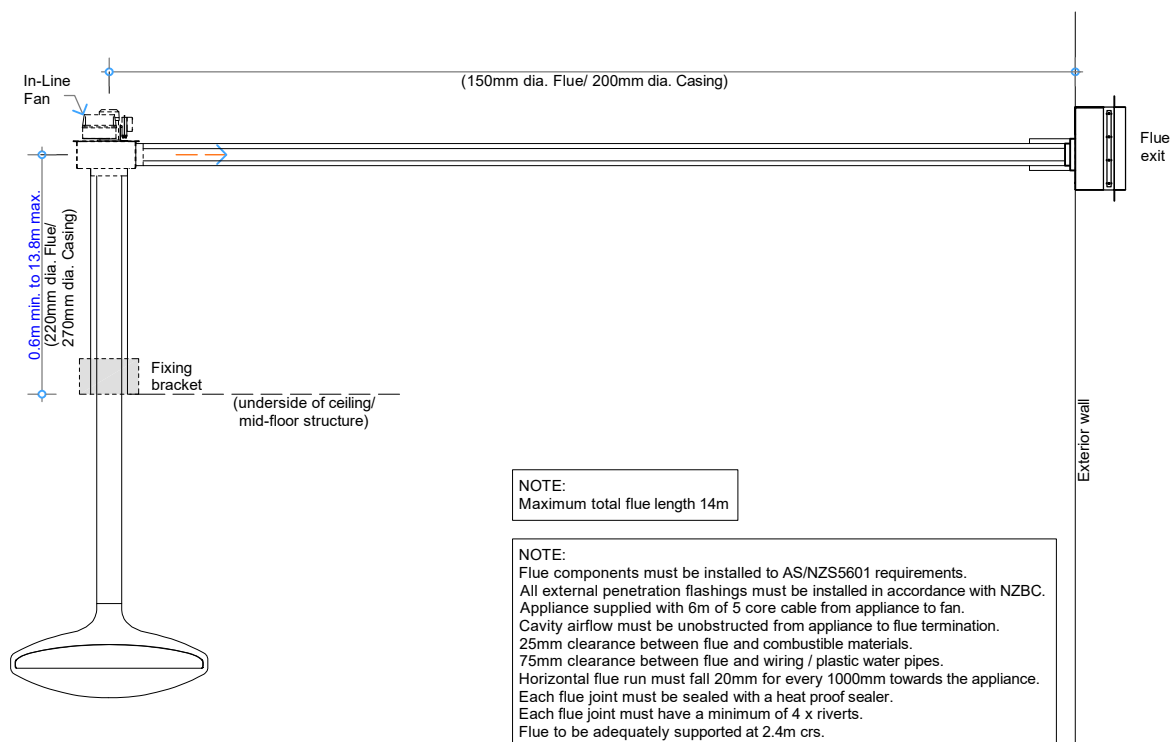

Horizontal Flue Combination GD7D

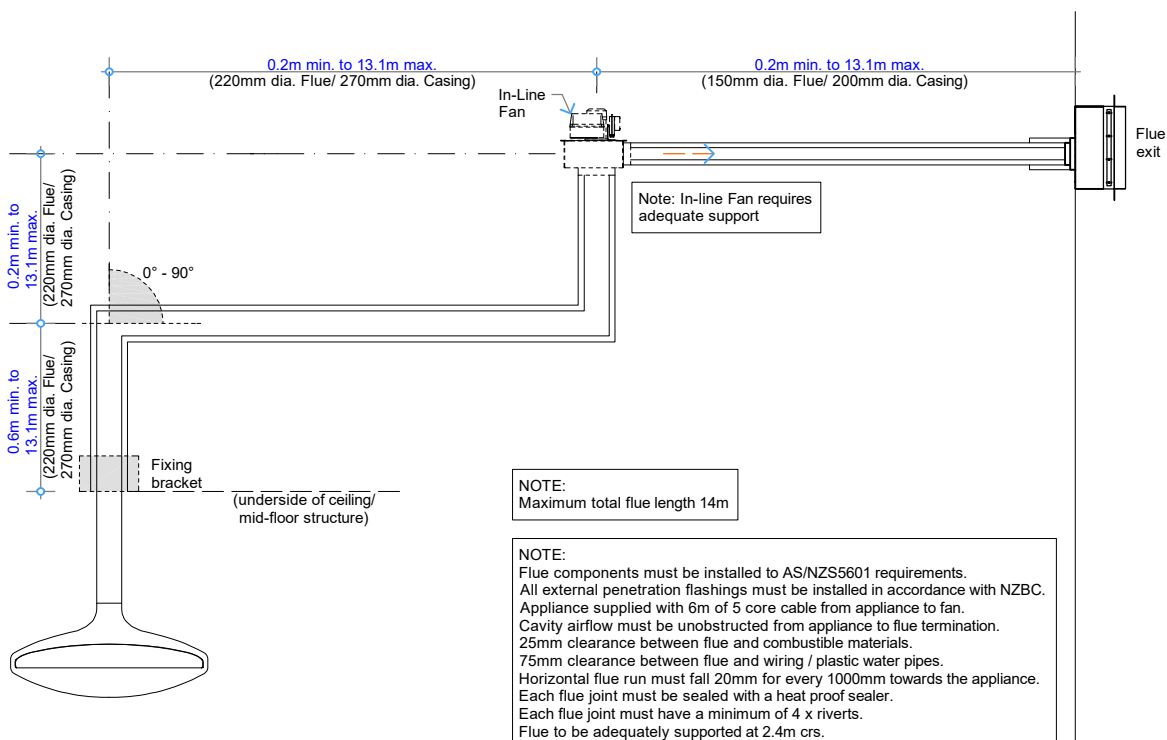

Horizontal Flue Combination GD7E

COPYRIGHT©
THIS DRAWING IS THE PROPERTY
OF The Fire Dept.

Client: THE FIRE DEPT.

Product: GD7-1270

Title: HORIZONTAL FLUE COMBINATION OPTIONS

Drawn: LB

Date: 20/05/2020

Chkd: JW

Date: 08/05/2018

Appd: JW

Date: 08/05/2018

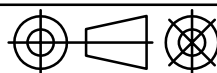

Scale: on A4

THE
**FIRE
DEPT.**
HAND CRAFTED FIRES

Drawing No. **GD7-1270-907**

Sheet 07 of 09

Revision

6

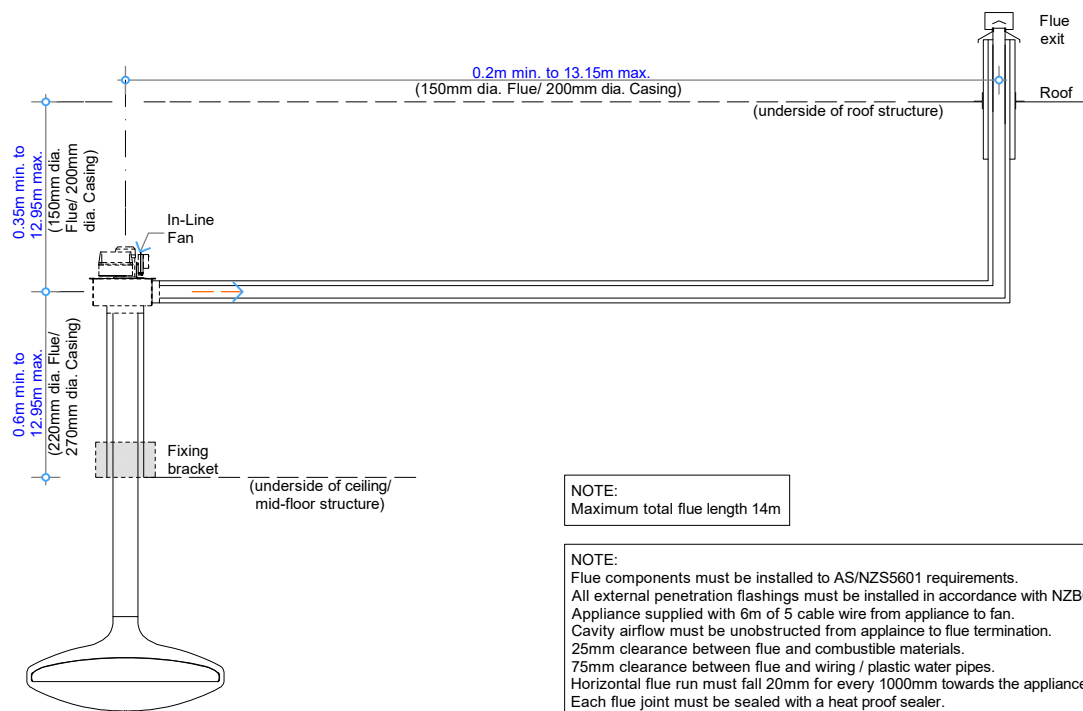

Vertical Flue Combination GD7F

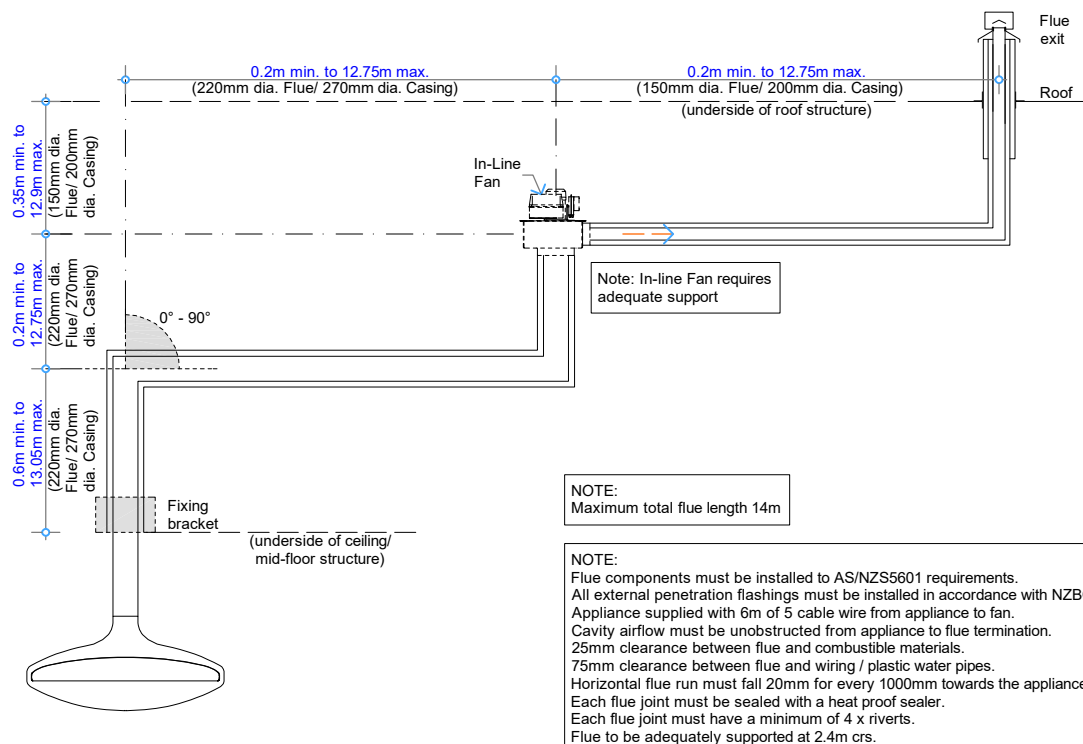

Vertical Flue Combination GD7G

COPYRIGHT©
THIS DRAWING IS THE PROPERTY
OF The Fire Dept.

Client: THE FIRE DEPT.

Product: GD7-1270

Title: VERTICAL FLUE COMBINATION OPTIONS

Drawn: LB

Date: 20/05/2020

Chkd: JW

Date: 08/05/2018

Appd: JW

Date: 08/05/2018

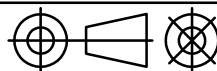

Scale: on A4

THE
**FIRE
DEPT.**
HAND CRAFTED FIRES

Drawing No. **GD7-1270-901**

Sheet 08 of 09

Revision

6

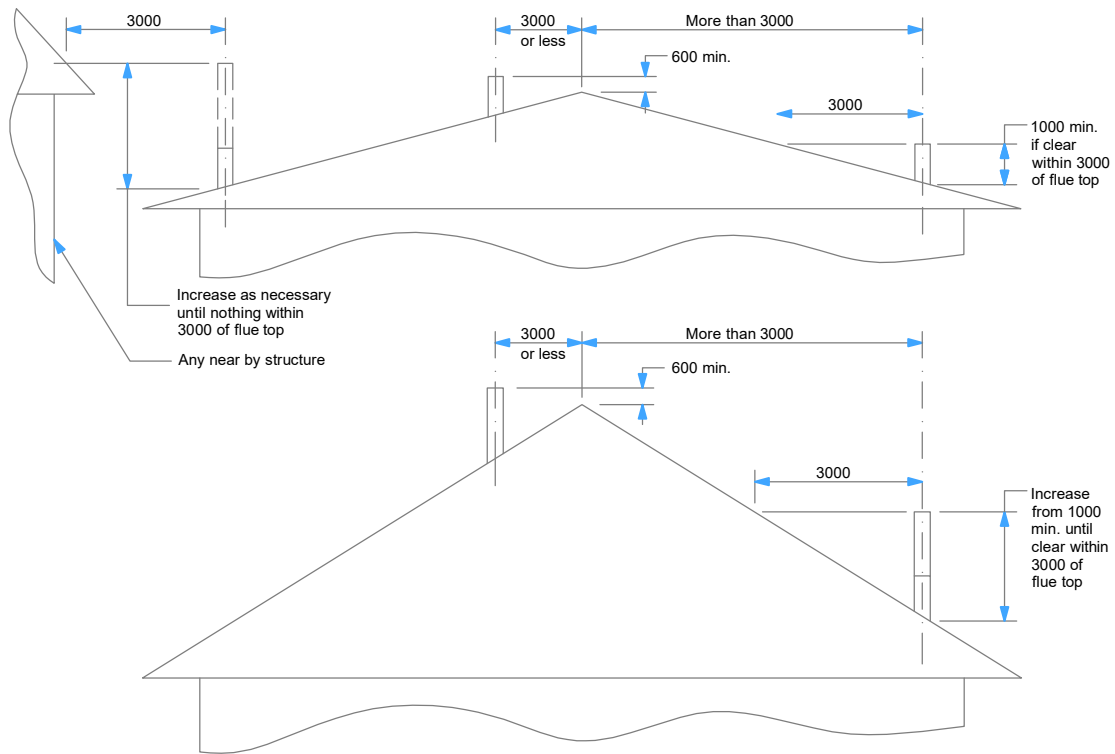

Minimum Height of Flue System Exit
Or as per AS/NZS 5601

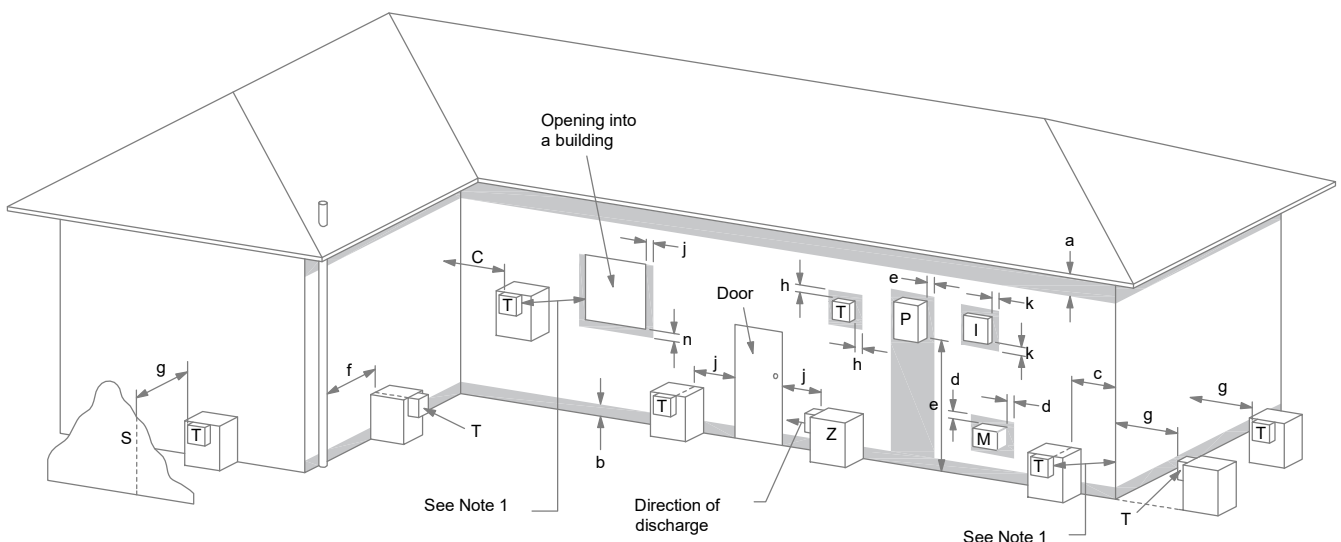

LEGEND:

I = Mechanical air inlet
M = Gas meter
P = Electricity meter or fuse box
S = Structure
T = Flue terminal
Z = Fan-assisted appliance only

a = 200
b = 300
c = 300
d = 1000
e = 500
f = 75
g = 500
h = 300
j = 300 (at window) & 1500 (fan-assisted appliance by the door)
k = 1000
n = 500

NOTES:

1 Where dimensions c, j or k cannot be achieved an equivalent horizontal distance measured diagonally from the nearest discharge point of the terminal to the opening may be deemed by the Technical Regulator to comply.

Shading indicates prohibited area for flue terminals

Location of Flue Terminals of Balanced Flue,
Room-Sealed, Fan-Assisted or Outdoor Appliances

NOTE: To be read in conjunction with AS/NZS 5601.1:2013

COPYRIGHT©
THIS DRAWING IS THE PROPERTY
OF The Fire Dept.

Client: THE FIRE DEPT.

Product: GD7-1270

Title: FLUE EXIT CLEARANCES

Drawn: LB

Date: 20/05/2020

Chkd: JW

Date: 08/05/2018

Appd: JW

Date: 08/05/2018

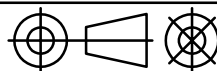

Scale: on A4

THE
**FIRE
DEPT.**
HAND CRAFTED FIRES

Drawing No. **GD7-1270-901**

Sheet 09 of 09

Revision **6**