



**GD2 | 1200
SPECIFICATIONS**

Information in this specification may be subject to change without notice. Please ensure you have the current version before beginning installation.

PLEASE BE AWARE!

Installation required specific wiring requirements including a wall mounted switch.
Ensure electrician is made aware ASAP and homeowner has specified switch location.

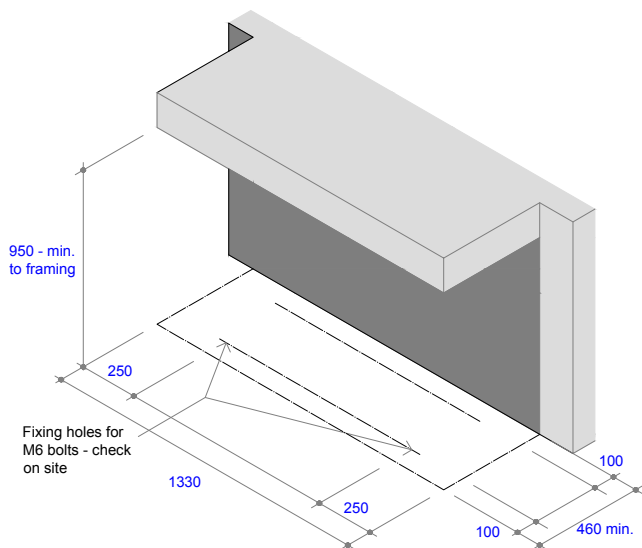
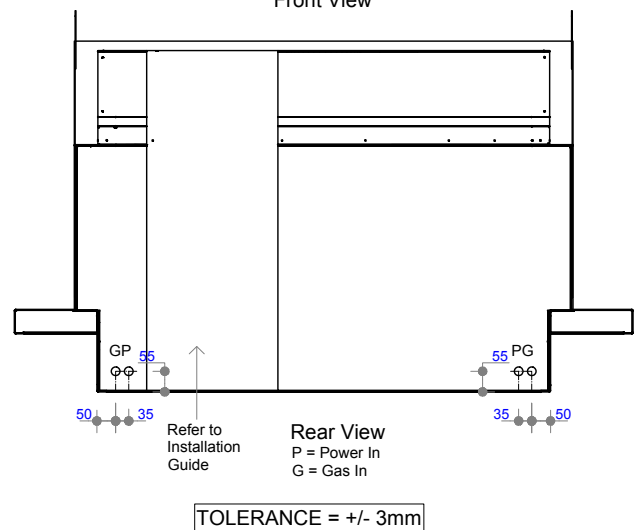
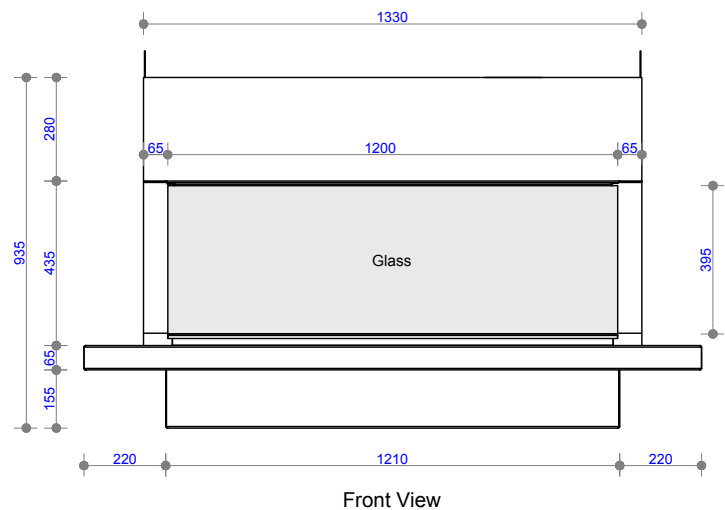
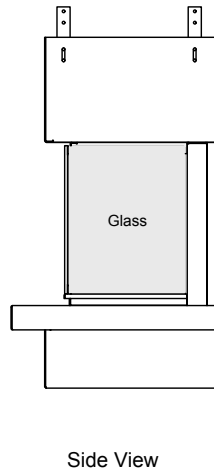
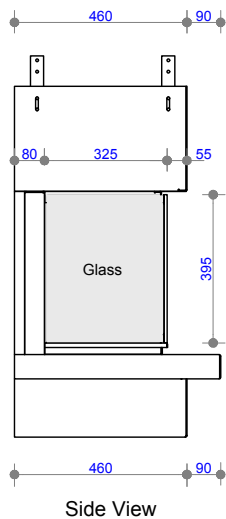
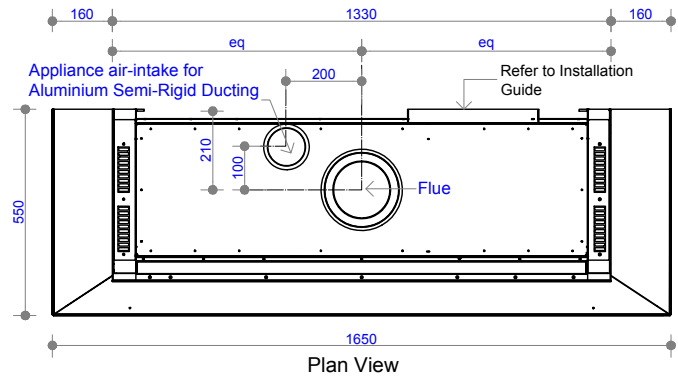

Appliance Installation - Trim Sizes

NOTE: Confirm fixing holes on site prior to drilling

COPYRIGHT©
THIS DRAWING IS THE PROPERTY
OF The Fire Dept.

Client: THE FIRE DEPT.

Product: GD2-1200

Title: FIREBOX DIMENSIONS

Drawn: LB

Date: 07/04/2020

Chkd: JW

Date: 08/05/2018

Appd: JW

Date: 08/05/2018

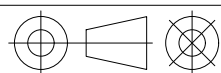

Scale: on A4

Drawing No.

GD2-1200-901

Sheet 01 of 10

Revision

6

THE
**FIRE
DEPT.**
HAND CRAFTED FIRES

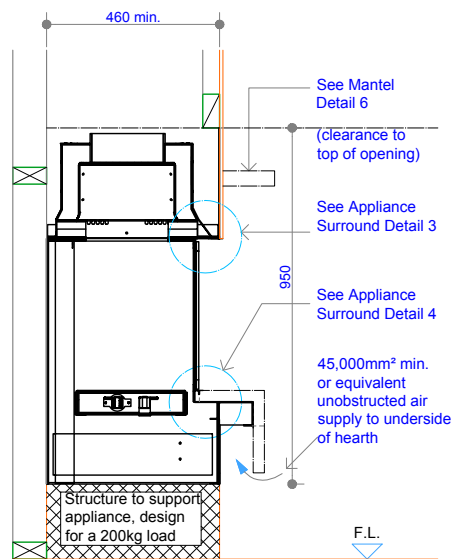
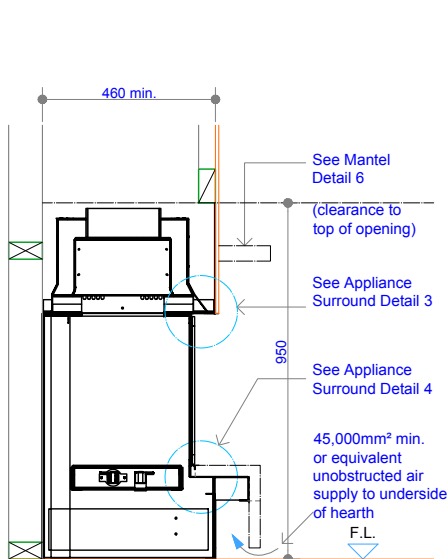
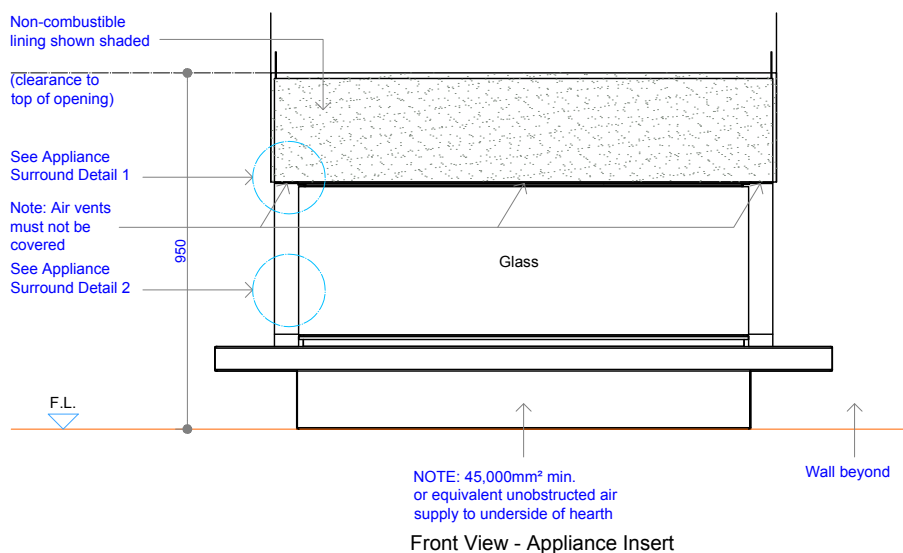
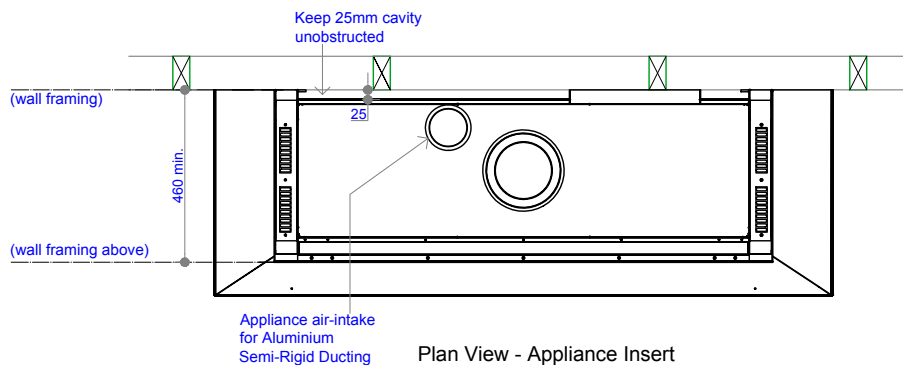

NOTE: Plinth height can vary to suit

COPYRIGHT©
THIS DRAWING IS THE PROPERTY
OF The Fire Dept.

Client: THE FIRE DEPT.

Product: GD2-1200

Title: CAVITY CLEARANCES

Drawn: LB

Date: 07/04/2020

Chkd: JW

Date: 08/05/2018

Appd: JW

Date: 08/05/2018

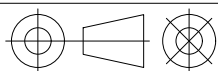

Scale: on A4

THE FIRE DEPT.
HAND CRAFTED FIRES

Drawing No.

GD2-1200-902

Sheet 02 of 10

Revision

6

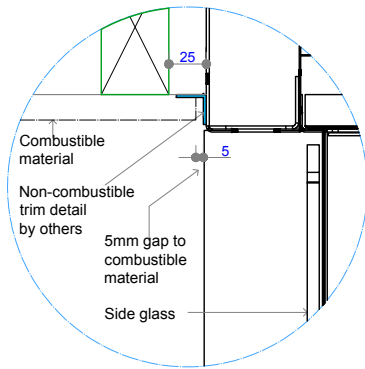

Detail 1 - Cross Section Appliance Surround Opt. 1

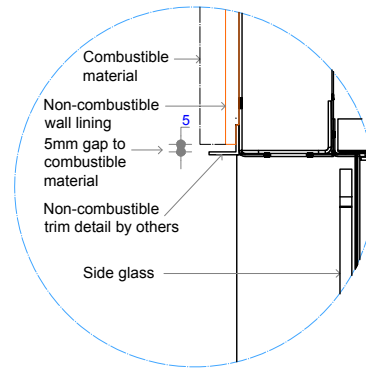

Detail 1 - Cross Section Appliance Surround Opt. 2

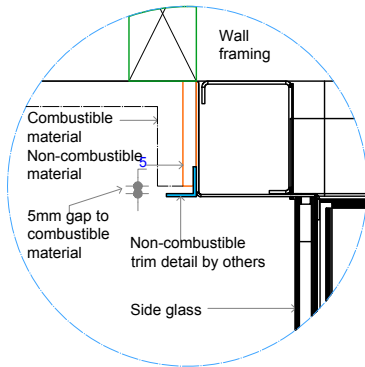

Detail 2 - Plan View Appliance Surround Opt. 3

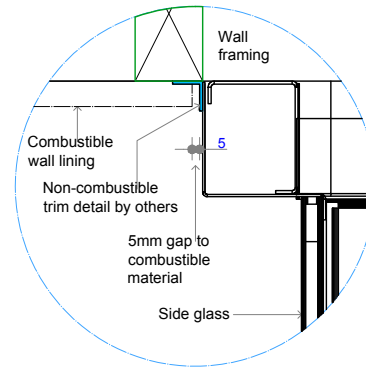

Detail 2 - Plan View Appliance Surround Opt. 4

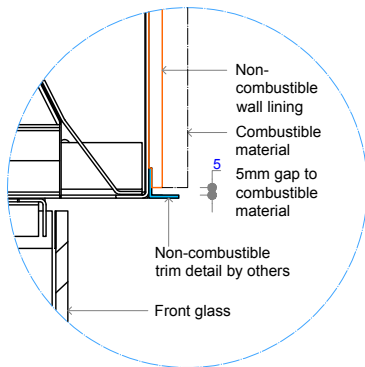

Detail 3 - Top of Appliance to Combustible Materials

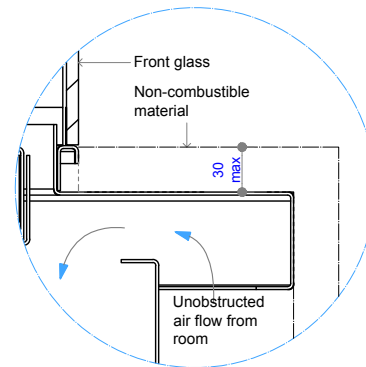

Detail 4 - Bottom of Appliance to Floor Opt. 5
NOTE: 45,000mm² min. or equivalent unobstructed air supply to underside of hearth

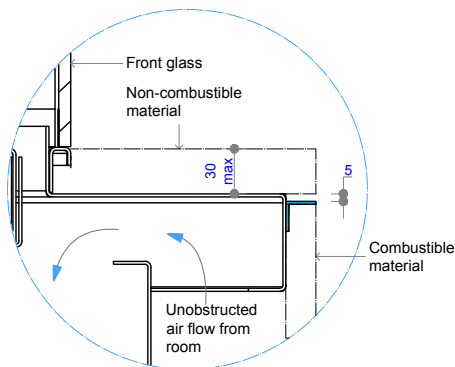

Detail 4 - Bottom of Appliance to Floor Opt. 6
NOTE: 45,000mm² min. or equivalent unobstructed air supply to underside of hearth

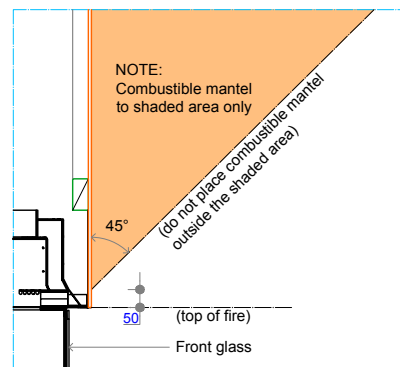

Detail 6 - Top of Appliance to Combustible Mantel

COPYRIGHT©
THIS DRAWING IS THE PROPERTY
OF The Fire Dept.

Client: THE FIRE DEPT.

Product: GD2-1200

Title: SURROUND DETAILS

Drawn: LB

Date: 07/04/2020

Chkd: JW

Date: 08/05/2018

Appd: JW

Date: 08/05/2018

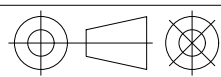

Scale: on A4

THE
**FIRE
DEPT.**
HAND CRAFTED FIRES

Drawing No.

GD2-1200-903

Sheet 03 of 10

Revision

6

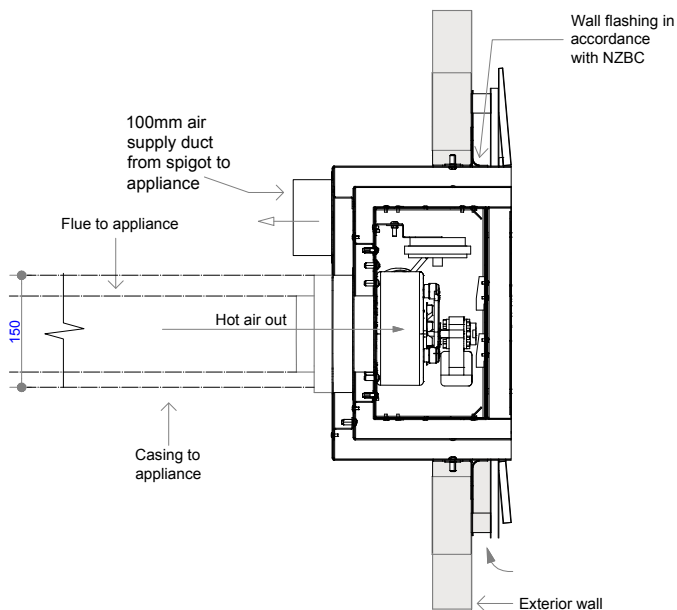

Detail - Combustion fan Option 1
Wall cowl fan, horizontal exit

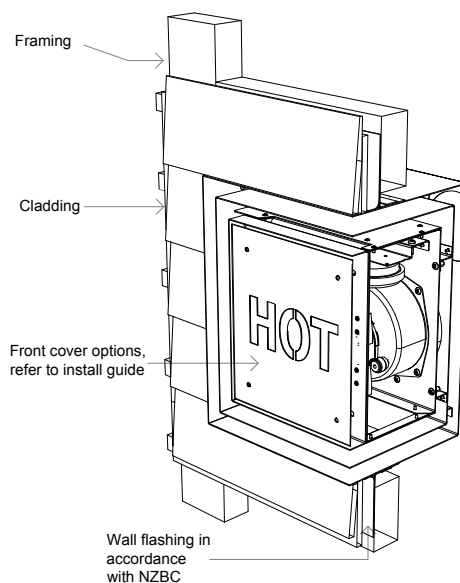

Detail - Wall cowl fan, horizontal exit

NOTE:
Flue components must be installed to AS/NZS5601 requirements.
All external penetration flashings must be installed in accordance with NZBC.
Appliance supplied with 6m of 5 core cable from appliance to fan.
Cavity airflow must be unobstructed from fire to flue termination.
25mm clearance between flue and combustible materials.
75mm clearance between flue and wiring / plastic water pipes.
Horizontal flue run must fall 20mm for every 1000mm towards the appliance.
Each flue joint must be sealed with a heat proof sealer.
Each flue joint must have a minimum of 4 x rivets.
Flue to be adequately supported at 2.4m crs.

Flue components:
100mm dia. Flue
150mm dia. Casing
100mm Ducting

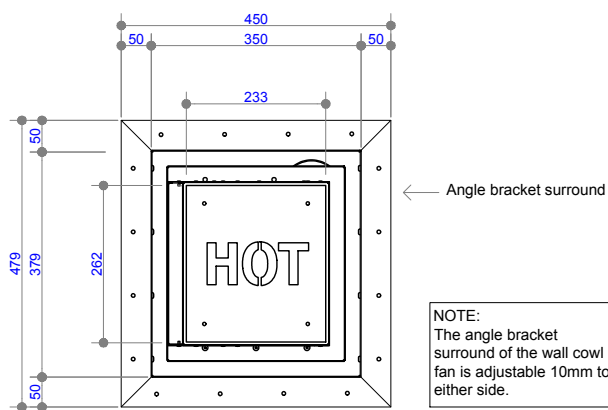

Wall Cowl Fan Front View

NOTE:
The angle bracket surround of the wall cowl fan is adjustable 10mm to either side.

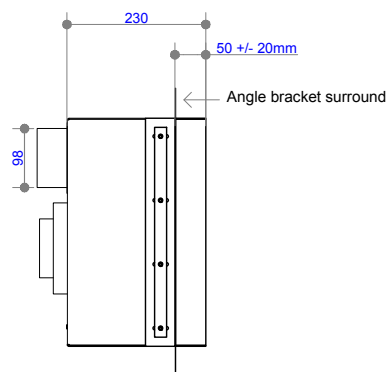

Wall Cowl Fan Side View

COPYRIGHT©
THIS DRAWING IS THE PROPERTY
OF The Fire Dept.

Client: THE FIRE DEPT.

Product: GD2-1200

Title: HORIZONTAL WALL COWL FAN EXIT DETAILS

Drawn: LB

Date: 07/04/2020

Chkd: JW

Date: 08/05/2018

Appd: JW

Date: 08/05/2018

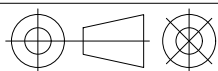

Scale: on A4

THE
**FIRE
DEPT.**
HAND CRAFTED FIRES

Drawing No.

GD2-1200-904

Sheet 04 of 10

Revision

6

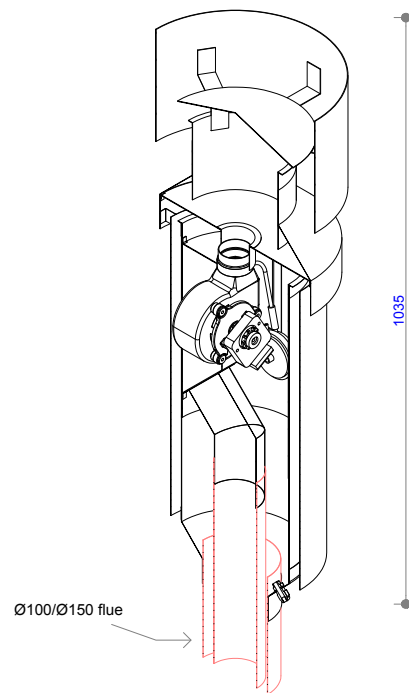
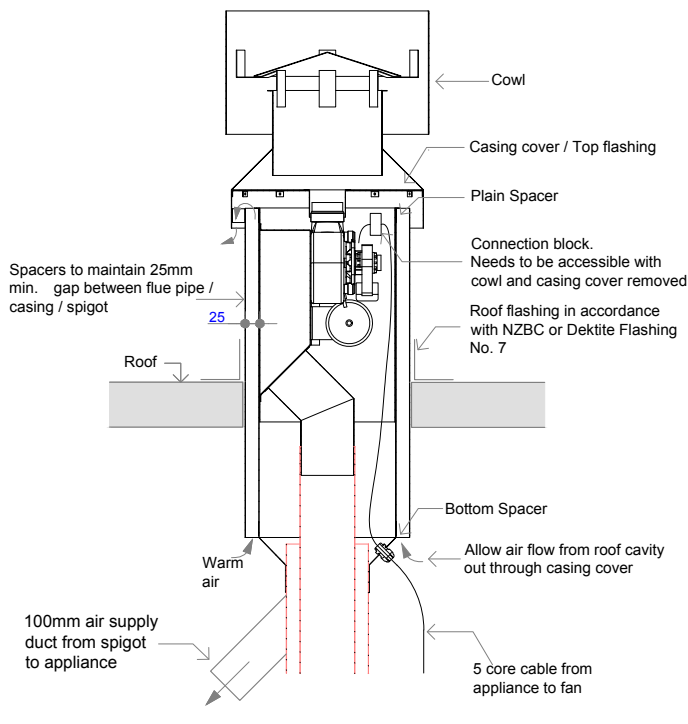

Detail - Combustion fan Option 2
Cowl fan, vertical exit

NOTE:

Flue components must be installed to AS/NZS5601 requirements.
All external penetration flashings must be installed in accordance with NZBC.
Appliance supplied with 6m of 5 core cable from appliance to fan.
Cavity airflow must be unobstructed from fire to flue termination.
25mm clearance between flue and combustible materials.
75mm clearance between flue and wiring / plastic water pipes.
Horizontal flue run must fall 20mm for every 1000mm towards the appliance.
Each flue joint must be sealed with a heat proof sealer.
Each flue joint must have a minimum of 4 x rivets.
Flue to be adequately supported at 2.4m crs.

Flue components:
100mm dia. Flue
150mm dia. Casing
300mm dia. Spigot
100mm Ducting

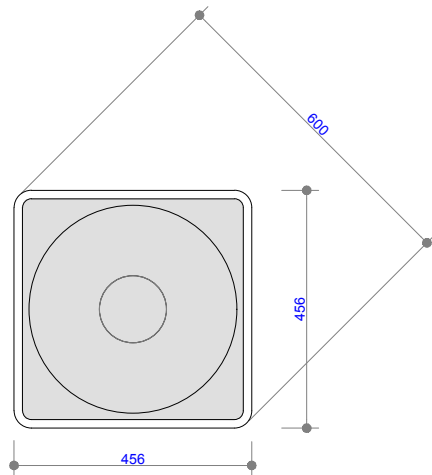

Deklite Flashing No. 7 - Plan View

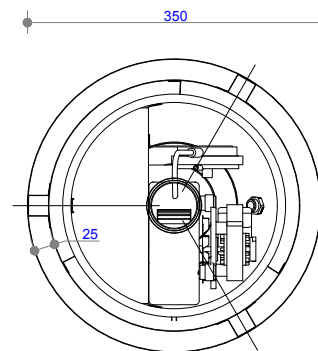

Cowl Fan Top View

COPYRIGHT©
THIS DRAWING IS THE PROPERTY
OF The Fire Dept.

Client: THE FIRE DEPT.

Product: GD2-1200

Title: VERTICAL COWL FAN, EXIT DETAILS

Drawn: LB

Date: 07/04/2020

Chkd: JW

Date: 08/05/2018

Appd: JW

Date: 08/05/2018

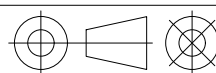

Scale: on A4

THE FIRE DEPT.
HAND CRAFTED FIRES

Drawing No.

GD2-1200-905

Sheet 05 of 10

Revision

6

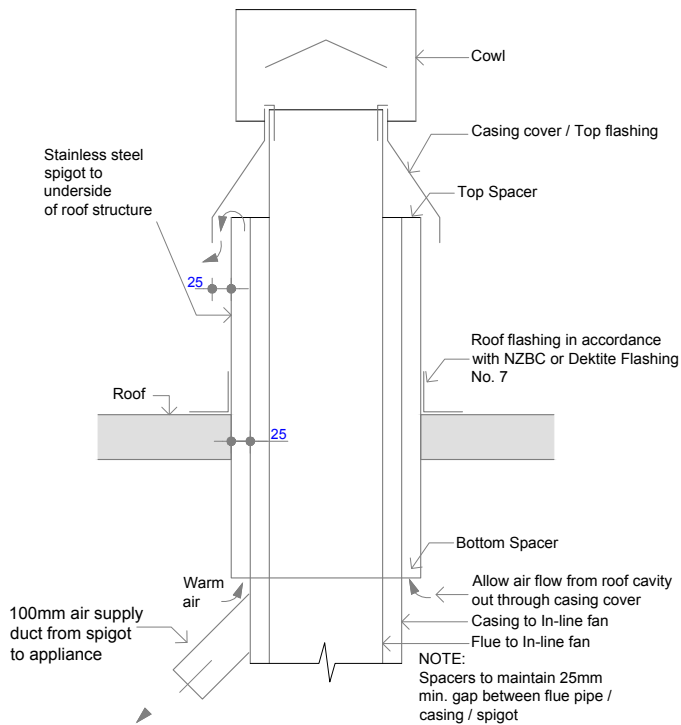

Detail - Air Ventilation through Casing cover/ Top flashing
Option 3A - To be used in conjunction with Fan Option 3

NOTE:

Flue components must be installed to AS/NZS5601 requirements.
All external penetration flashings must be installed in accordance with NZBC.
Appliance supplied with 6m of 5 core cable from appliance to fan.
Cavity airflow must be unobstructed from fire to flue termination.
25mm clearance between flue and combustible materials.
75mm clearance between flue and wiring / plastic water pipes.
Horizontal flue run must fall 20mm for every 1000mm towards the appliance.
Each flue joint must be sealed with a heat proof sealer.
Each flue joint must have a minimum of 4 x rivets.
Flue to be adequately supported at 2.4m crs.

Flue components:
100mm dia. Flue
150mm dia. Casing
200mm dia. Spigot
100mm Ducting

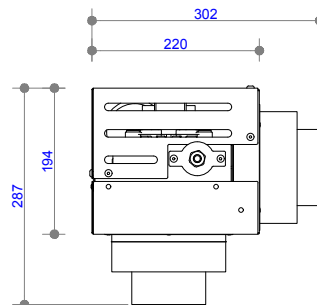

Detail - Combustion fan Option 3
In-Line Fan Side View

NOTE: Requires access hatch for maintenance

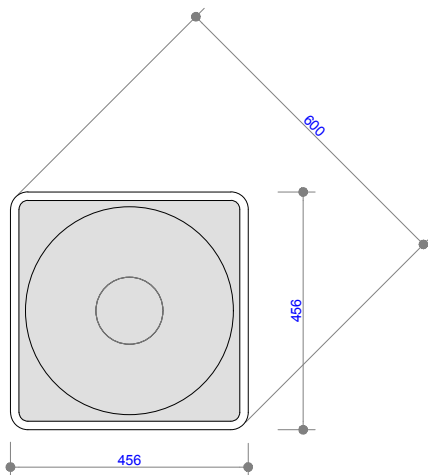

Deklite Flashing No. 7 - Plan View

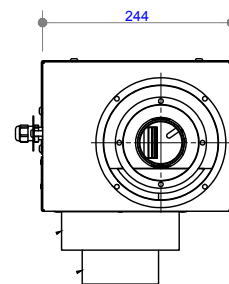

Detail - Combustion fan Option 3
In-Line Fan Front View

NOTE: Requires access hatch for maintenance

COPYRIGHT©
THIS DRAWING IS THE PROPERTY
OF The Fire Dept.

Client: THE FIRE DEPT.

Product: GD2-1200

Title: VERTICAL & HORIZONTAL FLUE EXIT DETAILS

Drawn: LB

Date: 07/04/2020

Chkd: JW

Date: 08/05/2018

Appd: JW

Date: 08/05/2018

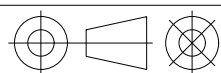

Scale: on A4

Drawing No.

GD2-1200-906

Sheet 06 of 10

Revision

6

THE
**FIRE
DEPT.**
HAND CRAFTED FIRES

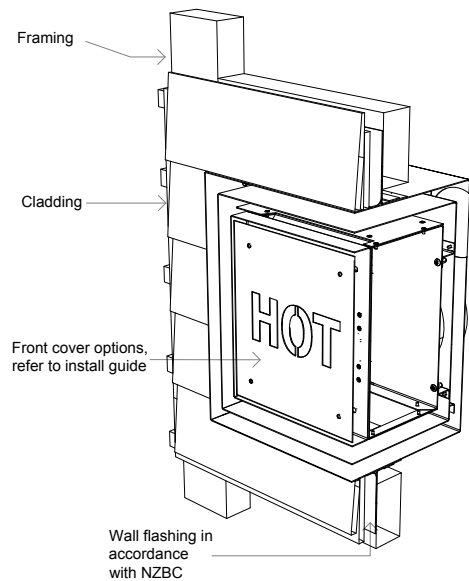
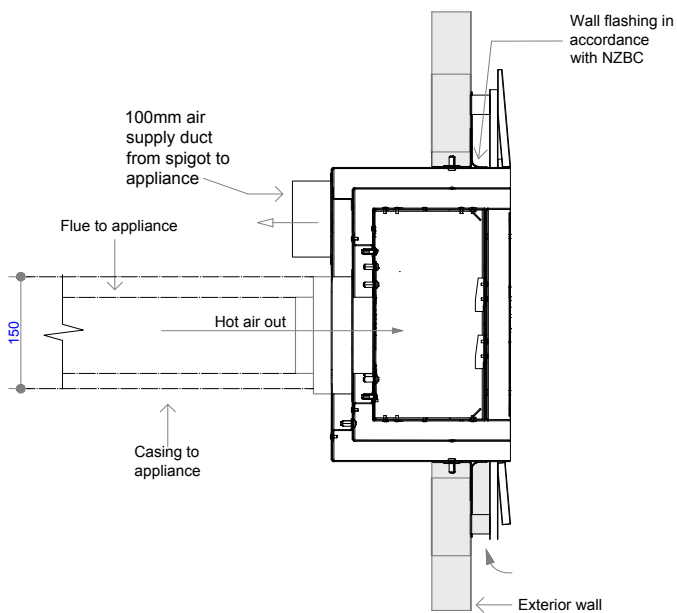

Detail - Wall cowl, horizontal exit
Option 3B - To be used in conjunction with Fan Option 3

Detail - Wall cowl, horizontal exit

NOTE:

Flue components must be installed to AS/NZS5601 requirements.
All external penetration flashings must be installed in accordance with NZBC.
Appliance supplied with 6m of 5 core cable from appliance to fan.
Cavity airflow must be unobstructed from fire to flue termination.
25mm clearance between flue and combustible materials.
75mm clearance between flue and wiring / plastic water pipes.
Horizontal flue run must fall 20mm for every 1000mm towards the appliance.
Each flue joint must be sealed with a heat proof sealer.
Each flue joint must have a minimum of 4 x rivets.
Flue to be adequately supported at 2.4m crs.

Flue components:
100mm dia. Flue
150mm dia. Casing
100mm Ducting

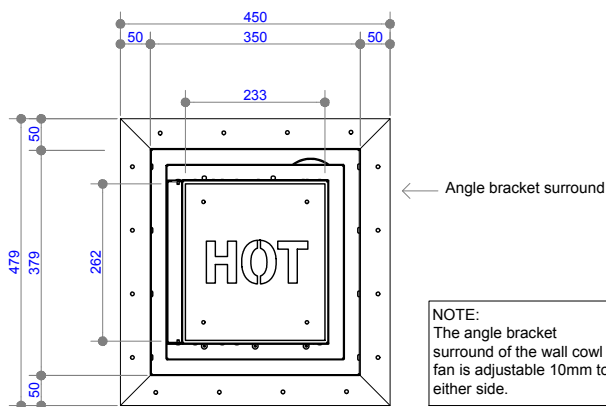

Wall Cowl Front View

NOTE:
The angle bracket surround of the wall cowl fan is adjustable 10mm to either side.

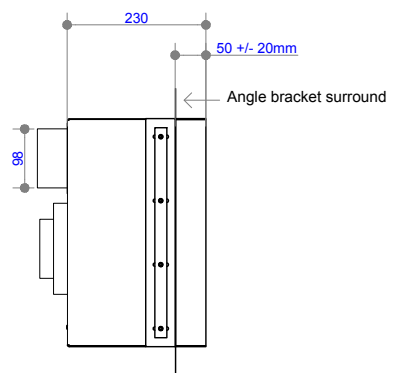

Wall Cowl Side View

COPYRIGHT©
THIS DRAWING IS THE PROPERTY
OF The Fire Dept.

Client: THE FIRE DEPT.

Product: GD2-1200

Title: HORIZONTAL WALL COWL EXIT DETAILS

Drawn: LB

Date: 07/04/2020

Chkd: JW

Date: 08/05/2018

Appd: JW

Date: 08/05/2018

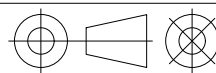

Scale: on A4

THE FIRE DEPT.
HAND CRAFTED FIRES

Drawing No.

GD2-1200-907

Sheet 07 of 10

Revision

6

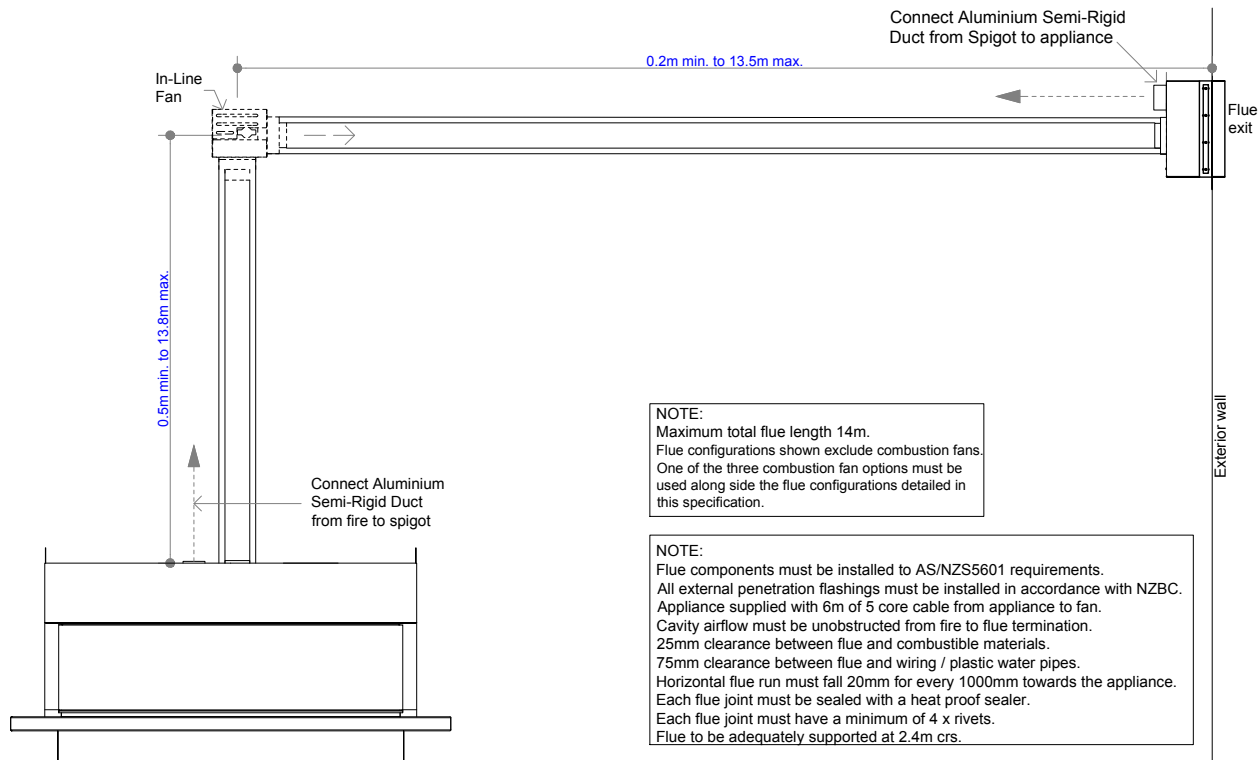

Horizontal Flue Combination GD2A

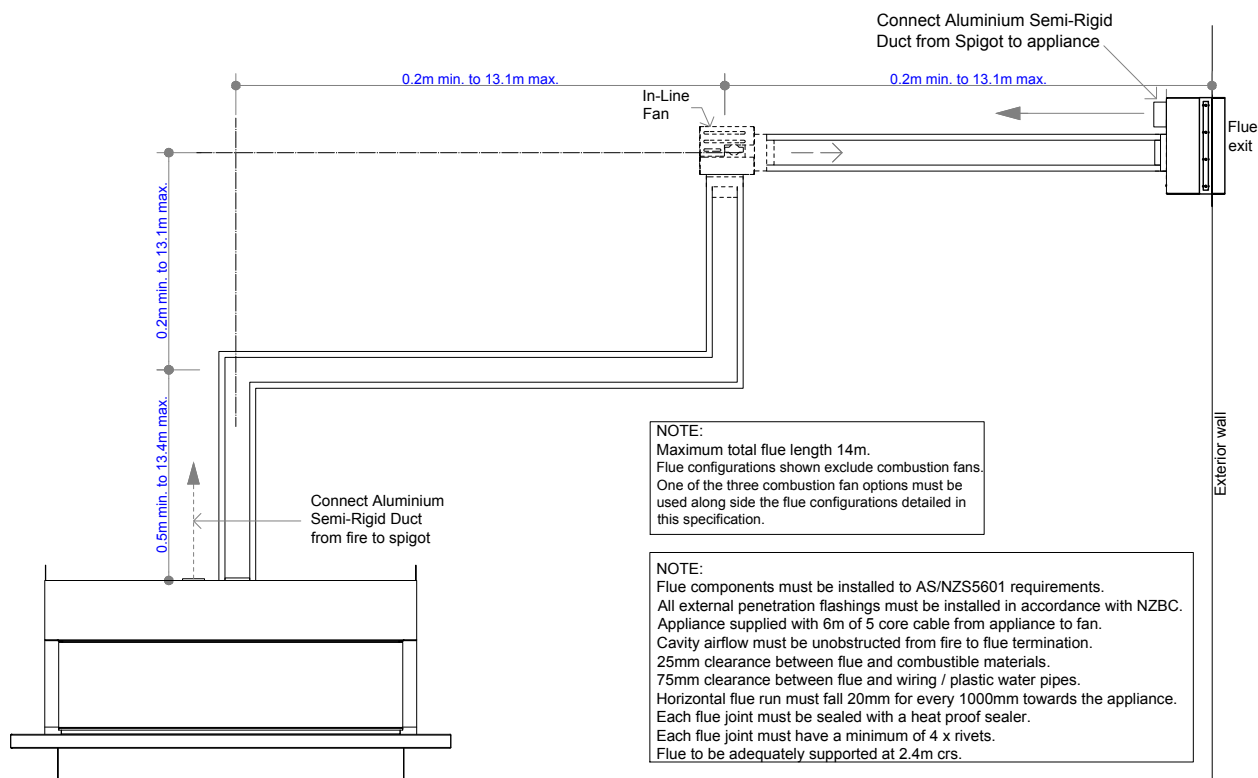

Horizontal Flue Combination GD2B

COPYRIGHT©
THIS DRAWING IS THE PROPERTY
OF The Fire Dept.

Client: THE FIRE DEPT.

Product: GD2-1200

Title: HORIZONTAL FLUE COMBINATION OPTIONS

Drawn: LB

Date: 07/04/2020

Chkd: JW

Date: 08/05/2018

Appd: JW

Date: 08/05/2018

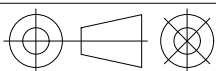

Scale: on A4

THE
**FIRE
DEPT.**
HAND CRAFTED FIRES

Drawing No.

GD2-1200-908

Sheet 08 of 10

Revision

6

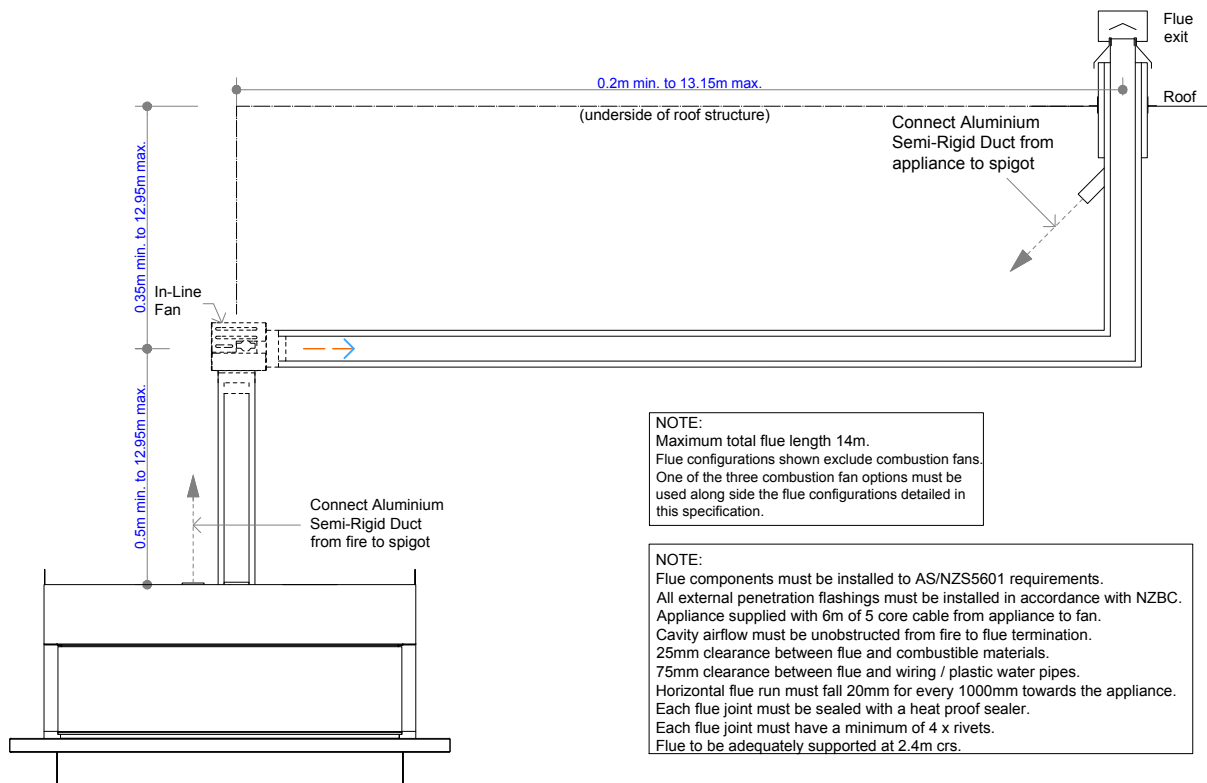

Vertical Flue Combination GD2C

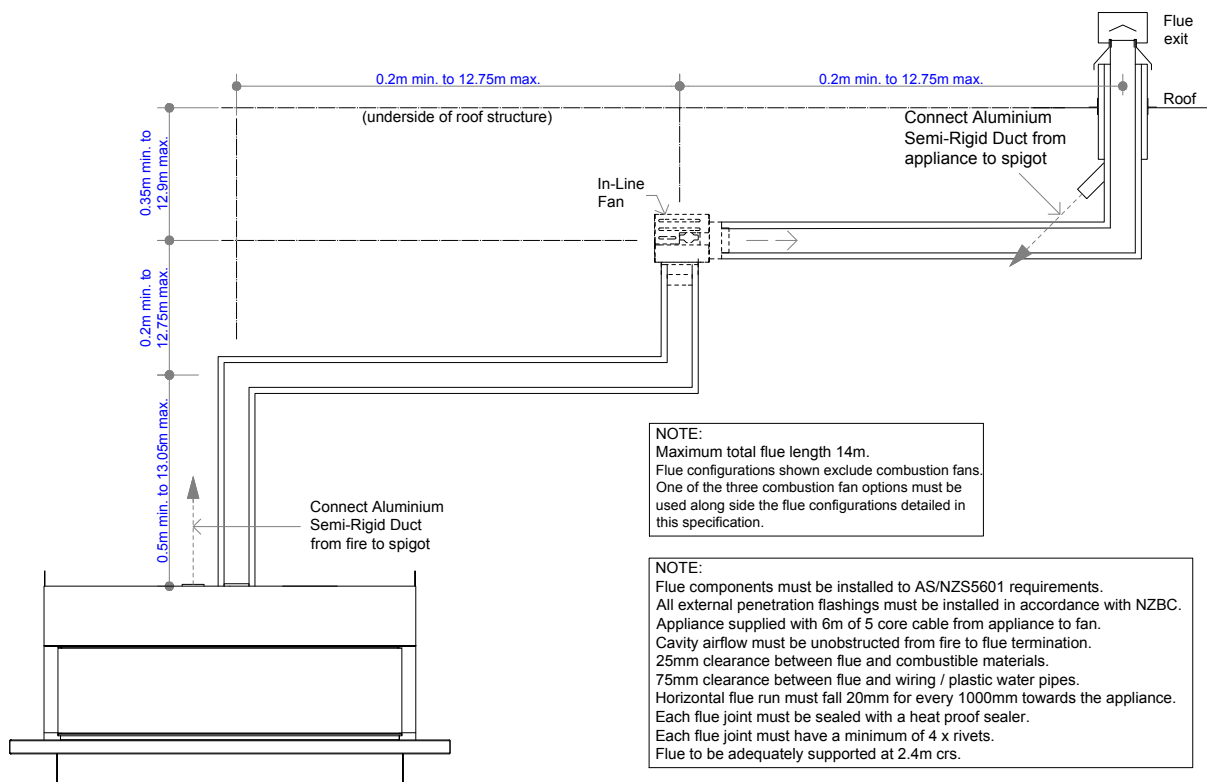

Vertical Flue Combination GD2D

COPYRIGHT©
THIS DRAWING IS THE PROPERTY
OF The Fire Dept.

Client: THE FIRE DEPT.

Product: GD2-1200

Title: VERTICAL FLUE COMBINATION OPTIONS

Drawn: LB

Date: 07/04/2020

Chkd: JW

Date: 08/05/2018

Appd: JW

Date: 08/05/2018

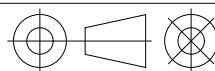

Scale: on A4

THE
**FIRE
DEPT.**
HAND CRAFTED FIRES

Drawing No.

GD2-1200-909

Sheet 09 of 10

Revision

6

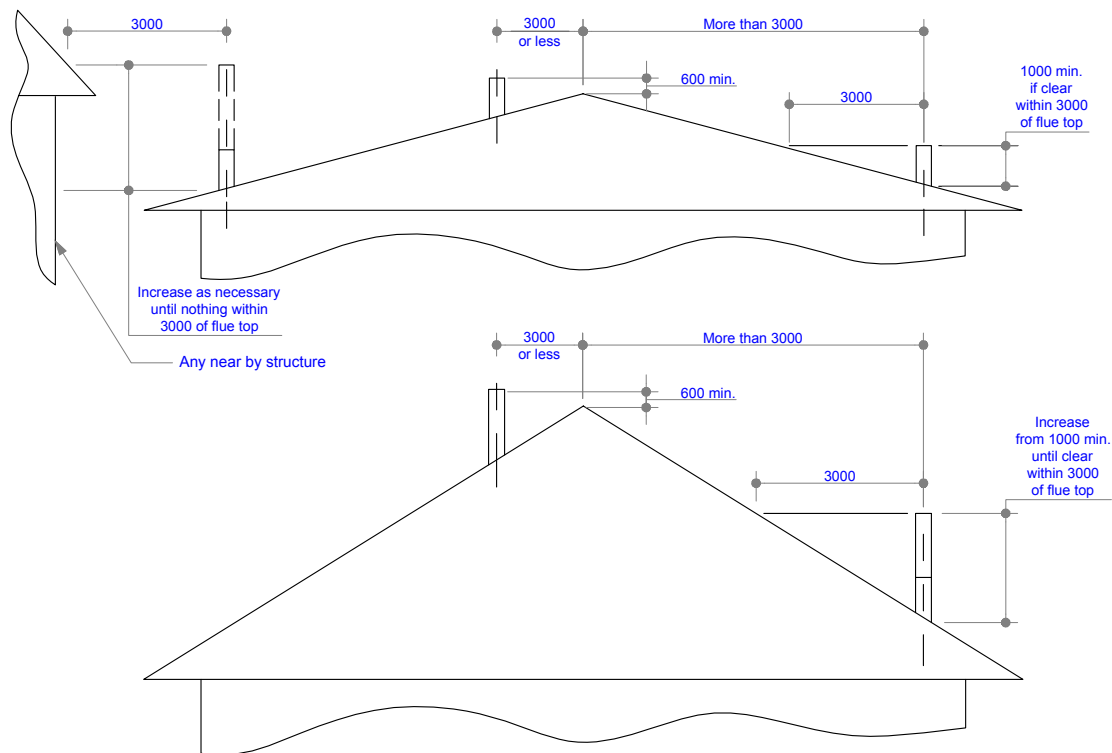

Minimum Height of Flue System Exit
Or as per AS/NZS 5601

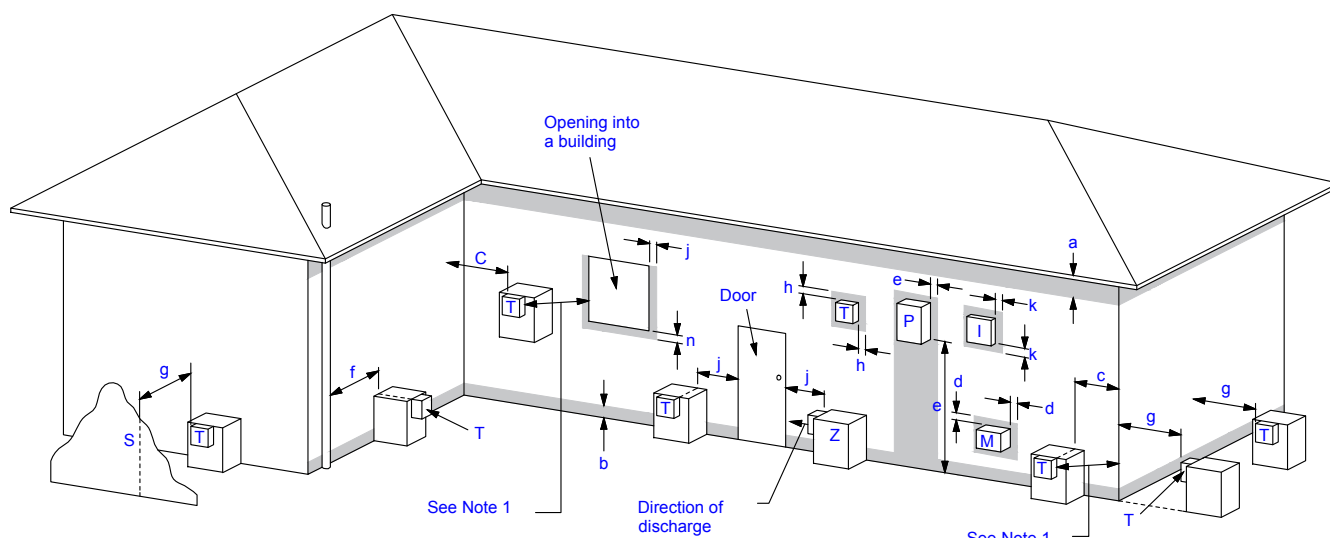

LEGEND:

I = Mechanical air inlet
M = Gas meter
P = Electricity meter or fuse box
S = Structure
T = Flue terminal
Z = Fan-assisted appliance only

a = 200
b = 300
c = 300
d = 1000
e = 500
f = 75
g = 500
h = 300
j = 300 (at window) & 1500 (fan-assisted appliance by the door)
k = 1000
n = 500

NOTES:

1 Where dimensions c, j or k cannot be achieved an equivalent horizontal distance measured diagonally from the nearest discharge point of the terminal to the opening may be deemed by the Technical Regulator to comply.

Shading indicates prohibited area for flue terminals

Location of Flue Terminals of Balanced Flue,
Room-Sealed, Fan-Assisted or Outdoor Appliances

NOTE: To be read in conjunction with AS/NZS 5601.1:2013

COPYRIGHT©
THIS DRAWING IS THE PROPERTY
OF The Fire Dept.

Client: THE FIRE DEPT.

Product: GD2-1200

Title: FLUE EXIT CLEARANCES

Drawn: LB

Date: 07/04/2020

Chkd: JW

Date: 08/05/2018

Appd: JW

Date: 08/05/2018

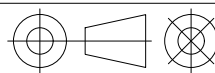

Scale: on A4

THE
**FIRE
DEPT.**
HAND CRAFTED FIRES

Drawing No.

GD2-1200-910

Sheet 10 of 10

Revision

6