

**THE
FIRE
DEPT.
HAND CRAFTED FIRES**

**WD7 | 1200
SPECIFICATIONS**

Information in this specification may be subject to change without notice. Please ensure you have the current version before beginning installation.

If fireplace is installed on a combustible surface, a layer of non combustible material needs to be placed in front of the fireplace opening for floor protection

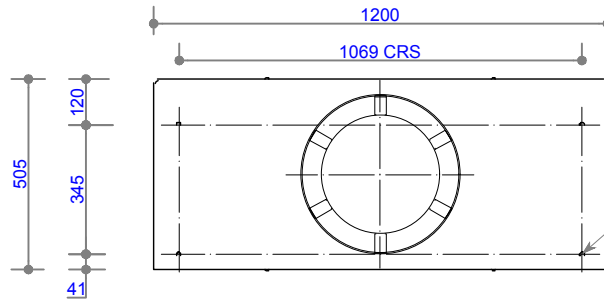

NOTE:
2mm Non-combustible material required directly in front of fireplace opening if placed onto combustible flooring.
e.g timber deck
Min dimensions:
1350 x 1350 mm x 2mm thick

Fixing holes for M12 fixing bolts

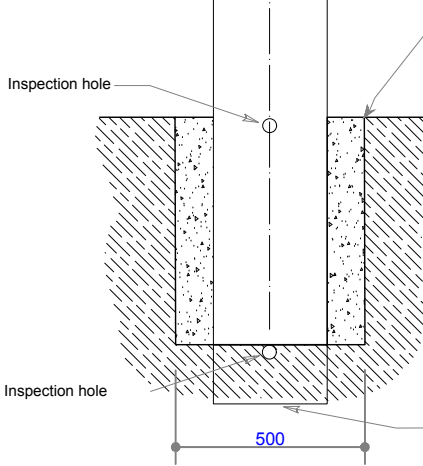
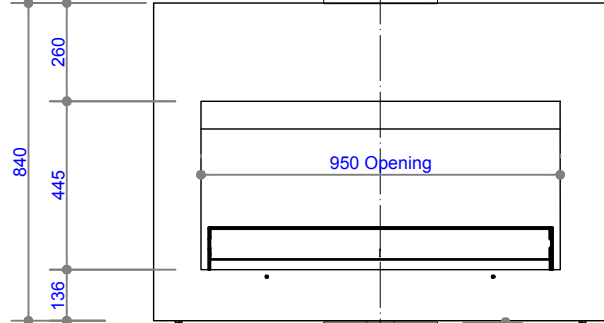
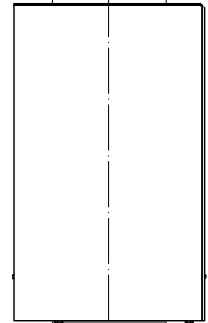
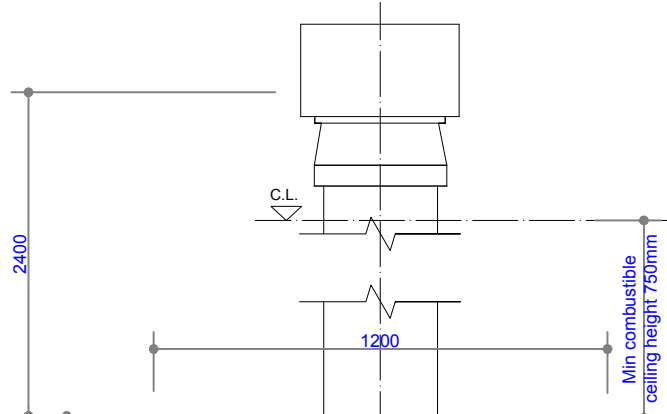
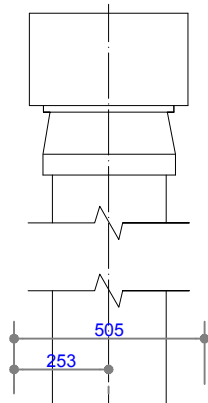

NOTE:
2mm Non-combustible material required directly in front of fireplace opening if placed onto combustible flooring.
e.g timber deck
Min dimensions:
1350 x 1350 mm x 2mm thick

Crimped end of flue to be pushed into the soil

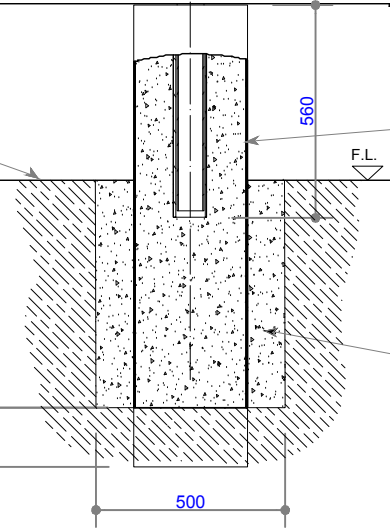

NOTE: Optional Spinning base.

100mm of concrete cover (Engineering required - by others)

Side View

Front view

TOLERANCE = +/- 3mm

COPYRIGHT©
THIS DRAWING IS THE PROPERTY
OF The Fire Dept.

Client: THE FIRE DEPT.

Product: WD7

Title: FIREPLACE DIMENSIONS

Drawn: JG

Date: 25/08/2022

Chkd: LB

Date: 25/08/2022

Appd: JW

Date: 25/08/2022

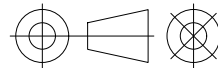

Scale: on A4

THE FIRE DEPT.
HAND CRAFTED FIRES

Drawing No.

WD7-1200-901

Sheet 01 of 07

Revision 9

If fireplace is installed on a combustible surface, a layer of non combustible material needs to be placed in front of the fireplace opening for floor protection

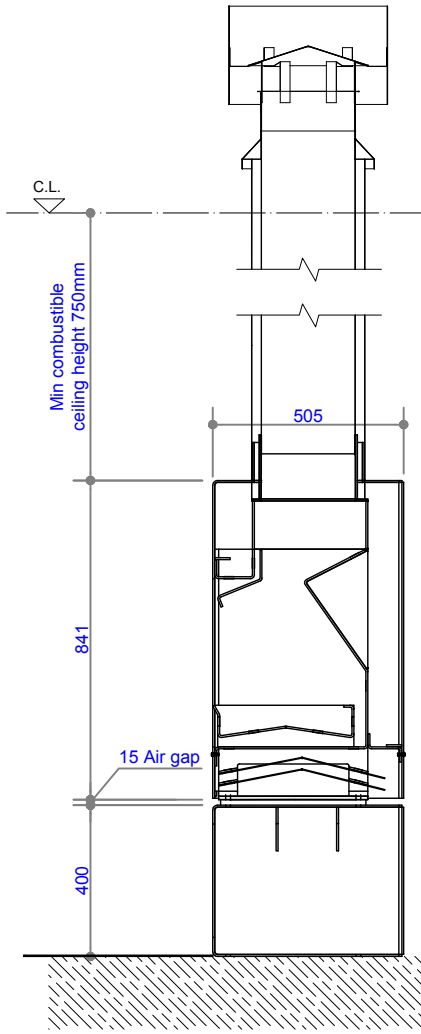
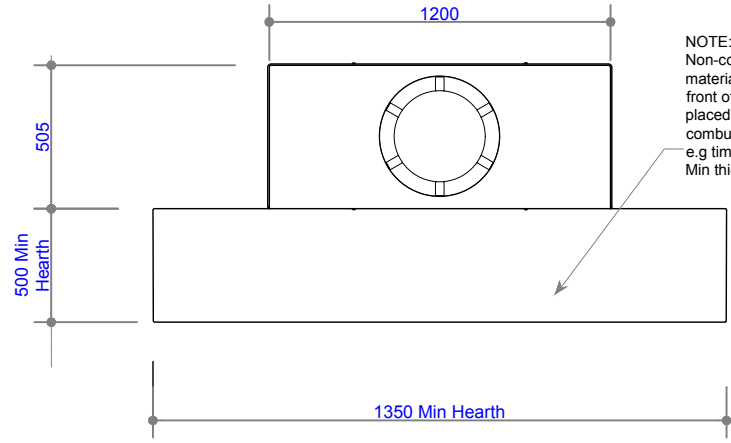

Side View

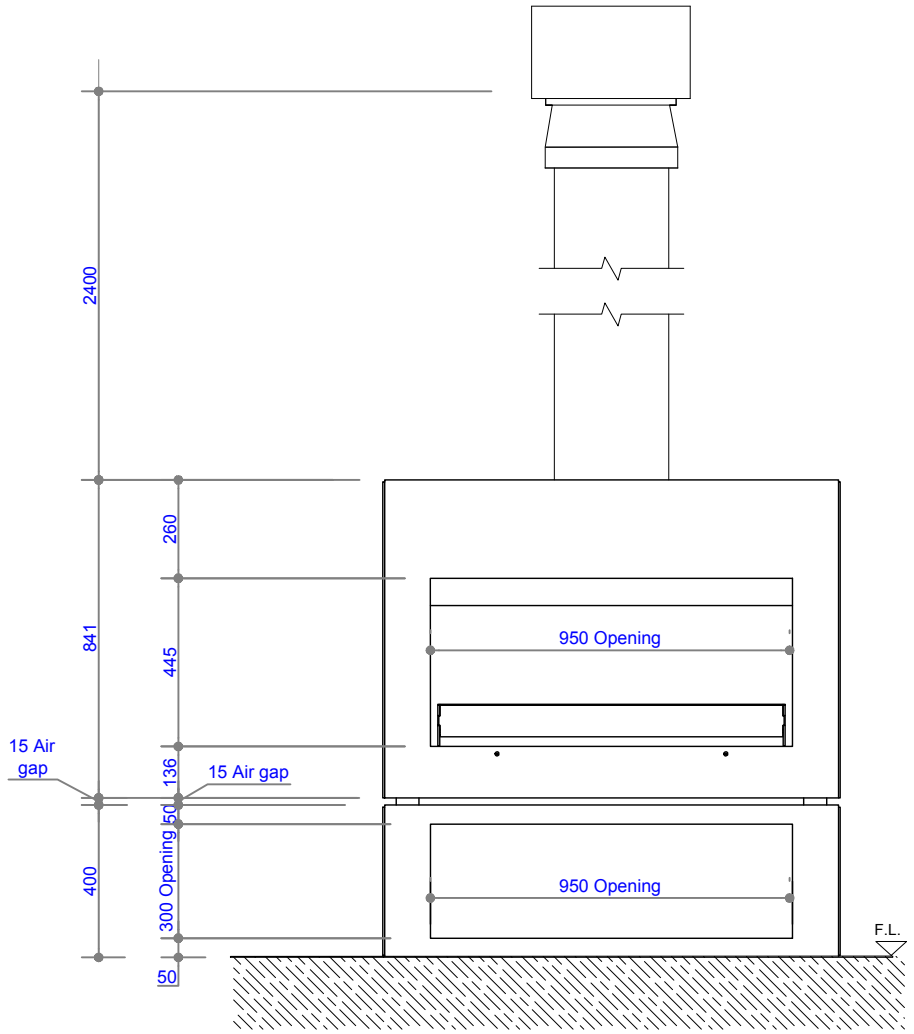

Front view

TOLERANCE = +/- 3mm

COPYRIGHT©
THIS DRAWING IS THE PROPERTY
OF The Fire Dept.

Client: THE FIRE DEPT.		
Product: WD7		
Title: FIREPLACE DIMENSIONS		
Drawn: JG	Date: 25/08/2022	
Chkd: LB	Date: 25/08/2022	
Appd: JW	Date: 25/08/2022	
Scale:		on A4



Drawing No.	WD7-1200-902	Sheet 02 of 07	Revision
-------------	--------------	----------------	----------

If fireplace is installed on a combustible surface, a layer of 9mm Compressed Concrete Sheet needs to sit under the hearth.

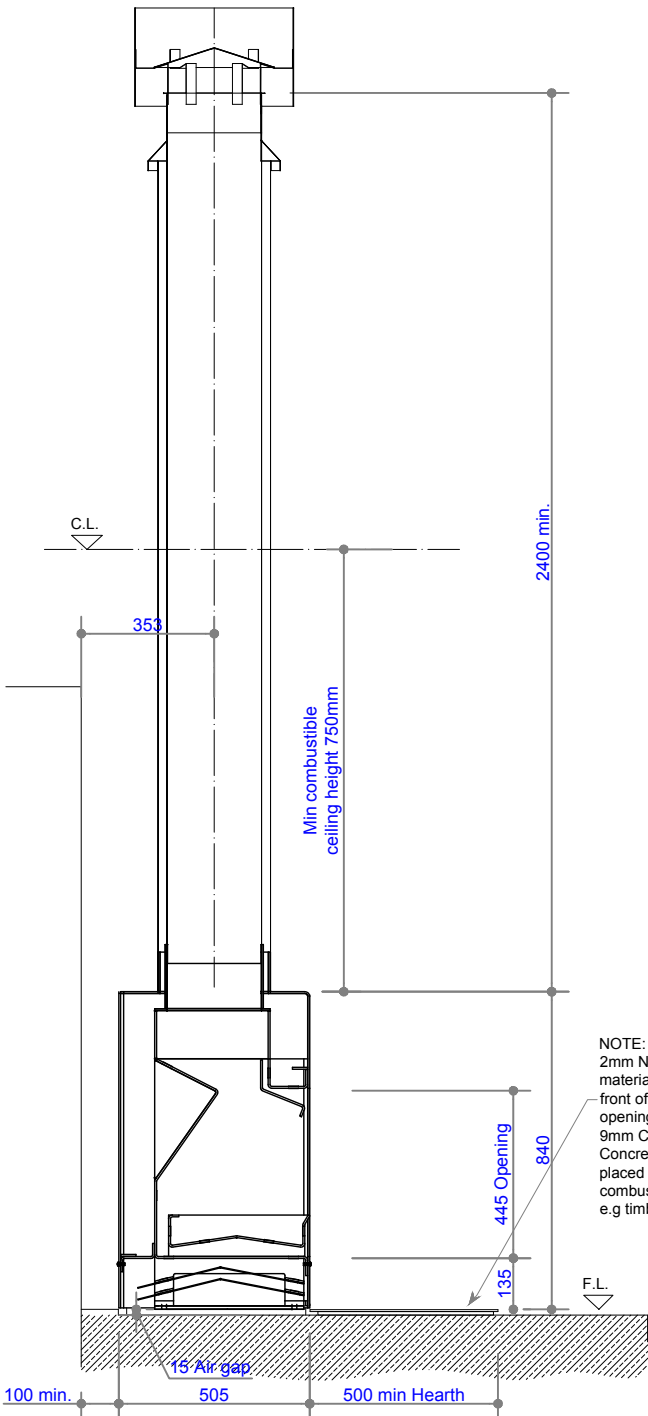

Cross Section - Fireplace at floor level

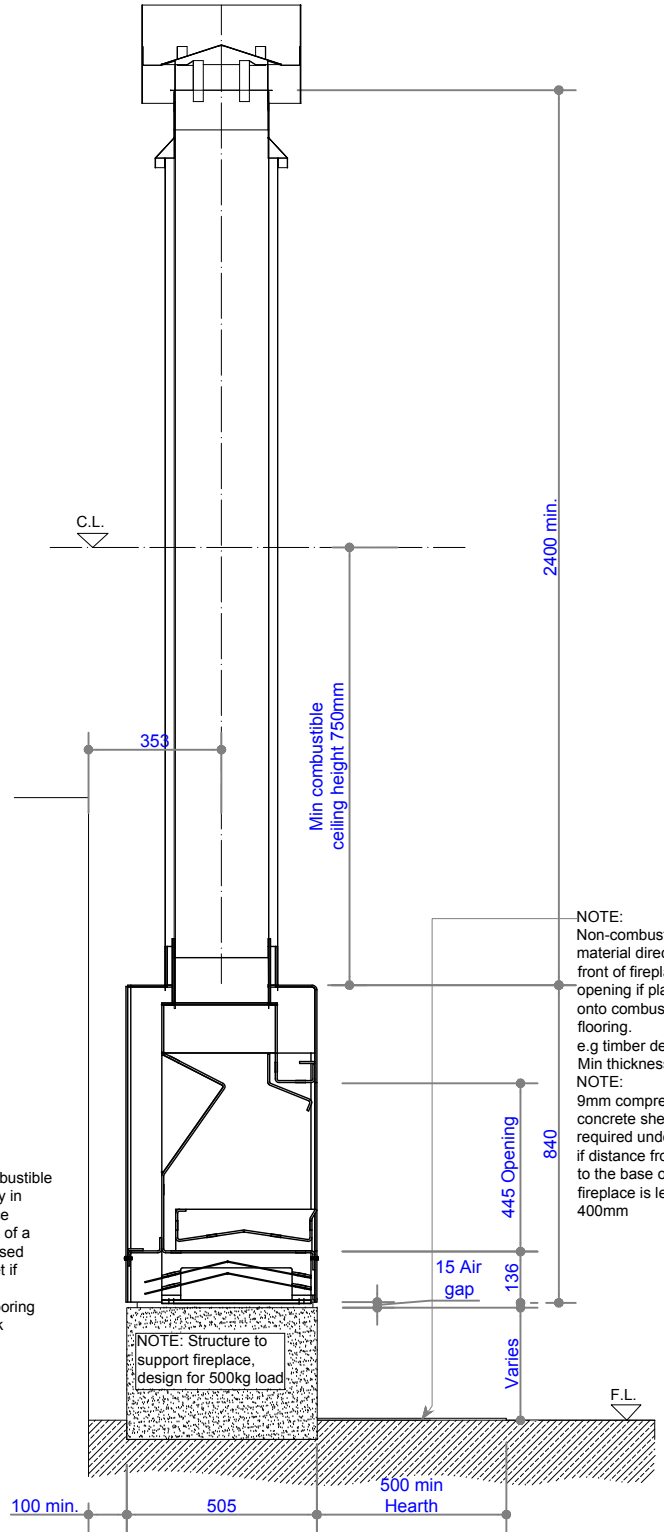

Cross Section - Fireplace on raised plinth

NOTE: Plinth height can vary to suit

NOTE: Non-combustible material directly in front of fireplace opening if placed onto combustible flooring. e.g timber deck
Min thickness: 2mm
NOTE: 9mm compressed concrete sheet required under hearth if distance from floor to the base of the fireplace is less than 400mm

COPYRIGHT©
 THIS DRAWING IS THE PROPERTY
 OF The Fire Dept.

Client: THE FIRE DEPT.

Product: WD7

Title: FIREPLACE DIMENSIONS

Drawn: JG

Date: 25/08/2022

Chkd: LB

Date: 25/08/2022

Appd: JW

Date: 25/08/2022

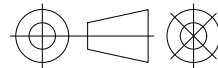

Scale: on A4

THE
 FIRE
 DEPT.
 HAND CRAFTED FIRES

Drawing No.

WD7-1200-903

Sheet 03 of 07

Revision

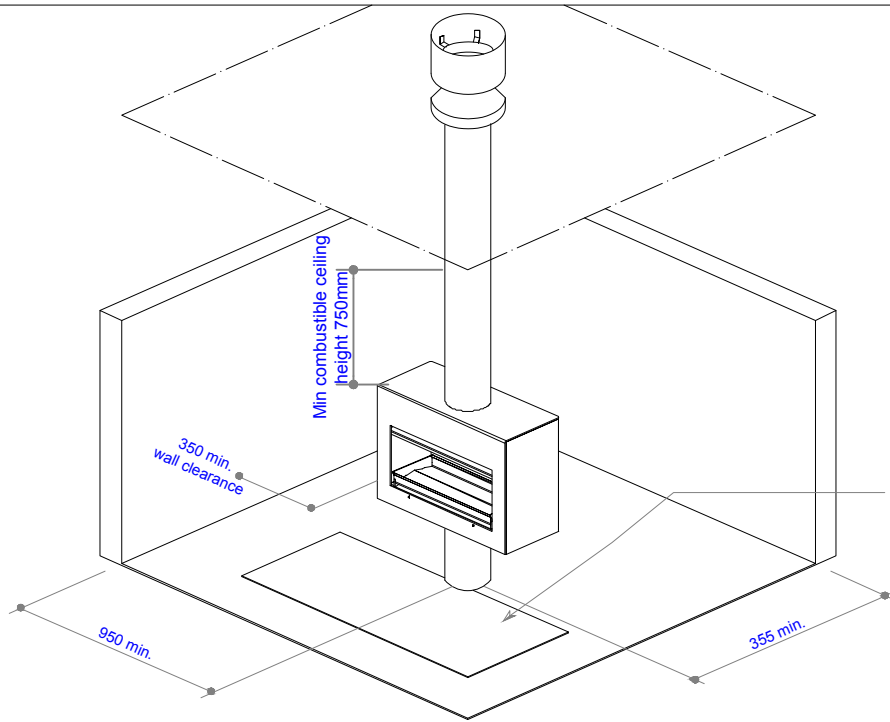

Non-combustible material directly in front of fireplace opening if placed onto combustible flooring.
e.g timber deck
Min dimensions:
1350 mm x 2mm thick
NOTE: The floor protector needs to be installed centrally with rotating axis

Fireplace installation & Hearth Requirements
Option 1 - Fixed Supported base

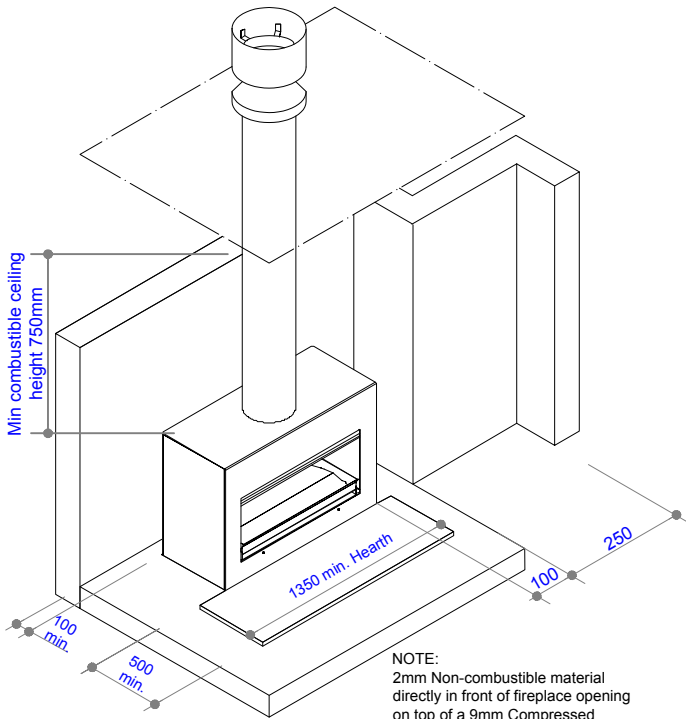

NOTE:
2mm Non-combustible material directly in front of fireplace opening on top of a 9mm Compressed Concrete Sheet if placed onto combustible flooring e.g timber deck

Fireplace installation & Hearth Requirements
Option 2 - Floor mounted

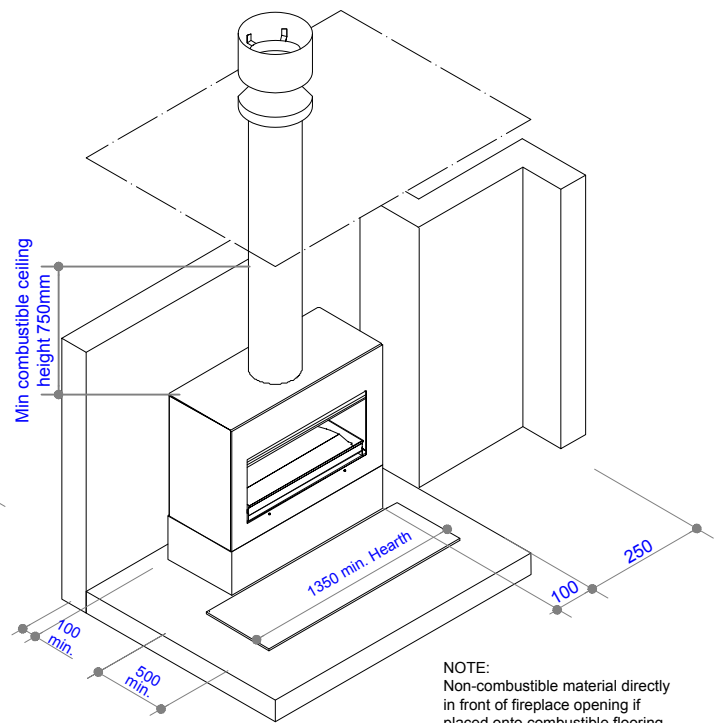

NOTE:
Non-combustible material directly in front of fireplace opening if placed onto combustible flooring. e.g timber deck
Min thickness: 2 mm

Fireplace installation & Hearth Requirements
Option 3 - Raised or on a Wood box base

COPYRIGHT©
THIS DRAWING IS THE PROPERTY
OF The Fire Dept.

Client: THE FIRE DEPT.

Product: WD7

Title: FIREPLACE CLEARANCES

Drawn: JG

Date: 25/08/2022

Chkd: LB

Date: 25/08/2022

Appd: JW

Date: 25/08/2022

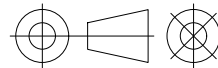

Scale: on A4

THE
FIRE
DEPT.
HAND CRAFTED FIRES

Drawing No.

WD7-1200-904

Sheet 04 of 07

Revision

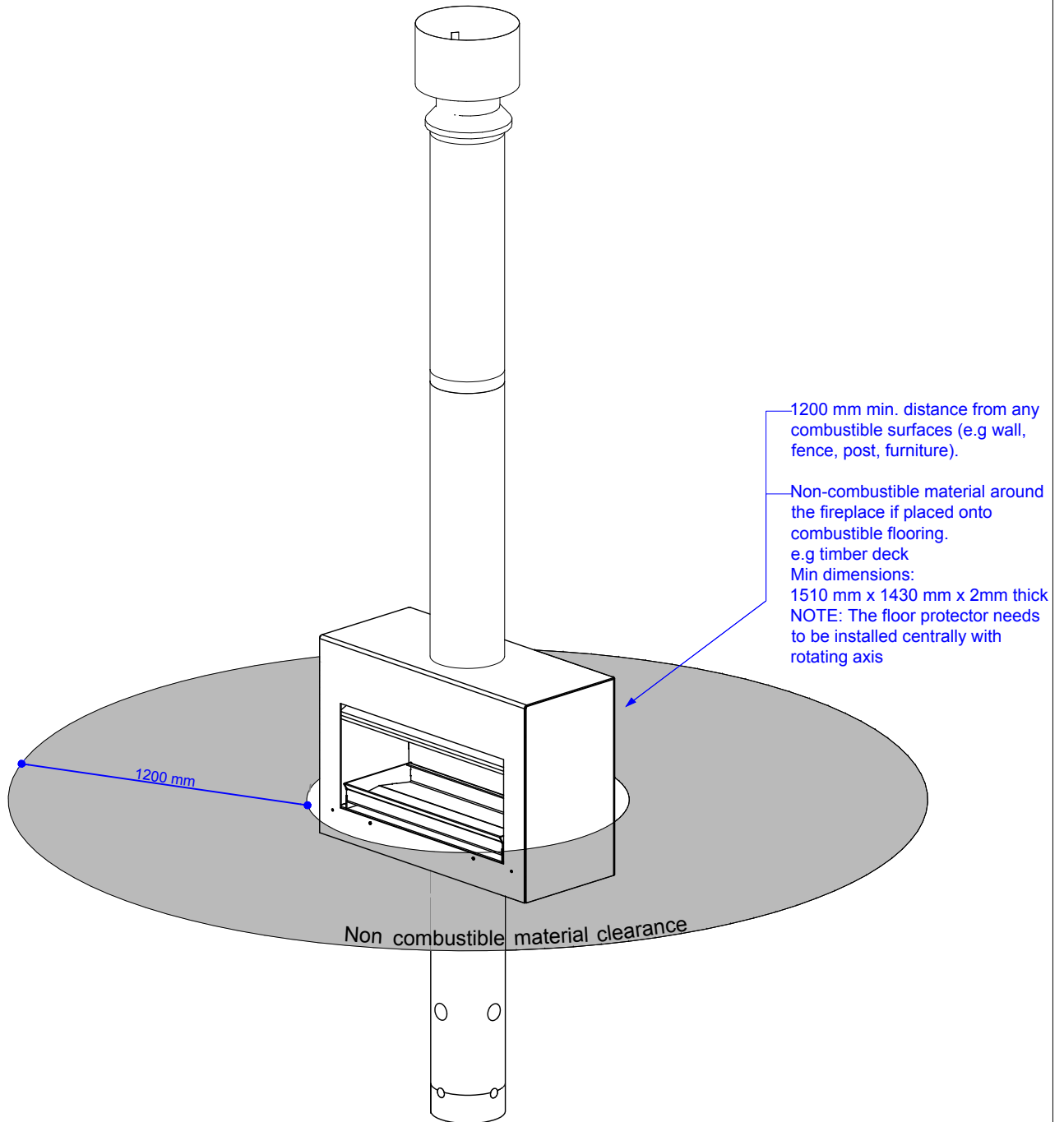

Fireplace installation Requirements
Option 4 - Spinning base

COPYRIGHT© THIS DRAWING IS THE PROPERTY OF The Fire Dept.	Client: THE FIRE DEPT.			
	Product: WD7			
	Title: FIREPLACE CLEARANCES			
	Drawn: JG	Date: 25/08/2022		
	Chkd: LB	Date: 25/08/2022		
	Appd: JW	Date: 25/08/2022		
Drawing No.		WD7-1200-905	Scale: on A4	
Sheet		05 of 07	Revision	

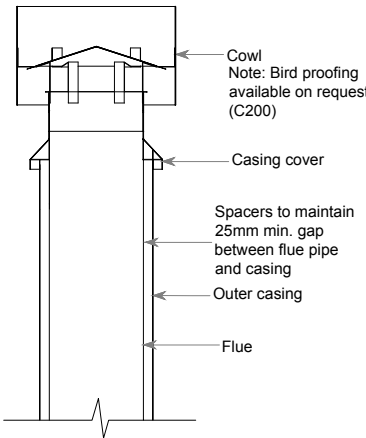

Flue components (F35):
 Ø 250mm S/S Flue
 Ø 300mm S/S Outer Casing

NOTE:
 Flue components must be installed to AS/NZS2918:2001 requirements.
 All external penetration flashings must be installed in accordance with NZBC.
 Cavity airflow must be unobstructed from fire box to flue termination.
 75mm clearance between inner flue and combustible materials.
 125mm clearance between inner flue and wiring / plastic water pipes.
 Each flue joint must be sealed with a heat proof sealer.
 Each flue joint must have a minimum of 4 x Stainless Steel rivets.
 Flue to be adequately supported at 2m crs.

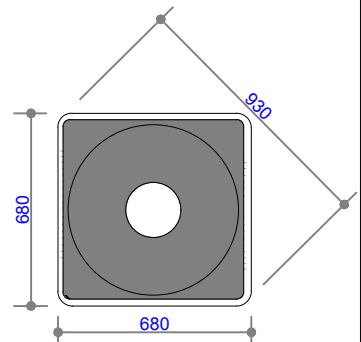

Dektite Flashing No. 9 - Plan View

Option 1 - Free standing fireplace flue detail -
 Air Ventilation through Casing cover / Top flashing

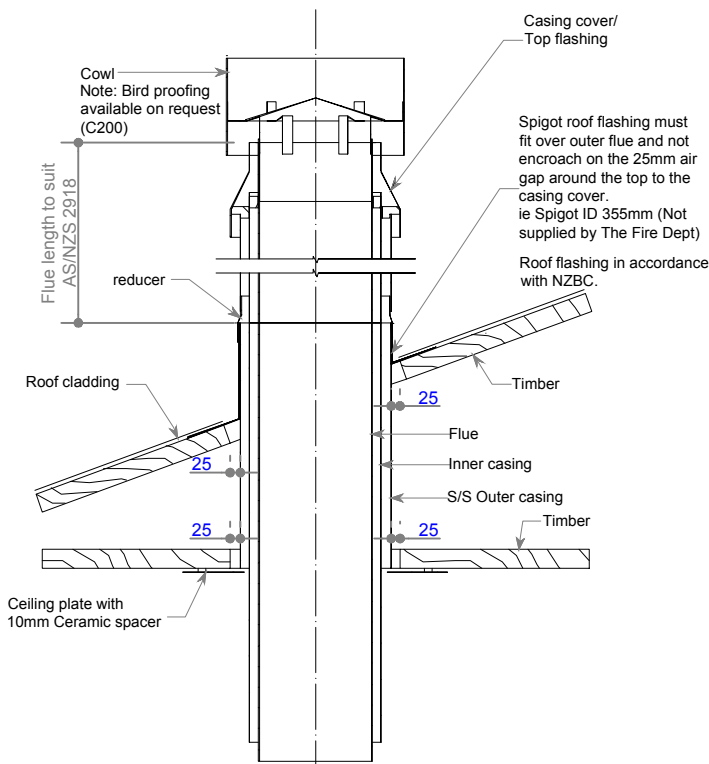

Option 2 - Roof penetration flue detail - (Spigot)
 Air Ventilation through Casing cover / Top flashing

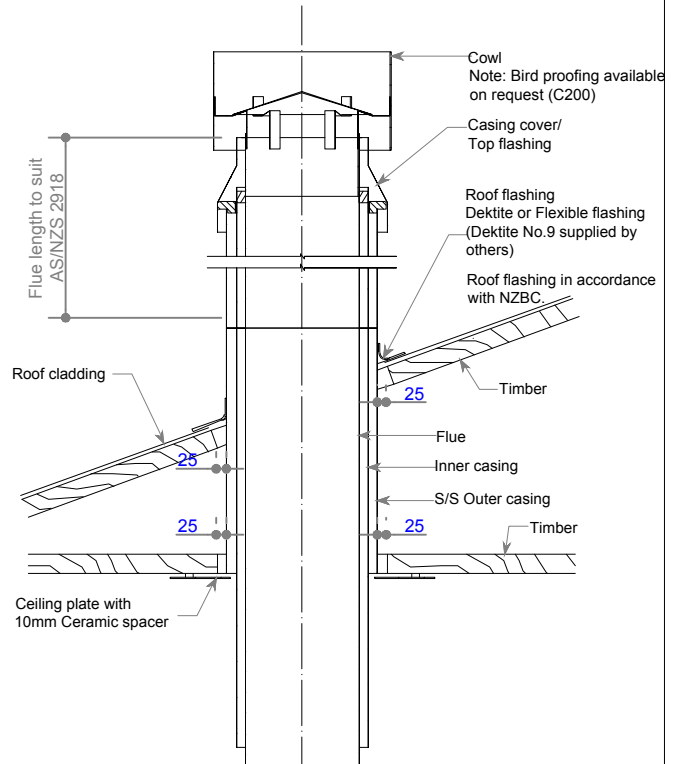

Option 3 - Roof penetration flue detail - (Dektite / Flashing)
 Air Ventilation through Casing cover / Top flashing

Flue components (F35 & F38):
 Ø 250mm S/S Flue
 Ø 300mm Inner Casing
 Ø 350mm S/S Outer casing
 Ø 360mm Ø ID to Ø 345mm OD reducer

NOTE:
 Flue components must be installed to AS/NZS2918:2001 requirements.
 All external penetration flashings must be installed in accordance with NZBC.
 Cavity airflow must be unobstructed from fire box to flue termination.
 75mm clearance between inner flue and combustible materials.
 125mm clearance between inner flue and wiring / plastic water pipes.
 Each flue joint must be sealed with a heat proof sealer.
 Each flue joint must have a minimum of 4 x Stainless Steel rivets.
 Flue to be adequately supported at 2m crs.

Flue components (F35 & F39):
 Ø 250mm S/S Flue
 Ø 300mm Inner Casing
 Ø 350mm S/S Outer casing
 Dektite No.9 (by others)

COPYRIGHT©
 THIS DRAWING IS THE PROPERTY
 OF The Fire Dept.

Client: THE FIRE DEPT.			
Product: WD7			
Title: FLUE DETAILS			
Drawn: JG	Date: 25/08/2022		
Chkd: LB	Date: 25/08/2022		
Appd: JW	Date: 25/08/2022		
Scale: on A4			



Drawing No.	WD7-1200-906	Sheet 06 of 07	Revision
-------------	--------------	----------------	----------

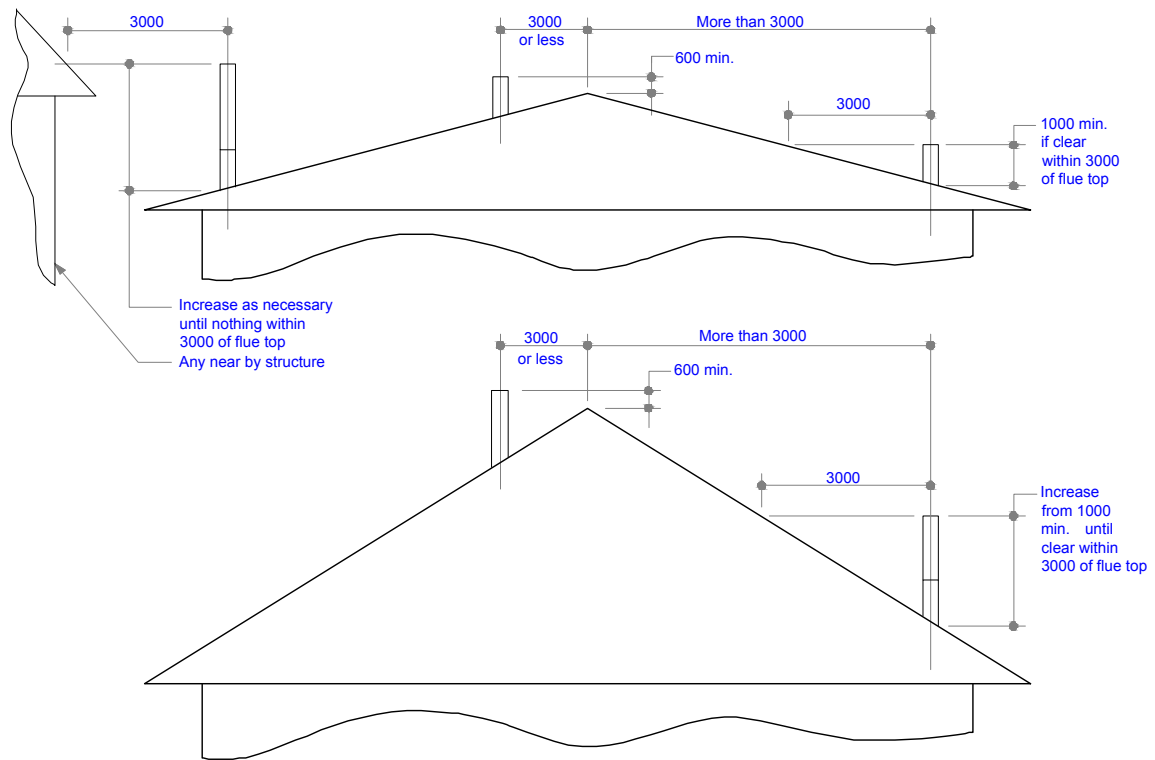

Minimum Height of Flue System Exit
Or as per AS/NZS 2918:2001

Note - Roof Penetrations: Flue pipe to extend not less than 4.6mm above the top of the floor protector, excluding cowl height.

COPYRIGHT©
THIS DRAWING IS THE PROPERTY
OF The Fire Dept.

Client: THE FIRE DEPT.

Product: WD7

Title: FLUE DETAILS

Drawn: JG

Date: 25/08/2022

Chkd: LB

Date: 25/08/2022

Appd: JW

Date: 25/08/2022

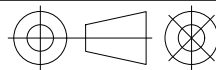

Scale: on A4

THE FIRE DEPT.
HAND CRAFTED FIRES

Drawing No.

WD7-1200-907

Sheet 07 of 07

Revision